

Standortportfolio

München Bogenhausen

DESIGN OFFICES



OG 02

Meetings & Conference

 Zusammengestellt durch flexible Wände

- 1** Training Room I
- 2** Training Room II
- 3** Training Room I + II
- 4** Fireside Room II
- 5** Meet & Move Room I
- 6** Meet & Move Room II
- 7** Meet & Move Room III
- 8** Meet & Move Room IV
- 9** Meet & Move Room III + IV
- 10** Work Lab S
- 11** Work Lab S II
- 12** Work Lab M
- 13** Work Lab L
- 14** Fireside Room I
- 15** Coworking Space
- 16** DO.Lounge
- 17** Terrasse

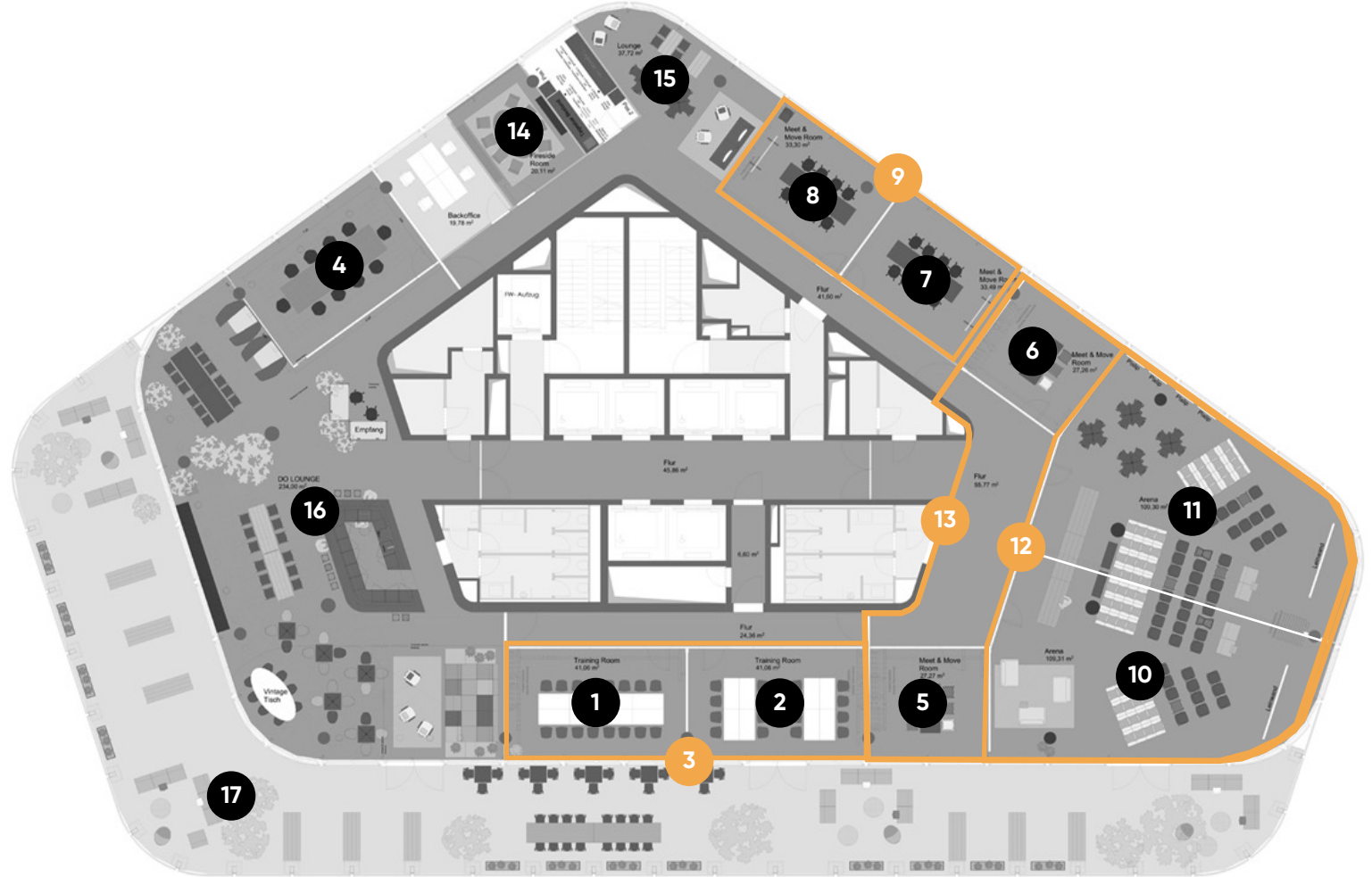

OG 02

Meetings & Conference



		m ²	L x B x H in Metern	New Work	U-Form	Parlament	Theater	Block	Stuhlkreis	Bankett
1	Training Room I	41	8,0 x 5,0 x 3,0	12	8	8	12	8	8	
2	Training Room II	41	8,0 x 5,0 x 3,0	12	8	8	12	8	8	
3	Training Room I + II	82	16,0 x 5,0 x 3,0	25	25	24	45	18		
4	Fireside Room II	40	7,3 x 5,0 x 3,0					8		
5	Meet & Move Room I	27	5,3 x 5,0 x 3,0					6		
6	Meet & Move Room II	27	5,3 x 5,0 x 3,0					6		
7	Meet & Move Room III	33	6,6 x 5,0 x 3,0					8-10		
8	Meet & Move Room IV	33	6,6 x 5,0 x 3,0					8-10		
9	Meet & Move Room III + IV	66	13,3 x 5,0 x 3,0					16-20		
10	Work Lab S	109	14,5 x 9,8 x 3,0	25	15	15	35			
11	Work Lab S II	109	14,5 x 9,8 x 3,0	25	15	15	35			
12	Work Lab M	218	14,5 x 19,6 x 3,0	70	30	55	70			
13	Work Lab L	328		150	30	90	150			
14	Fireside Room I	20	3,9 x 5,0 x 3,0					6		
15	Coworking Space	53								
16	DO.Lounge	234	22,0 x 10,5 x 3,0	Community Table, Bistro- und Lounge-Möblierung						
17	Terrasse	360	5,0 x 4,2 x 21,0	Außergewöhnliche Outdoor-Möblierung mit Tribüne						

OG 04

Meetings & Conference

- 1 Work Lab I
- 2 Work Lab II
- 3 Work Lab III
- 4 Eatery
- 5 Training Room II
- 6 Training Room III
- 7 Training Room IV
- 8 Day Office I
- 9 Day Office II

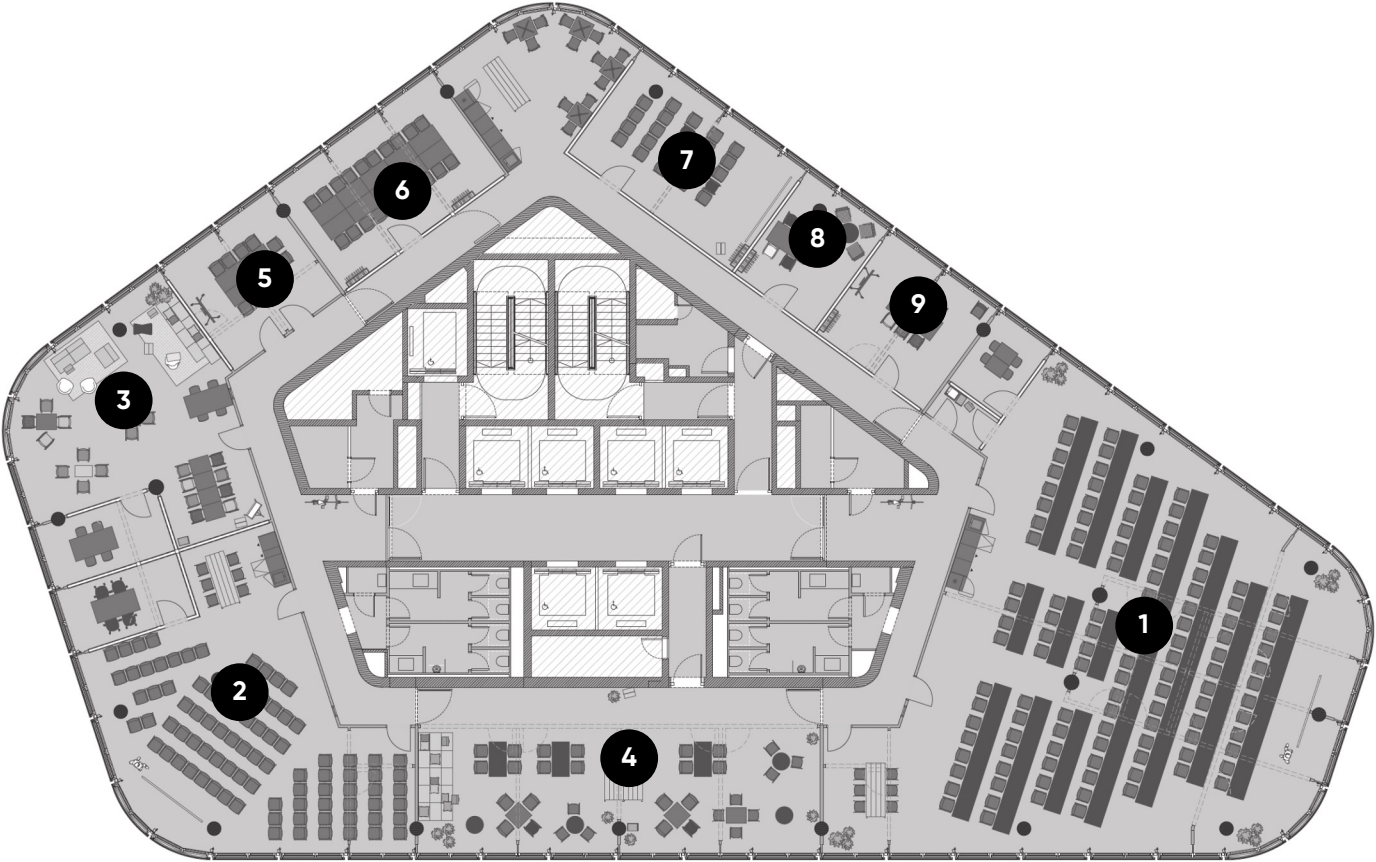

OG 04

Meetings & Conference



		m ²	L x B x H in Metern	New Work	U-Form	Parlament	Theater	Block	Stuhlkreis	Bankett
1	Work Lab I	280	17,0 x 13,0 x 3,0	120	18	50	120	16		
2	Work Lab II	108	11,0 x 4,0 x 3,0	30			30	18		
3	Work Lab III	108	11,0 x 4,0 x 3,0	30			30	18		
4	Eatery	106	16,2 x 5,2 x 3,0	45						45
5	Training Room II	27	5,0 x 3,0 x 3,0					4		
6	Training Room III	27	5,0 x 8,0 x 3,0					6		
7	Training Room IV	33	5,0 x 4,0 x 3,0					6		
8	Day Office I	33	5,0 x 4,0 x 3,0					4		
9	Day Office II	66	5,0 x 5,4 x 3,0					6		