



DESIGN OFFICES

STUTT GART

EBERHARDHÖFE

**MEETING &
CONFERENCE**

GROUND FLOOR

GF

GROUND FLOOR

- ① Fireside Room
- ② Meet & Move Room I
- ③ Training Room I
- ④ Training Room II
- ⑤ Training Room I + II
- ⑥ Training Room III
- ⑦ Training Room II + III
- ⑧ Training Room I – III
- ⑨ Training Room V
- ⑩ Training Room VI
- ⑪ Training Room V + VI
- ⑫ Worklab
- ⑬ Arena
- ⑭ DO Lounge

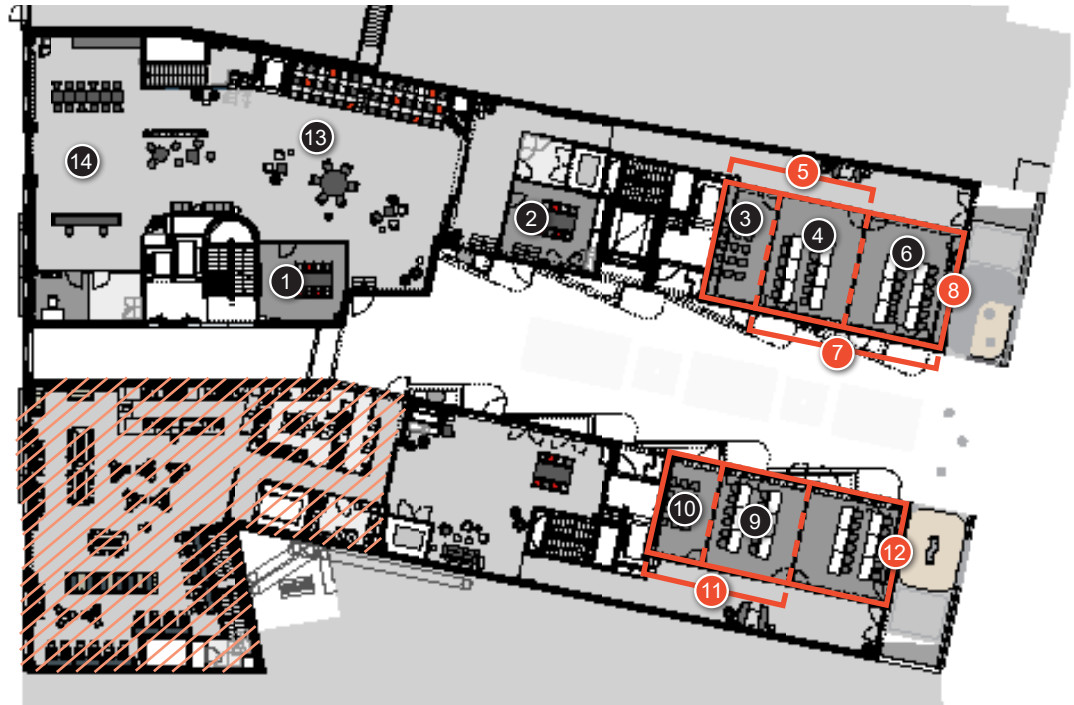

DESIGN OFFICES







STUTT GART

EBERHARDHÖFE

SEATING PLAN

- 1 Fireside Room
- 2 Meet & Move Room I
- 3 Training Room I
- 4 Training Room II
- 5 Training Room I + II
- 6 Training Room III
- 7 Training Room II + III
- 8 Training Room I – III
- 9 Training Room V
- 10 Training Room VI
- 11 Training Room V + VI
- 12 Work lab
- 13 Arena
- 14 DO Lounge

GF

m ²	L x W x H in Meter							
		New Work	U-Shape	Parliament	Theater	Block	Circle	Banquet
25	4.8 x 5.3 x 2.8-3.6					8		
25	4,6 x 5,3 x 2,8-3,6					8		
23	7.0 x 3.3 x 2.8-3.6			6	6	4	10	
39	7.0 x 5.5 x 2.8-3.6		12	12	20	12	20	
62	7.0 x 8.8 x 2.8-3.6	30	18	24	50	16	25	
43	7.0 x 6.0 x 2.8-3.6	15	12	16	30	12	20	
82	7.0 x 11.5 x 2.8-3.6	40	24	30	60	24	30	
105	7.0 x 14.8 x 2.8-3.6	60	30	48	100	28	50	
35	6.0 x 5.5 x 2.8-3.6		12	12	20	12	20	
20	6.0 x 3.3 x 2.8-3.6			6	6	4	10	
54	6.0 X 8.8 X 2.8-	30	18	24	50	16	25	
91	6.0 X 14.8 X 2.8-	50	24	30	70	24	30	
	H: 2,7-3,7	120			175			
310	H: 2,7-3,7	Community table, bistro and lounge furniture						