



DESIGN OFFICES

MÜNCHEN

88 NORTH

MEETING &
CONFERENCE

3RD FLOOR

3RD FL

DESIGN OFFICES

COMARCH

AKOIA

3RD FLOOR

- ① Coworking Space
- ② Meet & Move Room
- ③ Training Room I
- ④ Training Room II
- ⑤ Training Room I + II
- ⑥ Fireside Room I
- ⑦ Fireside Room II
- ⑧/⑨ Dachterrasse
- ⑩ DO Lounge/Empfang
- ⑪ DO Bistro

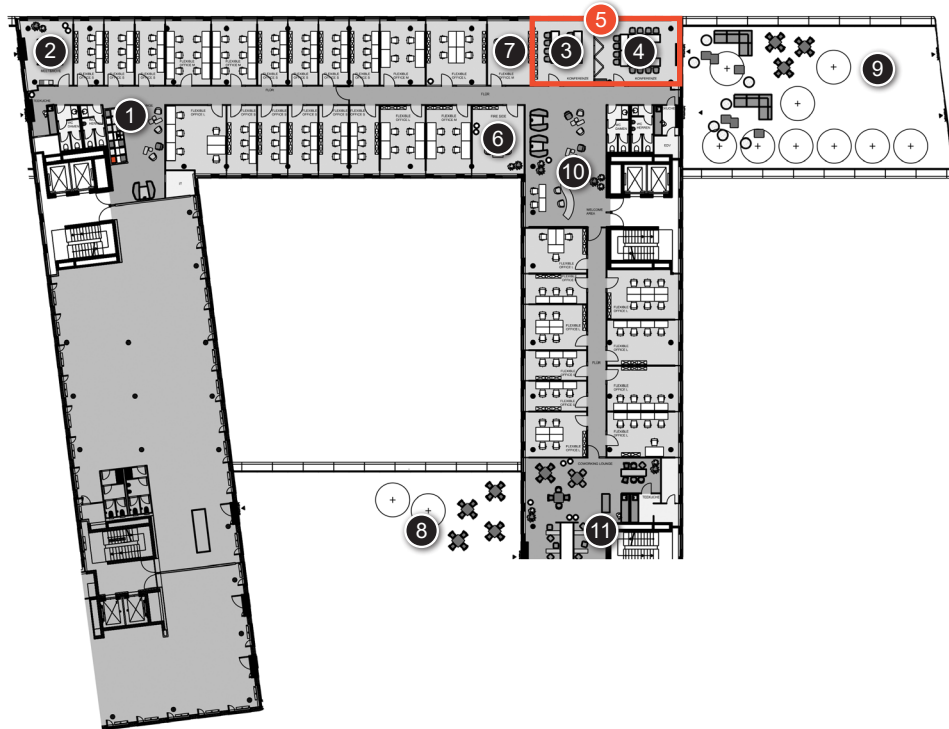







MÜNCHEN
88 NORTH

SEATING PLAN

- 1 Coworking Space
- 2 Meet & Move Room
- 3 Training Room I
- 4 Training Room II
- 5 Training Room I + II
- 6 Fireside Room I
- 7 Fireside Room II
- 11 DO Bistro
- 8 + 11 DO Bistro + Terrace

3RD FL

m ²	L x W x H in Meter							
		New Work	U-Shape	Parliament	Theater	Block	Circle	Banquet
41	8,8 x 4,6	New Work seating for 20 people						
31	5,7 x 5,3					12		
30	5,7 x 5,3		12	8	15	12	10	9
42	5,7 x 7,4		16	12	30	16	15	12
72	5,7 x 12,7		30	20	50	28	30	24
27	4,5 x 6,0					8		
27	4,5 x 6,0					8		
86	6,6 X 4,6	individual seating - seated max. 40 pax						
ca. 90	3,3 x 6,0 x 3,3	individual seating - seated max. 70 pax						