

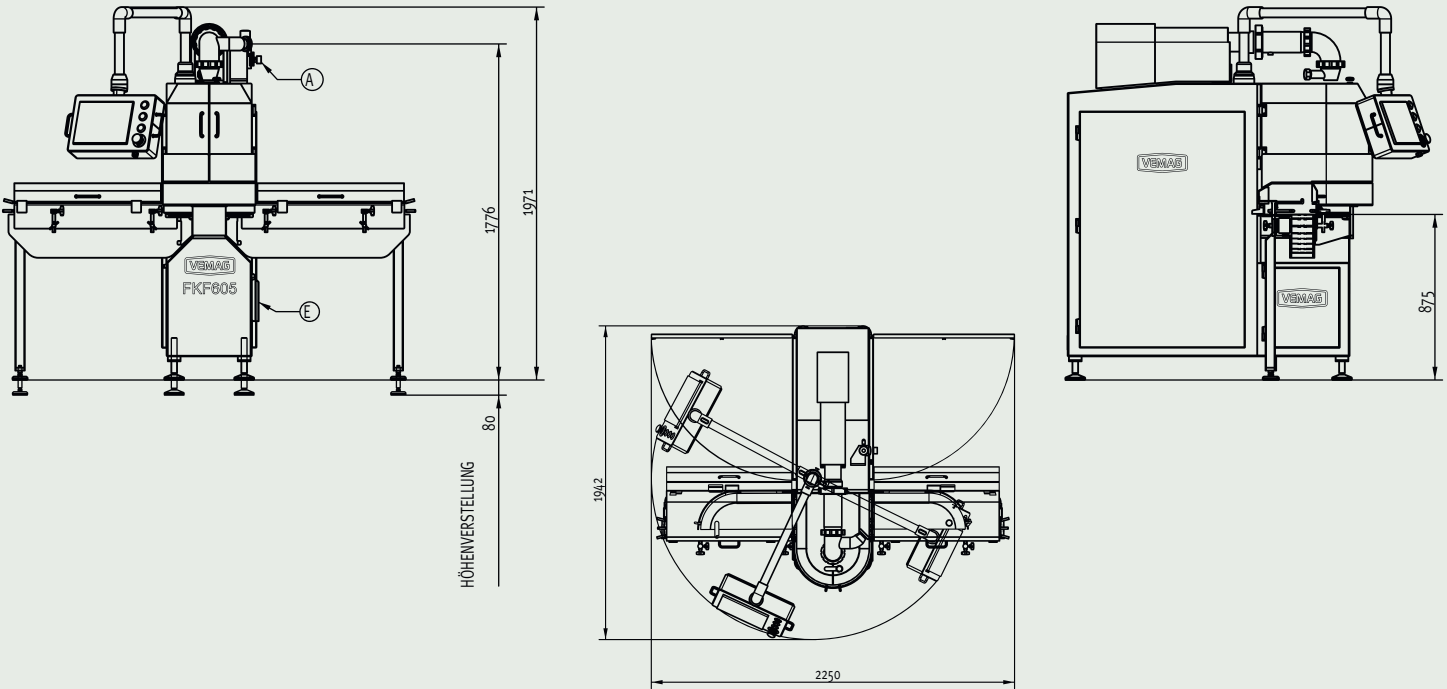

FKF II – CAN FILLING SYSTEM

SIMPLY CLEAN PORTIONING

DATA SHEET

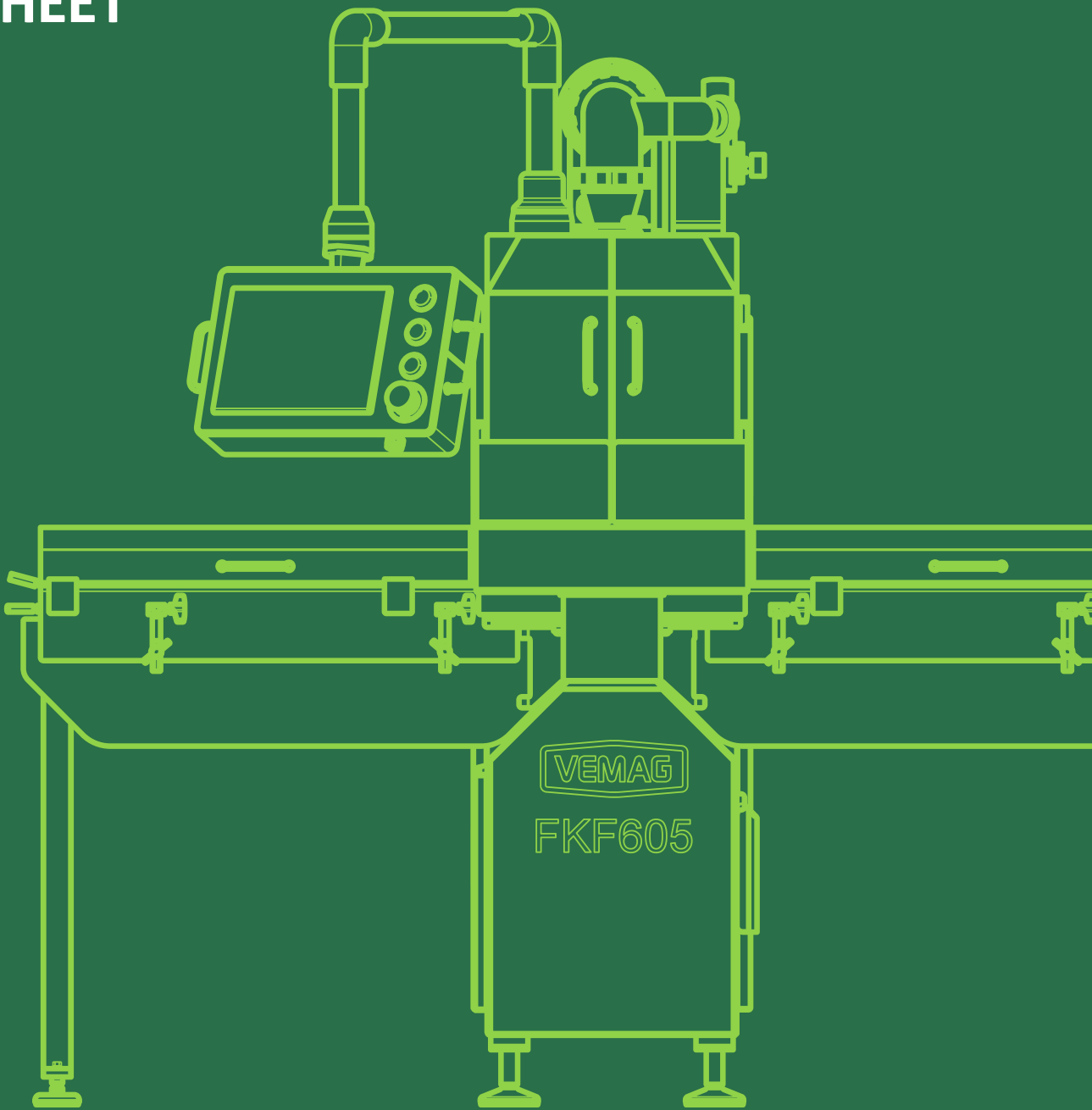

Technical drawing

A = Air connection E = Electrical connection W = Water connection

TECHNICAL SPECIFICATIONS	
FKF II	
Portioning rate	up to 120 cans/jars per minute (depending on the weight and material)
Receptacle size	Max. diameter = 99 mm Max. height = 145 mm
Filling weight	max. 1,200 ml

FILL CANS AND JARS FULLY AUTOMATICALLY

Portion lumpy and fibrous products in precise weights

The tin can – a classic item of packaging and still unbeatable in many ways. Food safety and sustainable packaging materials are coming under increasing scrutiny. Packaging like cans and jars are more in demand than ever.

The FKF offers many more advantages by using recyclable packaging materials. Products in paste form and in pieces are dispensed exactly, quickly and reliably. It ensures that your product is filled perfectly into cans or jars, ready for sale.

Benefits at a glance

- Utmost precision because volume is accurately adjustable
- Excellent product profile because portioning is done gently
- Cuts sinewy meat perfectly, such as ham hock and pet food
- Improved product quality because receptacle is completely filled without air inclusions
- Lots of flexibility in the formats and sizes of cans and jars
- Up to 120 cans or jars per minute

Dispensing cylinder with integrated piston lock

The Principle

- The dispensing cylinder is filled under a steady pressure using precise VEMAG filler technology
- Perfect synchronisation between filler and dispensing cylinder
- The volume is variably adjusted using the latest servo technology

The benefits

- Utmost precision because volume is accurately adjustable
- Flexible filling weight achieved using replaceable dispensing cylinders of up to 1200 ml
- Excellent product profile because portioning is done gently

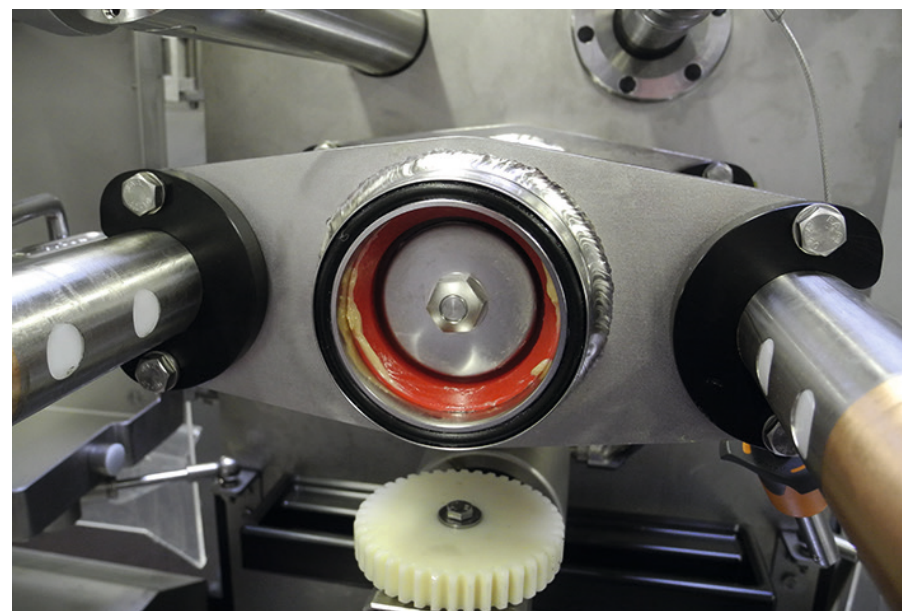

Cylinder Seal

Filling head with ball lock and rotating blade

The Principle

- The required volume is gently conveyed from the dispensing cylinder to the filling head once the ball lock opens
- The ball lock separates the products while they are being conveyed by the dispensing cylinder into the filling head
- The product is cut when the filling head closes in conjunction with a constantly rotating ring blade

The benefits

- Cuts sinewy meat perfectly, such as ham hock and pet food
- Portions precisely cut, even if the ingredients are in large pieces, to achieve the utmost weight accuracy
- The filling head is compactly designed so it can be lowered into the receptacle, filling it perfectly for an excellent product profile at all times



Filling-Head

Can lifter

The Principle

- Cans and jars are fed into a rotating cycle star-disc by the feed belt
- Servo-driven technology guarantees precision positioning beneath the filling head
- Cans and jars are lowered in synch and continuously filled

The benefits

- Improved product quality because receptacle is completely filled without air inclusions
- Filling is continuously perfect, meaning less reworking
- Small weight sizes are ideally filled, even if the products are firm or in pieces



Can lifter



FKF II – Can Filling System