

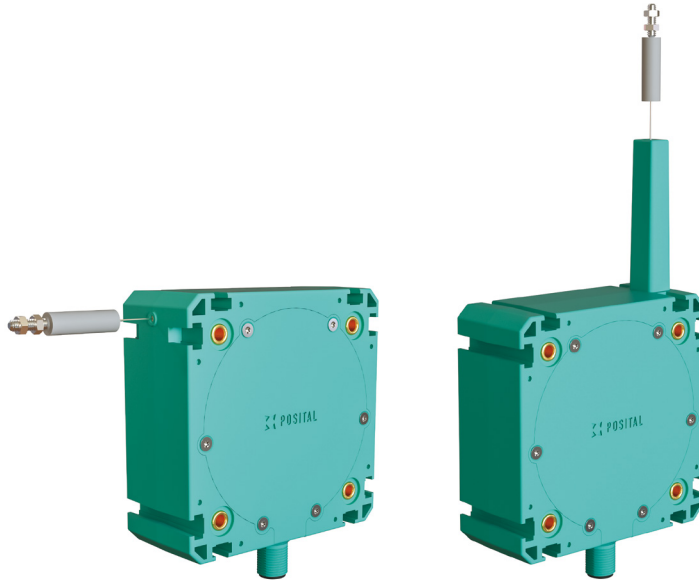

REDUNDANT LINEAR SENSOR

LINARIX Draw Wire with Integrated Encoder



The newest addition to our LINARIX linear sensor family, offers reliable performance in a compact, cost-efficient design. Engineered for outdoor applications like outriggers, trucks, and forklifts, this highly integrated draw-wire sensor ensures dependable position determination by redundant magnetic sensing. This LINARIX sensor features a redundant analog output and is prepared for future functional safety certification. With a measuring range of up to 8 meters and a linearity of $\pm 0.5\%$, it provides reliable data for safe and efficient operations, supporting redundant measurement in a cost-effective package.

Benefits

- > **Redundant Magnetic Sensing**
Prepared for Functional Safety
- > **Output: Analog or RS485**
CANopen and J1939 will Follow
- > **Compact Design**
95 mm x 95 mm x 40 mm
- > **Ideal for Mobile Machinery**
Designed for Harsh Environments (IP66/IP67)
- > **Up to 8 m Measuring Range**
Linearity: $\pm 0.5\%$ Full Scale
- > **Flexible Mounting**
4 mm Through Hole and M5 Mounting Nuts



REDUNDANT LINEAR SENSOR

LINARIX Draw Wire with Integrated Encoder

Electrical Data

Supply Voltage	8 – 30 VDC
Power Consumption	≤ 0.7 W

Environmental Specifications

Protection Class (Electronics)	IP66/IP67
Operating Temperature	-40 °C (-40 °F) – +85 °C (+185 °F)
Humidity	98% RH, No Condensation

Mechanical Data

Length per Revolution	227.80 mm
Housing Material	Glass-fiber Reinforced Plastics
Draw Wire Material	Polyamide-coated Stainless Steel (ø 0.70 mm)

Electrical Connection

Connector	M12 Connector (5 or 8 pin), Cable Exit or Pigtail
-----------	---

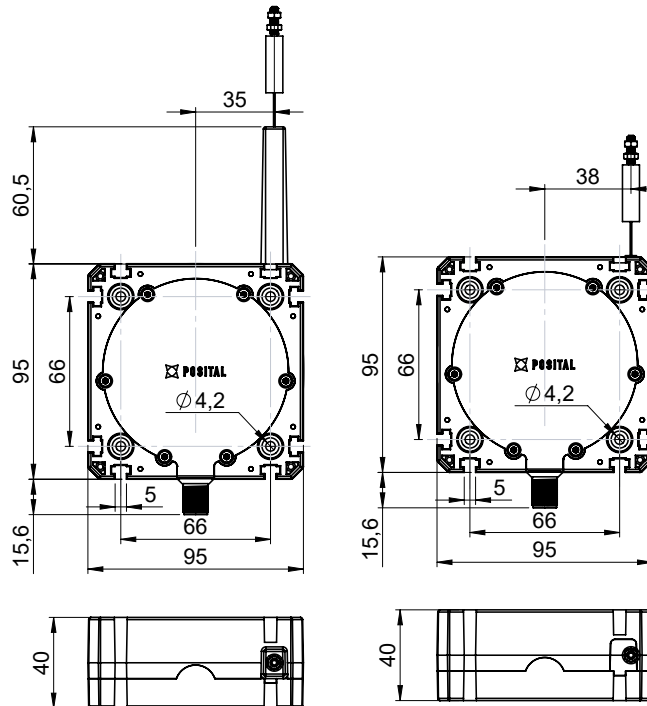

Join Our Network!



www.posital.com

Cologne (EMEA) – Hamilton (Americas) – Singapore (APAC) – Shanghai (China)