

ko'ala

paddington bed base

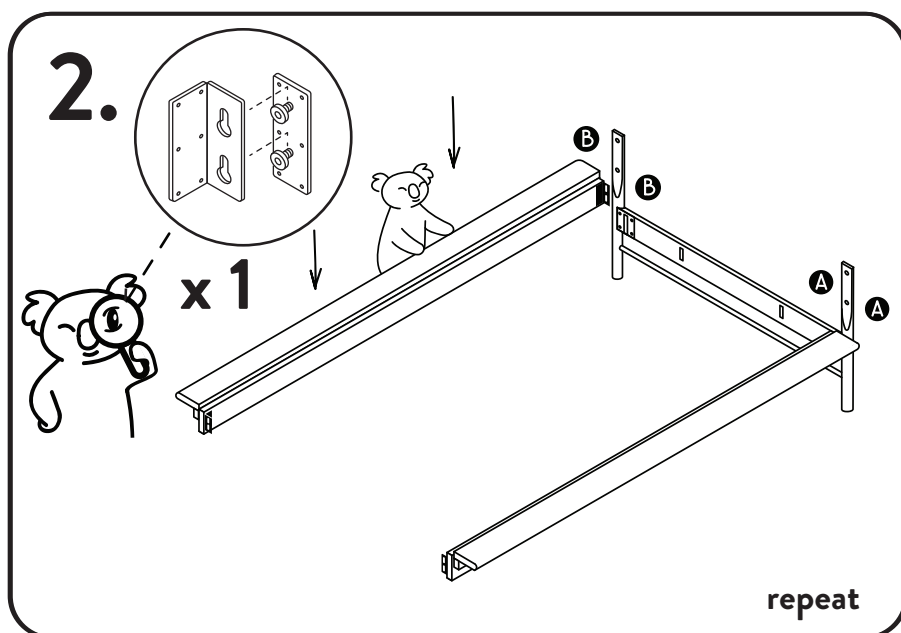

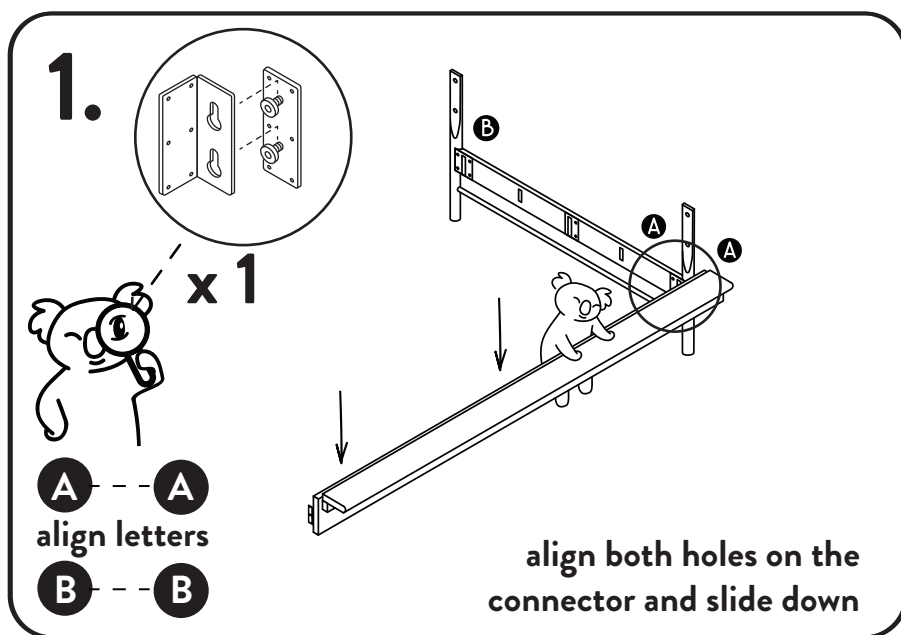
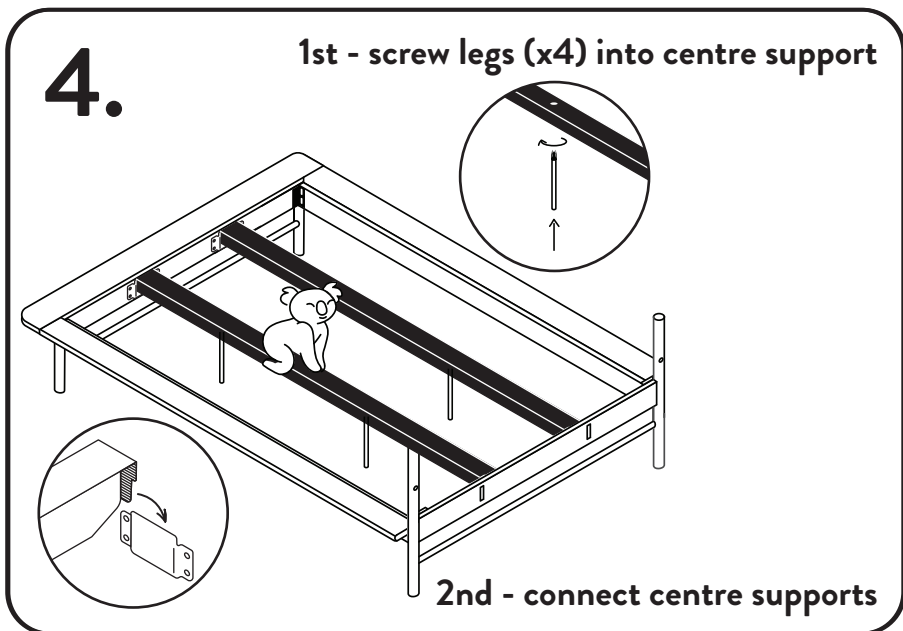
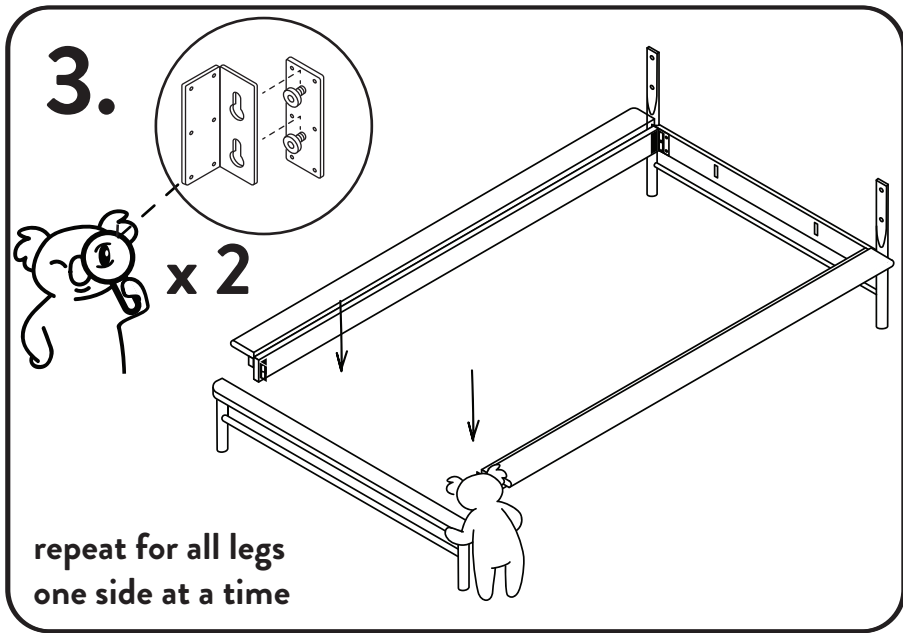

5.

x 2

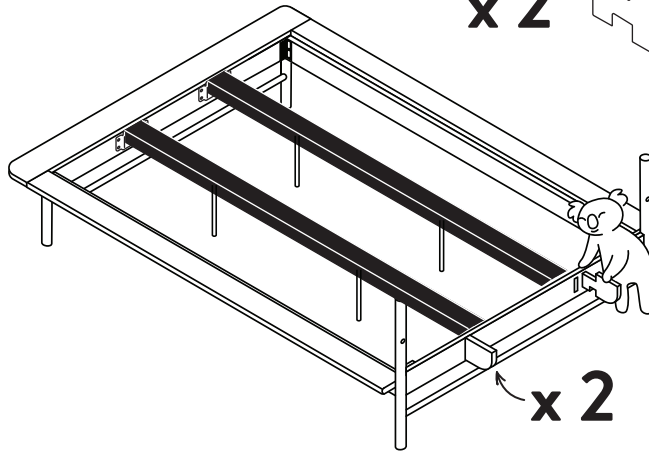
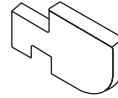

slide shelf supports into the frame

6.

adjust feet if needed

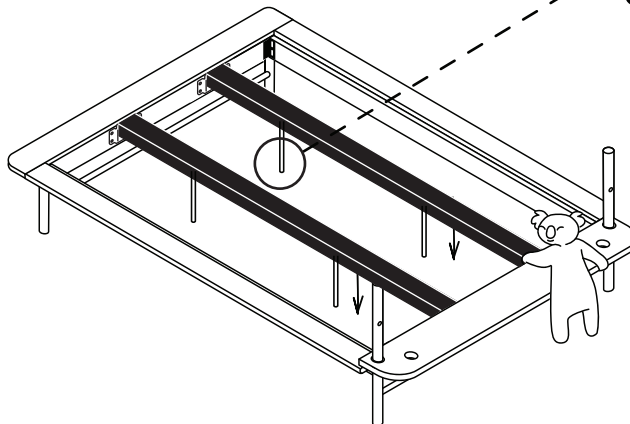

lower down shelf keeping it flat

7.

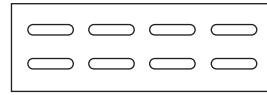

x 4

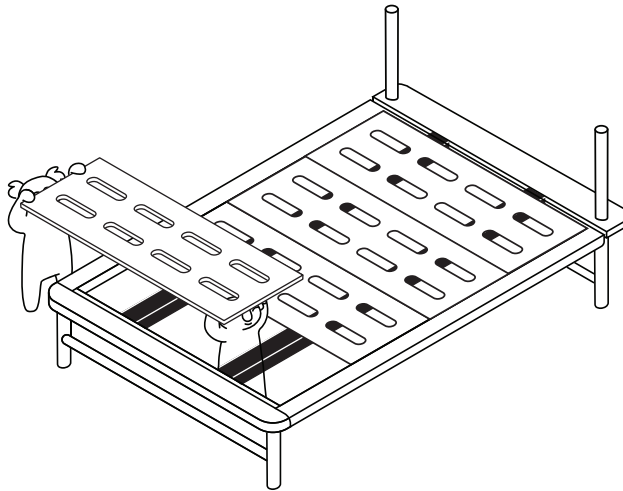

8.



x 16

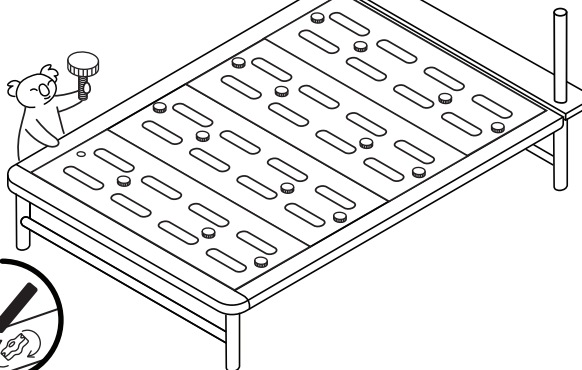

tighten gumnuts

screw in mini gumnuts

9.

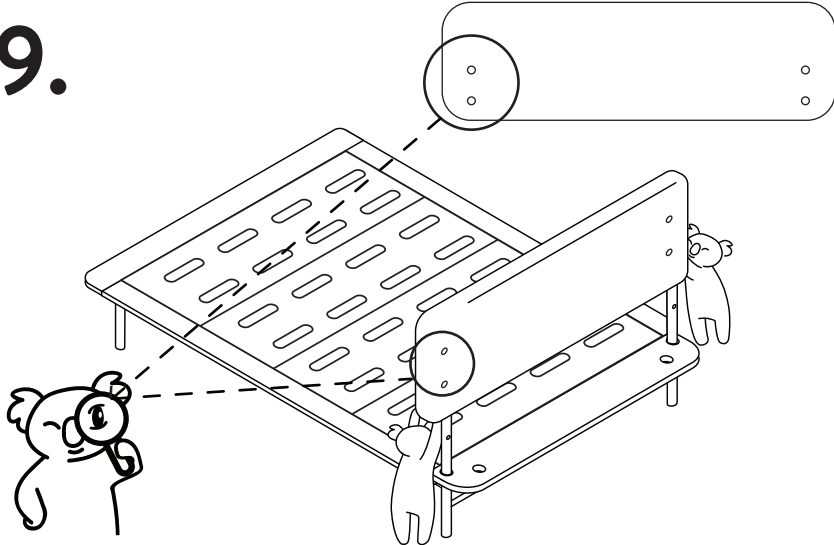

holes on the bottom

lift on backrest

10.

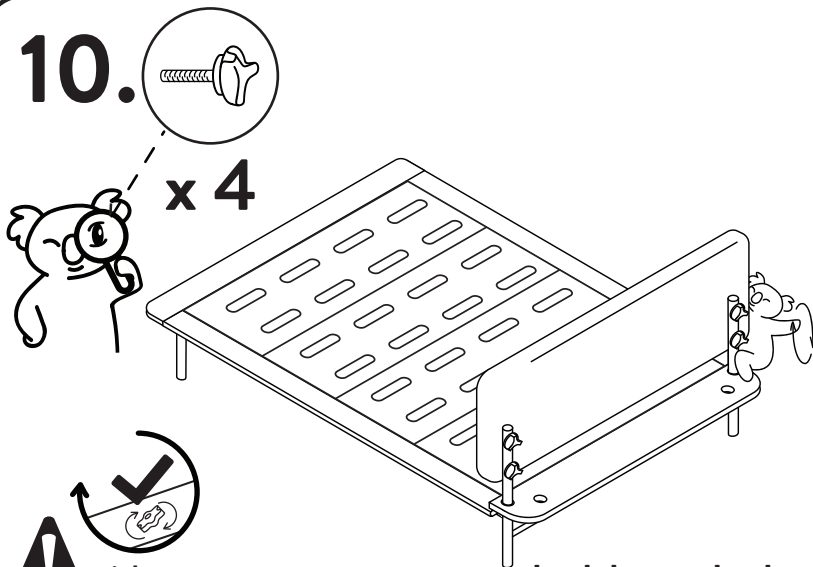

x 4



tighten gumnuts

connect back legs to backrest

COMPLETE!

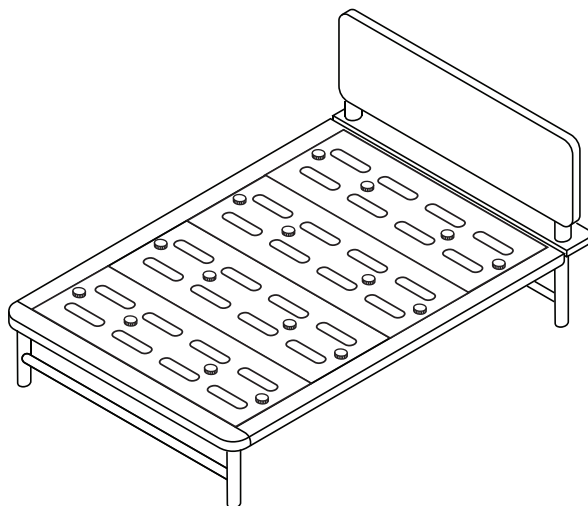



don't forget to recycle

ko'ala