



FALL POSSESSION



# THE CAMBRIDGE 26

2361 SQ.FT.

196 Precedence Hill



3 Bedrooms



2½ Bathrooms



Double Garage

### OPTIONS INCLUDED IN THIS HOME ARE:

- Walk-out homesite
- Hardwood throughout main floor
- Quartz kitchen countertops
- Built-in kitchen appliances
- Large kitchen pantry
- Fireplace in great room
- Main floor den
- 9' Main floor ceilings
- Central bonus room with open-to-below
- 5-Piece owner's ensuite
- Spacious walk-in closet
- Upstairs laundry room with wire shelf
- Rear deck with aluminum railings
- 9' Foundation

### COME VISIT OUR SHOWHOME

392 Rivercrest View, Cochrane, AB

Call Gwenn Utigard today at 403.981.0339 or email at rivercrest@tricohomes.com



THE ROSEWOOD

### SHOWHOME HOURS:

Mon - Thurs: 2pm - 8pm

Fri: Closed

Sat - Sun: 12pm - 5pm

### PLUS RECEIVE YOUR OWN TRICO RED CARD



& ENJOY INCREDIBLE ONGOING SAVINGS & REWARDS FROM OUR PARTNERS & RETAILERS

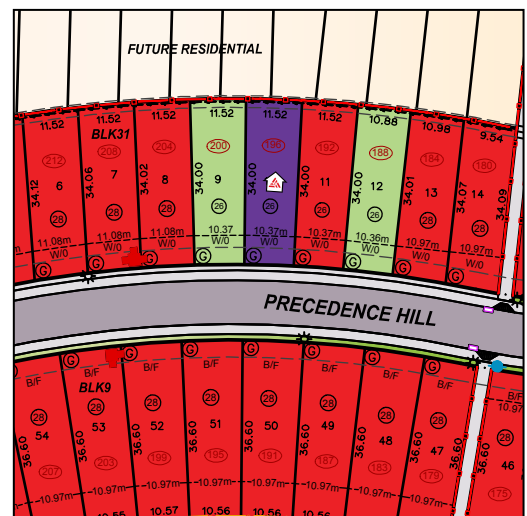

tricohomes.com



# THE CAMBRIDGE 26

2361 SQ.FT.

196 Precedence Hill



**MAIN**  
1060 SQ.FT.

**UPPER**  
1301 SQ.FT.



Renderings are artist's conceptions only and may vary by community and lot selection. Prices, floorplans, specifications and dimensions are approximate and are subject to change without notice. E.&O.E. © All rights reserved, including the right if reproduction in the whole or in part without the permission of Trico Homes.

Plan updated March 5, 2024

