



JANUARY 2026 POSSESSION



THE RAEYA 1884 SQ.FT.

316 Chelsea Pier Manor



4 Bedrooms



3 Bathrooms

OPTIONS INCLUDED IN THIS HOME ARE:

- 32' Wide traditional homesite
- Main floor bedroom and full bathroom
- 3 Bedrooms with central bonus room on upper floor
- Full laundry room
- Spacious owner's suite walk-in closet
- Legal secondary suite rough-ins in basement with separate entry
- 3 Windows in basement
- Rear deck with stairs to grade & aluminum railing
- 9' Foundation

COME VISIT OUR SHOWHOME

419 Chelsea Port Crossing, Chestermere AB

Call Matthew Lysaght or David Bell today at

403.651.9666 or email at chelsealaned@tricohomes.com



THE RAEYA

SHOWHOME HOURS:

Mon - Thurs: 2pm - 8pm

Fri: Closed

Sat - Sun: 12pm - 5pm

ASK ABOUT OUR TRICO RED CARD REWARDS



**YOU DECIDE
HOW TO REWARD
YOURSELF!**

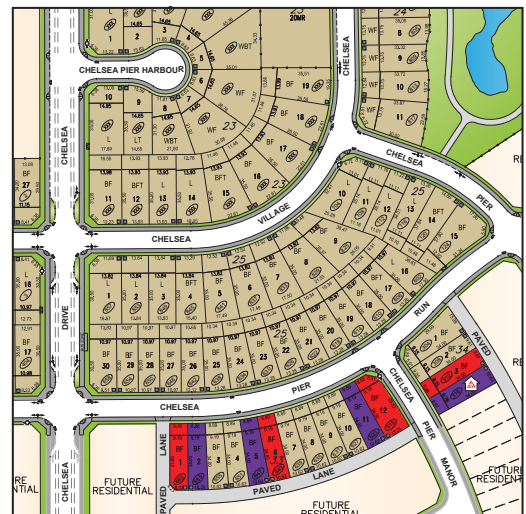

CHELSEA
CHESTERMERE

**Trico
Homes™**
The Heart of Homebuilding®



tricohomes.com



THE RAEYA

1884 SQ.FT.

316 Chelsea Pier Manor



Renderings are artist's conceptions only and may vary by community and lot selection. Prices, floorplans, specifications and dimensions are approximate and are subject to change without notice. E.&O.E. © All rights reserved, including the right if reproduction in the whole or in part without the permission of Trico Homes.

Plan updated August 19, 2025



tricohomes.com