

AirLink® RX400/EX400 Quick Start Guide



What's In the Box

- AirLink RX400 or EX400 High Performance 5G Redcap Router
- This Quick Start Guide for quick router connection and configuration
- Locking DC power cable
- AirLink Complete leaflet for ALMS registration and configuration

STEP 1 – Register with AirLink Management Service (ALMS)

One year of access to ALMS is included in the router's purchase price. Use ALMS to register, configure and monitor your router (or router fleet). Refer to the included AirLink Complete leaflet to create an ALMS account (if you do not have one), register your router and activate your subscription.

Note: You will need the Registration Code (**Reg Code**) printed on the router label to register and preconfigure your router. Your router will automatically connect to ALMS the first time it powers on, then complete its registration and apply any preconfiguration.

STEP 2 – Install the SIM Cards

1. Use a #1 Phillips screwdriver to remove the side panel cover.
2. Slide the 4FF (NanoSIM) SIM card(s) into the SIM card slots until they click into place. (Note the position of the notched corners.) By default, the SIM card in slot 1 (the upper slot) is the Primary SIM card. When the router is powered on or reboots, it automatically connects to the network associated with the Primary SIM card.
3. Re-attach the cover.

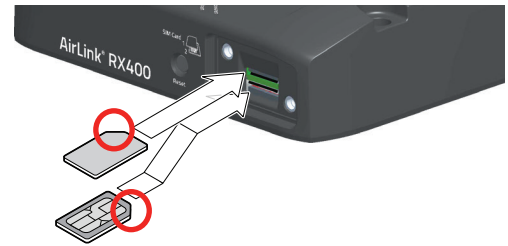

STEP 3 – Connect and Power On the Router

1. Connect cellular, Wi-Fi (on Wi-Fi models only) and GNSS antennas to the SMA connectors on the back panel.
2. Power on the router by providing 10.5–36 VDC to the DC Power connector, using the DC power cable or an optional AC power adapter (part number 2000579).

Once powered on, the router uses an available Internet connection to connect to ALMS, completes its registration and applies any preconfiguration done in **STEP 1**.

Important: DO NOT REMOVE POWER during an LED 'chase' (all LEDs flashing in sequence) as this indicates a device update is occurring.

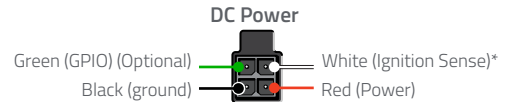
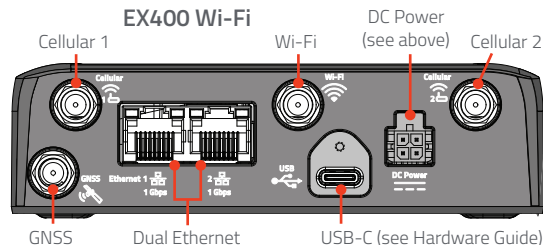
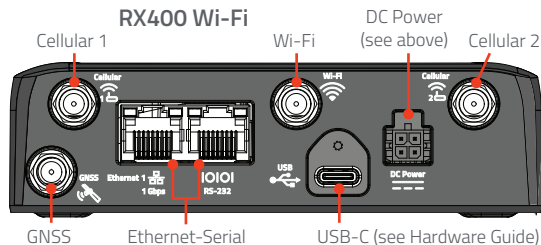

* If not using an AC adapter, Ignition Sense must be connected to vehicle ignition or the positive terminal of your power supply.



STEP 4 – Complete the Router Configuration (Recommended Procedure)

1. For your first AirLink router or a router in your fleet requiring custom configuration, connect your computer to the router (use any Ethernet port) and use the router's AirLink OS web interface — follow the instructions in **Configure the Router Locally with AirLink OS**, below.
2. If additional AirLink routers **of the same model** in your fleet will use the same configuration, use ALMS to make a template from this router. Then, when needed, use ALMS to push the template to those routers. Refer to the AirVantage documentation at source.sierrawireless.com/airvantage for details.

Configure the Router Locally with AirLink OS (Optional Procedure)

To locally configure your router, log in to AirLink OS (the router's web interface).

1. Connect to the router through a LAN connection (such as the router's Ethernet or USB-C port or Wi-Fi connection).
2. Open a browser window and enter **192.168.1.1**, and bypass any certificate notifications in your browser. The login screen appears.
3. Enter the administrator Name (**admin**) and factory default Password (printed on the label on the base of the router), and click SIGN IN. The Dashboard screen appears, and you can now make configuration changes to your router.

Note: The default password is recorded only on the label, which also has a QR code that contains the password and the router's serial number.

For system security, please change the default password as soon as possible.

Configure and Monitor the Router Remotely with ALMS (Optional Procedure)

Use ALMS to remotely monitor your router, and to perform maintenance activities and additional configuration. For details, refer to the enclosed AirLink Complete leaflet.

To configure your router:

1. Open a browser window, connect to AirVantage (e.g. na.airvantage.net, eu.airvantage.net), and log in to ALMS. Your ALMS account Dashboard is displayed.
2. Select Monitor > Systems to display your registered devices.
3. Find your router in the list, then click the router name to display the system details.
4. Click the Configuration button to display the configuration interface.
5. Make and save any required configuration changes. These changes will be applied to the router the next time it connects to ALMS.

For more information, refer to the following resources:

- AirLink RX400 and EX400 Hardware User Guide available from source.sierrawireless.com
- AirLink OS User Guide available at source.sierrawireless.com/airlinkos

Create an ALMS account at www.sierrawireless.com/products-and-solutions/routers-gateways/alms/register/

SEMTECH CONTACT INFORMATION

Sales information and technical support:

www.sierrawireless.com/company/contact-us/
(including warranty and returns)

Global toll-free number: 1-877-687-7795

Corporate and product information:

www.sierrawireless.com