

AirLink[®] LS300 Quick Start Guide



This guide provides instructions for quickly getting your Sierra Wireless[®] AirLink[®] LS300 gateway configured and connected. For more information refer to the:

- AirLink LS300 Hardware User Guide
- ALEOS[®] Software Configuration User Guide

Both are available for download from the Sierra Wireless web site (source.sierrawireless.com).

STEP 1 Install the SIM Card (Does Not Apply to CDMA Gateways)

1. Remove the rear panel access cover.
2. Slide the SIM card into the SIM card holder.
Note the location of the notched corner for correct alignment.
3. Re-attach the cover.

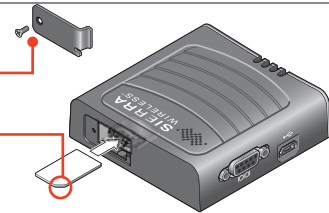

STEP 2 Connect and Turn On the Gateway

NOTE: If you want to configure all your gateways at the same time using AirLink Management Service, follow the instructions on page 2 to register your gateways **before** applying power.

1. Connect the RF antenna.
2. If required, connect the GPS and/or the diversity antenna (recommended).
3. Connect the power cable to the gateway and apply power. The gateway starts automatically, as indicated by the flashing LEDs.
4. After applying power, connect a Windows[®] computer to the gateway with an Ethernet cable. If required by your application, connect the RS-232 port and/or the USB port.



AirLink[®] LS300 Quick Start Guide



STEP 3 Connect to the Network

The first time you power up the gateway on its home network, it automatically begins the activation/provisioning process and attempts to connect to the network. This process typically takes 5–10 minutes. A successful connection is indicated by a solid green Network LED. If the gateway does not automatically connect to the network, refer to the ALEOS Software Configuration User Guide (WAN/Cellular chapter).

STEP 4 Connect to ACEmanager™

1. On a Windows computer connected to the LS300, enter **http://192.168.13.31:9191** in the web browser. The ACEmanager login screen appears.
NOTE: It may take the gateway 2–3 minutes to respond after the initial power up.
2. The administrator user name is entered by default. Enter the default password **12345** and click Login. The Status > Home screen appears.
3. Check the Network State field. It should read Network Ready, which indicates the gateway is connected to the network. If not, see STEP 3 above.
4. On the Status > Home screen, note the ALEOS Software Version. Go to **source.sierrawireless.com** to check the available versions of ALEOS. If there is a newer version available, download it and follow the instructions in the ALEOS Software Configuration User Guide to update ALEOS on the LS300 gateway.
You are now ready to use ACEmanager to configure your gateway (if your setup requires additional configuration). Refer to the ALEOS Software Configuration User Guide for detailed information.

STEP 5 Connect to AirLink Management Service (Optional)

You can remotely configure and monitor all your gateways at the same time with AirLink Management Service (ALMS), Powered by AirVantage.

NOTE: An ALMS account is required.

1. Using a web browser, log into your ALMS account.
If you don't have an ALMS account, visit **www.sierrawireless.com/ALMS** for information on setting one up.
2. If you have not already done so, register your gateways by following the instructions on the registration page.
3. Apply power to all your gateways. ALMS completes the registration on power up.
You are now ready to use ALMS to configure your gateways.

Sierra Wireless Contact Information

AirLink Sales

AirLinkSales@sierrawireless.com

AirLink Support

Please contact your AirLink Reseller for technical support.

AirLink Technical Information

source.sierrawireless.com