

**TABLE OF CONTENTS**

CHAP.	PAGE	PAGE
1.0 INTRODUCTION.....	1	3.0 SPARE PARTS..... 2
1.1 WARRANTY AND RESPONSABILITIES	1	3.1 TECHNICAL ASSISTANCE ..... 2
1.2 OBJECTIVES OF CONTENTS.....	1	3.2 TECHNICAL DETAILS ..... 2
1.3 CONSERVATION.....	1	4.0 ABRASIVE BELT CHANGING..... 3
2.0 GENERALES INFORMATIONS .....	2	5.0 INSTALLATION DETAILS..... 3
2.1 DISTRIBUTOR INFORMATIONS .....	2	6.0 USING TECHNICS ..... 3
2.2 REFERENCES.....	2	

## Sanding Belt Holder for lathes

### 1.0 INTRODUCTION

A tool for sanding and deburring on conventional lathes. Indeed, you can sand and debur without the direct use of hands (for safety). The tool is fixed to the existing toolpost of the conventional lathes. It allows sanding operations of metal parts, alloy and wood. A manually operated crank allows rotation of the abrasive belt (this index is needed for a more efficient sanding). This tool is designed to fit the different diameters of parts sanded. It also allows quick change abrasive belt (details 4.0).

### 1.1 Warranty and Responsibilities limits

Subject to the following, Montfort International Ltd. warrants parts, accessories and components of each new equipment against failure resulting from a defect in workmanship or material in a proper and normal use for a period of one year starting on the date of delivery of said machine. The equipment is sold only with the warranties offered by the manufacturer. The buyer is responsible for installation and use in accordance with the manufacturer's instructions.

The only obligation of Montfort International under such warranty is limited to replacement without charge of the part or component of the equipment. Transport, travel and labor are not included. Any part or product that a return and / or warranty claim is subject to inspection and evaluation of our quality control department will confirm that the product was used in a normal usage context. Is excluded any product and part that is modified, use, installation, and improper handling or abuse. This warranty does not cover normal wear and maintenance items (exp. Abrasive belt).

The above warranty is the only express or implied exclusive, provided by the seller replace all other warranties, of some kind, contractual, legal, regulatory or otherwise, for the purpose of merchantability, quality, compatibility or otherwise. The seller's liability will in no event exceed the purchase price of the products. In no event shall the seller (including, if applicable, its subsidiaries and its parent company and its shareholders, directors, officers, employees, partners and subcontractors) can not be held liable to the buyer or any third party for any indirect, incidental, punitive or exemplary damages, as without limitation any loss of profits or other economic loss, including without limiting the foregoing, regarding the performance of equipment or products acquired by purchaser.

### 1.2 OBJECTIVES OF CONTENTS

The purpose of this document is not simply to provide instructions on the operation and equipment, but mainly to ensure that the work of the operator can be conducted safely. It contains information on the technical aspects, operation, maintenance, spare parts. The instructions are an integral part of the safety equipment. This document is essential for the proper use of the product and must at all times be available for immediate consultation. This document should not in any case be duplicated, reproduced or transmitted electronically or by photography, without the prior permission of the manufacturer / distributor. If in doubt regarding the interpretation of the instructions, refer to the manufacturer or distributor to obtain the necessary clarifications. All operations that require assembly or disassembly of parts must be assigned to qualified personnel.

### 1.3 CONSERVATION

The instruction manual should be keep close to the machine and, above all, protected against liquid and any other items that might reduce readability.

## 2.0 GENERALES INFORMATIONS

### 2.1 DISTRIBUTOR INFORMATIONS

PRISMONT, a division of **Montfort International Ltée.** 850 Boul. Pierre-Bertrand, bureau 360, Qc, Canada, G1M 3K8 Tél : 418-877-0778

### 2.2 REFERENCE

The design of this tool is based on the standard EN.12840-2001 & ISO 23125:2010

No manual operation, for example **SANDING** and / or **FILING** must be performed on a moving part.

### 3.0 Spare parts

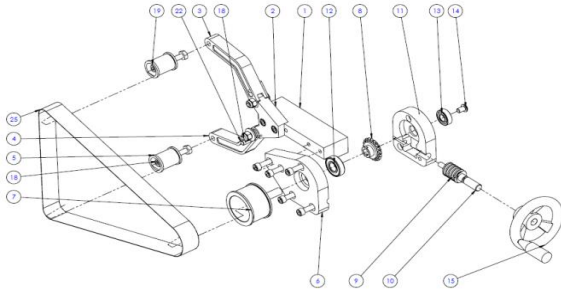

No. ARTICLE	NUMERO DE PIECE	DESCRIPTION	QTE	
1		Support porte outil	1	
2		Support des bras	1	
3		Bras	Bras supérieur	1
4		Bras	Bras inférieur	1
5		Roue pression	2	
6		Support roue principale	1	
7		Roue menante	1	
8		Worm gear	1	
9		Worm	1	
10		Shaft du worm	1	
11		Boitier roue principale	1	
12		Roulement à bille	1	
13		Roulement à bille	1	
15		marivette	1	
21		Spacer ressort	2	
22		Block ressort	1	
25		Coumole sablé 1 X 30	1	
26		Block bras haut	1	

### 3.1 TECHNICAL ASSISTANCE

Contact directly your supplier or technical service that can provide you with the information necessary for identification of the tool.

Serial number and date of purchase

### 3.2 TECHNICAL DETAILS

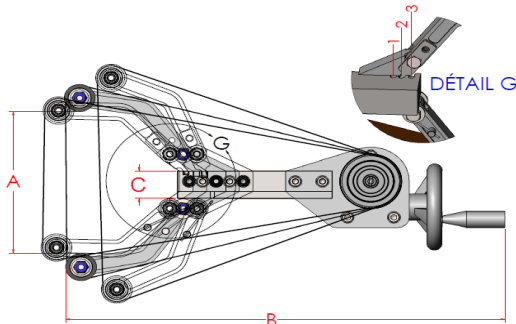

SBH1.0	Max.Ø	A	B	C	Belt
1	6 3/16"	6 3/16"	13 1/4"	3/4"	1" X 30"
2	4 3/4"	4 3/4"	14"	3/4"	1" X 30"
3	3 5/8"	3 5/8"	14 1/4"	3/4"	1" X 30"

SBH2.0	Max.Ø	A	B	C	Belt
1	8 5/8"	8 5/8"	14 5/8"	1"	2" X 36"
2	7 1/4"	7 1/4"	15 5/8"	1"	2" X 36"
3	6 5/32"	6 5/32"	16 3/8"	1"	2" X 36"

SBH4.0	Max.Ø	A	B	C	Belt
1	16 5/8"	16 5/8"	14 3/8"	1"	4" X 54"
2	14 7/8"	14 7/8"	19 1/8"	1"	4" X 54"
3	13 1/2"	13 1/2"	20 3/8"	1"	4" X 54"

NOTE! We hereby certify the equipment listed above has been manufactured according



## 4.0 CHANGING THE ABRASIVE BELT

**Warning!** The machine must be stopped during this operation.

For changing the abrasive belt. Simply lift the lower arm (Fig 4.2) and remove it (Fig 4.3). Then reposition the new strip and gently release the arm.



Initial position



Lift the lower bar



Remove strip

## 5.0 INSTALLATION

**Warning!** The machine must be stopped during this operation.

Position on the movable carriage of the machine tool holder (Fig 5.1). Then attach securely to the transverse instrumentation platform (Fig 5.3).



Position on the tool post



Screw firmly



Correct position

## 6.0 USE

The initial position (Fig 6.1), then start the turn counterclockwise (for normal processing) and gently close the abrasive belt finally get working position as illustrated in (Fig 6.2) Then turn slowly the handle to index the abrasive belt as needed.



Initial position



Working position

### **WARNING!**

It is strictly forbidden, by the manufacturer and OSHA standards, using any electrical appliance to accelerate the rotation of the abrasive belt. Only the use of the handle by the operator is permitted. All other ways may violate a security operator.