

DETAIL AT BASE—PROJECT SPECIFIC

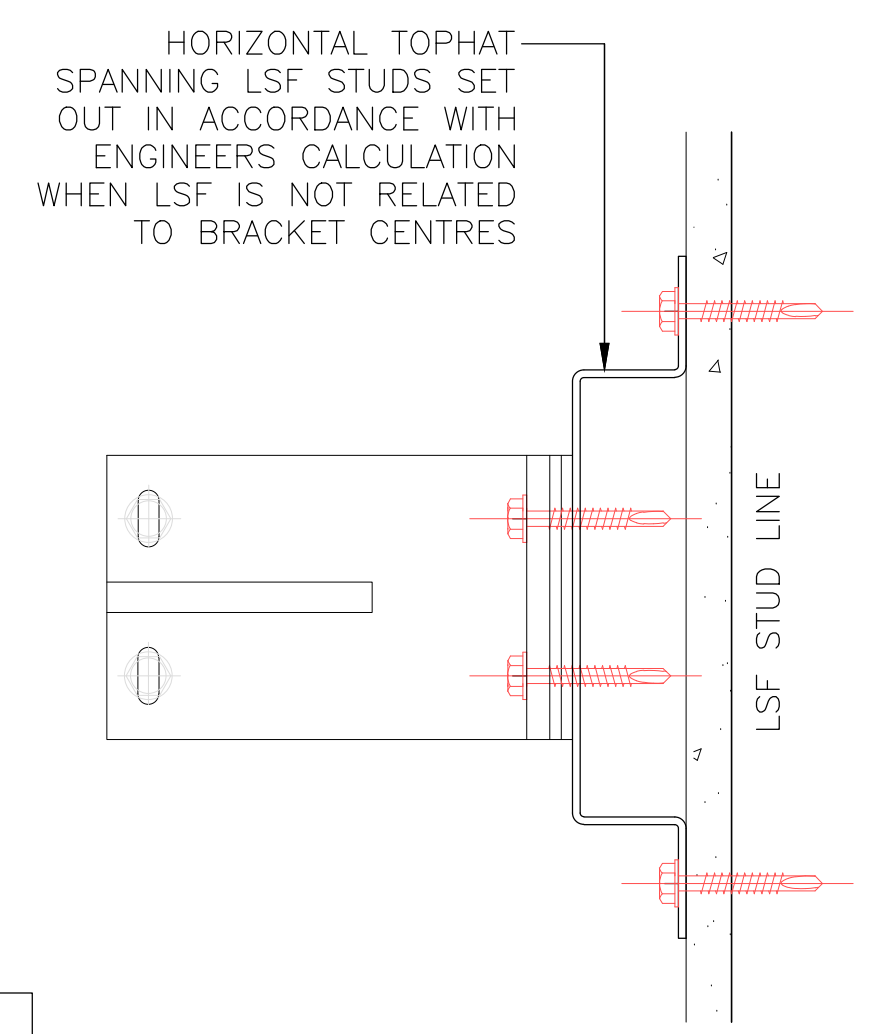

FIG. 1

TO BE READ IN CONJUNCTION WITH PROJECT SPECIFIC ENGINEER CALCULATIONS TO CONFIRM LOCATIONS

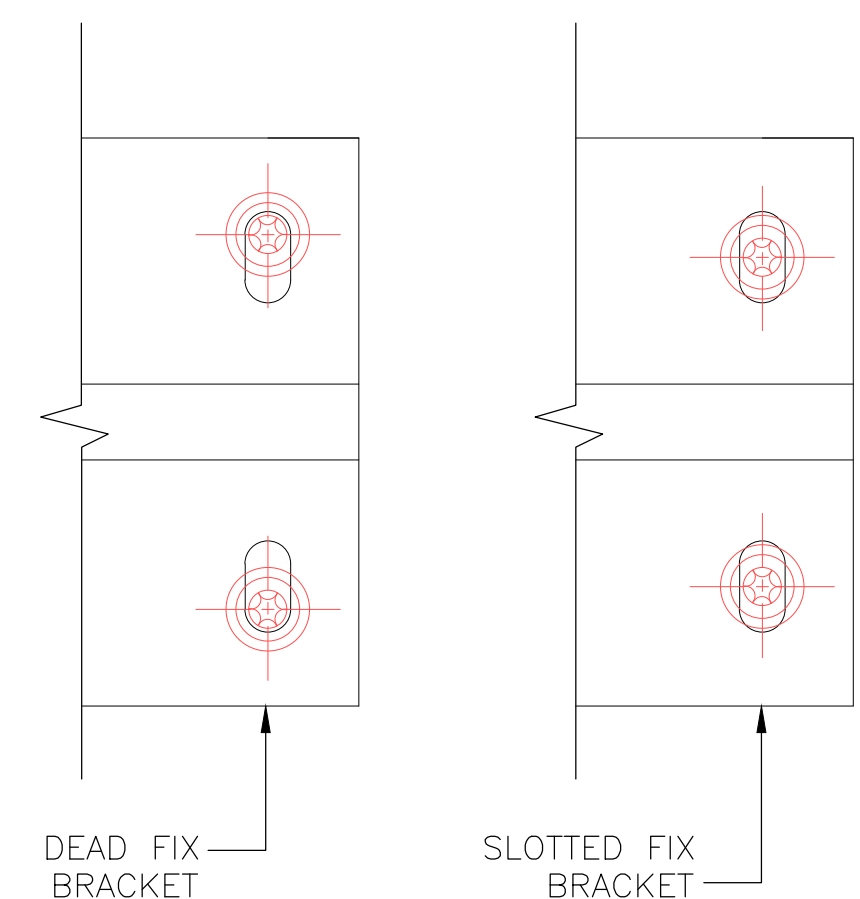

FIG. 2

DETAIL LEGEND:		Site Location Plan:	
01	3mm THICK .75/150mm DEEP ALUMINIUM HELPING HAND BRACKET & BACKING PLATE FIXED TO STRUCTURE (SEE ALTERNATIVE FIXING DETAIL FIG. 1). SETOUT IN ACCORDANCE WITH ENGINEERS CALCULATIONS DEAD FIXED OR SLIDING BRACKET (FIG.2) LOCATIONS TBA BY ENGINEER AS PROJECT SPECIFIC		
02	THERMAL ISOLATION PAD		
03	2.2mm 125x60mm EXTRUDED 'T' OR 3mm 50x50mm 'L' RAIL MILL FINISHED AS STANDARD PPC IF REQUIRED <COLOUR / FINISH>	General Notes: 1. All details to be read in conjunction with H92 Specification and engineers project specific calculations. 2. Tenmat open state horizontal cavity barriers are tested to the requirements of TGD19. Tenmat closed state vertical cavity barriers are tested to the requirements of EN 1366-4. Please contact Tenmat directly for 3rd party classification or field of application reports.	
04	BREATHER MEMBRANE, FIXED IN ACCORDANCE WITH MANUFACTURERS RECOMMENDATIONS		
05	GENERIX GENBRIX EXTRUDED ALUMINIUM TRAY		
06	LOW PROFILE 5.5 TEK SCREW (STAINLESS STEEL)		
07	10mm MORTAR JOINT		
08	NON COMBUSTIBLE INSULATION AS PER PROJECT SPECIFICATION		
09	5.5 TEK SCREW (STAINLESS STEEL)		
10	CEMENT PARTICLE BOARD/ CALCIUM SILICATE BOARD, FIXED IN ACCORDANCE WITH MANUFACTURERS RECOMMENDATIONS		
11	LIGHTWEIGHT STEEL FRAME SET OUT IN ACCORDANCE WITH ENGINEERS CALCULATION		
12	GENERIX GENBRIX BRICK SLIP		
13	FLASHING		
14	INTERNAL FINISHES		
15	38x5.5mm STAINLESS STEEL TEK SCREWS OR SIMILAR APPROVED BY STRUCTURAL ENGINEER		
16	VAPOUR CONTROL LAYER FIXED IN ACCORDANCE WITH MANUFACTURERS RECOMMENDATIONS		
17	EPDM by OTHERS		
DRAWING DESIGN AND SPECIFICATION REMAINS THE PROPERTY OF GENERIX.			
Rev	By:	Date:	Description
A		00.00.00 10.02.21	00.00.00 FIRE BARRIERS INDICATED
18	ALUMINIUM WINDOW POD OR REVEAL FLASHING		
19	WINDOW/ DOOR FIXING AND SEALING BY APPOINTED SUB-CONTRACTOR		
20	2mm CORNER SUPPORT ANGLE		
21	1mm VERMIN MESH		
22	COPING AND SUPPORT BRACKET		
23	LOW PROFILE RIVET		
24	PLYWOOD		
25	TENMAT NVFB VERTICAL FIRE BARRIER.		
26	TENMAT-VFB PLUS HORIZONTAL CAVITY BARRIER		
27	TENMAT NVFB HORIZONTAL FIRE BARRIER TO WINDOW CILL OR HEAD OF WALL AS REQUIRED.		
Client:			
Project Name and Address:		GENERIX GENBRIX STANDARD DETAILS	
Drawing Title:		GENERIX GENBRIX CORBEL DETAIL	
Drawn by			
Drawing Date			
Checked by			
Checked Date			
Scale			
Sheet			
Drawing Status			
Drawing Reference			GENBRIX-D-09

