

DETAIL AT BASE—PROJECT SPECIFIC

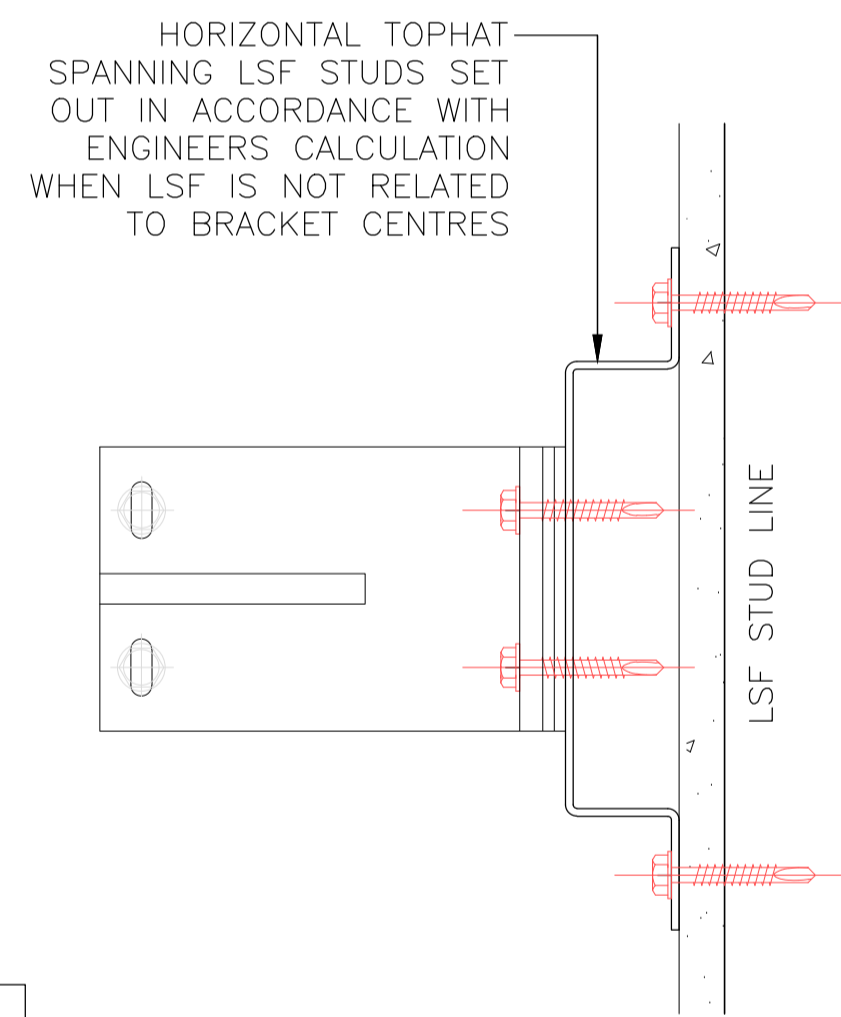

FIG. 1

TO BE READ IN CONJUNCTION WITH PROJECT SPECIFIC ENGINEER CALCULATIONS TO CONFIRM LOCATIONS

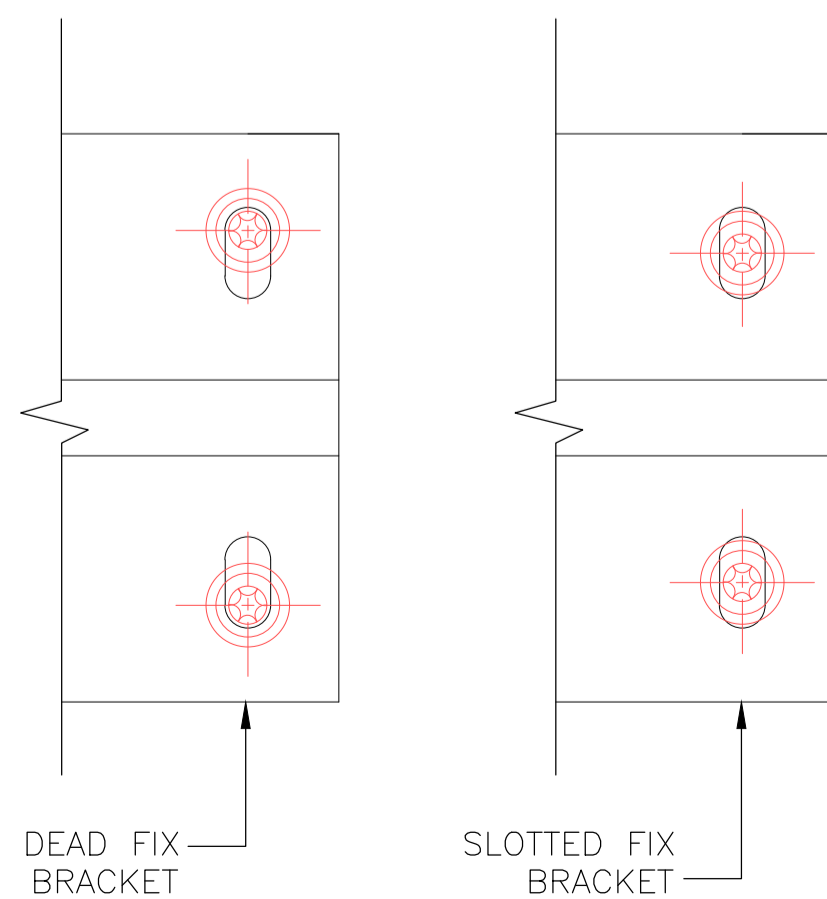

FIG. 2

DETAIL LEGEND:	
01	3mm THICK .75/150mm DEEP ALUMINIUM HELPING HAND BRACKET & BACKING PLATE FIXED TO STRUCTURE (SEE ALTERNATIVE FIXING DETAIL FIG. 1), SETOUT IN ACCORDANCE WITH ENGINEERS CALCULATIONS DEAD FIXED OR SLIDING BRACKET (FIG.2) LOCATIONS TBA BY ENGINEER AS PROJECT SPECIFIC
02	THERMAL ISOLATION PAD
03	2.2mm 125x60mm EXTRUDED 'T' OR 3mm 50x50mm 'L' RAIL MILL FINISHED AS STANDARD PPC IF REQUIRED <COLOUR / FINISH>
04	BREATHER MEMBRANE, FIXED IN ACCORDANCE WITH MANUFACTURERS RECOMMENDATIONS
05	GENERIX GENBRIX EXTRUDED ALUMINIUM TRAY
06	LOW PROFILE 5.5 TEK SCREW (STAINLESS STEEL)
07	10mm MORTAR JOINT
08	NON COMBUSTIBLE INSULATION AS PER PROJECT SPECIFICATION
09	5.5 TEK SCREW (STAINLESS STEEL)
10	CEMENT PARTICLE BOARD/ CALCIUM SILICATE BOARD, FIXED IN ACCORDANCE WITH MANUFACTURERS RECOMMENDATIONS
11	LIGHTWEIGHT STEEL FRAME SET OUT IN ACCORDANCE WITH ENGINEERS CALCULATION
12	GENERIX GENBRIX BRICK SLIP
13	FLASHING
14	INTERNAL FINISHES
15	38x5.5mm STAINLESS STEEL TEK SCREWS OR SIMILAR APPROVED BY STRUCTURAL ENGINEER
16	VAPOUR CONTROL LAYER FIXED IN ACCORDANCE WITH MANUFACTURERS RECOMMENDATIONS
17	EPDM by OTHERS
18	ALUMINIUM WINDOW POD OR REVEAL FLASHING
19	WINDOW/ DOOR FIXING AND SEALING BY APPOINTED SUB-CONTRACTOR
20	2mm CORNER SUPPORT ANGLE
21	1mm VERMIN MESH
22	COPING AND SUPPORT BRACKET
23	LOW PROFILE RIVET
24	PLYWOOD
25	TENMAT NVFB VERTICAL FIRE BARRIER.
26	TENMAT-VFB PLUS HORIZONTAL CAVITY BARRIER
27	TENMAT NVFB HORIZONTAL FIRE BARRIER TO WINDOW CILL OR HEAD OF WALL AS REQUIRED.

Site Location Plan:

General Notes:
 1. All details to be read in conjunction with H92 Specification and engineers project specific calculations.
 2. Tenmat open state horizontal cavity barriers are tested to the requirements of TGD19. Tenmat closed state vertical cavity barriers are tested to the requirements of EN 1366-4. Please contact Tenmat directly for 3rd party classification or field of application reports.

DRAWING DESIGN AND SPECIFICATION REMAINS THE PROPERTY OF GENERIX.

Rev	By:	Date:	Description
A		00.00.00 10.02.21	00.00.00 FIRE BARRIERS INDICATED

Client:

 Project Name and Address:
 GENERIX GENBRIX STANDARD DETAILS

 Drawing Title:
 GENERIX GENBRIX BASE DETAIL

Drawn by	
Drawing Date	
Checked by	
Checked Date	
Scale	
Sheet	
Drawing Status	
Drawing Reference	GENBRIX-D-08

