

## INSTALLATION GUIDE - GEMINI & MINISLATE MECHANICALLY FIXED VERGE

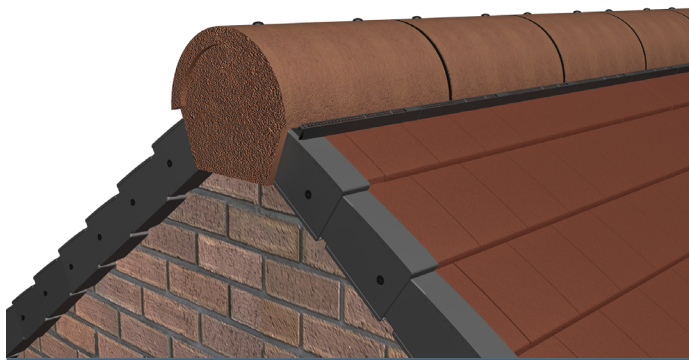

The Gemini & Minislate Verge system has been specifically designed to replace traditional mortar bedded verge while also providing a second mechanical fixing to the perimeter tiles.

- 1) Fix Battens and underlay in accordance with BS 5534. Cut the underlay 20mm beyond the gable end and fold down against the outside of the gable end surface ensuring that the felt is not pulled taught.
- 2) Fix tiling battens, ensuring that the battens finish maximum +/- 10mm from the face of the gable. Lift the tile batten and insert a Batten end spacer bracket onto the end of each tile batten until the bracket legs make contact with the gable end surface. Fix with two 20mm stainless steel nails provided. (See picture 1)

**Note:** Insert the batten spacer brackets before fully fixing the batten into place.

When laying tiles ensure they overhang the outside of the gable structure by 30-35mm



Picture 1

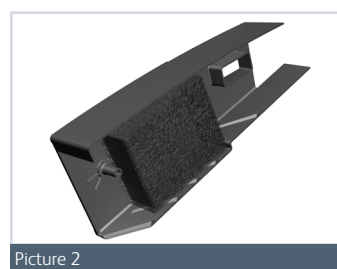

Picture 2

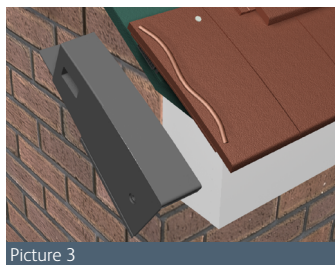

Picture 3

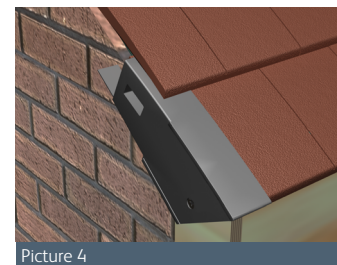

Picture 4

- 3) For the eaves course only, carefully peel the backing paper off the back of the foam block to expose the adhesive. Stick into place behind the round spigot position and to the base of the verge unit, press down firmly to make an eaves stop end unit. (See picture 2)

To secure an additional fixing of the eaves stop end unit, pipe a bead of suitable exterior flexible waterproof mastic onto the face of the eaves verge tile under the verge unit. (See picture 3)

Position the prepared eaves stop end unit over the side of the eaves course so that it makes contact with the bottom edge of the tile and ensure the unit is fully fixed. The face of the verge unit must be vertical and not sloping inwards/outwards. (Picture 4)

Fix the second verge unit in place through the spigot hole with a 38mm coloured stainless steel screw provided.

- 4) Continue installing verge units up the verge, repeating the process described above. (Picture 5)
- 5) At the apex of the roof where the verge units meet, carefully mark and cut off the excess to form an effective bird stop. (See picture 6)
- 6) Cover the apex detail with a Ibstock Nail Holed Block End Ridge closely fitted to the face of the mechanically fixed verge unit.

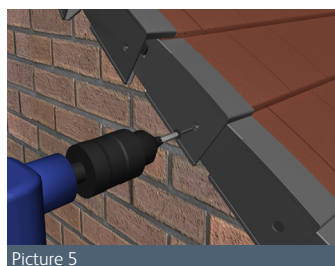

Picture 5

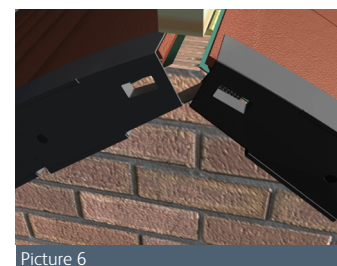

Picture 6

## INSTALLATION GUIDE - GEMINI & MINISLATE MECHANICALLY FIXED VERGE

### Important Notes:

- Tighten until the screw secures the verge unit in place. Do not attempt to overtighten.
- Do not attempt to install the Mechanically Fixed Verge system without using the Batten End Spacer Brackets. This will significantly compromise the performance of the product.
- This product is not suitable for use with uneven wall surfaces or raked cut verges.
- The purpose of this mechanically fixed verge system is to replace traditional mortar bedded verges and not to act as a gutter system or control rainwater discharge.
- All tiles are to be fixed in accordance with Ibstock Fixing Specification, BS: 5534 and BS: 8000.

### Mechanically Fixed Verge Components

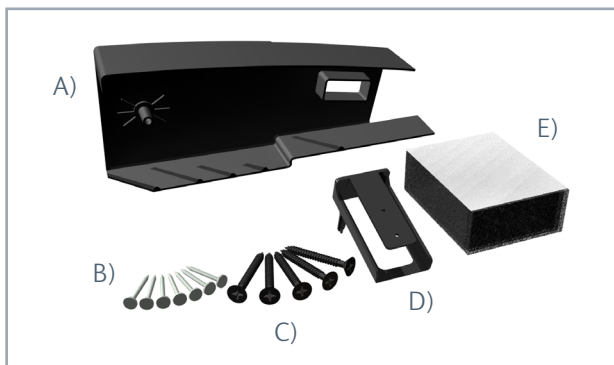

#### Verge Continuation Packs (2.625 - 2.925 linear metres)

- A) 15 no. Verge units (handed packs)
- B) 30 no. 3.35mm x 20mm batten end spacer bracket nails
- C) 15 no. 38mm coloured stainless steel screws
- D) 15 no. Batten end spacer brackets
- E) 1 no. Foam stop end block (for eaves unit only)

Colours available - Grey, Brown, Red & Rustic

Conforms to the requirements of BS:8612

Plastic Type: Polypropylene