



# APPLICATION & CONSTRUCTION

## IBSTOCK VENT BRICK LAYING AND HANDLING GUIDELINES

Ibstock Vent Bricks are a modification to a standard clay facing brick for the purpose of providing ventilation in the fabric of buildings resulting in a finish to complement surrounding brickwork.

Vent Bricks differ from standard Airbricks as they are not formed with voids, but have them retrospectively cut into the brick by a state of the art water jet cutting system. By forming them in this manner products are not intended to conform to 'BS 493: Specification for airbricks and gratings for wall ventilation', but are produced to 'EN 771-1: Specification for clay masonry' with a further modification.

Before cutting, any existing voids in the brick are filled with hard setting mortar rendering them solid before the desired aperture size and shape is cut.

A range of finishes in Ibstock clay facings or Forticrete reconstituted stone are available and requirements should be discussed with one of Ibstock's Area Design Advisors.

The finished product should be laid with the fair face outermost in a designation (i) or (ii) mortar, dependent on chosen brick type, for units below dpc. Mortar for units above dpc can be laid as per surrounding

brickwork. Clay brick heights are available in standard 65mm plus various imperials sizes and are 50mm deep (reduced from 102mm) to allow for the incorporation of a cavity sleeve if required. Forticrete blocks are recessed behind the aperture to allow a standard sized cavity sleeve but are the full 102mm depth otherwise.

For under floor ventilation vent bricks should be at least one full course above ground level but below the dpc.

If inserting Vent Bricks above the dpc a cavity tray must be fitted to shed moisture effectively.

### 215 ROUND

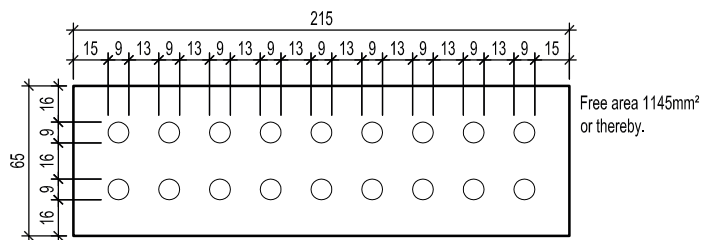

### 215 FOUR SLOTTED SQUARE

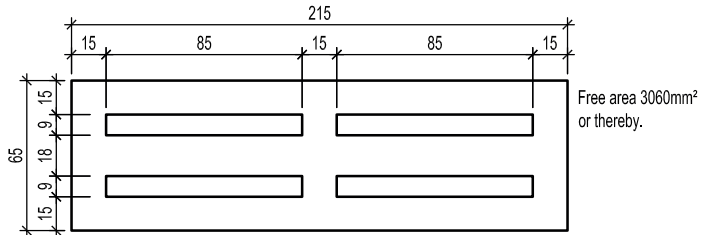

### 215 SLOTTED ROUND

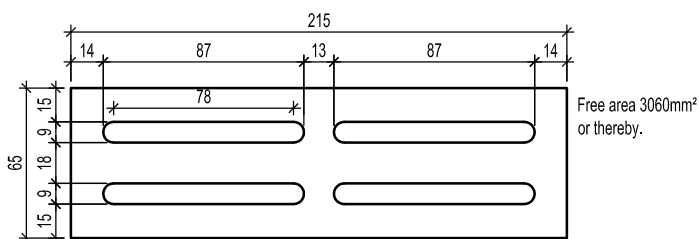

### 215 SQUARE

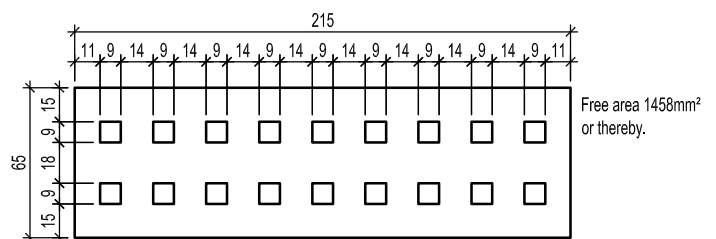



## APPLICATION & CONSTRUCTION

# IBSTOCK VENT BRICK LAYING AND HANDLING GUIDELINES

### 215 MULTIPLE ROUND

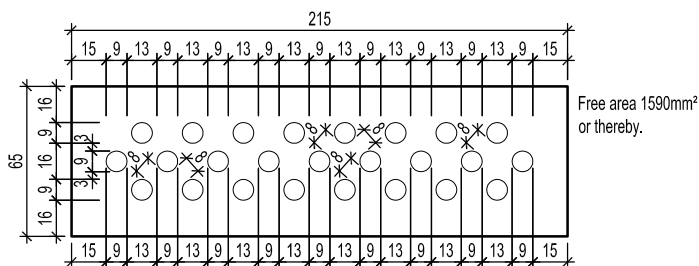

### DOUBLE COURSE ASSEMBLY 215 X 140 (SQUARE HOLE SHOWN)

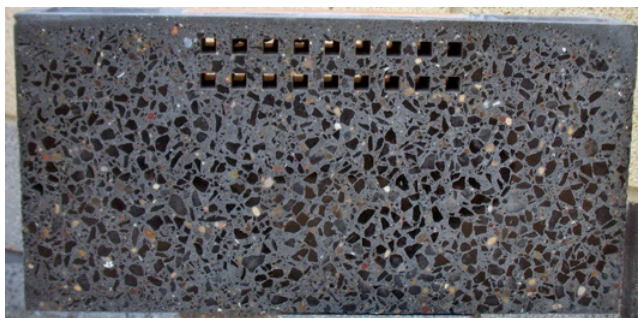
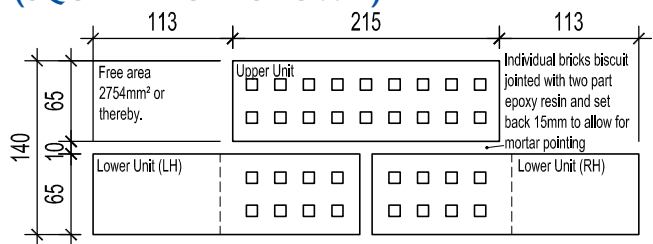

Examples of  
Forticrete  
Medici and  
Anstone Pitched  
Walling Stone.

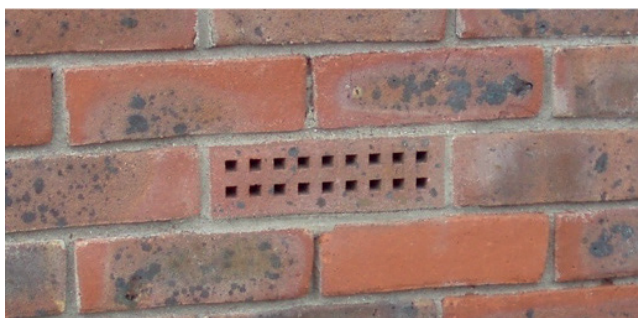

Examples of  
square hole.

Although the instructions contained in this publication and any other information published by Ibstock Brick Ltd are believed to be accurate at the date of publication, they are strictly for guidance only and Ibstock Brick Ltd accepts no liability in relation to their use or for any losses, howsoever caused. You are responsible for taking all reasonable steps to ensure your use of the product conforms to all applicable health and safety requirements from time to time. If in doubt, please consult appropriately qualified persons. All products sold by Ibstock are sold subject to Ibstock's Terms and Conditions of Sale, a copy of which is available on request.