

Chapter 9

Easements

© Christine A. Klein, *Property* (2d edition 2020)

For professors use only – *not* for distribution to students.

Do not distribute without permission.

Estate of Thomson v. Wade (p. 520)

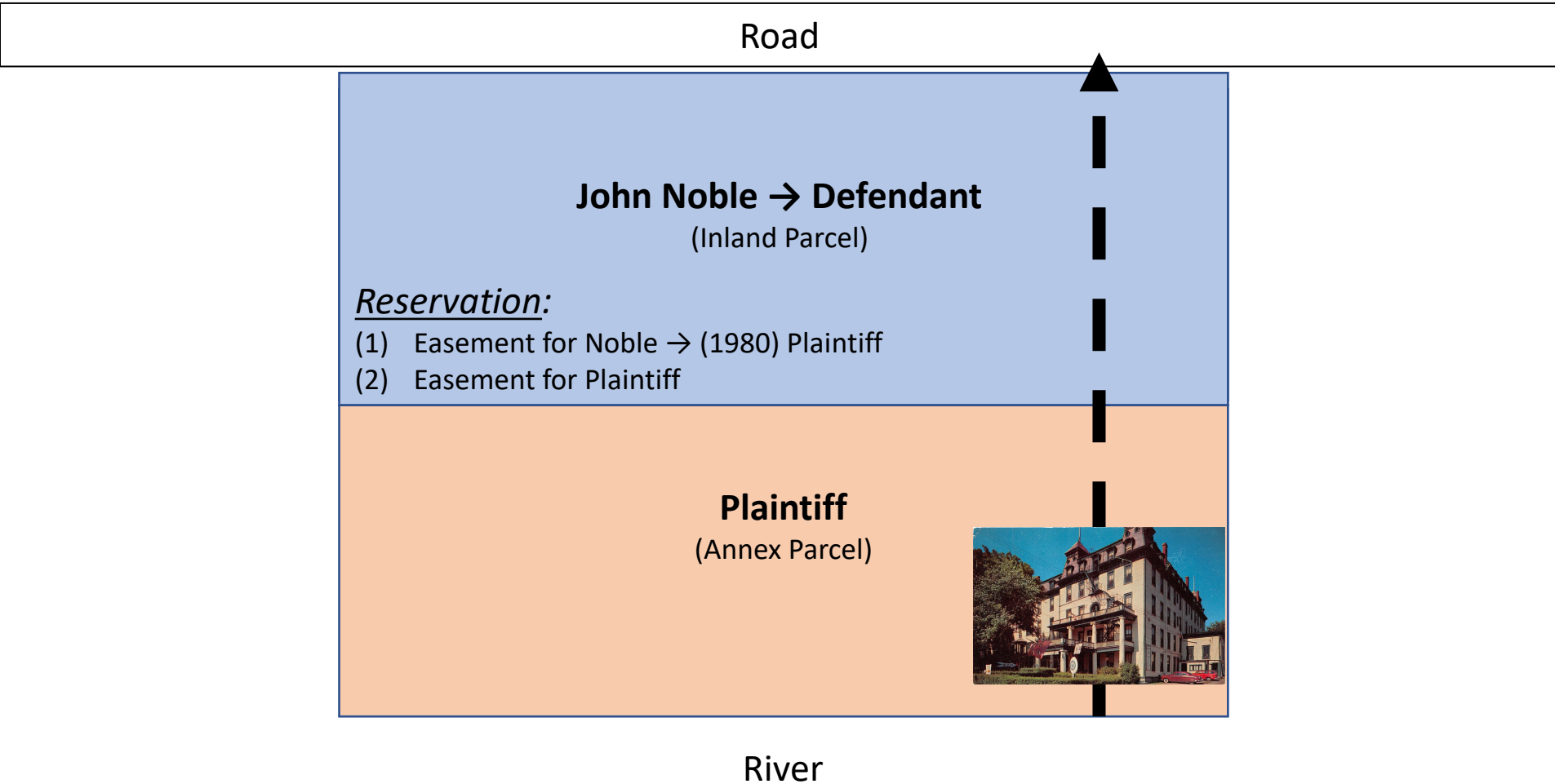

Sunday Drivers (p. 524)

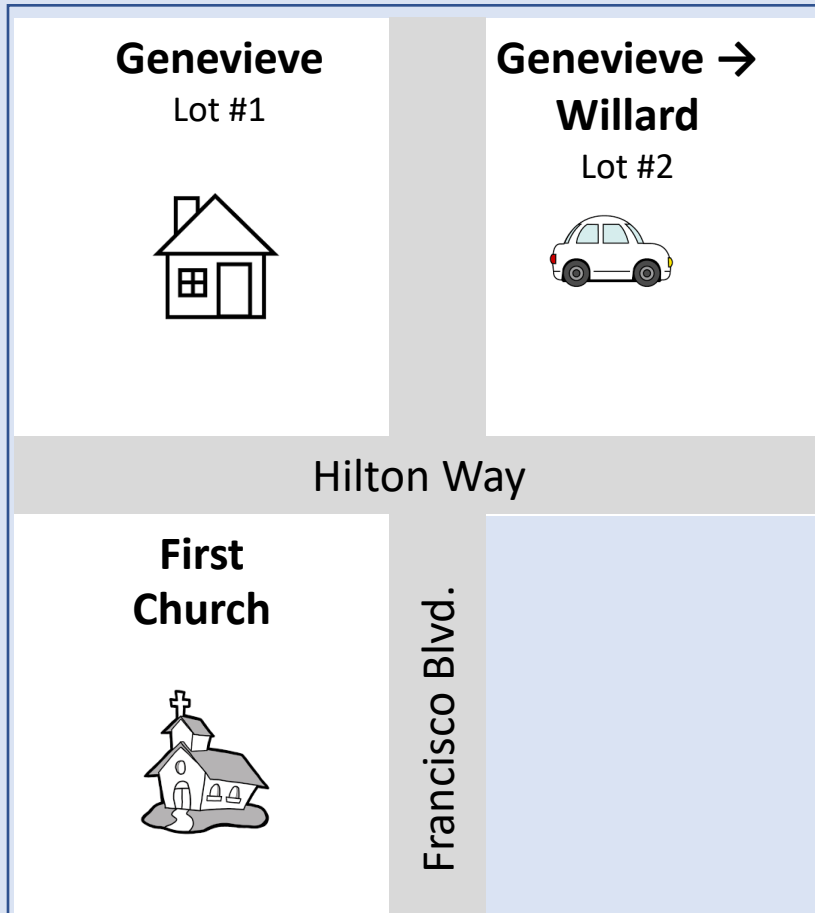

- Lot #2: "To Willard, *subject to* an easement for automobile parking during church hours for the benefit of the church at the SW corner of Hilton & Francisco."
- Question 1: Would the church's easement be appurtenant or in gross?
- Question 2: Redraft clearly each way.
- Question 3: Would the church's easement be valid under the *stranger-to-the-deed* rule?

Daytona Beach v. Tona-Rama

(p. 532)

- Who owns the beach?
- Who has the right to use the beach?



