

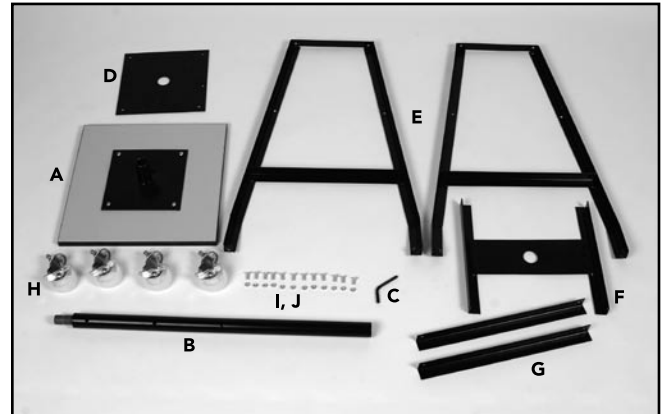

Please open box, take out all pieces and check for damage before beginning assembly.



Parts

- | | |
|-----------------------------------|---------------------------|
| A. 1 - Melamine Sculpting Surface | F. 1 - Middle Support |
| B. 1 - Center Post | G. 2 - Lower Support Bars |
| C. 1 - Adjusting Pin | H. 4 - Plastic Wheels |
| D. 1 - Top Plate | I. 12 - 3/4" Bolts |
| E. 2 - Side Legs | J. 12 - 7/16" Nuts |



Step 1

Step One:
Loosely assemble Side Legs (E), Top Plate (D) and Middle Support (F) using 8 nuts and bolts.



Step 2

Step Two:
Attach 2 Lower Support Bars (G) using 4 nuts and bolts.



Step 3

Step Three:
Tighten previously assembled parts. Attach Wheels (H) and wheel bolts through fixed nuts in Side Legs (E). Leave adjusting nuts on Wheels when assembling as shown in the closeup photo.

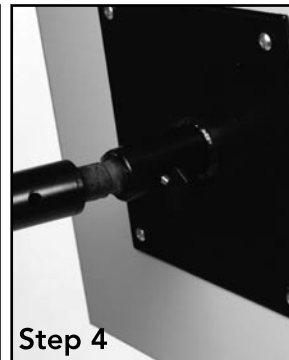

Step 4

Step Four:
Attach Melamine Sculpting Surface (A) to Center Post (B) locking in place with set screw.



Step 5

Step Five:
Insert Adjusting Pin (C) at desired level.

NOTE: The weight limit for this sculpture stand is 250lb. DO NOT EXCEED this limit.