

Mildura Riverside

MURRAY RIVER, VIC

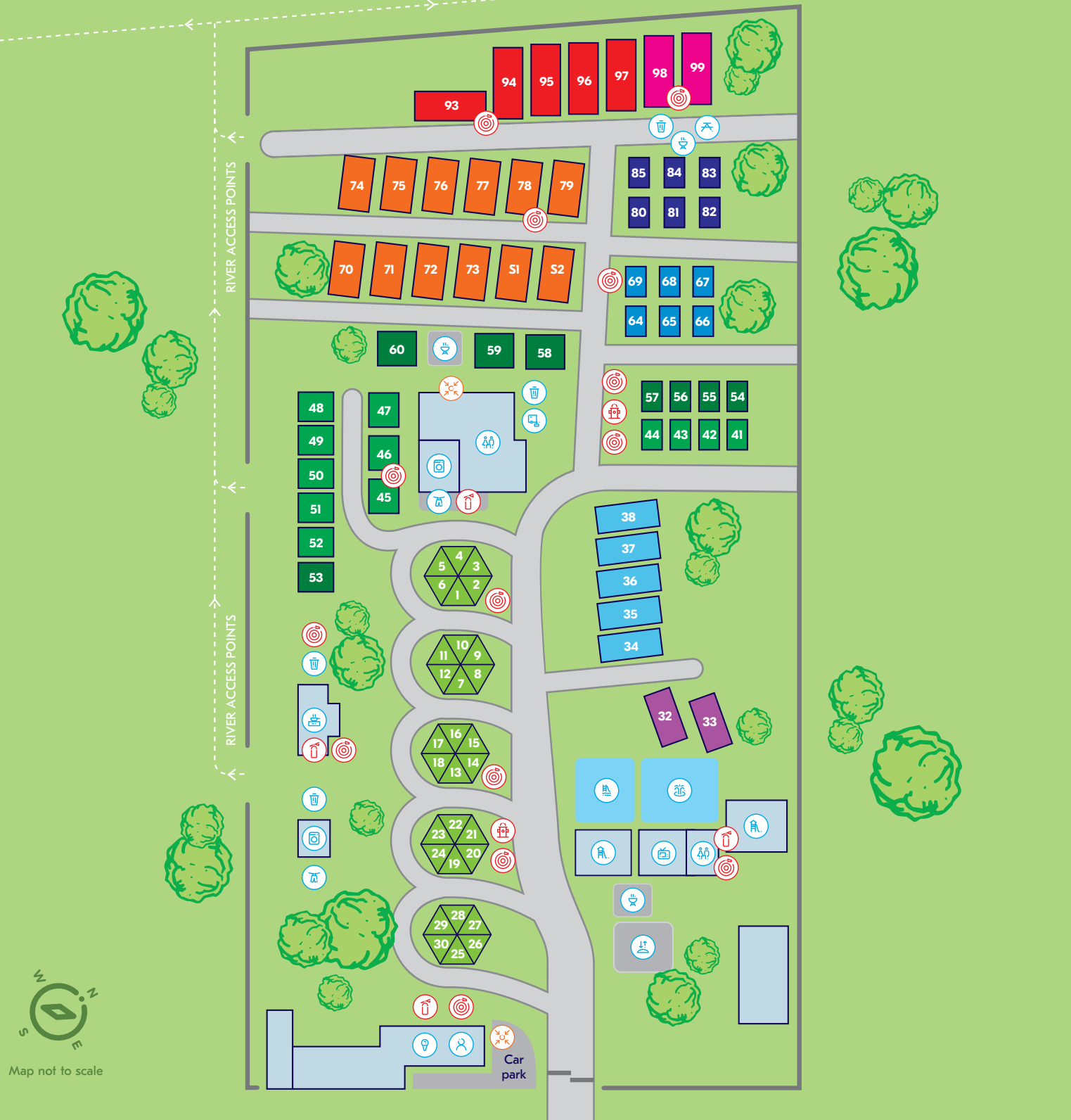

Camping

- Ensuite powered site
- Powered grass site
- Powered slab site

Accommodation

- 2 Bedroom superior cabin
- 3 Bedroom family cabin
- Budget cabin
- 2 Bedroom Cabin Pet Friendly
- 3 Bedroom superior cabin
- 2 Bedroom family cabin
- 2 Bedroom cabin

Facilities

- | | | | | | | |
|-------------|-------------------|-----------------|------------------|-------------------|---------------------|----------------------------|
| Ⓜ Amenities | Ⓜ BBQ | Ⓜ Waterslide | Ⓜ Camp kitchen | Ⓜ Bouncing pillow | Ⓜ Fire extinguisher | Ⓜ Fire hydrant |
| Ⓜ Laundry | Ⓜ Recreation room | Ⓜ Swimming pool | Ⓜ Clothesline | | Ⓜ Fire hose reel | Ⓜ Evacuation meeting point |
| Ⓜ Kiosk | Ⓜ Playground | Ⓜ Dump point | Ⓜ Refuse station | | | |

Guest information welcome, please enjoy your stay

Welcome to NRMA Mildura Riverside Holiday Park.

Here's some basic information about your stay. For anything not covered here, please come see us at reception. We'd appreciate it if you observe the park rules displayed around the property and follow directions from Management, so everyone can have a pleasant and safe time.

Arrival/Departure Check in is available from 2pm on the day of your scheduled arrival, unless you've made prior arrangements with us. All rooms/sites need to be vacated by 10 am on the day of your departure. If you'd like to check out before reception opens or extend your stay, please come see us at reception and we'll be happy to help.

Amenities Amenities blocks are located throughout the property. Please see the map provided for locations. Children under 12 years of age must be accompanied by an adult and supervised at all times. Please consider others when using these facilities and leave them in a neat and tidy condition. Facilities are cleaned daily and the cleaning times are displayed at the entrance to each block.

BBQ areas Guest BBQ areas are available throughout the property for your enjoyment and are marked on the park map. Please remember to leave the area clean after use and please note that open fires are prohibited for fire safety reasons.

Bicycles/scooters/rollerblades and go-karts Please only use these during daylight hours and observe all road rules, including wearing helmets and necessary protective gear. Children must be supervised at all times. Please note: Electric scooters and electric skateboards are not permitted at any time. Guests to see reception prior to go-kart use.

Camp kitchen Camp kitchens are available for use by all guests. Please consider others when using these facilities and clean the area after use.

CCTV Please be aware that surveillance cameras are used within the property.

Dump point A dump point is available for the use of guests. You can find the location of this on the map.

Emergency assembly point To ensure the safety of all guests, we ask that you familiarise yourself with our emergency assembly area, which you can see marked on the map. In the case of an emergency, please stay calm and follow the instructions from staff members.

E-scooters/e-skateboards Due to the risk of injury and/or property damage, the riding of e-scooters and e-skateboards is not permitted within the park boundaries.

Fires Fire pits are allowed on sites, but not during a fire danger period.

Generators The use of generators is not permitted.

Internet Complimentary wifi is available throughout the property for all guests. Please be aware that black spots occur at some locations around the property. **The wifi password is: nrmaholiday**

Jumping Pillows and Swimming Pools Open hours are 9am to dusk. Please note that children under 15 years must be accompanied by an adult at all times in our recreational areas. No pool toys are allowed, lifesaving flotation devices only. The use of bouncing pillows can result in serious personal injury or death, so it is important that you follow the rules displayed at the entry gate so everyone can have fun safely.

Laundry Laundry blocks are provided around the park for guest use. Please see the map provided for locations. Machines are coin-operated and change is available from reception during opening hours. Washing powder is also available at a small charge from the store. Clotheslines are available at some laundry facilities. You can find these on the map.

Linen All cabins receive a mid-stay service for booking of 5 days or longer. If you need additional linen or fresh towels, please come see us at reception.

Motorbikes and quad-bikes No unlicensed motorbikes or quad-bikes may be ridden in the property or surrounding areas. Please check with the local council for designated riding areas and rules.

Noise Please be respectful of other guests in the park by minimising noise from TVs, music and social gatherings between the hours of 10pm and 8am.

Parking One car park is allocated per reservation. Should you need additional parking, please give us a call at reception prior to your arrival to check availability.

Pets Dogs must be on a lead and under control at all times. They may not be left unattended. The pet bond will, unfortunately, be forfeited for any damage or disturbance.

Rubbish All areas are to be kept clean and tidy. Rubbish needs to be tied in a plastic bag before disposing of it in the bins provided to keep the flies and ants at bay.

Security While Management do their best to ensure a safe and secure environment, we do recommend that you secure your valuable items for extra peace of mind.

Smoking Please note that smoking is not permitted in any accommodation, amenities or common areas.

Speed limits All roads in the park are shared by pedestrians and vehicles. For this reason, speed limits are restricted to 8km/per hour (walking pace) at all times.

Tour desk Our reception staff are happy to assist with any queries you may have about tours and activities available in the area. Come have a chat with us.

Visitors Please be aware that any visitors that you invite to the park must adhere to the properties condition of entry and will be the responsibility of the guest. Visitors may leave their car in the guest car park and must be offsite by 10pm.

Wildlife Please don't feed any of the wildlife as human food can be detrimental to their health and behaviour.

Guests or visitors who cause damage to buildings, plants or equipment at the property will be liable for all the costs to repair or replace these assets.

Risk warning: Park Management wishes to warn all persons who engage in any activity for recreation, enjoyment, leisure or relaxation that the pursuit of such activities may result in harm or serious personal injury. All persons who engage in such activities do so at their own risk. Children and infants must be supervised by an adult at all times



Operation Hours

Reception 8am to 6pm, Pools and Waterslide 9am to dusk, Indoor playroom/TV room 9am to dusk.

If the office is unattended or you have an emergency please contact 0458 966 258

03 50212299

mildurariverside@nrmaparksandresorts.com.au

f/NRMAParksandresorts @nrmaparksandresorts

nrmaparksandresorts.com.au