



Shutters

ON THE BEACH®

WHERE NOTHING STANDS
BETWEEN YOU AND THE BEACH

ENTER



One Pico Boulevard, Santa Monica, CA 90405 | 310.458.0030 Reservations | ShuttersontheBeach.com

etc
HOTELS

LEGEND
Preferred
HOTELS & RESORTS



DISCOVER SHUTTERS

- MAP
- ACCOMMODATIONS
- EVENTS
- DINING
- SPA & FITNESS
- POOL & THE BEACH
- AUDIO VISUAL

“WAKE UP TO THE SOUND
OF THE SURF OUTSIDE
YOUR WINDOW AND THE
SAND JUST STEPS AWAY.”

– ANGELENO MAGAZINE

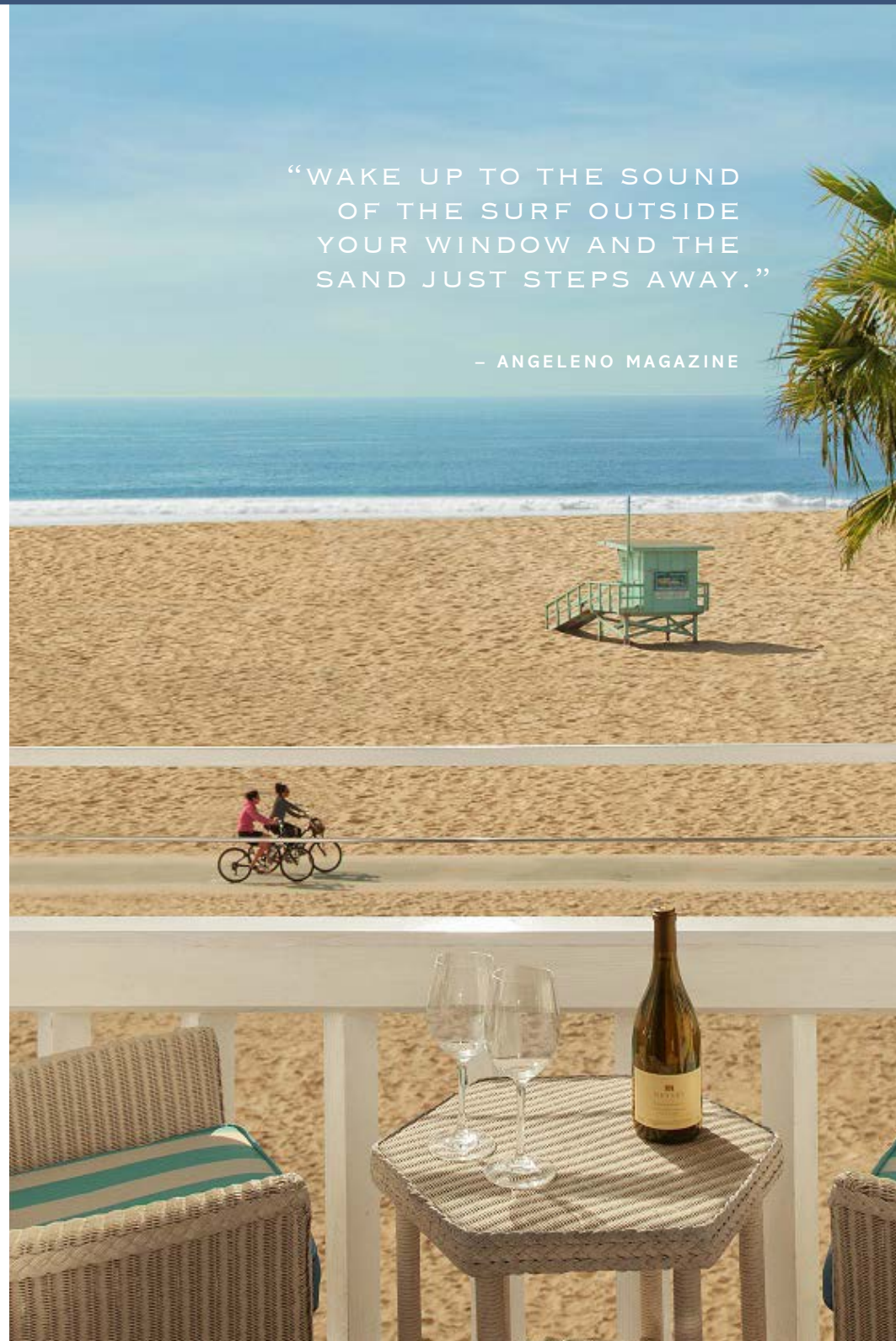



MAP

ACCOMMODATIONS

EVENTS

DINING

SPA & FITNESS

POOL & THE BEACH

AUDIO VISUAL

LOBBY LEVEL

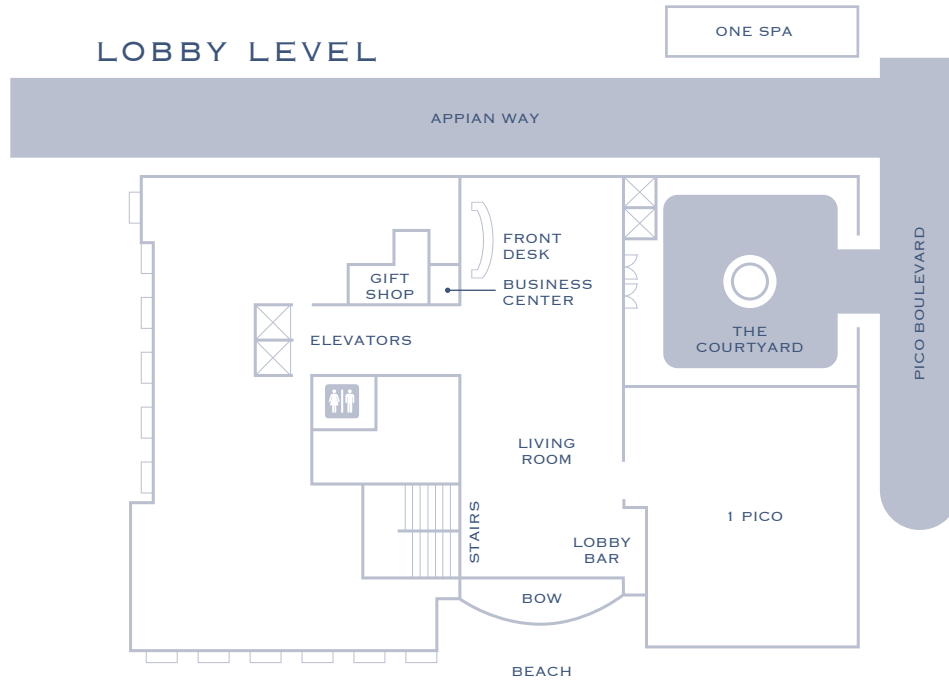

PROMENADE LEVEL

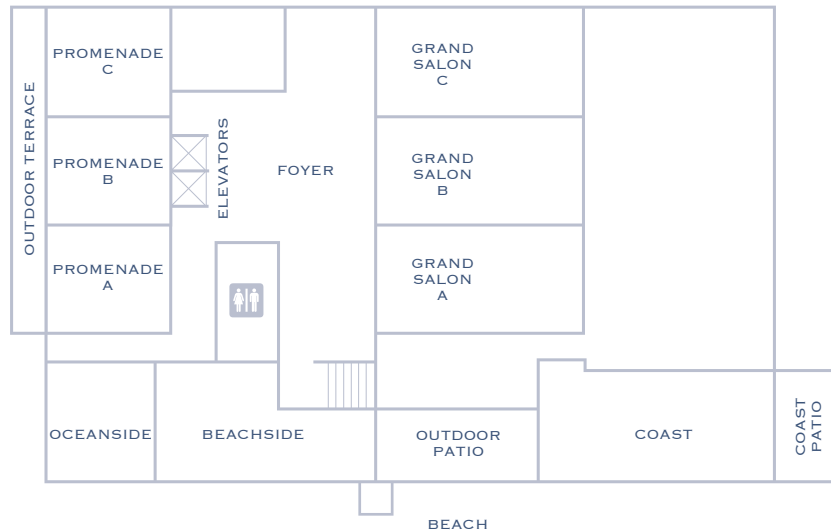

GUESTROOMS

198

SUITES

12



RESTAURANTS

1 Pico & Coast

LOBBY LOUNGE



ONE SPA
FITNESS CENTER



OUTDOOR HEATED POOL
WHIRLPOOL SPA
BEACH ACTIVITY CENTER



VALET PARKING EXCLUSIVELY



8
MILES TO LAX
& BEVERLY HILLS

15
MILES TO
DOWNTOWN LA



Located on the world-renowned Santa Monica Beach, walking distance to Santa Monica Pier and shopping on Abbot Kinney Boulevard and Montana Avenue.



ACCOMMODATIONS

STEP INSIDE YOUR PERSONAL BEACH HOUSE

“LAID-BACK BEACH HOUSE FEEL, WITH ALL THE PERKS OF A LUXURY HOTEL.”

– TRAVEL & LEISURE MAGAZINE



KING BED



DOUBLE BED



SANTA MONICA SUITE



OCEAN VIEW SUITE



OCEAN FRONT SUITE



PACIFIC VIEW SUITE



BEACH HOUSE SUITE



MAP

ACCOMMODATIONS

EVENTS

DINING

SPA & FITNESS

POOL & THE BEACH

AUDIO VISUAL

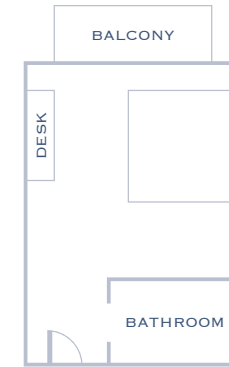

NOT TO SCALE

KING BED

*Non-Ocean View Superior, Deluxe and Spa King Guestrooms
Partial Ocean View, Ocean View and Ocean Front King*

- 450 Square Feet
- Handcrafted California King Bed
- Bathroom includes Hydrothermal Massage Tub and Separate Shower
- Smart TV, Bluetooth Speaker System, and Bedside Control Technology
- Nespresso Coffee Machine
- Most with Outdoor Balcony
- Option for Connecting King or Double Room
- Signature Dyptique™ Bath Amenities



MAP

ACCOMMODATIONS

EVENTS

DINING

SPA & FITNESS

POOL & THE BEACH

AUDIO VISUAL

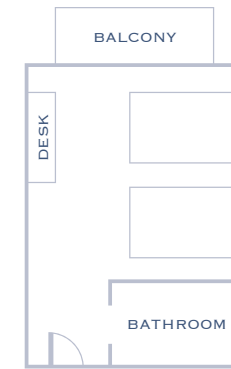

NOT TO SCALE

DOUBLE BED

*Non-Ocean View Superior and Deluxe Double Guestrooms,
Partial Ocean View, and Ocean View Doubles*

- 450 Square Feet
- Two Double Beds
- Bathroom includes Hydrothermal Massage Tub and Separate Shower
- Smart TV, Bluetooth Speaker System, and Bedside Control Technology
- Nespresso Coffee Machine
- Most with Outdoor Balcony
- Option for Connecting King Room
- Signature Dyptique™ Bath Amenities



MAP

ACCOMMODATIONS

EVENTS

DINING

SPA & FITNESS

POOL & THE BEACH

AUDIO VISUAL



NOT TO SCALE

SANTA MONICA SUITES

One Bedroom

- 800 Square Feet
- Santa Monica City Views (Non-Ocean View)
- Bedroom features Handcrafted California King Bed
- Bathroom includes Bidet, Hydrothermal Massage Tub, and Separate Shower
- Powder Room
- Living Room with Sleeper Sofa and Work Desk
- Smart TVs, Bluetooth Speaker System, and Bedside Control Technology
- Nespresso Coffee Machine
- Outdoor Balcony
- Signature Dyptique™ Bath Amenities

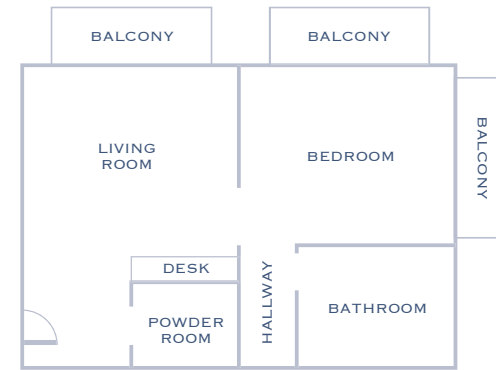

NOT TO SCALE

OCEAN VIEW SUITES

One Bedroom, Ocean House

- 800 Square Feet
- Views of the Ocean and California Coastline
- Bedroom features Handcrafted California King Bed
- Bathroom includes Bidet, Hydrothermal Massage Tub, and Separate Shower
- Living Room with Sleeper Sofa and Work Desk
- Smart TVs, Bluetooth Speaker System, and Bedside Control Technology
- Nespresso Coffee Machine
- Two Outdoor Balconies
- Signature Dyprique™ Bath Amenities



MAP

ACCOMMODATIONS

EVENTS

DINING

SPA & FITNESS

POOL & THE BEACH

AUDIO VISUAL

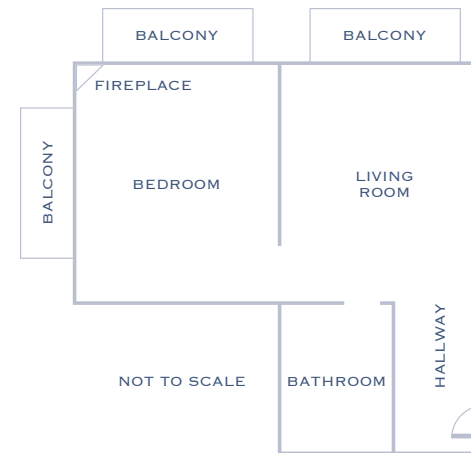

OCEAN FRONT SUITES

One Bedroom, Beach House

- 800 Square Feet
- Sits Right Along the Beach Boardwalk with Full Views of the Ocean
- Bedroom features Handcrafted California King Bed and Fireplace
- Bathroom includes Bidet, Hydrothermal Massage Tub, and Separate Shower
- Living Room with Sleeper Sofa and Work Desk
- Smart TVs, Bluetooth Speaker System, and Bedside Control Technology
- Nespresso Coffee Machine
- Two Outdoor Balconies
- Signature Dyptique™ Bath Amenities

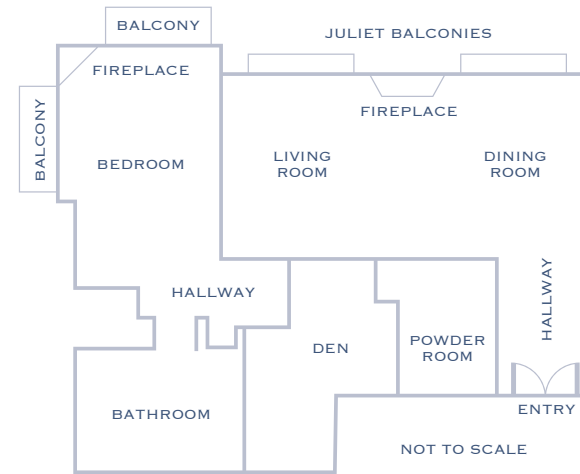

PACIFIC VIEW SUITE 721

One Bedroom, Ocean House

- 1,100 Square Feet
- Full Views of the Ocean and California Coastline
- Bedroom features Handcrafted California King Bed and Fireplace
- Bathroom includes Bidet, Hydrothermal Massage Tub, and Separate Shower
- Living Room with Dining Area, Sleeper Sofa and Fireplace
- Smart TVs, Bluetooth Speaker System, and Bedside Control Technology
- Separate Den with Work Desk
- Nespresso Coffee Machine
- Wet Bar with Wine Fridge
- Powder Room
- Two Outdoor Balconies
- Option for Connecting 2nd Bedroom
- Signature Dyptique™ Bath Amenities



MAP

ACCOMMODATIONS

EVENTS

DINING

SPA & FITNESS

POOL & THE BEACH

AUDIO VISUAL

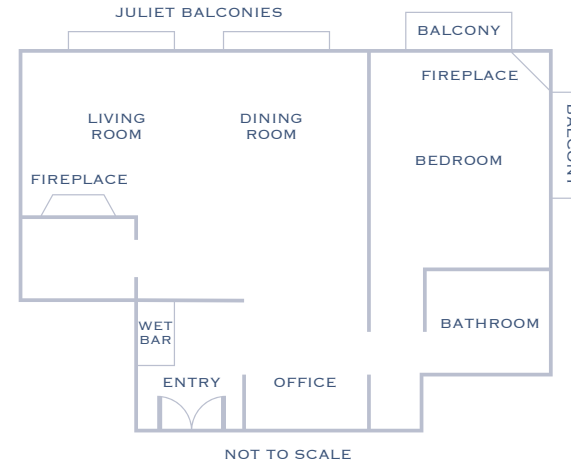

PACIFIC VIEW SUITE 745

One Bedroom, Ocean House

- 1,100 Square Feet
- Full Views of the Ocean and California Coastline
- Bedroom features Handcrafted California King Bed and Fireplace
- Bathroom includes Bidet, Hydrothermal Massage Tub, and Separate Shower
- Living Room with Dining Area, Sleeper Sofa and Fireplace
- Smart TVs, Bluetooth Speaker System, and Bedside Control Technology
- Separate Den with Work Desk
- Nespresso Coffee Machine
- Wet Bar with Wine Fridge
- Powder Room
- Two Outdoor Balconies
- Signature Dyptique™ Bath Amenities

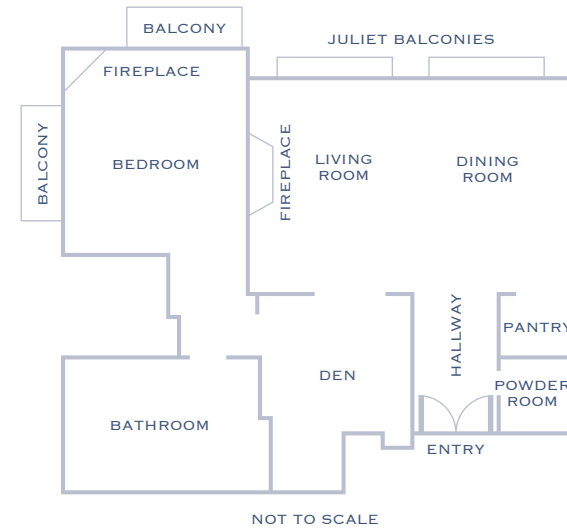

BEACH HOUSE SUITE

One Bedroom, Beach House

- 1,300 Square Feet
- Sits Right Along the Beach Boardwalk with Full Views of the Ocean
- Bedroom features Handcrafted California King Bed and Fireplace
- Bathroom includes Bidet, Hydrothermal Massage Tub, and Separate Shower
- Living Room with Dining Area, Sleeper Sofa and Fireplace
- Smart TVs, Bluetooth Speaker System, and Bedside Control Technology
- Separate Den with Work Desk
- Nespresso Coffee Machine
- Pantry with Refrigerator, Freezer, Wine Fridge and Microwave
- Powder Room
- Two Outdoor Balconies
- Signature Dyptique™ Bath Amenities



MAP

ACCOMMODATIONS

EVENTS

DINING

SPA & FITNESS

POOL & THE BEACH

AUDIO VISUAL

EVENT SPACES

INDOOR AND OUTDOOR EVENT SPACES ARE PERFECT
FOR A MEETING, WEDDING OR SOCIAL OCCASION...
JUST STEPS FROM THE SAND



PACIFIC TERRACE



GRAND SALON
BALLROOM & FOYER



PROMENADE



BEACHSIDE &
OCEANSIDE



PRIVATE
DINING ROOM



PACIFIC TERRACE

With panoramic views of the Pacific Ocean and California Coastline, this is Santa Monica's most breathtaking venue for cocktail receptions, dinners, and wedding ceremonies.

- Outdoor Fireplace
- Heaters Available
- Acoustic Music Only
- City Ordinance 9:00 p.m. End Time for Outdoor Events

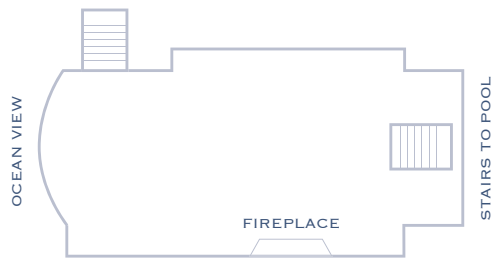

DIMENSIONS	26' x 92'
SQ FT	2,392
VIEW	Beach & Ocean
ROUNDS	150
RECEPTION	250





GRAND SALON

BALLROOM & FOYER

The Grand Salon Ballroom features a fireplace and can be divided into three sections to accommodate large and smaller-sized groups. The spacious foyer is perfect for receptions, breaks or meals.

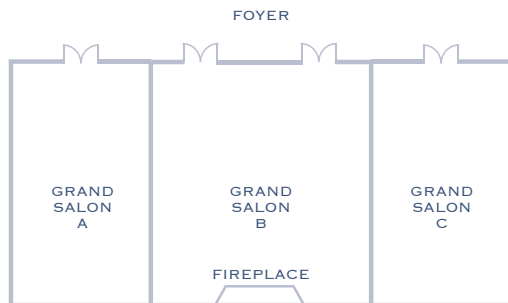

	GRAND SALON	SALON A	SALON B	SALON C
DIMENSIONS	81' x 45'	22' x 45'	36' x 45'	22' x 45'
SQ FT	3,645	990	1,620	990
CEILING	9'	9'	9'	9'
CLASSROOM	216	54	72	54
CONFERENCE	72	30	30	30
SQUARE	96	44	54	44
U-SHAPE	80	38	44	38
ROUNDS	300	96	120	96
THEATER	400	120	200	120
RECEPTION	400	100	100	100
ROUNDS W/ DANCE FLOOR	220			

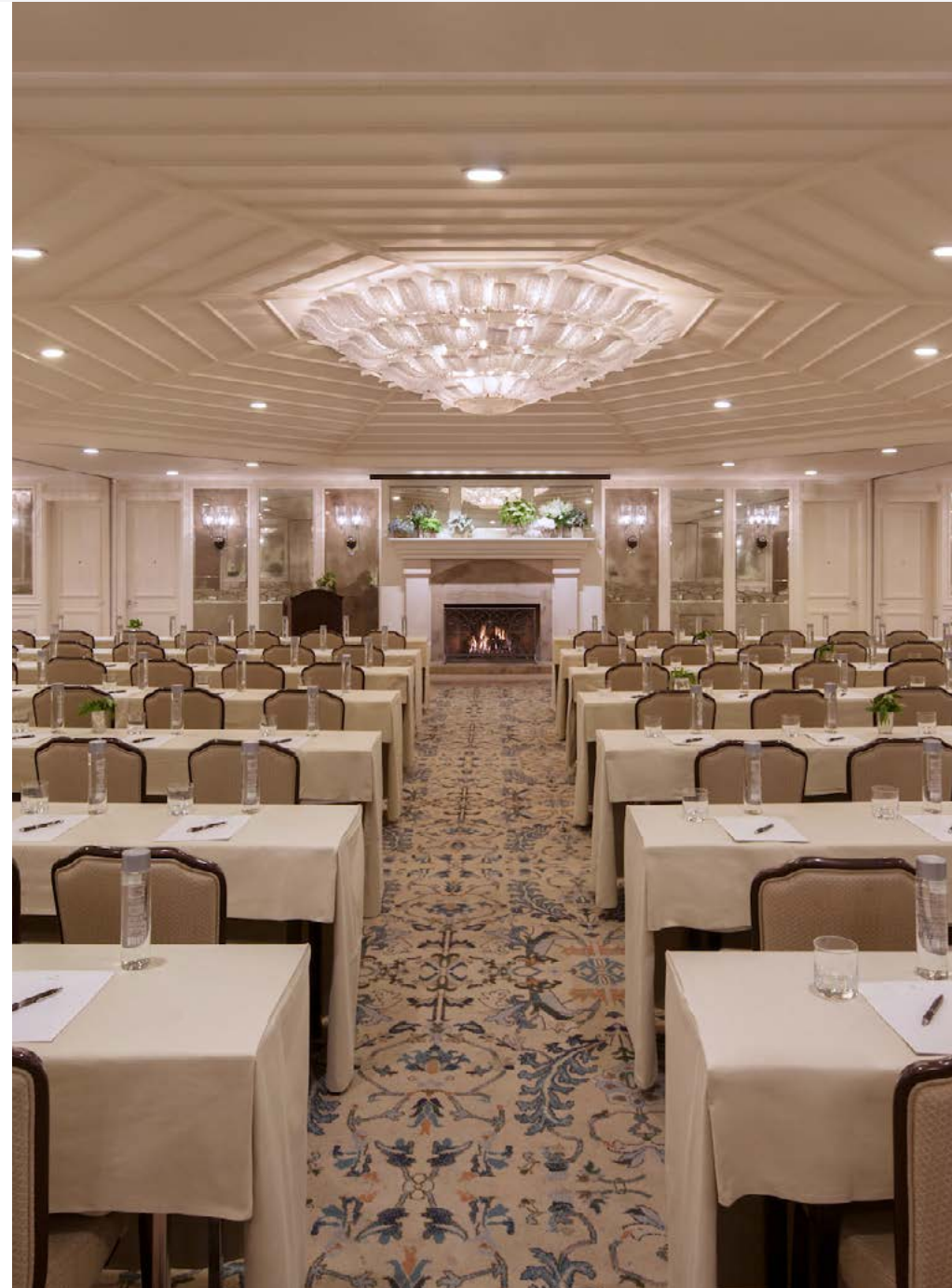



PROMENADE

Promenade features an abundance of natural light and an adjoining outdoor terrace. The room can be divided into three sections, allowing more flexibility for your guests. The private outdoor terrace is perfect for cocktail receptions or meals.

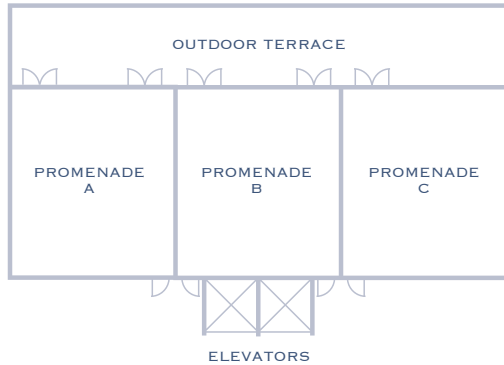

	PROMENADE	PROMENADE A	PROMENADE B	PROMENADE C
DIMENSIONS	76' x 23'	26' x 23'	28' x 23'	22' x 23'
SQ FT	1,748	598	644	506
CEILING	9'	9'	9'	9'
CLASSROOM	72	27	36	18
CONFERENCE	70	22	22	18
SQUARE	72	30	30	28
U-SHAPE	69	18	24	18
ROUNDS	130	40	50	40
THEATER	140	55	55	44
RECEPTION	150	40	50	40
ROUNDS W/ DANCE FLOOR	90			





BEACHSIDE & OCEANSIDE

Beachside and Oceanside sit right along the strand, offering natural light and windows that let in the fresh ocean breeze. The rooms adjoin and can be used together or separately. Feel the ocean breeze and experience the closest thing to being right on the sand.

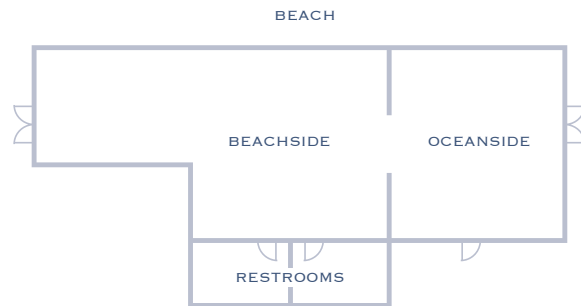

	BEACHSIDE	OCEANSIDE
DIMENSIONS	54' x 20'	19' x 26.5'
SQ FT	1,078	500
CEILING	7'	7'
CLASSROOM	48	18
CONFERENCE	42	20
SQUARE	42	24
U-SHAPE	45	24
ROUNDS	84	30
THEATER	90	50
RECEPTION	100	30
ROUNDS W/ DANCE FLOOR	50	





PRIVATE DINING ROOM

The private dining room holds a maximum of 12 guests and that's precisely the charm. Intimate, thoughtfully designed, and wonderfully private, it's ideal for everything from small family gatherings to formal business dinners.



DIMENSIONS	11' x 18'
SQ FT	198
CEILING HEIGHT	7'
CONFERENCE	12



MAP

ACCOMMODATIONS

EVENTS

DINING

SPA & FITNESS

POOL & THE BEACH

AUDIO VISUAL

DINING

OFFERING BREATHTAKING VIEWS OF THE PACIFIC,
OUR RESTAURANTS FEATURE REFINED MENU SELECTIONS
IN A RELAXED SETTING.

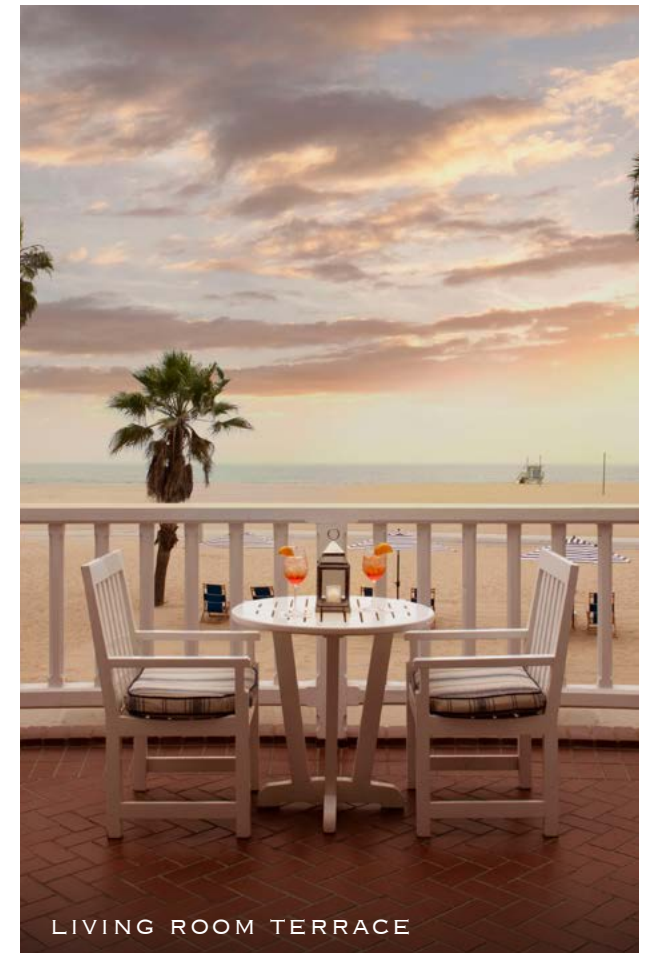

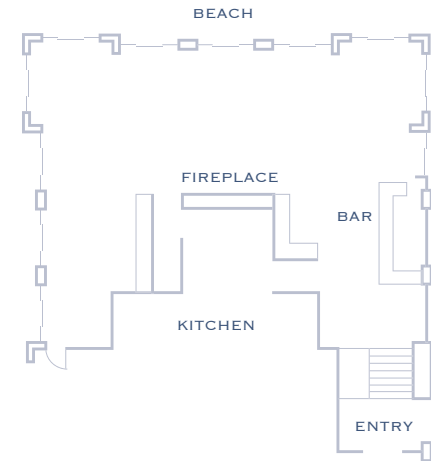
[MAP](#)[ACCOMMODATIONS](#)[EVENTS](#)[DINING](#)[SPA & FITNESS](#)[POOL & THE BEACH](#)[AUDIO VISUAL](#)

1 PICO

Perched above the beach, with a seasonal market menu and a unique wine list, 1 Pico is an address to always remember.

- Open for Dinner and Weekend Brunch
- Seats up to 90 Guests
- Available for Private Events





MAP

ACCOMMODATIONS

EVENTS

DINING

SPA & FITNESS

POOL & THE BEACH

AUDIO VISUAL

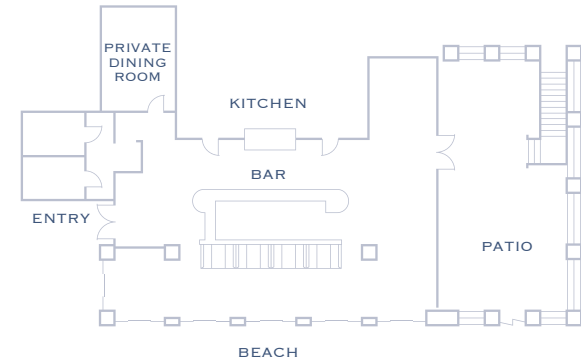

COAST

Coast is a casual beachfront café and bar where imaginative chefs and California-inspired dishes evoke a laid back coastal state of mind.

- Open for Breakfast, Lunch and Dinner
- Private Dining Room seats 12 Guests
- Outdoor Heated Patio Seats up to 40 Guests and is Available for Private Events

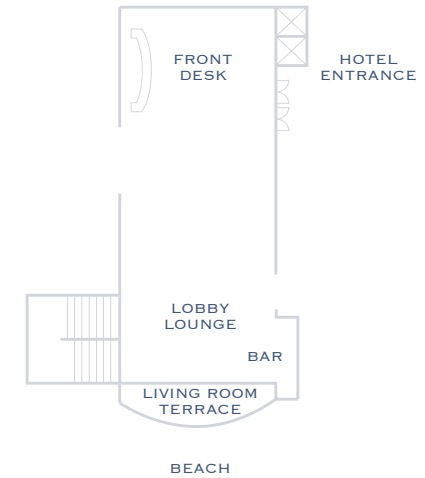

[MAP](#)[ACCOMMODATIONS](#)[EVENTS](#)[DINING](#)[SPA & FITNESS](#)[POOL & THE BEACH](#)[AUDIO VISUAL](#)

LIVING ROOM

For relaxing, entertaining, meeting and light bites, this is the heart of Santa Monica's beloved luxury beach house. Sophisticated and relaxed furnishings are surrounded by contemporary art.

- Open Daily from 11:00 a.m.
- Seating on a First-Come First-Served Basis
- Features an AI Fresco Terrace
- Live Music



MAP

ACCOMMODATIONS

EVENTS

DINING

SPA & FITNESS

POOL & THE BEACH

AUDIO VISUAL

SPA & FITNESS

THE SPA AND FITNESS CENTER ARE LUXURIOUS
WAYS TO MAKE WELLNESS A PART OF LIFE
IN SANTA MONICA.

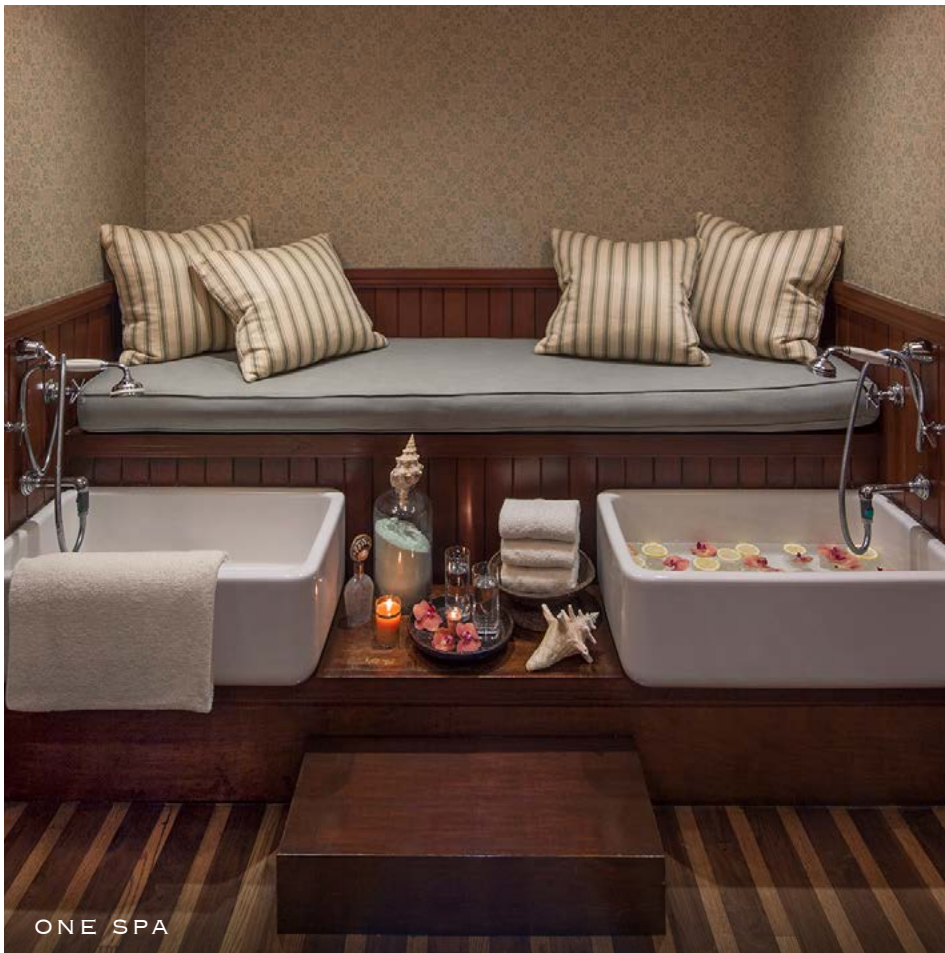

ONE SPA



FITNESS CENTER



ONE SPA

ONE Spa features luxurious treatment rooms, including sage Carrara marble wetrooms with linear rain showers, and a secluded manicure and pedicure area. The interior is crisp and ship-shape, recalling the romantic era of the 1930s yachting scene. Natural woods and stone combined with subtle tones of sand and sea evoke the healing powers of the sea.

- Featuring Custom Treatments by Augustinus Bader, Luzern, and Omorovicza
- Designed by Michael Smith

[SPA MENU](#)





FITNESS CENTER

Featuring cardio equipment, resistance machines and free weights, our comprehensive fitness center has everything to maintain a workout routine.

- Yoga Classes on the Beach
- Mindful Meditation Sessions
- Featuring Peloton and Technogym





POOL & THE BEACH

OVERLOOKING THE OCEAN, THE POOL IS SURROUNDED BY CHAISE LOUNGES, PRIVATE CABANAS, A HEATED WHIRLPOOL, AND POOL BAR SERVING LIGHT FOOD AND BEVERAGES. IF A DIP IN THE OCEAN IS MORE IDEAL, MILES OF SHORELINE WAIT JUST BELOW.

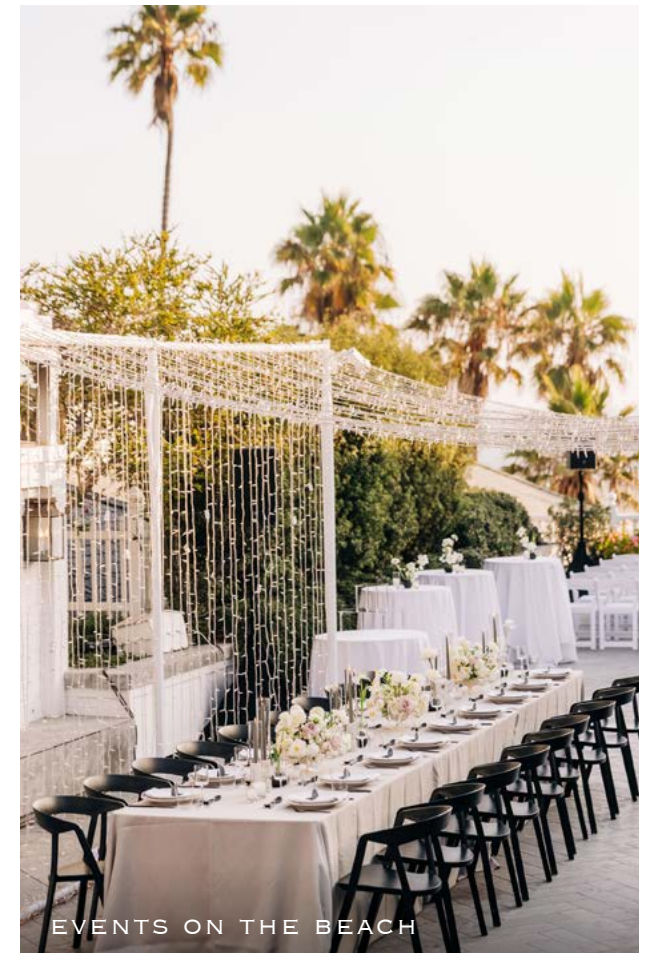
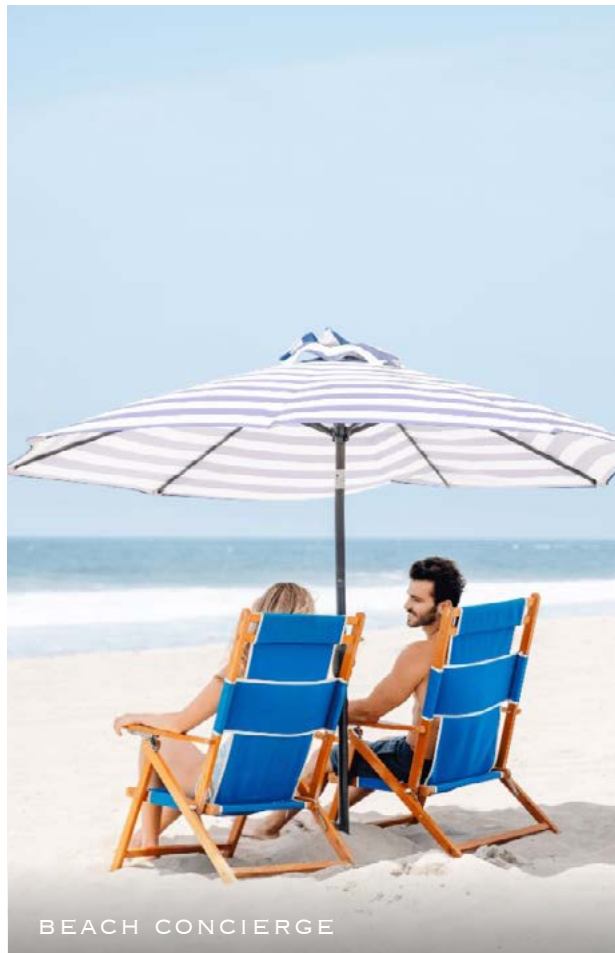



MAP

ACCOMMODATIONS

EVENTS

DINING

SPA & FITNESS

POOL & THE BEACH

AUDIO VISUAL



THE POOL

Pool and heated whirlpool feature cabanas and full poolside service.

- Open Seasonally 6:00 a.m. - 10:00 p.m.





BEACH CONCIERGE

Beach Concierge is here to assist with every need. The seasonal Beach Concierge is equipped with bicycles, chairs, umbrellas, boogie boards, refreshment menu and more to explore.

- Surf Lessons
- Bike Rentals
- Beach Chairs and Umbrellas



[MAP](#)[ACCOMMODATIONS](#)[EVENTS](#)[DINING](#)[SPA & FITNESS](#)[POOL & THE BEACH](#)[AUDIO VISUAL](#)

EVENTS ON THE BEACH

Wedding ceremonies are permitted on the beach in front of the hotel. Our Catering and Events Team are happy in arranging for a breathtaking beach event.



EVENTS ON
THE BEACH



MAP

ACCOMMODATIONS

EVENTS

DINING

SPA & FITNESS

POOL & THE BEACH

AUDIO VISUAL



AUDIO VISUAL

ENCORE AT SHUTTERS

Encore offers the latest audiovisual equipment and innovative event technology services, such as developing customized mobile express apps for smart phones, global video conferencing, and extended bandwidth for any meeting or event.

ENCORE CONTACT

HECTOR VILLALOBOS

*Director of Event Technology
Encore Presentation Services*

 hector.villalobos@encoreglobal.com

 310.469.8539



Shutters

ON THE BEACH®



One Pico Boulevard, Santa Monica, CA 90405
310.458.0030 Reservations
ShuttersontheBeach.com

etc
HOTELS

LEGEND
Preferred
HOTELS & RESORTS