



Square Kiosk

Getting started

CONTENTS

What's in the box	2
Setup options	4
Angled wall mount	6
Flat wall mount	8
Countertop mount	10
VESA mount	12
Get the Square Kiosk app	14
Take payments and stay powered unplugged	15
Help, guarantee and regulatory information	16



Scan this code with your smartphone camera to get step-by-step instructions or go to square.com/go/kiosk-guide.

WHAT'S IN THE BOX

What you need to get your Square Kiosk up and running is inside — just make sure your compatible iPad is ready.

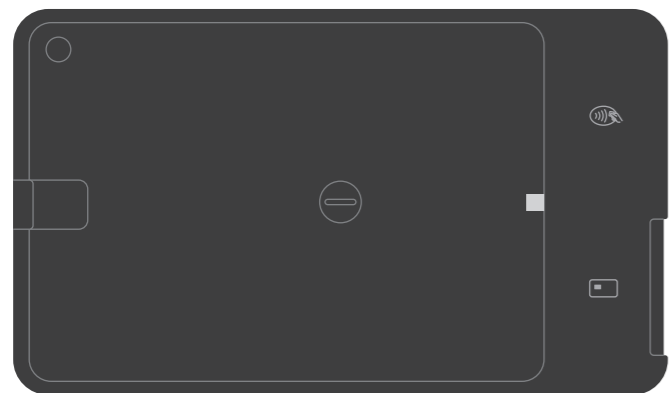

Square Kiosk (front)

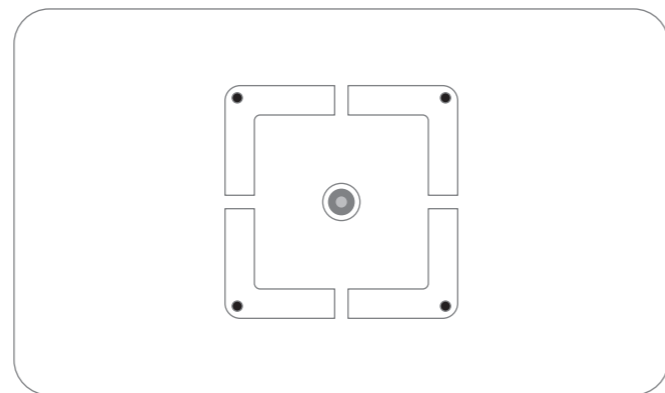

Square Kiosk (back)

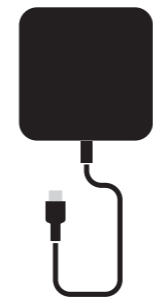

Power adapter



Power adapter cable



Hub

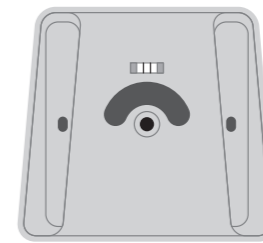

Angled bracket with built-in level

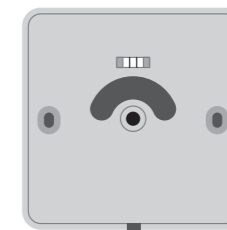

Flat bracket with built-in level



Adapter for iPad Air and iPad Pro



Drywall drill bit



Long PH2 screwdriver bit

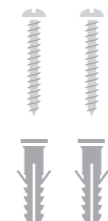

Wall screws (x2) and wall anchors (x2)



VESA screws



Security screw

HOW DO YOU WANT TO SET UP SQUARE KIOSK?

There are four different ways you can set up Square Kiosk. Read below to pick which best fits your business needs.

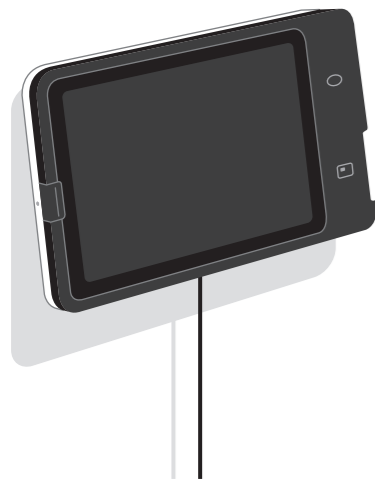

ANGLED WALL MOUNT

Positions the screen at an upward angle towards staff and customers

Go to page 6.

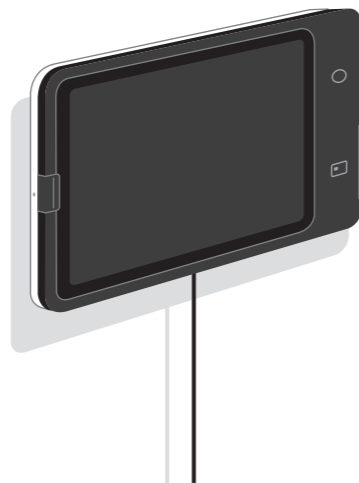

FLAT WALL MOUNT

Has a slim, space-saving profile that sits flat against the wall

Go to page 8.



COUNTERTOP MOUNT

Creates a low-profile countertop kiosk that angles the screen upwards

Go to page 10.

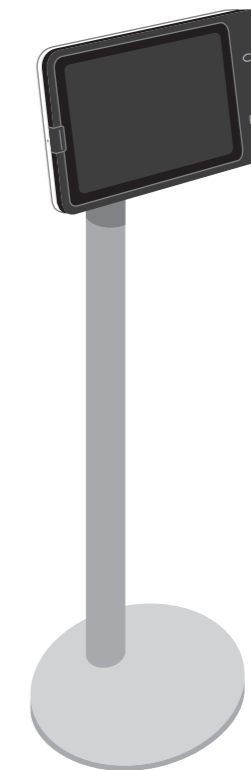

VESA MOUNT

Uses any 100 mm x 100 mm VESA mount to attach a standalone pedestal, swing arm or other setup option

Go to page 12.

ANGLED WALL MOUNT

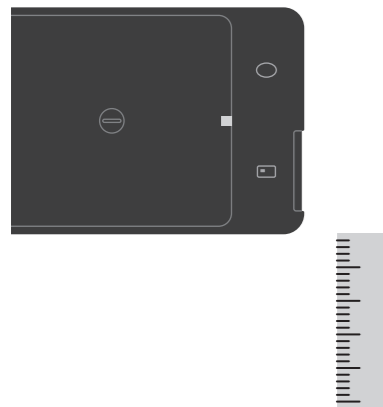

1 Pick a spot on your wall

Hold up Square Kiosk against the wall to find your preferred height. Avoid placing over studs.

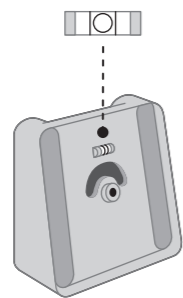

2 Position the angled bracket

Level the bracket on the wall, then mark the position of the screw holes with a pencil.

What you need from the box

- Angled bracket
- Square Kiosk
- Hub
- Power adapter cable
- Power adapter

- Wall screws (x2)
- Wall anchors (x2)
- Long PH2 screwdriver bit
- Drywall drill bit
- Security screw (optional)

What you need that's not in the box

- Drill
- Stud finder
- Phillips screwdriver
- Small Phillips screwdriver (optional)
- Pencil

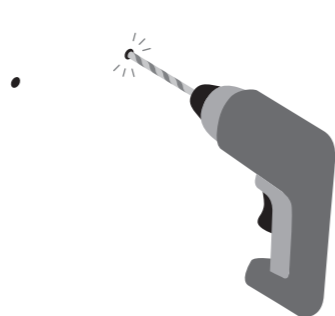

3 Drill the holes you just marked

For drywall installation, use the included drywall drill bit.

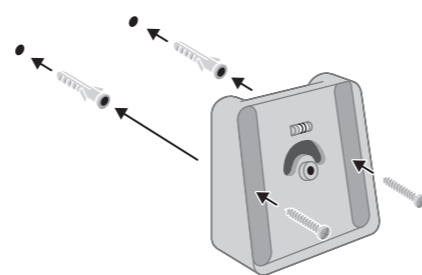

4 Screw the angled bracket into the wall

Insert the wall anchors into the drill holes. Position the angled bracket, then insert the wall screws into the front and screw in, making sure the bracket is level as you fully tighten.

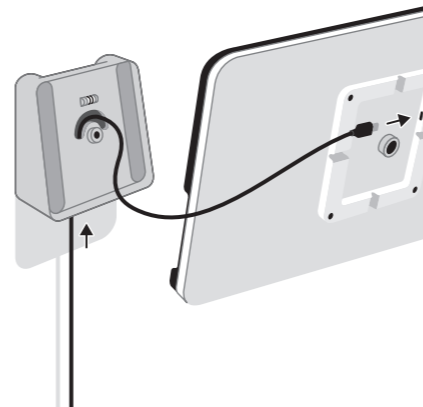

5 Plug the hub in to Square Kiosk

Starting from the bottom of the bracket, thread the hub's USB-C cable through the pass-through hole and into the connector on the back of Square Kiosk.

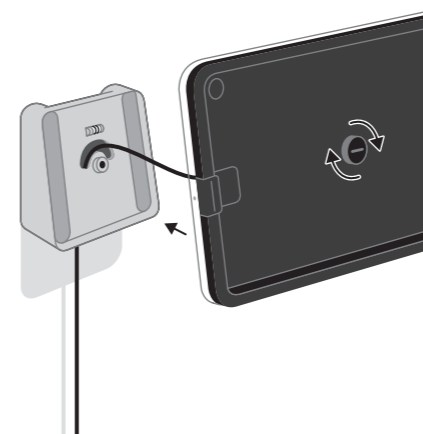

6 Place Square Kiosk into the bracket

Tighten the centre mounting screw until you cannot see any of the red sidewall on the screw. Make sure it is secure and does not wiggle.

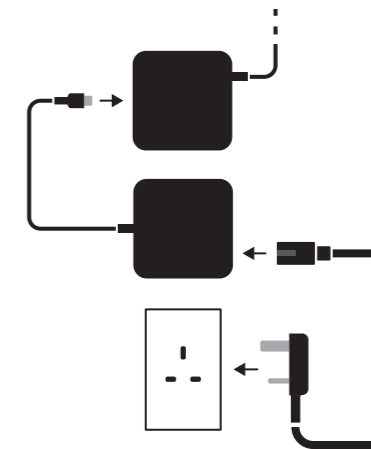

7 Plug in Square Kiosk

Plug the power adapter's USB-C cable into the hub, then plug one end of the power adapter cable into the power adapter and the other into a socket.

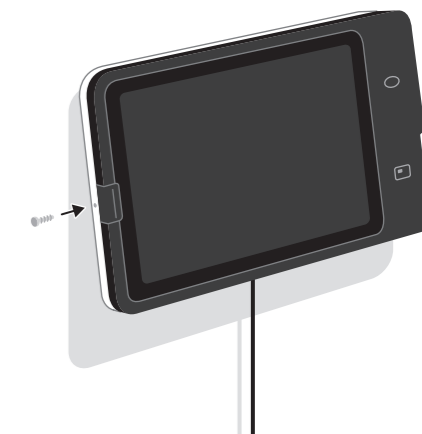

8 Slide your iPad in and secure it

Dock your iPad to the connector and make sure the security latch clicks. **Optional:** To further secure your iPad, use a small Phillips screwdriver to attach the security screw to the side of Square Kiosk.

Additional installation options: For installation on other surfaces, like concrete or brick, or to hide cords when installing, go to square.com/go/kiosk-setup.

Removing your iPad from Square Kiosk: If you used the optional security screw, first unscrew it. You can then take your iPad out by pulling out then pushing down on the raised security latch located next to the iPad's camera. Once unlatched, carefully slide the iPad out to the left.

FLAT WALL MOUNT

What you need from the box

- Flat bracket
- Square Kiosk
- Hub
- Power adapter cable
- Power adapter
- Wall screws (x2)
- Wall anchors (x2)
- Long PH2 screwdriver bit
- Drywall drill bit
- Security screw (optional)

What you need that's not in the box

- Drill
- Stud finder
- Phillips screwdriver
- Small Phillips screwdriver (optional)
- Pencil

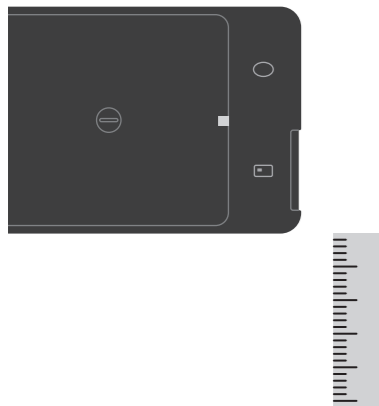

1 Pick a spot on your wall

Hold up Square Kiosk to find your preferred height on the wall. Avoid placing over studs.

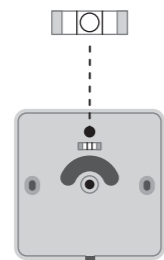

2 Position the flat bracket

Level the bracket on the wall, then mark the position of the screw holes with a pencil.

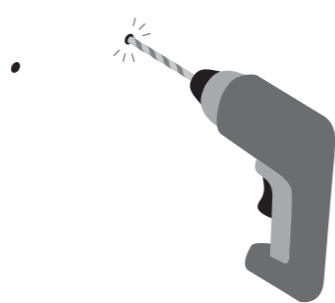

3 Drill the holes you just marked

For drywall installation, use the included drywall drill bit.

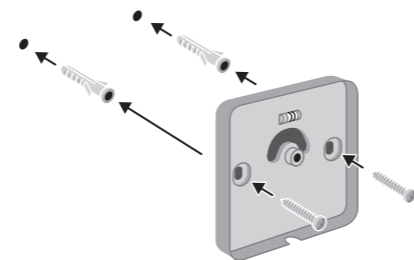

4 Screw the flat bracket into the wall

Insert the wall anchors into the drill holes. Position the flat bracket, then insert the wall screws into the front and screw in, making sure the bracket is level as you fully tighten.



5 Plug the hub into Square Kiosk

Press the hub's USB-C cable into the cable channel on the back of Square Kiosk. Check that there is no interference between the cable and the mount screw.

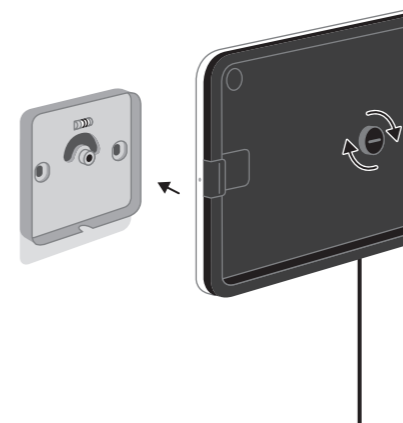

6 Place Square Kiosk into the bracket

Tighten the centre mounting screw until you cannot see any of the red sidewall on the screw. Make sure it is secure and does not wiggle.

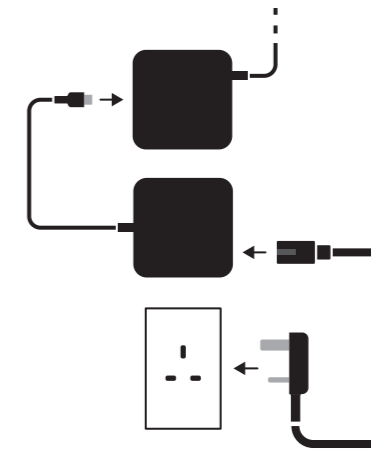

7 Plug in Square Kiosk

Plug the power adapter's USB-C cable into the hub, then plug one end of the power adapter cable into the power adapter and the other into a socket.

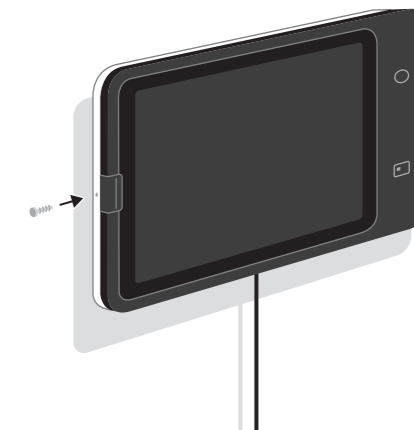

8 Slide your iPad in and secure it

Dock your iPad to the connector and make sure the security latch clicks. **Optional:** To further secure your iPad, use a small Phillips screwdriver to attach the security screw to the side of Square Kiosk.

Additional installation options: For installation on other surfaces, like concrete or brick, or to hide cords when installing, go to square.com/go/kiosk-setup.

Removing your iPad from Square Kiosk: If you used the optional security screw, first unscrew it. You can then take your iPad out by pulling out then pushing down on the raised security latch located next to the iPad's camera. Once unlatched, carefully slide the iPad out to the left.

COUNTERTOP MOUNT

What you need from the box

- Angled bracket
- Square Kiosk
- Hub
- Power adapter cable
- Power adapter

What you need that's not in the box

- Small Phillips screwdriver (optional)

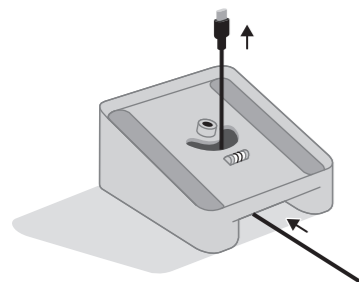

1 Pick a spot on your counter

With the angled bracket facing you as shown, pass the hub's USB-C cable through the hole.

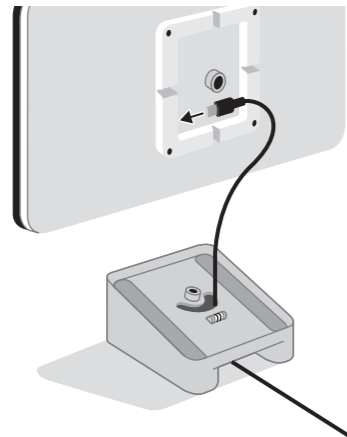

2 Plug the hub into Square Kiosk

Make sure the hub's USB-C cable is firmly pushed in.

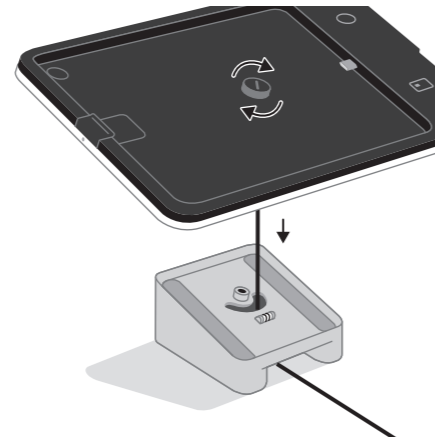

3 Place Square Kiosk into the bracket

Tighten the centre mounting screw until you cannot see any of the red sidewall on the screw. Make sure it is secure and does not wiggle.

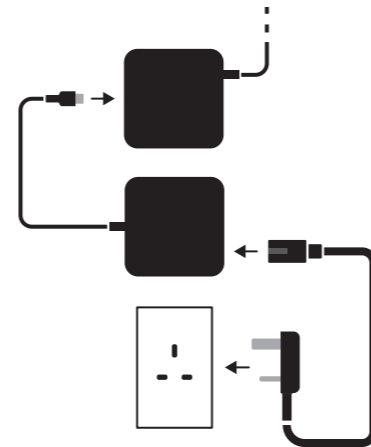

4 Plug in Square Kiosk

Plug the power adapter's USB-C cable into the hub, then plug one end of the power adapter cable into the power adapter and the other into a socket.

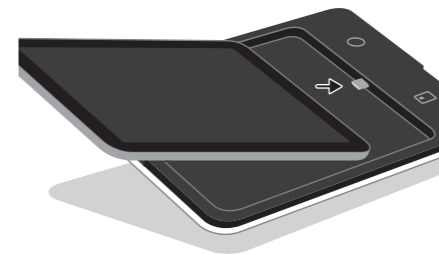

5 Slide your iPad in

Dock your iPad to the connector and make sure the security latch clicks.



6 Optional: Secure your iPad

Using a small Phillips screwdriver, attach the security screw to the side of Square Kiosk to further secure your iPad.

Removing your iPad from Square Kiosk: If you used the optional security screw, first unscrew it. You can then take your iPad out by pulling out then pushing down on the raised security latch located next to the iPad's camera. Once unlatched, carefully slide the iPad out to the left.

VESA MOUNT

Connect Square Kiosk to a third-party VESA system. Before you begin setting up, make sure you have the installation guide that came with the VESA mount you are using.
Note: Square Kiosk is only compatible with 100 mm x 100 mm VESA plates.

What you need from the box

- Square Kiosk
- Hub
- Power adapter cable
- Power adapter
- VESA screws (x4)
- Security screw (optional)

What you need that's not in the box

- Small Phillips screwdriver (optional)
- Phillips screwdriver



1 Plug the hub into Square Kiosk

Decide which side you want the hub's USB-C cable to exit, then slot it into the cable channel, or if VESA mount allows, run the cable through the VESA mount.

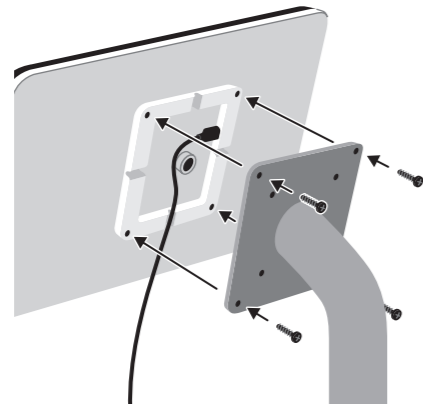

2 Screw Square Kiosk onto the VESA plate

Align the 100 mm x 100 mm VESA plate screw holes with the threads on the back of the Square Kiosk and screw on.

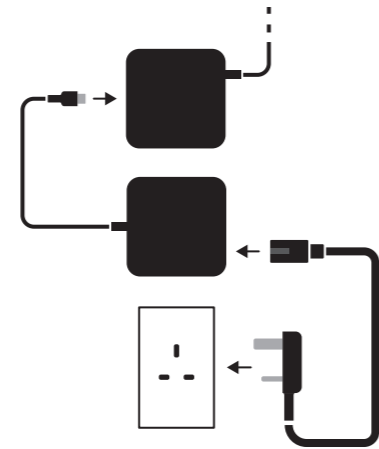

3 Plug in Square Kiosk

Plug the power adapter's USB-C cable into the hub, then plug one end of the power adapter cable into the power adapter and the other into a socket.

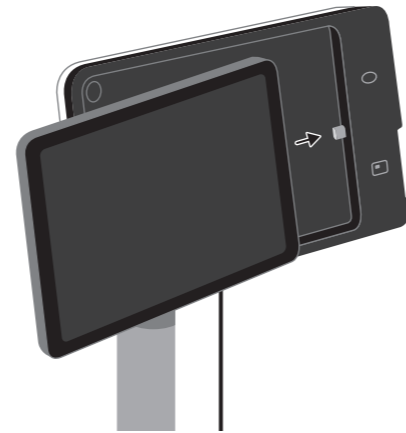

4 Slide your iPad in and secure it

Dock your iPad to the connector and make sure the security latch clicks.

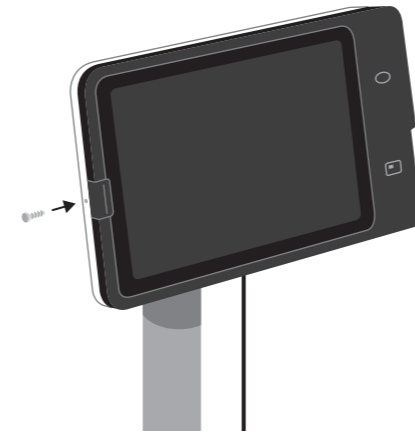

5 Optional: Secure your iPad

Using a small Phillips screwdriver, attach a security screw to the side of Square Kiosk to further secure your iPad.

Removing your iPad from Square Kiosk: If you used the optional security screw, first unscrew it. You can then take your iPad out by pulling out then pushing down on the raised security latch located next to the iPad's camera. Once unlatched, carefully slide the iPad out to the left.

GET THE SQUARE KIOSK APP

Keep your staffing costs in order. The Square Kiosk app keeps your front and back of house in sync with instant menu updates and real-time sales data. To get your self-service ordering kiosk up and running, **download the Square Kiosk app** and subscribe for an additional monthly fee.

To learn more about pairing accessories when running the Square Kiosk app, go to square.com/go/kiosk-support.

Scan to download
the Square Kiosk app

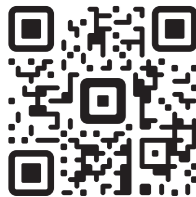

TAKE PAYMENTS AND STAY POWERED UNPLUGGED

Go from setup to sale in no time at all. Plus, with iPad-powered mode, Square Kiosk runs off iPad battery, so losing power or unplugging never gets in the way of selling.

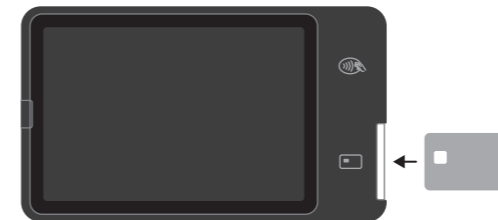

1 Insert

Insert a chip and PIN card into the blinking card slot.



2 Tap

The flashing contactless icon shows where to tap a contactless card or mobile device.

HELP AND SUPPORT

Read our FAQs, learn more about compatible hardware and get troubleshooting support at square.com/go/kiosk-guide.

HARDWARE PROTECTION

Your Square hardware comes with a limited two-year warranty. To find warranty information, go to square.com/guarantee.

FREE 30-DAY RETURNS

Square offers a 30-day, risk-free return policy for all purchases made from square.com/hardware. Visit square.com/returns to process your return. After a return is complete, a refund will be credited back to you.

LIMITED PRODUCT GUARANTEE AGAINST DEFECTS – REPUBLIC OF IRELAND

Squareup International Limited (“Square”) guarantees this product against any defect in manufacture or workmanship or failure of the product to comply with the specifications set out in the instruction manual (“Defect”) for a period of two (2) years from the date of delivery. If the original consumer purchaser (or his/her assignee) finds this product to have a Defect within two (2) years from the original date of delivery, Square will replace the product at no cost. The limited guarantee shall be void if the Defect in the product has arisen through use other than as set out in the instruction manual. If you are acting as a consumer under applicable legislation, then this limited guarantee is in addition to (and does not affect) any of your statutory or consumer rights and remedies, including those under the Sale of Goods Act 1893 (as amended).

GUARANTEE COVERAGE

The rights in this limited guarantee may be assigned to another person without prejudice, including but not limited to the time restriction of two (2) years for customers in the Republic of Ireland from the date of delivery set out in the first paragraph of this limited product guarantee. See square.com/go/ie/guarantee for more information.

This limited guarantee does not apply if the product: has been subjected to alteration, modification/adaptation, abuse, misuse or otherwise used other than as set out in the instruction manual; or has been combined with any hardware or software that was not manufactured by Square or a member of its corporate group, not intended for use with the product or otherwise not included in its original packaging. For service, support or guarantee assistance in this circumstance, you are advised to contact the manufacturer of the relevant third-party hardware or software supplier directly (and not Square).

To contact Square in the Republic of Ireland, please visit square.com/go/ie/help or call 1800 904 878 to be connected to customer support. The limited guarantee applies exclusively to residents of the Republic of Ireland and is issued by Square, whose registered office is located at 70 Sir John Rogerson’s Quay, Dublin 2, D02 R296, Republic of Ireland.

LIMITED PRODUCT GUARANTEE AGAINST DEFECTS – UNITED KINGDOM

Squareup (UK) Ltd (“Square”) guarantees this product against any defect in manufacture or workmanship or failure of the product to comply with the specifications set out in the instruction manual (“Defect”) for a period of two (2) years from the date of delivery. If the original consumer purchaser (or his/her assignee) finds this product to have a Defect within two (2) years from the original date of delivery, Square will replace the product at no cost. The limited guarantee shall be void if the Defect in the product has arisen through use other than as set out in the instruction manual. If you are acting as a consumer under applicable legislation, then this limited guarantee is in addition to (and does not affect) any of your statutory or consumer rights and remedies, including those under the Consumer Rights Act 2015.

GUARANTEE COVERAGE

The rights in this limited guarantee may be assigned to another person without prejudice, including but not limited to the time restriction of two (2) years for customers in the United Kingdom from the date of delivery set out in the first paragraph of this limited product guarantee. See square.com/go/uk/guarantee for more information.

This limited guarantee does not apply if the product: has been subjected to alteration, modification/adaptation, abuse, misuse or otherwise used other than as set out in the instruction manual; or has been combined with any hardware or software that was not manufactured by Square or a member of its corporate group, not intended for use with the product or otherwise not included in its original packaging. For service, support or guarantee assistance in this circumstance, you are advised to contact the manufacturer of the relevant third-party hardware or software supplier directly (and not Square).

To contact Square in the UK, please visit square.com/uk/help or call 0800 098 8014. The limited guarantee applies exclusively to residents of the UK and is issued by Square, whose registered office is located at 6th Floor, One London Wall, London EC2Y 5EB.

COMPLIANCE WITH 2014/53/EU RADIO EQUIPMENT DIRECTIVE (RED)

Square wireless products comply with the requirements of Article 10(2) as they can operate in at least one Member State as examined. In accordance with Article 10(10), in cases of restrictions on putting into service, information available on the packaging shall allow the identification of the Member States or the geographical area within a Member State where restrictions on putting into service or requirements for authorisation of use exist.

ACCESSORY SAFETY

- Using an unapproved or incompatible power adapter or cord may cause fire, explosion or other hazards.
- Choose only accessories approved for use with this model by the device manufacturer. The use of any other types of accessories may void the warranty, may violate local laws and regulations and may be dangerous. Please contact your retailer for information on approved accessories.

POWER ADAPTER SAFETY

- Do not drop or cause an impact to the power adapter.
- If the power cable is damaged (for example, the cord is exposed or broken) or the plug loosens, stop using it immediately. Continued use may lead to electric shocks, short circuits or fire.
- Do not touch the power adapter with wet hands. Doing so may lead to malfunctions, short circuits or electric shocks.

NFC

Frequency: 13.56 MHz

Max. Transmit Power: 1.39 dBµA/m at 10 m

Model identifier	SWJ1-01
Input voltage	100-240 V
Input AC frequency	50 / 60 Hz
Output voltage	5 V / 9 V / 15 V / 3 A 20 V / 2.25 A
Output current	3 A, 2.25 A
Output power	45 W max
Average active efficiency	84.91%
Efficiency at low load (10%)	79.58%
No-load power consumption	0.054 W max

DISPOSAL OF WASTE BATTERIES AND ELECTRICAL AND ELECTRONIC EQUIPMENT

This symbol on the product and its packaging means that this product must not be disposed of with your household waste. Instead it is your responsibility to hand this over to an applicable collection point for the recycling of electrical and electronic equipment.

The separate collection and recycling will help conserve natural resources and prevent potential negative consequences for human health and the environment due to the possible presence of hazardous substances in electrical and electronic equipment, which could be caused by inappropriate disposal. Disposal regulations vary by region. Dispose of old batteries and equipment in compliance with your local regulations.

For more information on where to deliver your batteries and electrical and electronic waste, please contact your local city/council office, your household waste disposal service or the shop where you purchased this product. For the nearest recycling collection point in the United Kingdom, please visit square.com/go/uk-recycling. In the Republic of Ireland, please visit square.com/go/ie-recycling.

SIMPLIFIED EU AND UKCA DECLARATION OF CONFORMITY

Hereby, Block, Inc. declares that the radio equipment type Model SPH1-02-A is in compliance with Directive 2014/53/EU. The full text of the EU and UKCA declaration of conformity is available at the following internet address: squareup.com/gb/en/legal/general/dc.

COMMISSION REGULATION (EU) 2019/1782 OF 1 OCTOBER 2019

Laying down ecodesign requirements for external power supplies pursuant to Directive 2009/125/EC of the European Parliament and of the Council.

Manufacturer’s name and commercial registration number and address:

Squareup (UK) Limited,
6th Floor, One London Wall,
London, EC2Y 5EB
CRO Entity#: 09023549
VAT ID#: 233237041

Squareup International Ltd.
70 Sir John Rogerson’s Quay,
Dublin 2, D02 R296, Ireland.
CRO Entity#: 583287
VAT ID#: IE 3426675NH





Your use of the Square app and Square Kiosk, including any warranties associated with these products, is governed by your agreements with Square and related policies available at square.com/legal. Square and the Square logo are trademarks of Block, Inc. iPad, iPad Air, and iPad Pro are trademarks of Apple Inc., registered in the US and other countries. App Store is a service mark of Apple Inc. Other marks and brands are the property of their respective owners.

© 2024 Block, Inc., 1955 Broadway, Ste. 600, Oakland, CA 94612. Squareup Pte. Ltd., 8 Marina Boulevard #05-02, Marina Bay Financial Centre, Singapore (018981). M-LIT-0316-02