



Square Kiosk

Getting started

CONTENTS

What's in the box	2
Setup options	4
Angled wall mount	6
Flat wall mount	8
Countertop mount	10
VESA mount	12
Get the Square Kiosk app	14
Use this hardware as a POS	15
Take payments and stay powered unplugged	16
Help, limited warranty and claims procedure	17



Scan this code with your smartphone camera to get step-by-step instructions or go to square.com/go/kiosk-guide.

WHAT'S IN THE BOX

What you need to get your Square Kiosk up and running is inside – just make sure your compatible iPad is ready.

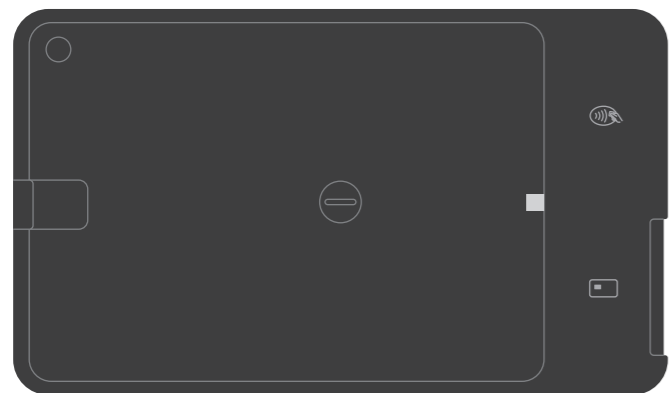

Square Kiosk (front)

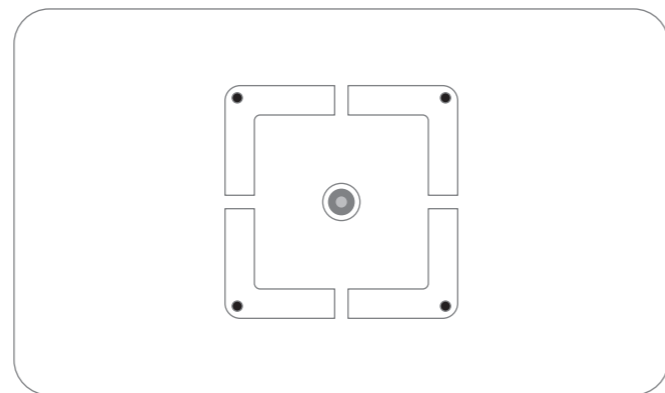

Square Kiosk (back)

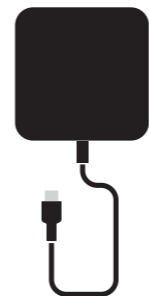

Power adapter



Power adapter cable



Hub

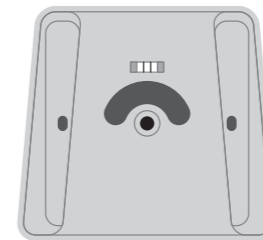

Angled bracket with built-in level

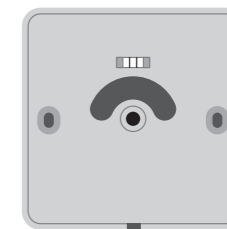

Flat bracket with built-in level



Adapter for iPad Air and iPad Pro



Drywall drill bit



Long PH2 screwdriver bit

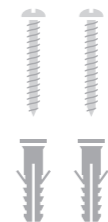

Wall screws (x2) and wall anchors (x2)

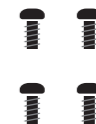

VESA screws



Security screw

HOW DO YOU WANT TO SET UP SQUARE KIOSK?

There are four different ways you can set up Square Kiosk. Read below to pick which best fits your business needs.

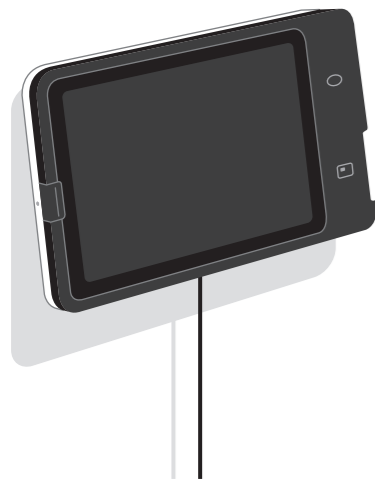

ANGLED WALL MOUNT

Positions the screen at an upward angle toward staff and customers

Go to page 6.

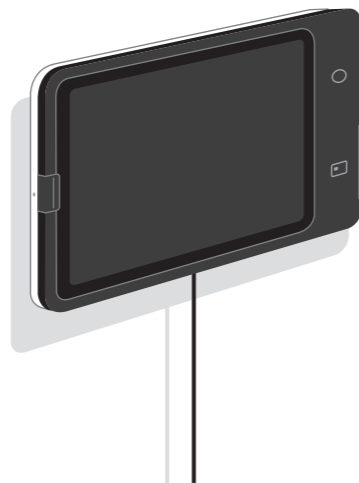

FLAT WALL MOUNT

Has a slim, space-saving profile that sits flat against the wall

Go to page 8.



COUNTERTOP MOUNT

Creates a low-profile countertop setup that angles the screen upwards

Go to page 10.

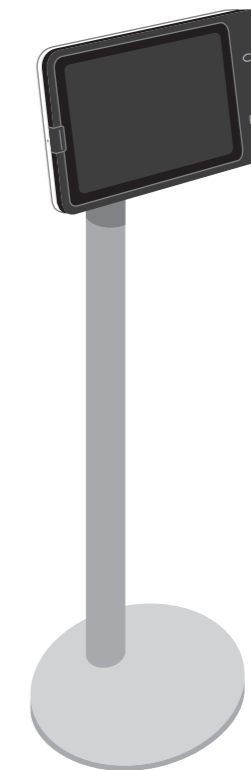

VESA MOUNT

Uses any 100 mm x 100 mm VESA mount to attach a standalone pedestal, swing arm or other setup option

Go to page 12.

ANGLED WALL MOUNT

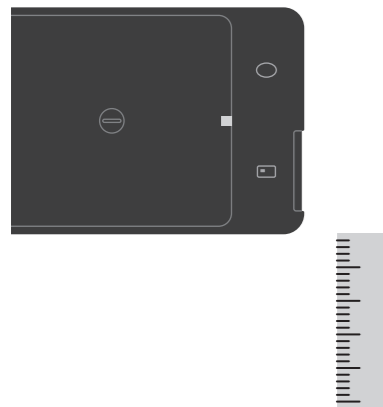

1 Pick a spot on your wall

Hold up Square Kiosk against the wall to find your preferred height. Avoid placing over studs.

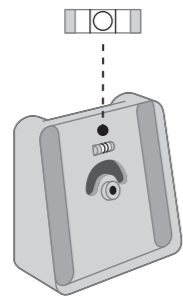

2 Position the angled bracket

Level the bracket on the wall, then mark the position of the screw holes with a pencil.

What you need from the box

- Angled bracket
- Square Kiosk
- Hub
- Power adapter cable
- Power adapter

- Wall screws (x2)
- Wall anchors (x2)
- Long PH2 screwdriver bit
- Plasterboard drill bit
- Security screw (optional)

What you need that's not in the box

- Drill
- Stud finder
- Pencil
- PH2 Phillips screwdriver
- PH1 Phillips screwdriver (optional)

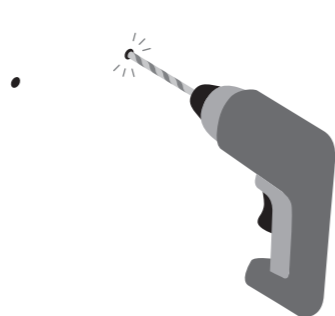

3 Drill the holes you just marked

For plasterboard installation, use the included plasterboard drill bit.

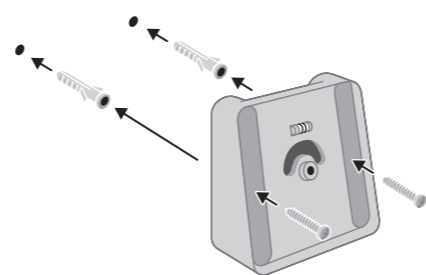

4 Screw the angled bracket into the wall

Insert the wall anchors into the drill holes. Position the angled bracket, then insert the wall screws into the front and screw in, making sure the bracket is level as you fully tighten.

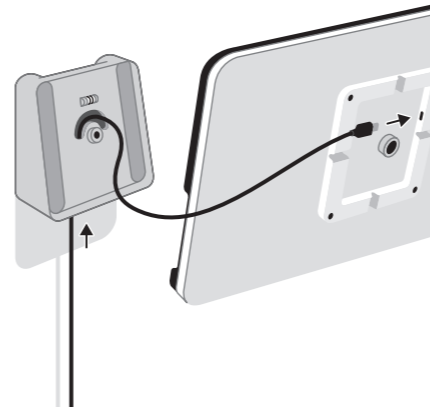

5 Plug the hub in to Square Kiosk

Starting from the bottom of the bracket, thread the hub's USB-C cable through the pass-through hole and into the connector on the back of Square Kiosk.

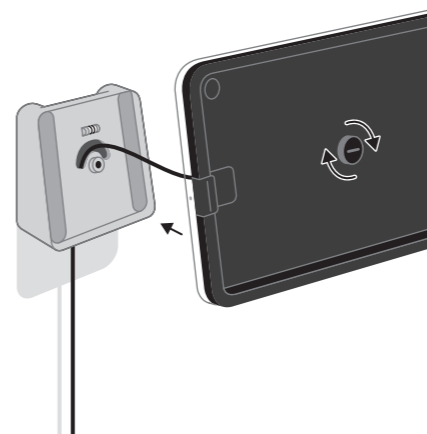

6 Place Square Kiosk into the bracket

Tighten the centre mounting screw until you cannot see any of the red sidewall on the screw. Make sure it is secure and does not wiggle.

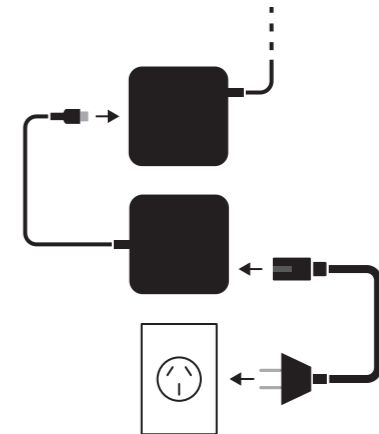

7 Plug in Square Kiosk

Plug the power adapter's USB-C cable into the hub, then plug one end of the power adapter cable into the power adapter and the other into a power point.



8 Slide your iPad in and secure it

Dock your iPad to the connector and make sure the security latch clicks. **Optional:** To further secure your iPad, use a PH1 Phillips screwdriver to attach the security screw to the side of Square Kiosk.

Additional installation options: For installation on other surfaces, like concrete or brick, or to hide cords when installing, go to square.com/go/kiosk-setup.

Removing your iPad from Square Kiosk: If you used the optional security screw, first unscrew it. You can then take your iPad out by pulling out then pushing down on the raised security latch located next to the iPad's camera. Once unlatched, carefully slide the iPad out to the left.

FLAT WALL MOUNT

What you need from the box

- Flat bracket
- Square Kiosk
- Hub
- Power adapter cable
- Power adapter

What you need that's not in the box

- Drill
- Stud finder
- Pencil
- PH2 Phillips screwdriver
- PH1 Phillips screwdriver (optional)

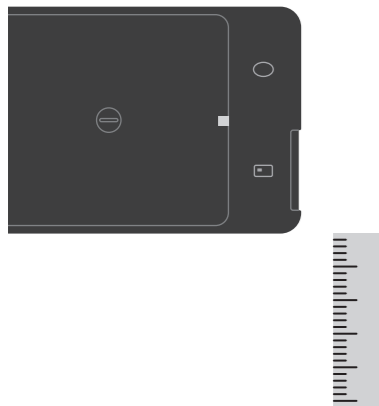

1 Pick a spot on your wall

Hold up Square Kiosk to find your preferred height on the wall. Avoid placing over studs.

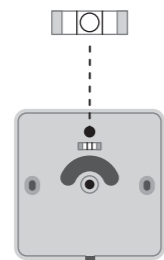

2 Position the flat bracket

Level the bracket on the wall, then mark the position of the screw holes with a pencil.

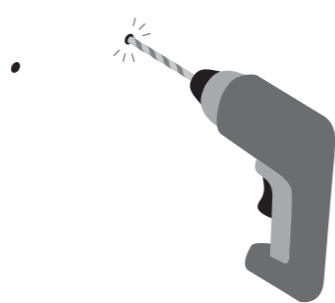

3 Drill the holes you just marked

For plasterboard installation, use the included plasterboard drill bit.

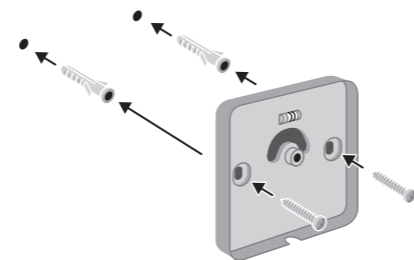

4 Screw the flat bracket into the wall

Insert the wall anchors into the drill holes. Position the flat bracket, then insert the wall screws into the front and screw in, making sure the bracket is level as you fully tighten.

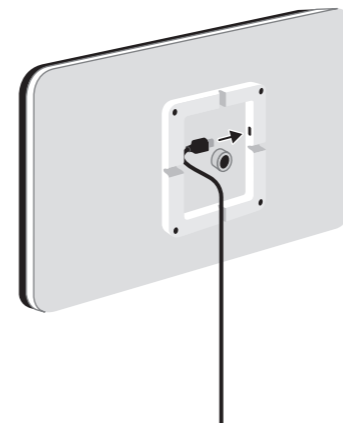

5 Plug the hub into Square Kiosk

Press the hub's USB-C cable into the cable channel on the back of Square Kiosk. Check that there is no interference between the cable and the mount screw.

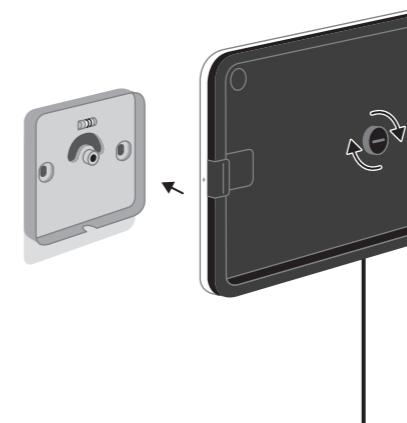

6 Place Square Kiosk into the bracket

Tighten the centre mounting screw until you cannot see any of the red sidewall on the screw. Make sure it is secure and does not wiggle.

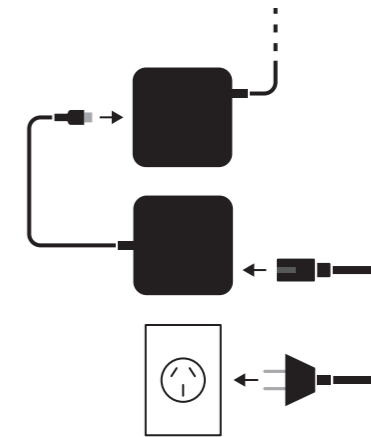

7 Plug in Square Kiosk

Plug the power adapter's USB-C cable into the hub, then plug one end of the power adapter cable into the power adapter and the other into a power point.

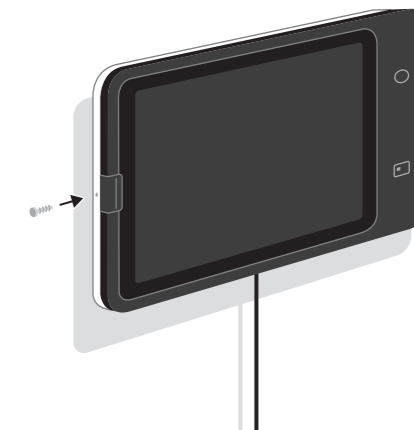

8 Slide your iPad in and secure it

Dock your iPad to the connector and make sure the security latch clicks. **Optional:** To further secure your iPad, use a PH1 Phillips screwdriver to attach the security screw to the side of Square Kiosk.

Additional installation options: For installation on other surfaces, like concrete or brick, or to hide cords when installing, go to square.com/go/kiosk-setup.

Removing your iPad from Square Kiosk: If you used the optional security screw, first unscrew it. You can then take your iPad out by pulling out then pushing down on the raised security latch located next to the iPad's camera. Once unlatched, carefully slide the iPad out to the left.

COUNTERTOP MOUNT

What you need from the box

- Angled bracket
- Square Kiosk
- Hub
- Power adapter cable
- Power adapter

What you need that's not in the box

- PH1 Phillips screwdriver (optional)

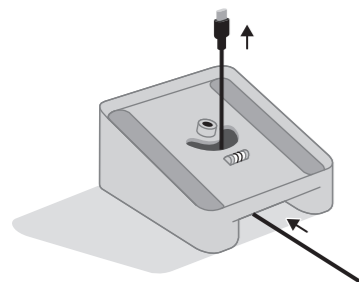

1 Pick a spot on your counter

With the angled bracket facing you as shown, pass the hub's USB-C cable through the hole.

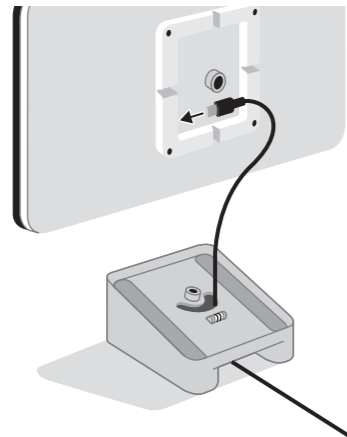

2 Plug the hub into Square Kiosk

Make sure the hub's USB-C cable is firmly pushed in.

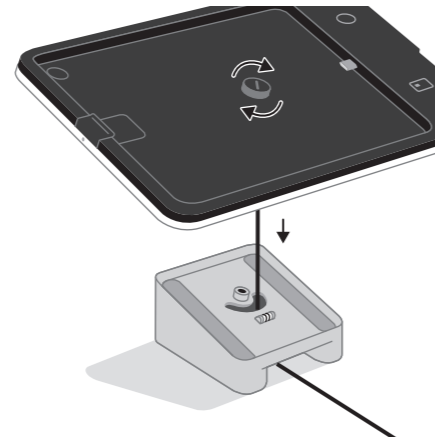

3 Place Square Kiosk into the bracket

Tighten the centre mounting screw until you cannot see any of the red sidewall on the screw. Make sure it is secure and does not wiggle.

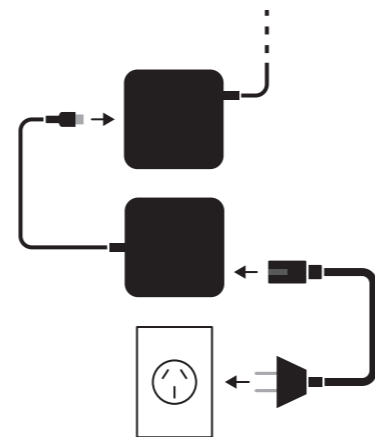

4 Plug in Square Kiosk

Plug the power adapter's USB-C cable into the hub, then plug one end of the power adapter cable into the power adapter and the other into a power point.

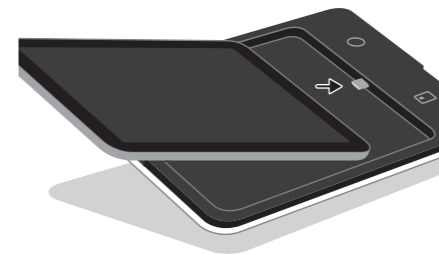

5 Slide your iPad in

Dock your iPad to the connector and make sure the security latch clicks.



6 Optional: secure your iPad

Using a PH1 Phillips screwdriver, attach the security screw to the side of Square Kiosk to further secure your iPad.

Removing your iPad from Square Kiosk: If you used the optional security screw, first unscrew it. You can then take your iPad out by pulling out then pushing down on the raised security latch located next to the iPad's camera. Once unlatched, carefully slide the iPad out to the left.

VESA MOUNT

Connect Square Kiosk to a third-party VESA system. Before you begin setting up, make sure you have the installation guide that came with the VESA mount you are using.
Note: Square Kiosk is only compatible with 100 mm x 100 mm VESA plates.

What you need from the box

- Square Kiosk
- Hub
- Power adapter cable
- Power adapter
- VESA screws (x4)
- Security screw (optional)

What you need that's not in the box

- PH2 Phillips screwdriver
- PH1 Phillips screwdriver (optional)



1 Plug the hub in to Square Kiosk

Decide which side you want the hub's USB-C cable to exit, then slot it into the cable channel, or if VESA mount allows, run the cable through the VESA mount.

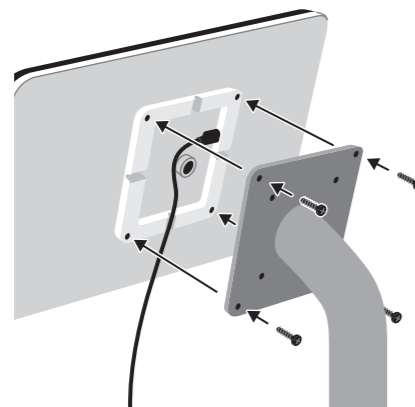

2 Screw Square Kiosk onto the VESA plate

Align the 100 mm x 100 mm VESA plate screw holes with the threads on the back of the Square Kiosk and screw on.

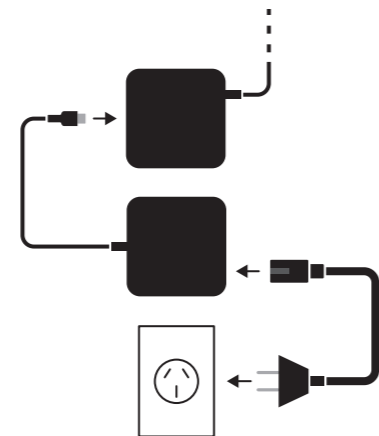

3 Plug in Square Kiosk

Plug the power adapter's USB-C cable into the hub, then plug one end of the power adapter cable into the power adapter and the other into a power point.

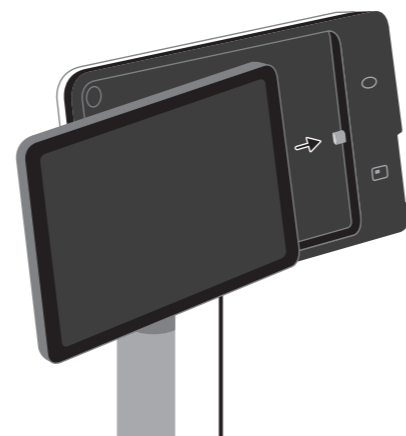

4 Slide your iPad in

Dock your iPad to the connector and make sure the security latch clicks.

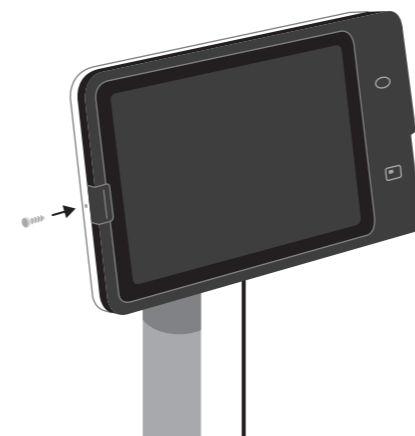

5 Optional: secure your iPad

Using a PH1 Phillips screwdriver, attach a security screw to the side of Square Kiosk to further secure your iPad.

Removing your iPad from Square Kiosk: If you used the optional security screw, first unscrew it. You can then take your iPad out by pulling out then pushing down on the raised security latch located next to the iPad's camera. Once unlatched, carefully slide the iPad out to the left.

GET THE SQUARE KIOSK APP

Keep your staffing costs in line – not your customers. The Square Kiosk app keeps your front- and back-of-house in sync with instant menu updates and real-time sales data. To get your self-service ordering kiosk up and running, **download the Square Kiosk app** and subscribe for an additional monthly fee.

To learn more about pairing accessories when running the Square Kiosk app, go to square.com/go/kiosk-support.

Scan to download
the Square Kiosk app

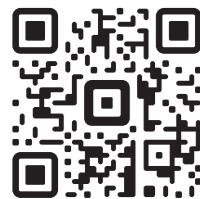

USE THIS HARDWARE AS A POS

To use this compact device as a mounted POS, simply find the software that fits your business – from free, easy-to-use payment solutions to custom-tailored solutions for restaurants, retail and appointments. Learn more at square.com.

When using Square Kiosk as a POS, you can easily connect a barcode scanner, receipt printer, cash drawer or other USB-A accessories via the USB hub. Some accessories may need additional setup by going to **Settings > Hardware** in the Square app. When using Square Kiosk as a POS in iPad powered mode, you won't be able to use accessories. For a complete list of compatible accessories, including Ethernet and Bluetooth-enabled printers and scanners, visit square.com/go/kiosk-accessories.

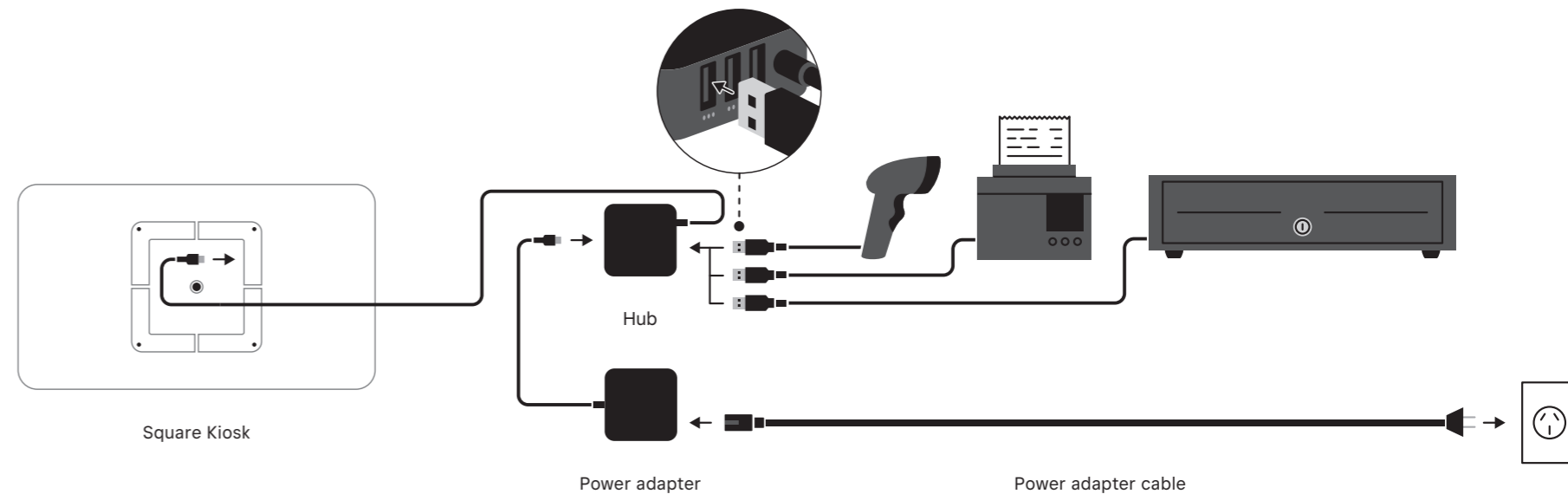

TAKE PAYMENTS AND STAY POWERED UNPLUGGED

Go from setup to sale in no time at all. Plus, with iPad powered mode, Square Kiosk runs off iPad battery, so losing power or unplugging never gets in the way of selling.



1 Insert

Insert a chip card into the blinking card slot.



2 Tap

The flashing contactless icon shows where to tap a contactless card or mobile device.

HELP AND SUPPORT

Read our FAQs, learn more about compatible hardware, and get troubleshooting support at square.com/go/kiosk-guide.

FREE 30-DAY RETURNS

Square offers a 30-day, risk-free return policy for all purchases made from square.com/shop/au. Visit square.com/shop/au/return to process your return. After a return is complete, a refund will be credited back to you.

LIMITED WARRANTY

Square provides a limited warranty for your Square Kiosk against defects in materials and workmanship under normal use for a period of one (1) year from the shipping date. If such defect appears within one (1) year from the shipping date, Square will replace Square Kiosk at no cost to you. To learn more, please visit square.com/warranty.

This warranty is in addition to other rights and remedies you may have under the consumer guarantees provisions of the Australian Consumer Law. Our goods come with guarantees that cannot be excluded under the Australian Consumer Law. You are entitled to a replacement or refund for a major failure and compensation for any other reasonably foreseeable loss or damage. You are also entitled to have the goods repaired or replaced if the goods fail to be of acceptable quality and the failure does not amount to a major failure. You can find more information about the Australian Consumer Law by visiting acc.gov.au.

CLAIMS PROCEDURE

To claim under the limited warranty, contact Square Support at square.com/help. You will be asked to:

1. Return the defective Square Kiosk to Square at the designated address below and in the designated box, with all accessories, cords, cables, parts and documentation included, within fourteen (14) days of receiving your replacement hardware.
2. Provide a credit card number to Square when you initiate a warranty-based return. In the event you fail to return your defective Square Kiosk pursuant to the process and time frame specified by Square, Square will charge the full cost of the replacement Square Kiosk to the credit card you provided when you initiated your warranty-based return or to your Square account (if there is a balance).

Square's address for warranty-based returns is as follows:

DB Schenker
Dock 7
1 Aviation Road
Hoxton Park, NSW 2171



Your use of the Square app and Square Kiosk, including any warranties associated with these products, is governed by your agreements with Square and related policies available at square.com/legal. Square and the Square logo are trademarks of Block, Inc. iPad, iPad Air, and iPad Pro are trademarks of Apple Inc., registered in the U.S. and other countries. Other marks and brands are the property of their respective owners.

© 2024 Block, Inc., 1955 Broadway, Ste. 600, Oakland, CA 94612. Squareup Pte. Ltd., 8 Marina Boulevard #05-02, Marina Bay Financial Centre, Singapore (018981). M-LIT-0315-02