

RECASTAL
BY DYWIDAG



RECASTAL[®] Foundation formwork

Fully self-supporting foundation formwork up to 100 cm

RECOSTAL® Foundation formwork

RECOSTAL® Foundation formwork is a complete assembly system with key profiled shuttering units. The accessories support the system and enable the unobstructed installation of the reinforcement.

The top S-hook is placed before concrete pour.

The formwork is self-supporting up to a height of H=1,0 m.

The distance of the accessories is always $\leq 1,0$ m. The tube diameter varies depend on the height of foundations.

The Benefits

- Fully self-supporting up to 100 cm
- Highly time-efficient
- No separate concrete pour
- Installation without crane
- No relocation of formwork

Self-supporting foundation formwork type FS and ES as complete assembly system with trapezoidal profiled formwork units. All parts are precision-made and pre-fabricated according to the layout plan. Due to the form ties and formbraces (accessories) provided with the formwork units, the system is self-supporting up to a formwork height of H=1,0 m.

Type FS

Max. length of the formwork units [m]	Formwork height [m]	Formwork width [m]
L=3,1	H= 0,25 to 1,25 (greater heights on request)	B=0,2 to 1,2 (greater widths as type ES)

Type ES

Max. length of the formwork units [m]	Formwork height [m]	Formwork width [m]
L=3,1	H=0,25 to 1,25 (greater heights on request)	B > 1,20 m

Foundation formwork type ET as an assembly system with trapezoidal profiled formwork units. All parts are precision-made and pre-fabricated according to the layout plan. Overlaps are fixed with hexagon head screws, which are included in the delivery. In order to withstand concrete pressure, the units are supported on site by placing backfill material.

Type ET

Max. length of the formwork units [m]	Formwork height [m]
L=3,1	H=0,25 to 1,6 (greater or smaller heights on request)

Installation of Type FS

Step 1

Setting bars and formworks.



Step 2

Application of tubes on bars.



Step 3

Stabilize formworks with clips inserted into the tubes.



Step 4

Stabilize the width of formwork with S-hook



Installation of type ES is similar. Installation of type ET can be fixed with self-tapping screws.

Technical details

- Technical Department receives foundation plan in CAD, pdf-file or foundation guidelines and work out the formwork layout in CAD.

- **Layout plans**

Position plan for Customer is an integral part of every project and contains all installation detail. Parts are clearly defined by colors and symbols.

- **Sticker/label**

All parts are marked with a label. The label contains all details concerning bending, installation direction and dimensions of formwork units.

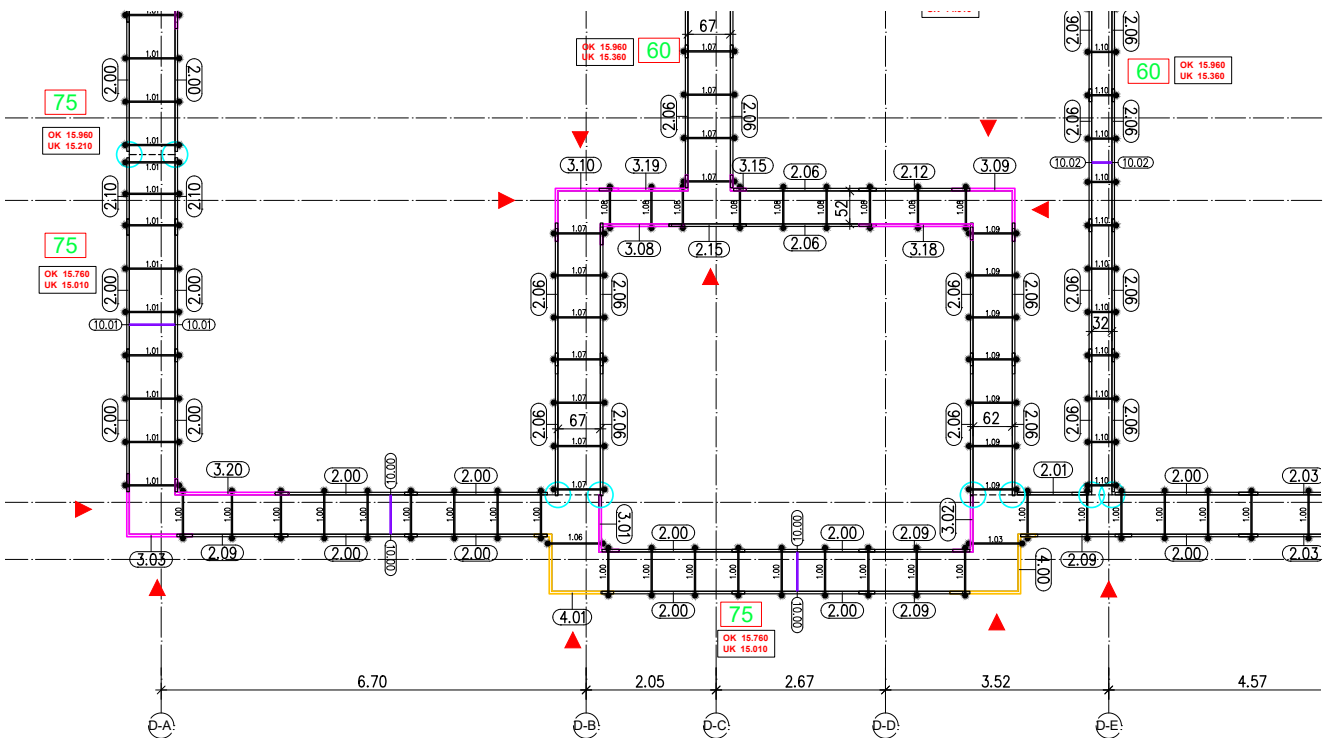
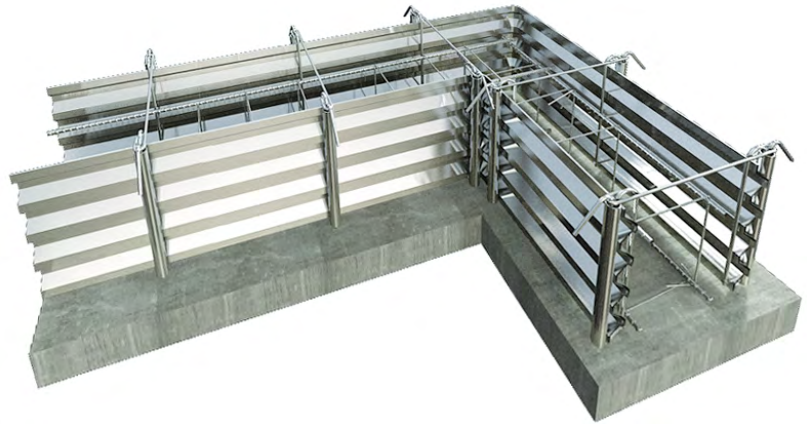

dywidag.com

Get in touch.

For local contact details, please visit our website.



© Copyright 2023 DYWIDAG. All rights reserved. Specifications subject to change without notice.

dywidag.com/contact