

**FLOYD**

**Chaise**

# Components

---

**4x**      **Chaise Legs**

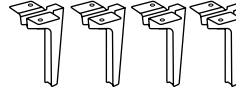

---

**12x**      **Knobs**



**A**

---

**2x**      **Connector Plates**



---

**1x**      **Chaise Panel**

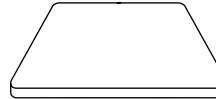

---

**1x**      **Chaise Cushion**

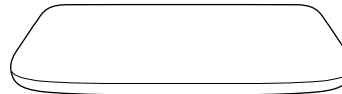

# 1

## Assemble the chaise

**Begin by attaching the four legs to the bottom of the chaise panel with the knobs** (We recommend doing this on a rug or the packaging it came in to protect the surface of the panel).

**When all four legs are attached, flip over the chaise panel.**

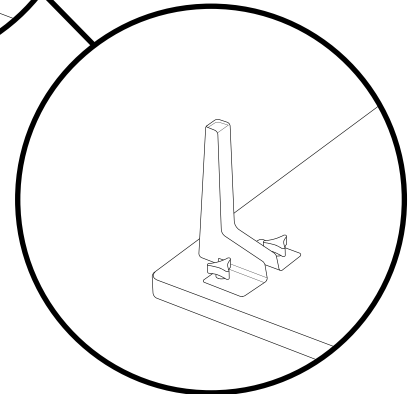
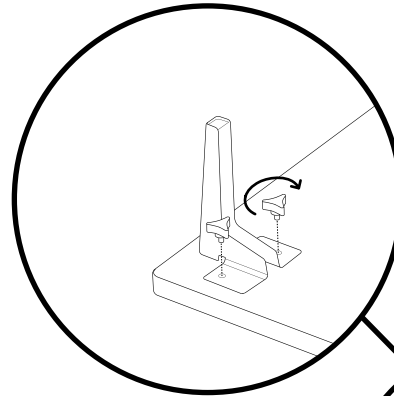
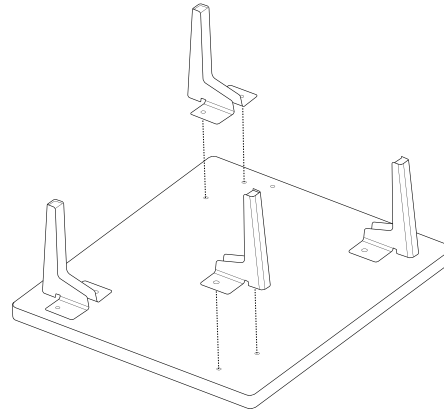

# 2

## Attach the chaise

**Place the chaise panel on the side of the sofa where you want to attach it** (it can go on either the left or right side, and you can always switch it later!)

**Take the two chaise connector plates and attach them to the bottom of chaise panel with two knobs.**

**The side of the plate with the longer slotted hole should attach to the bottom of the main sofa seat panel. Use the last two knobs to fasten the chaise connector plates to the main seat panel.**

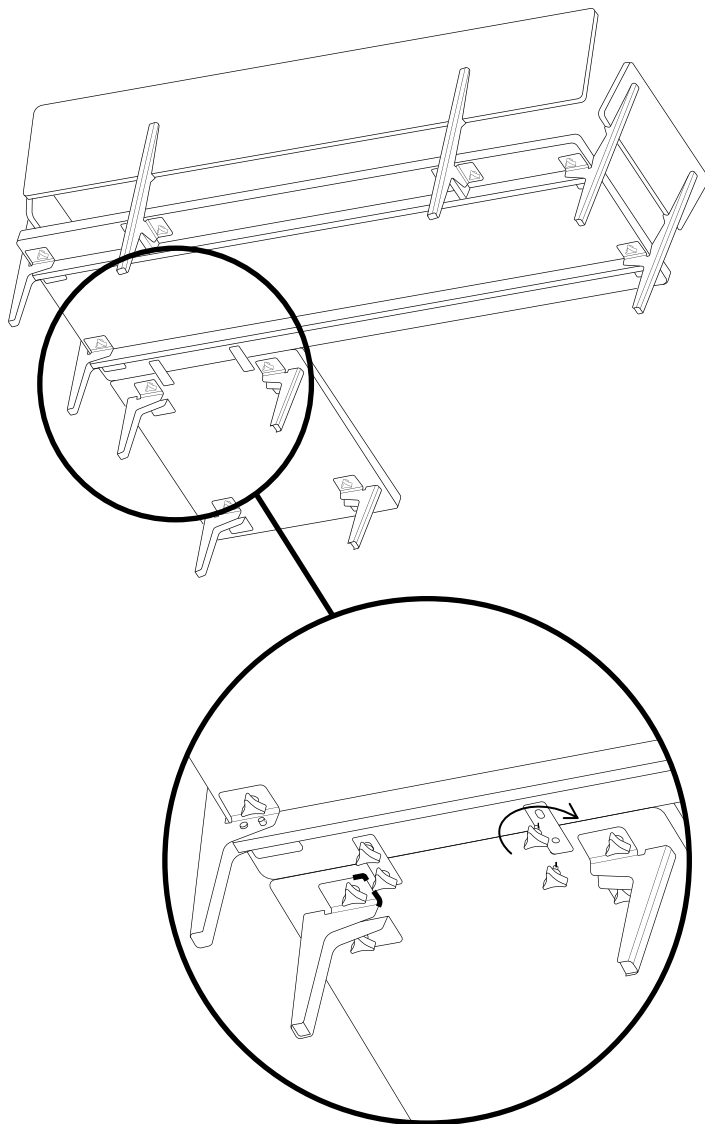

# 3

**All done!**

**On the side where the chaise is attached, replace the seat cushion with the long chaise cushion.**

**Note:** The chaise cushion should be placed so that the zipper pull is at the front of the sofa.

**That's it - you're done!**

**@floyddetroit  
#thefloydsofa**

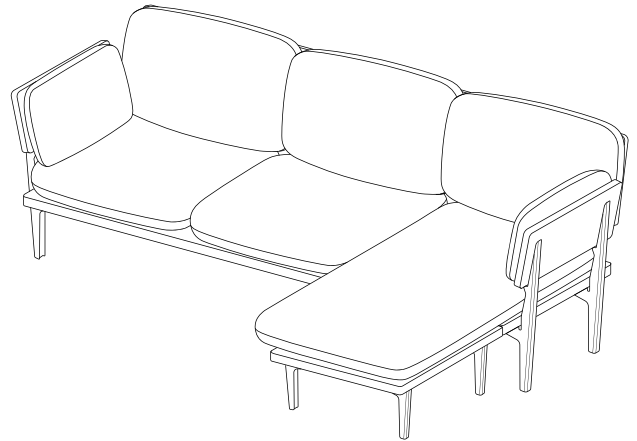

## **⚠ WARNING**

### **ASSEMBLY:**

Use extra caution when assembling and have someone assist you. Do not change the specifications or modify this product or use for any other purpose beyond its intended use as a sofa. Incorrect assembly can cause product to fail and cause personal injury. Double check that all fasteners are tightened and all pins are securely in place before use. Ensure that the back and arm panels are securely fastened to the legs and cushions are in place before using. Use caution and have someone assist you when assembling and flipping over the sofa during assembly.

### **USAGE:**

Remove all packaging before first use. Check periodically that all fasteners and pins are securely tightened and in place. Be aware that fasteners may become loose with prolonged use. The legs, panels, cushions, and hardware components are only intended as shown for use with the Floyd Sofa. The sofa is only meant for use indoors. The sofa has a tested capacity of 300lbs per seat. Loading it with more than this can cause personal risk and injury. Standing on, jumping on, or sitting on the arm or back panels may cause personal risk or injury.

### **CHILDREN:**

Exercise caution when children are near or sitting on sofa. Do not allow children to play under sofa or jump on sofa. There is a risk of injury from not following these warnings. Keep all packaging and parts away from children. There is a risk of choking and suffocation.

### **CARE:**

#### **GENERAL SPILLS:**

For mild spills, blot with a paper towel. For tougher spills, use a mild soap and water mix. To make the soap and water mixture, take 1 teaspoon of a liquid detergent such as Tide and mix it with 16 oz. of water in a bowl or plastic container – do not over wet the material. Cushion covers should not be removed and laundered – doing so could negate the stain-resistant technology.

## **CONTACT**

Have a question,  
comment, or suggestion?  
Just want to say hi?

[hello@floydhome.com](mailto:hello@floydhome.com)

[FLOYDHOME.COM](http://FLOYDHOME.COM)

Visit the Floyd Shop

The Floyd Shop  
1948 Division St. Suite 101  
Detroit, MI 48207

**FLOYD**

**FLOYDHOME.COM**