

## Seirin MOXSAFE (For "Acupuncture Needling with Moxibustion" Use)

Please read and understand this information thoroughly before using this product, in order to perform "needling with moxibustion" safely and effectively. In addition, please keep these instructions together with the product until you have finished using it.

### Introduction

- This product should only be used by a physician or licensed acupuncturist.
- Since moxibustion is a therapy, in which moxa is being burned on the skin, please do not use MOXSAFE on individuals who wish to avoid any sort of risk.
- Since this product demonstrates different types of heat, the practitioner should experience and understand the characteristics of the heat by him/herself, before using the product on the patient.

### Characteristics

- Safe ○ Almost no smoke ○ Only with slight odor ○ Easy handling ○ Light weight ○ Clean because of its disposability



#### Warning

If you touch the needle or the specialized cap when it is heated, you could get burned.

Use metal handle needle which has at least thickness of 0.20mm and has at least 3cm from the surface of the skin. Be sure that needle is fixed and never fall while the insertion.

### Directions for Use

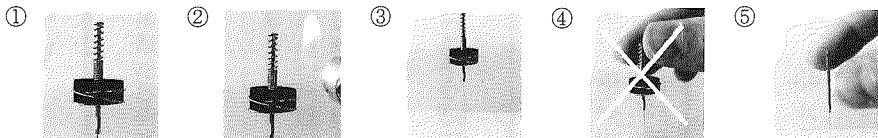

- ① Please place MOXSAFE on the handle of an acupuncture needle that has been inserted.
- ② Light the carbonized moxa upper part with an ignition device, so that the flames do not come into contact with the cap head. In addition, be certain that the flame does not reach the needle shaft.
- ③ It will take approximately 6 minutes from the time that the MOXSAFE has been lit and burnt out until the needle handle has cooled down.
- ④ Since MOXSAFE may still be hot, be sure to use tweezers or other such instruments when removing it from the needle-never use the bare hand to remove MOXSAFE.
- ⑤ Please withdraw the needle after the needle handle has cooled down sufficiently.

### Precautions for use

- Please do not use MOXSAFE for any purpose other than for needling with moxibustion.
- Use SEIRIN needles with metal handle.
- Please be absolutely sure that the MOXSAFE fits securely into the needle handle before conducting treatment.
- If at all possible, use MOXSAFE with the acupuncture needle positioned in a perpendicular direction.
- Provide a protective measure on the patient's skin, just in case the carbonized moxa should fall.
- Do not light from the lower part of the carbonized moxa.
- Since it is hard to light this MOXSAFE with an incense stick, please light it carefully with the flame of the lighter.
- Before using this product, make sure that there aren't any cracks in the carbonized moxa, because cracked moxa may fall down.
- Use MOXSAFE more than 3 cm above the skin's surface.
- Do not use the carbonized moxa on sensitive areas of the skin, such as the face.
- Remember that low temperature burns may occur even if one does not perceive strong heat. It should also be kept in mind that sensitive areas of the skin may burn easily.
- This product is a disposable. Do not re-use the cap.
- If moxa, other than this carbonized moxa, is used in the cap, product failure may occur.
- Dispose of the used cap in a manner that conforms with your local laws and ordinances.
- Please be sufficiently careful about providing indoor ventilation.

### Precautions for Storage

- Since MOXSAFE turns to powder when subjected to friction, if at all possible do not shake it after opening.
- Please store MOXSAFE with the instructions, in a place where there is minimal moisture and no odor.
- This MOXSAFE is not suitable for long term storage because it easily absorbs moisture and odors.

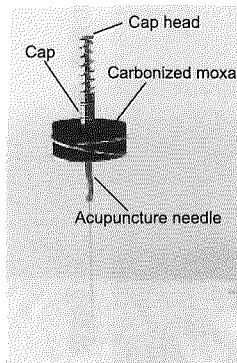

When you have questions concerning this product, please contact us;

SEIRIN Corporation

1007-1 Sodeshi-cho, Shimizu-ku, Shizuoka-shi, Shizuoka  
424-0037 Japan / <http://www.seirin.jp>

Dist by : SEIRIN-America, Inc.

230 Libbey Parkway Weymouth, MA 02189 U.S.A.  
<http://www.seirinamerica.com>