

Single Story • 2,889 Finished Sq. Ft. • 3 Bedrooms • 3.5 Baths • Great Room  
Kitchen with Island • Walk-in Pantry • Laundry • Owner's Entry • Flex Room  
Morning Kitchen • Covered Patio • 3-Bay Garage



Ranch (A)



Mountain (B)



Farmhouse (C)



Woodside Homes reserves the right to change floor plans, features, elevations, prices, materials and specifications without notice. All square footages and measurements are approximate. Please see Sales Professional for full details.  
12/2021



### OPTIONS

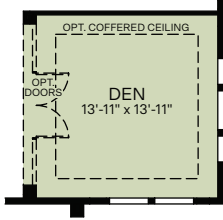

**OPTIONAL DEN ILO FLEX**  
(NOT AVAILABLE WITH DINING OPTION)  
(NOT AVAILABLE WITH MEDIA OPTION)

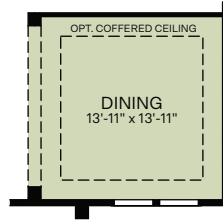

**OPTIONAL DINING ROOM ILO FLEX**  
(NOT AVAILABLE WITH DEN OPTION)  
(NOT AVAILABLE WITH MEDIA OPTION)

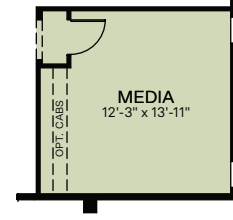

**OPTIONAL MEDIA ILO FLEX**  
(NOT AVAILABLE WITH DEN OPTION)  
(NOT AVAILABLE WITH DINING OPTION)

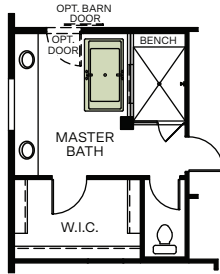

**OPTIONAL FREESTANDING TUB  
AT MASTER BATHROOM**

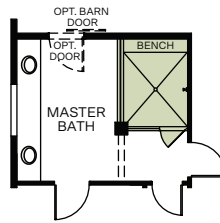

**OPTIONAL FULL GLASS SHOWER  
AT MASTER BATHROOM**

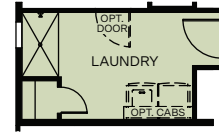

**OPTIONAL DOG WASH STATION WITH CABINETS  
AT LAUNDRY**

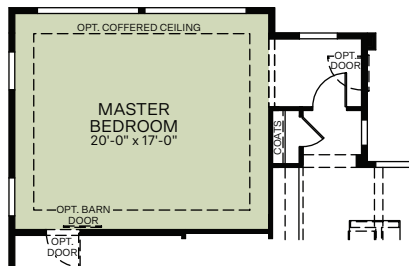

**OPTIONAL MASTER  
BEDROOM EXTENSION**

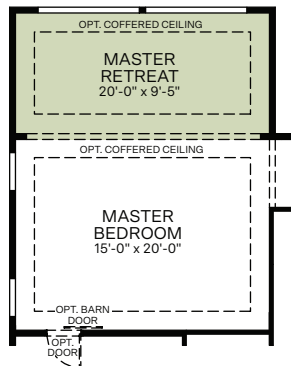

**OPTIONAL MASTER RETREAT**

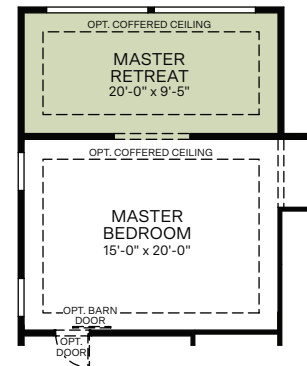

**OPTIONAL PARTIALLY ENCLOSED  
MASTER RETREAT**

## OPTIONS

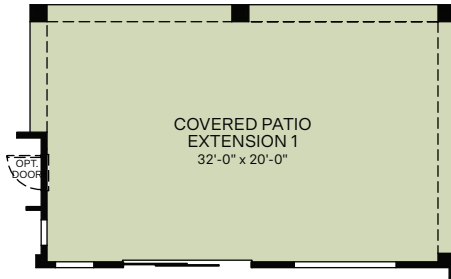

OPTIONAL COVERED PATIO EXTENSION 1

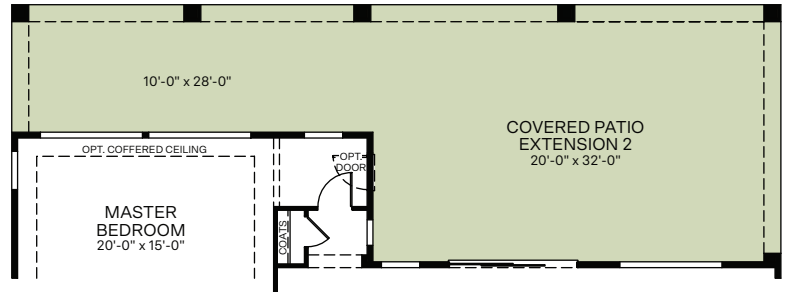

OPTIONAL COVERED PATIO EXTENSION 2

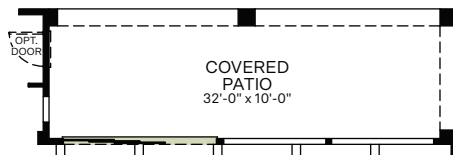

OPTIONAL 12 FT. MULTI-SLIDE DOOR 1  
AT GREAT ROOM

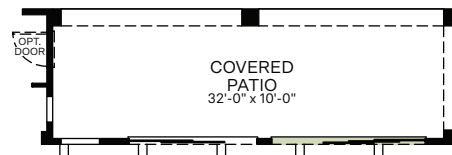

OPTIONAL 12 FT. MULTI-SLIDE DOOR 2  
AT GREAT ROOM

