

Grace / 6028

Single-Story • 2,889 Sq. Ft. • 3 Bedrooms • 3.5 Baths • Great Room • Kitchen with Island • Walk-in Pantry • Laundry • Owner's Entry • Covered Patio • Morning Kitchen • Flex Room • 3-Bay Garage



Spanish (A)



Ranch (B)



Tuscan (C)

Woodside Homes reserves the right to change floor plans, maps, prices, and specifications without notice. Prices are subject to change without notice. The model information listed, including availability, floor plans, elevations, features, and other information are subject to change. Model home interior decorating, landscaping, fencing, and other amenities are for display purposes only. All renderings, floor plans, and maps are artist conceptions and are not intended to be an actual depiction of the buildings, fencing, driveways, or landscaping. Optional features may be included at additional cost and are subject to construction cut-off dates. All square foot measurements, elevations, features, and floor plans are approximate. This advertisement is for illustration purposes only and not part of a legal contract. Please see Sales Representative for full details, and additional information about options shown dashed on base floor plan. Woodside Homes Sales AZ, LLC. 02/2021



#EleganceAtEastmark

WoodsideHomes.com/Arizona

Grace / 6028

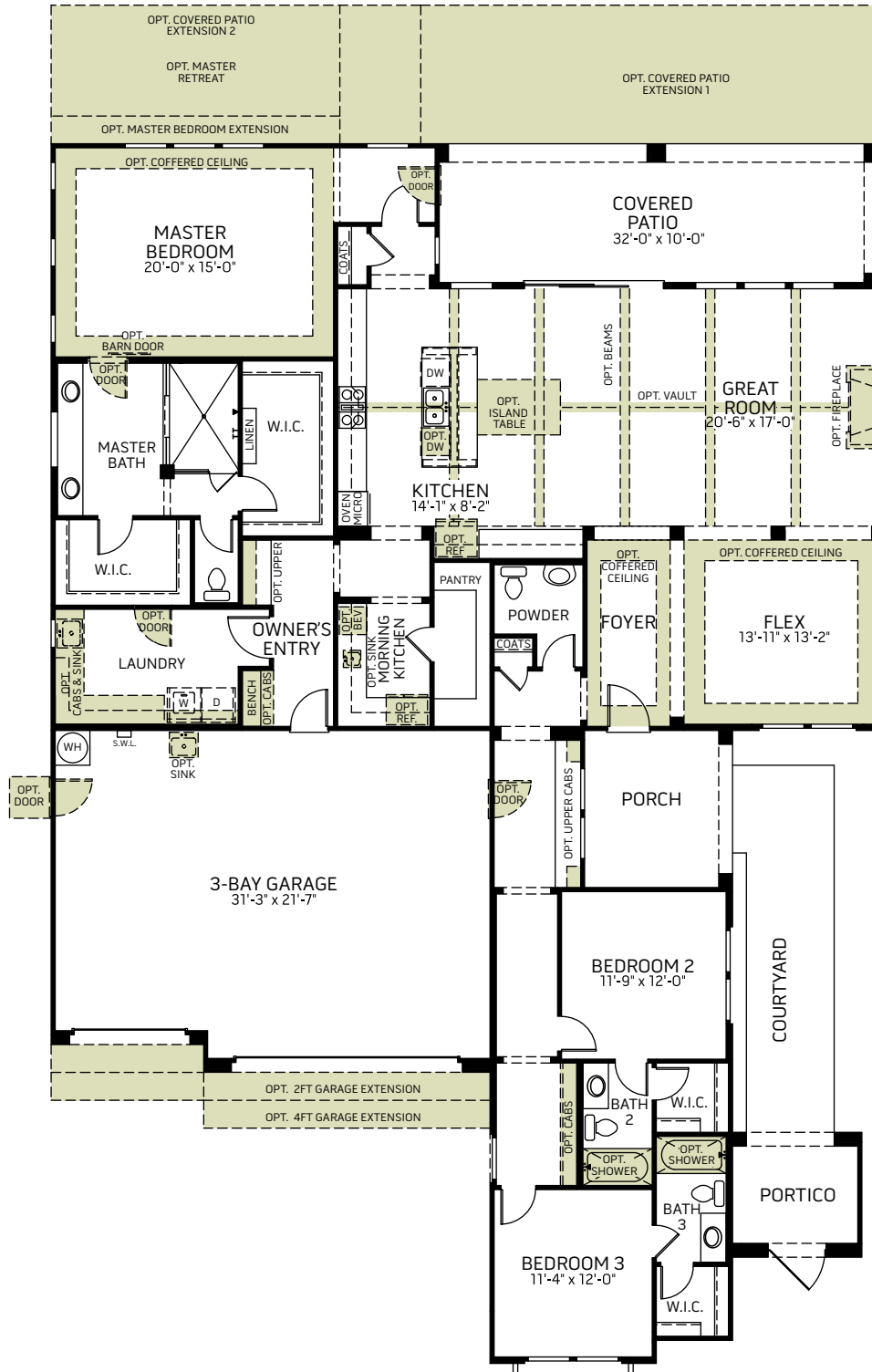

FLOOR PLAN

Woodside Homes reserves the right to change floor plans, maps, prices, and specifications without notice. Prices are subject to change without notice. The model information listed, including availability, floor plans, elevations, features, and other information are subject to change. Model home interior decorating, landscaping, fencing, and other amenities are for display purposes only. All renderings, floor plans, and maps are artist conceptions and are not intended to be an actual depiction of the buildings, fencing, driveways, or landscaping. Optional features may be included at additional cost and are subject to construction cut-off dates. All square foot measurements, elevations, features, and floor plans are approximate. This advertisement is for illustration purposes only and not part of a legal contract. Please see Sales Representative for full details, and additional information about options shown dashed on base floor plan. Woodside Homes Sales AZ, LLC. 02/2021

Grace / 6028

OPTIONS

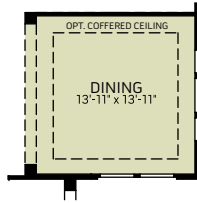

**OPTIONAL DINING ROOM
ILO FLEX**
(not available with den)
(not available with media)

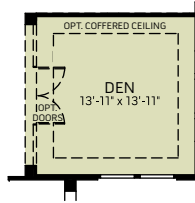

**OPTIONAL DEN
ILO FLEX**
(not available with dining)
(not available with media)

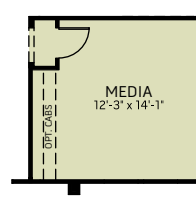

**OPTIONAL MEDIA ROOM
ILO FLEX**
(not available with dining)
(not available with den)

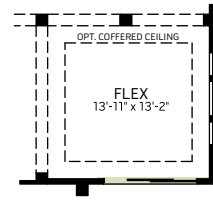

**OPTIONAL 8FT SLIDING GLASS DOOR
AT FLEX ROOM TO COURTYARD**
(also available with dining or den)

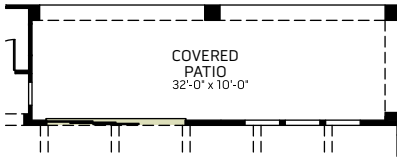

**OPTIONAL 12FT MULTI-SLIDE DOOR #1
AT GREAT ROOM**

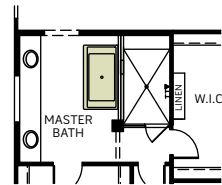

OPTIONAL FREE STANDING TUB

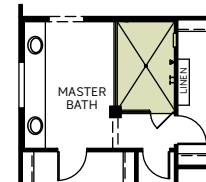

OPTIONAL FULL GLASS SHOWER

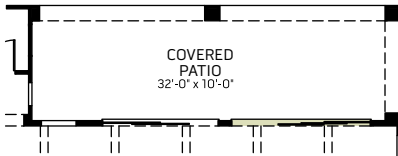

**OPTIONAL 12FT MULTI-SLIDE DOOR #2
AT GREAT ROOM**

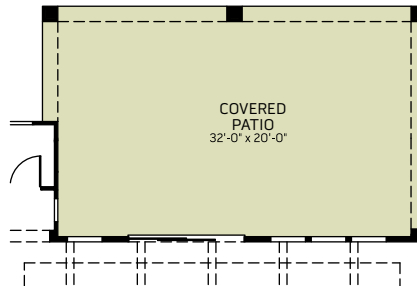

OPTIONAL COVERED PATIO EXTENSION 1

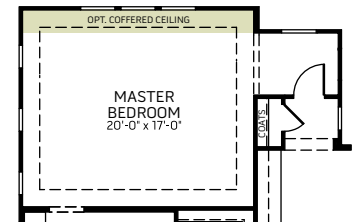

**OPTIONAL MASTER
BEDROOM EXTENSION**
(Not Available With Master Retreat)

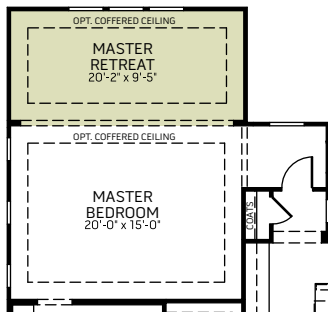

OPTIONAL MASTER RETREAT
(Not Available With Master Extension)

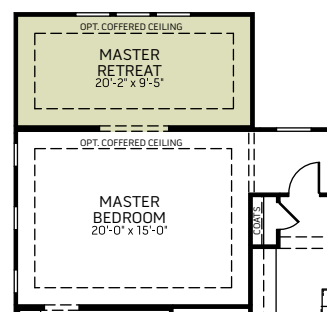

**OPTIONAL MASTER RETREAT
-PARTIALLY ENCLOSED**
(Not Available With Master Extension)

Woodside Homes reserves the right to change floor plans, maps, prices, and specifications without notice. Prices are subject to change without notice. The model information listed, including availability, floor plans, elevations, features, and other information are subject to change. Model home interior decorating, landscaping, fencing, and other amenities are for display purposes only. All renderings, floor plans, and maps are artist conceptions and are not intended to be an actual depiction of the buildings, fencing, driveways, or landscaping. Optional features may be included at additional cost and are subject to construction cut-off dates. All square foot measurements, elevations, features, and floor plans are approximate. This advertisement is for illustration purposes only and not part of a legal contract. Please see Sales Representative for full details, and additional information about options shown dashed on base floor plan. Woodside Homes Sales AZ, LLC. 02/2021



#EleganceAtEastmark

WoodsideHomes.com/Arizona

Grace / 6028

OPTIONS

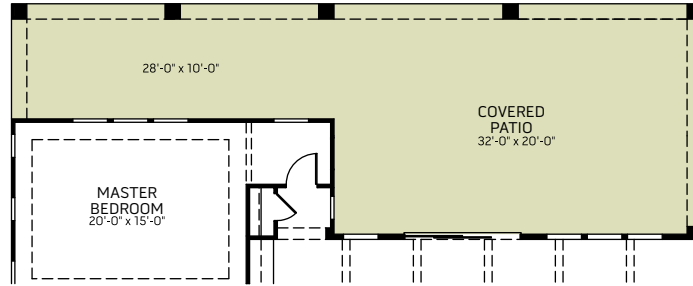

OPTIONAL COVERED PATIO EXTENSION 2

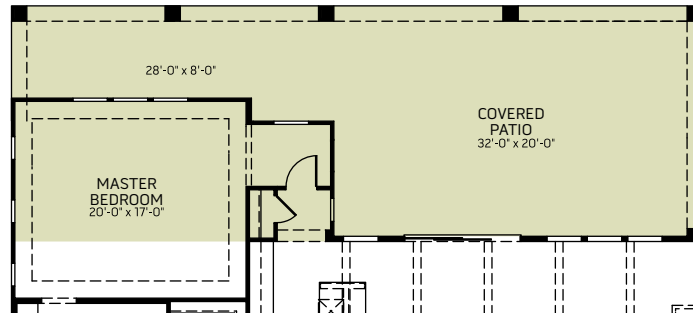

OPTIONAL COVERED PATIO EXTENSION 2 WITH MASTER EXTENSION

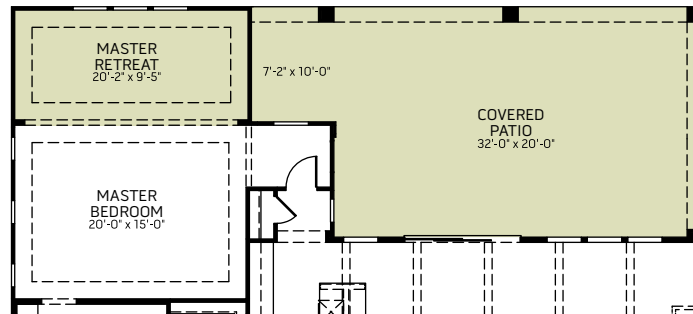

OPTIONAL COVERED PATIO EXTENSION 2 WITH MASTER RETREAT

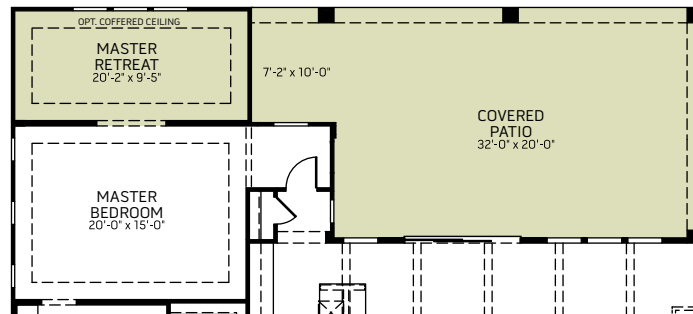

OPTIONAL COVERED PATIO EXTENSION 2 WITH MASTER RETREAT - PARTIALLY ENCLOSED