



Hydraulic Breakers M-Range



Normet reserves the right to change this specification without further notice

Pictures may include options and additional equipment.

INTRODUCTION

Normet Xrock Breakers are made for professional use for excavators from 4 ton up to 100 ton. Breakers can be used on all common applications and tailored for special applications such as underwater jobs and extreme, hot applications. A diverse selection of breakers with small weight differences between 330 kg and 7200 kg ensure perfect match on every carrier.

M-RANGE

M-range is the middle-range, consisting of four breakers designed for applications such as frozen ground and rock breaking, and urban and infrastructure works e.g. demolition and roadside breaking. Their working weights vary from 750 kg to 1650 kg, meant for excavators from 8 ton up to 25 ton. All M-range hammers have a wide selection of tools available. They are vibration and noise dampened, and they have membrane type accumulator, heavy duty hammer housing, and durable polyurethane buffers as a standard. Automatic greasing device and idle blow protection can be selected as an option. Additionally, for special applications we offer optional hot and underwater kits.

normet XROCK®



TECHNICAL SPECIFICATION

HYDRAULIC BREAKERS

XB11

Impact rate	360-670 bpm
Tool diameter	95 mm
Noise level	128 dB

XB14

Impact rate	360-630 bpm
Tool diameter	100 mm
Noise level	128 dB

XB18

Impact rate	460-760 bpm
Tool diameter	115 mm
Noise level	127 dB

XB23

Impact rate	360-550 bpm
Tool diameter	125 mm
Noise level	130 dB

- Pressure hose
- Left side
 - Right side

HYDRAULIC SYSTEM

XB11

Oil flow	60-110 l/min
Operating pressure	120-130 bar
Relief pressure	190 bar
Back pressure max.	10 bar

XB14

Oil flow	70-120 l/min
Operating pressure	120-130 bar
Relief pressure	190 bar
Back pressure max.	10 bar

XB18

Oil flow	80-130 l/min
Operating pressure	130-140 bar
Relief pressure	200 bar
Back pressure max.	10 bar

XB23

Oil flow	100-150 l/min
Operating pressure	130-140 bar
Relief pressure	200 bar
Back pressure max.	10 bar

HOSES

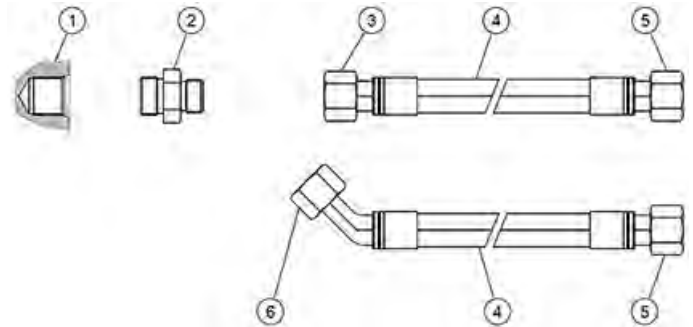

- 1 Breaker port
- 2 Breaker port to hose head (nipple size)
- 3 Head of hose (breaker side)
- 4 Hose
- 5 Head of hose (excavator side)
- 6 Head of hose (breaker side)

IN HOSES

	XB11	XB14	XB18	XB23
Breaker port (1)	3/4"	3/4"	3/4"	1"
Nipple size (2)	3/4" - 36x2"	3/4" - 36x2"	3/4" - 36x2"	1" - 42x2"
Head-breaker (3)	36x2"	36x2"	36x2"	42x2"
Hose size (4)	1"	1"	1"	1"
Head-Excavator (5)	*	*	*	*

OUT HOSES

	XB11	XB14	XB18	XB23
Breaker port (1)	3/4"	3/4"	1"	1"
Nipple size (2)	3/4" - 36x2"	3/4" - 36x2"	1" - 36x2"	1" - 42x2"
Head-breaker (3)	36x2"	36x2"	36x2"	42x2"
Hose size (4)	1"	1"	1"	1"
Head-Excavator (5)	*	*	*	*

*) The measurement depends on the excavator model

Normet reserves the right to change this specification without further notice

Pictures may include options and additional equipment.

TECHNICAL DOCUMENTATION

Standard documents:

Instruction manuals, hard copy 1 pcs:

- English
- Russian
- One of destination EU languages

Spare parts manuals, hard copy 1 pcs:

- English

PDF manuals on USB-stick 1 pcs, includes instruction and spare parts manuals

Additional documentation:

- Extra hard copies of manuals
- Extra PDF manuals
- LinkOne WebView electronic manuals
- Other than standard language manuals
- Dimensional (G.A.) drawings

ACCESSORIES

MAIN ACCESSORIES

- Idle blow protection
- Underwater use kit
- Hot application kit

PROCESS PRODUCTIVITY

- Tools
 - Blunt
 - Moil point
 - Chisel
- Automatic lubrication system
- Pressurized air for keeping the dust particles out
- Two dust suppression water nozzles

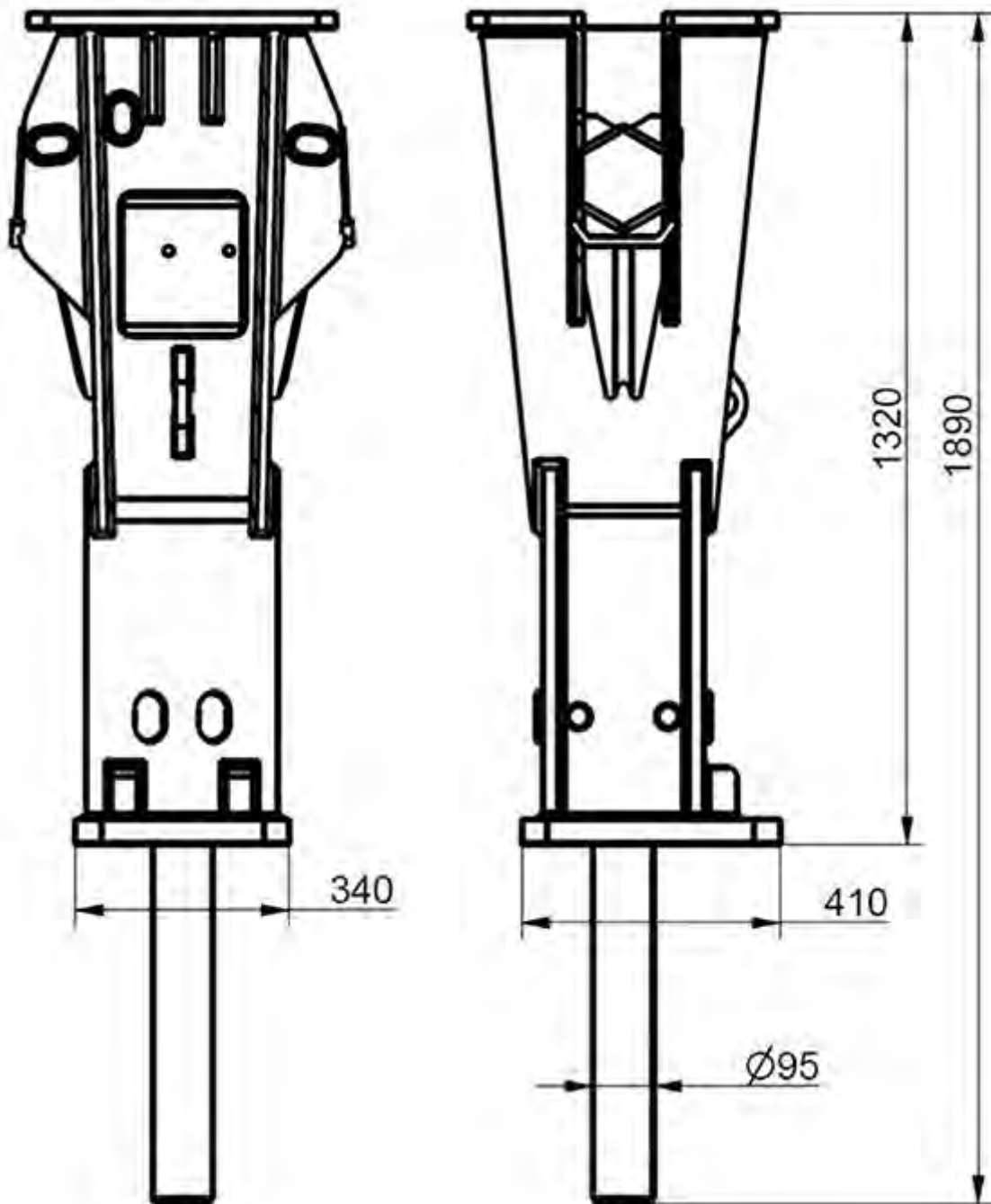
DIMENSIONS**SIDE VIEW XB11**

Normet reserves the right to change this specification without further notice

Pictures may include options and additional equipment.

SIDE VIEW XB14

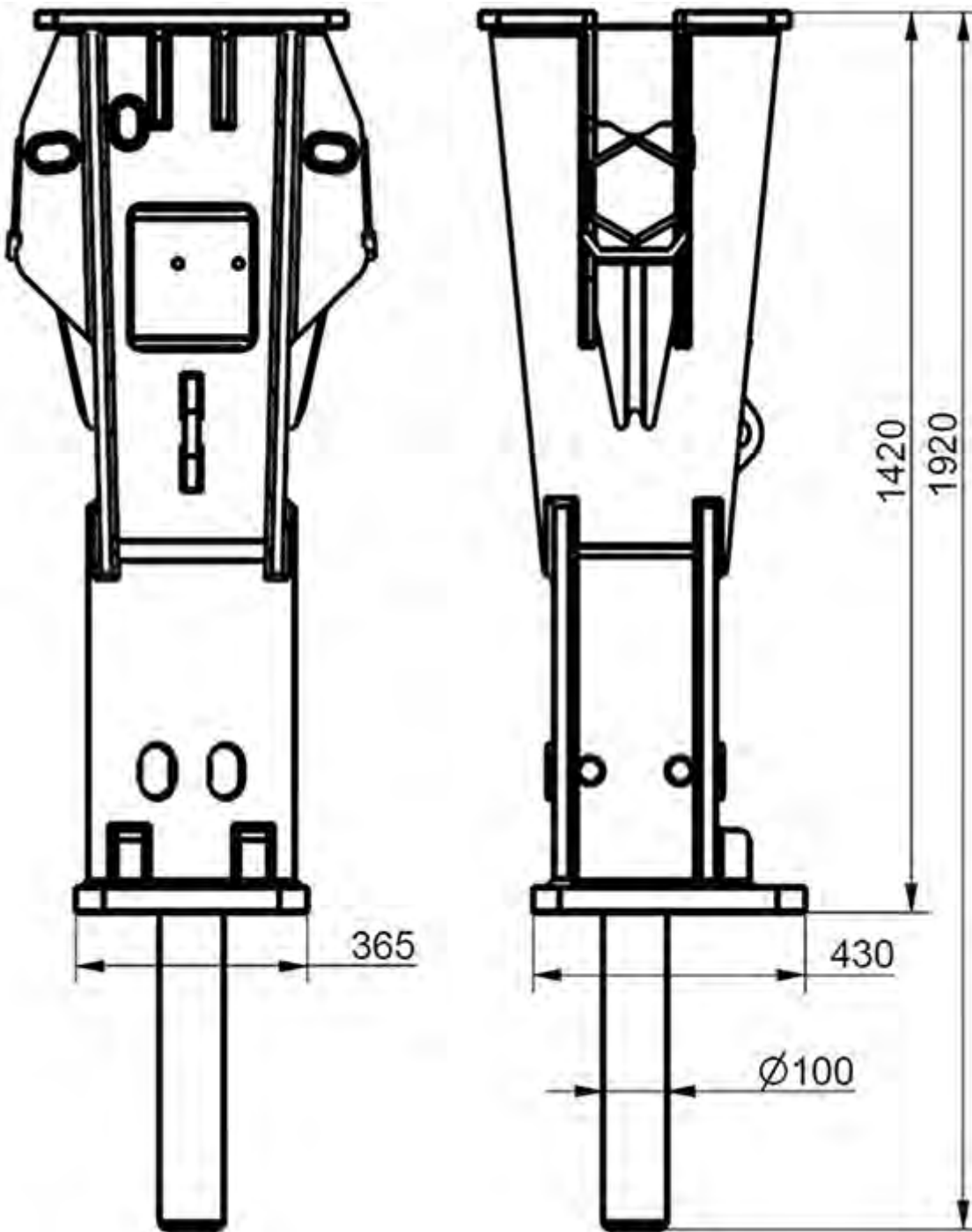

SIDE VIEW XB18

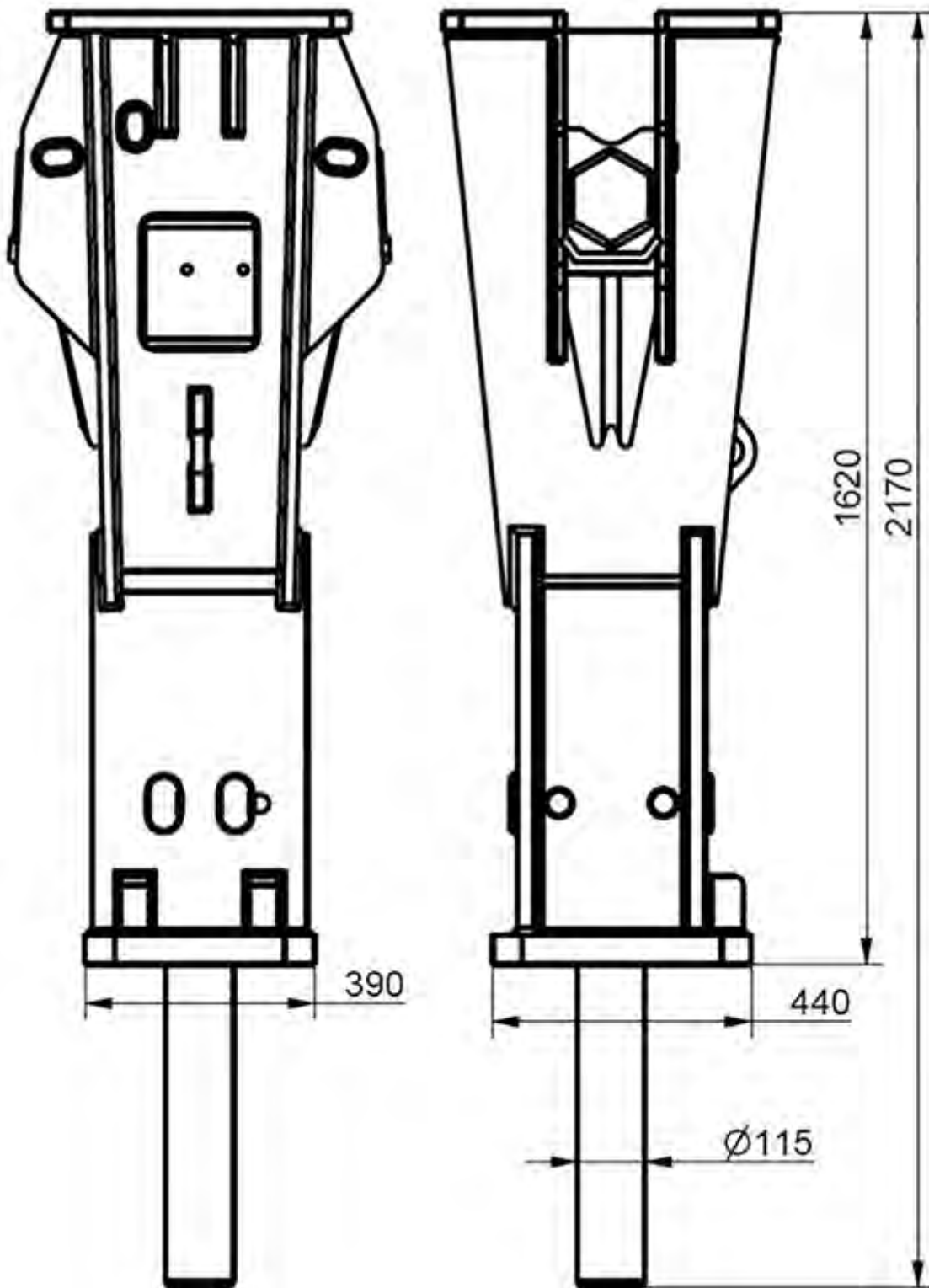

Normet reserves the right to change this specification without further notice

Pictures may include options and additional equipment.

SIDE VIEW XB23

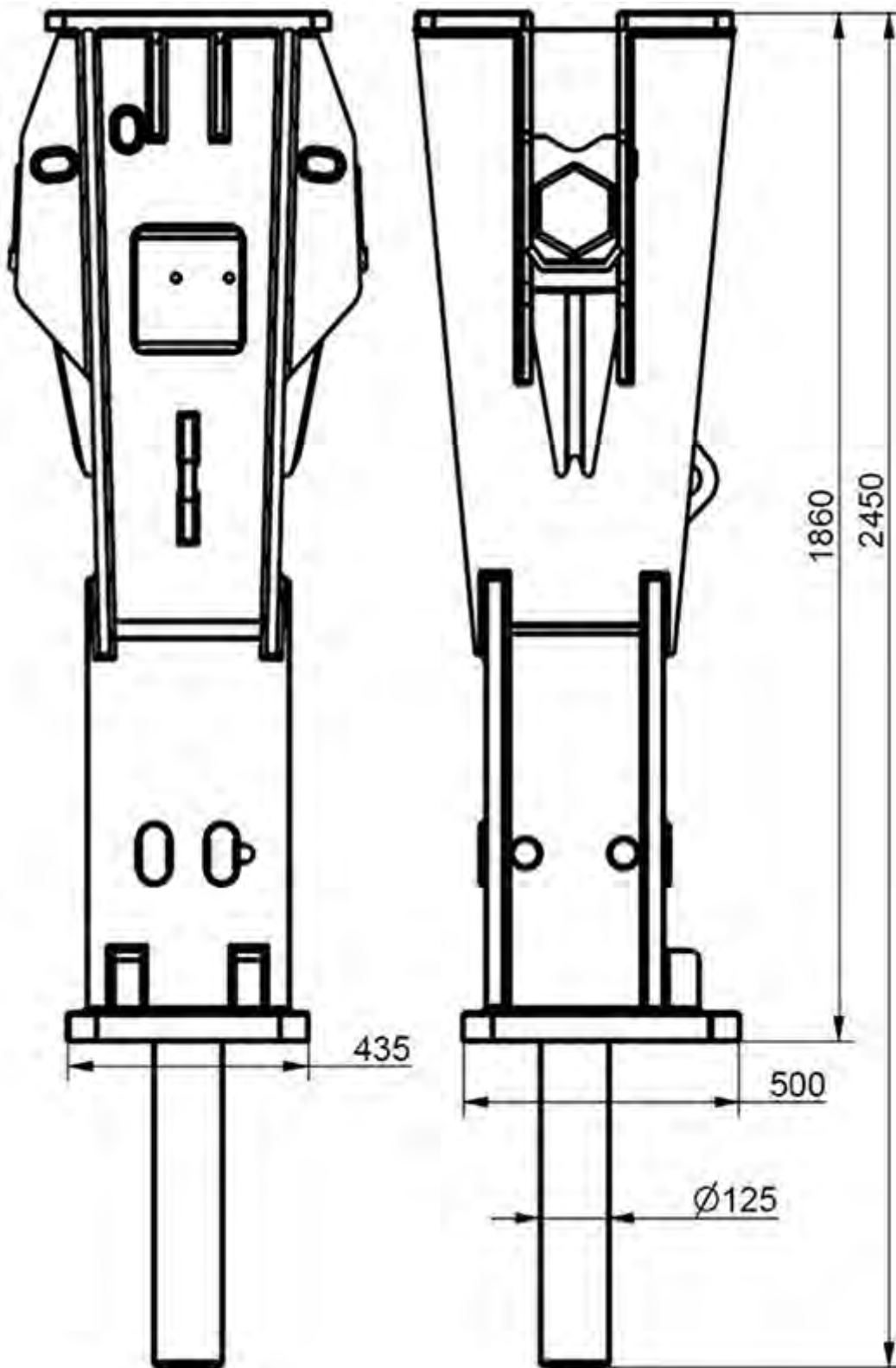

Normet reserves the right to change this specification without further notice

Pictures may include options and additional equipment.

TOP VIEW XB11

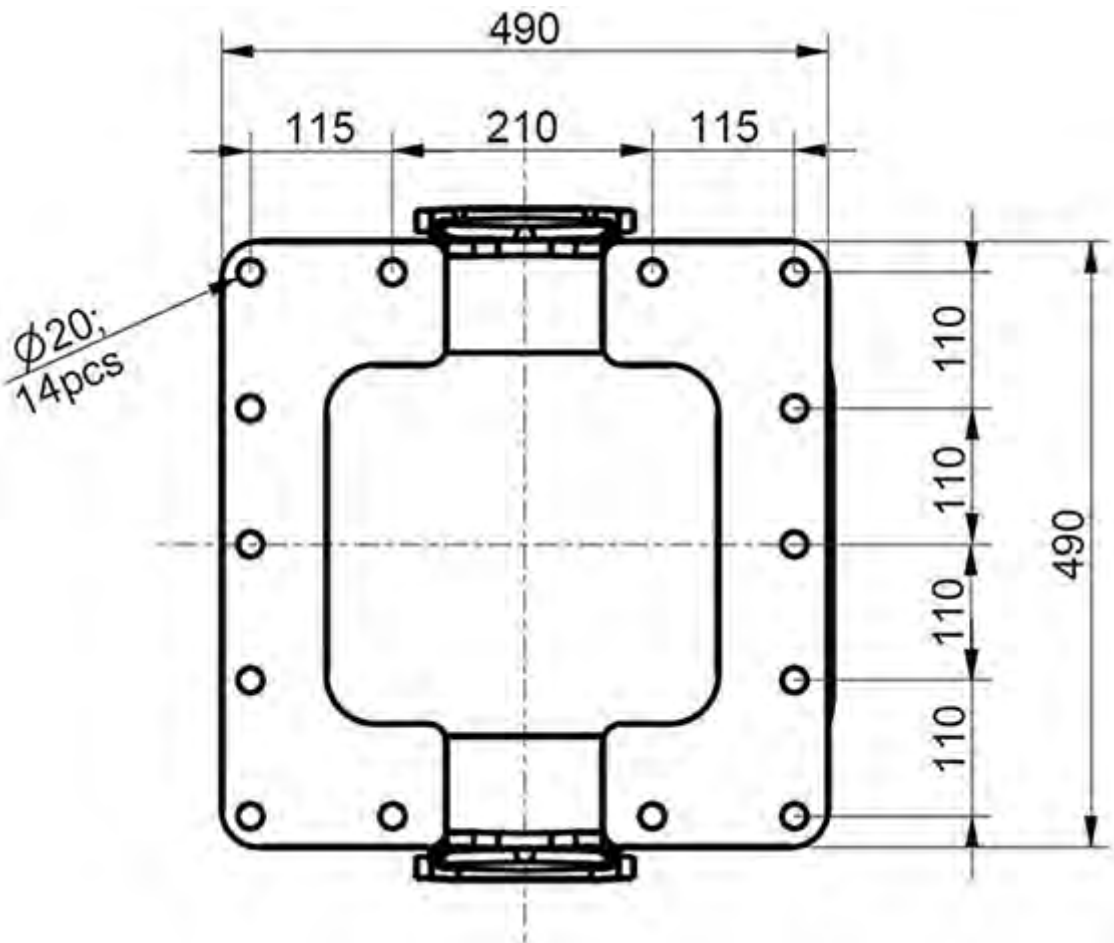

TOP VIEW XB14

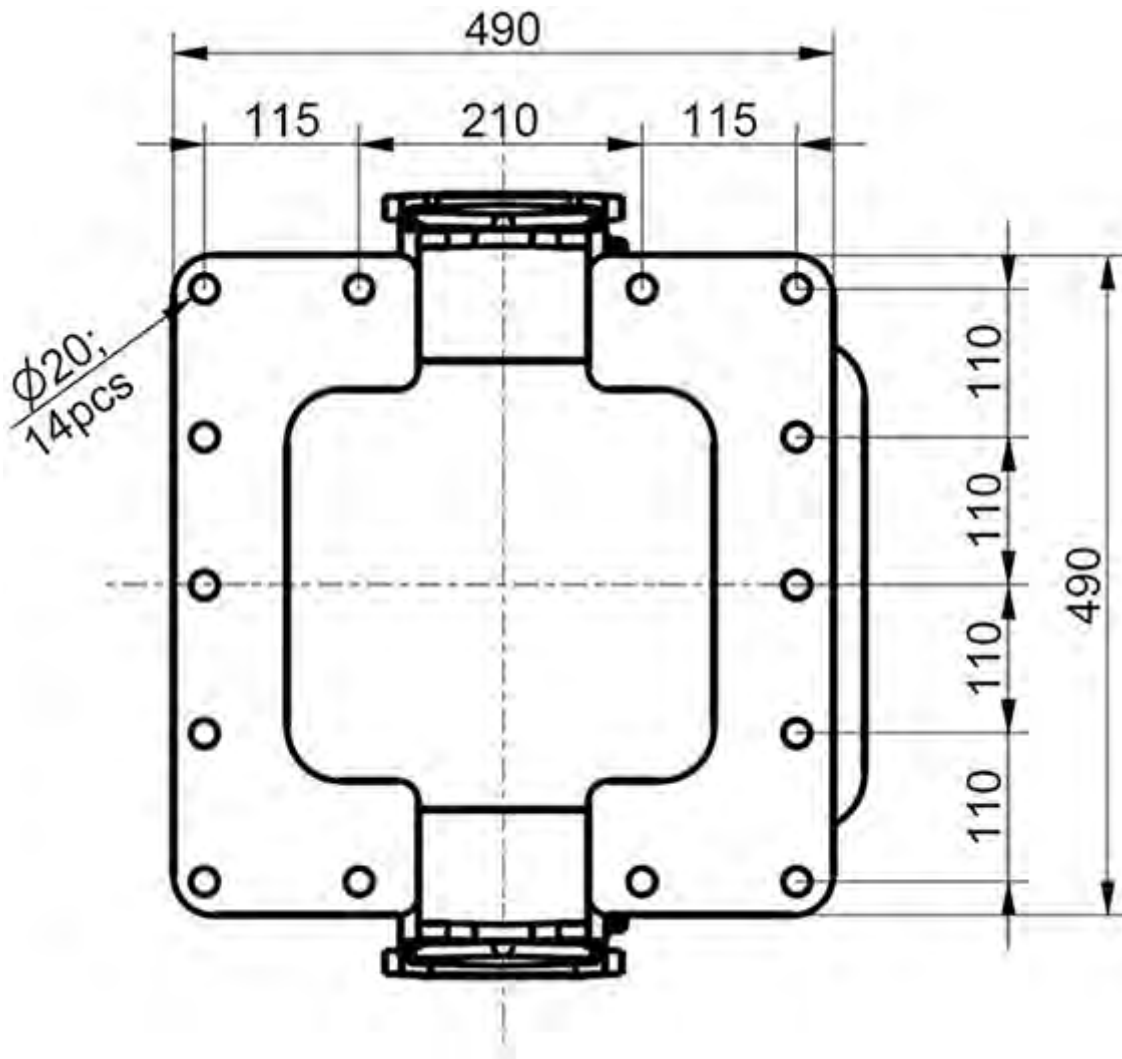

TOP VIEW XB18

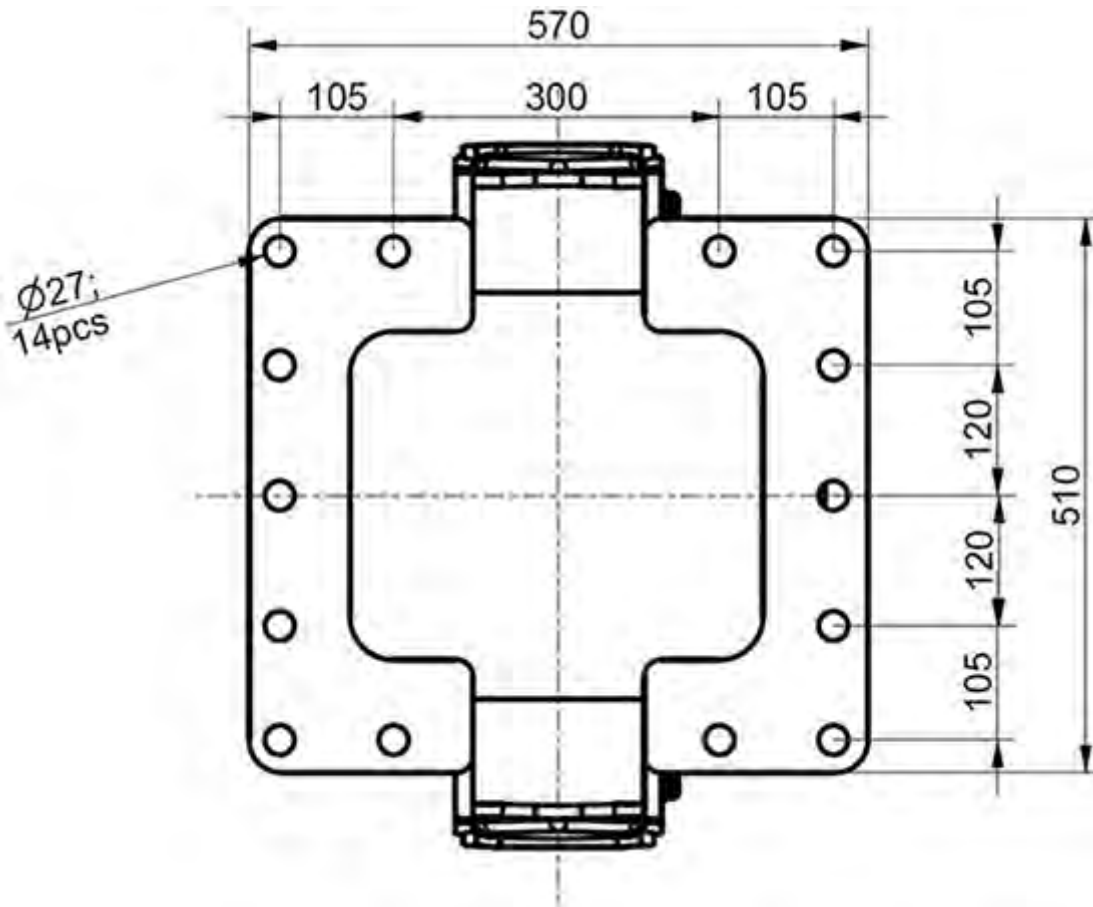

TOP VIEW XB23

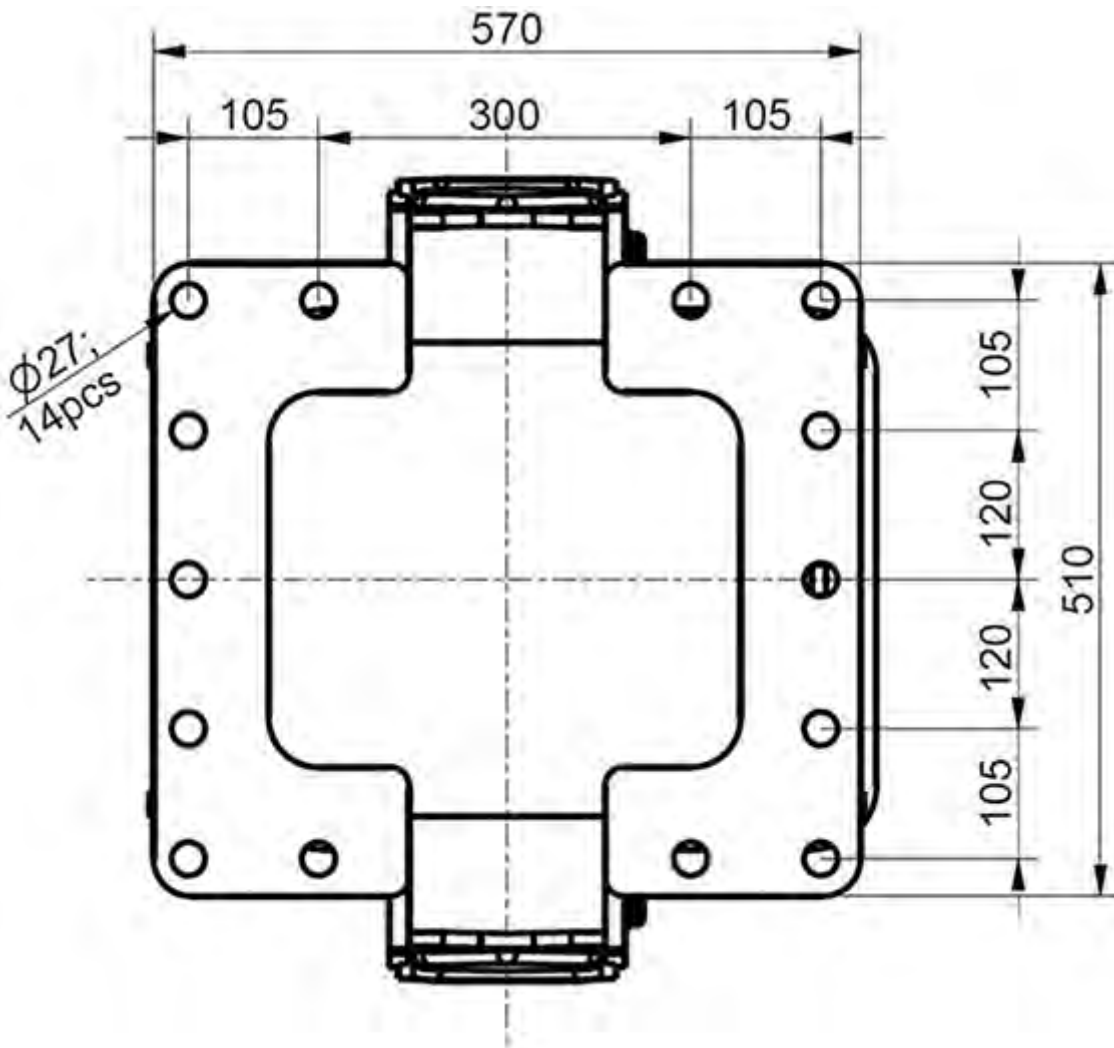

OPERATING WEIGHT

XB11 weight	750 kg
Excavator weight	8000-14 000 kg
XB14 weight	950 kg
Excavator weight	10 000-16 000 kg
XB18 weight	1300 kg
Excavator weight	16 000-22 000 kg
XB23 weight	1650 kg
Excavator weight	18 000-25 000 kg

final machine weight variate in agree with selected options

Normet reserves the right to change this specification without further notice

Pictures may include options and additional equipment.

SERVICES

NORMET SERVICES

Normet is committed to servicing its customers all over the world. We provide service from a single machine to an entire fleet. The Normet service offering consists of many different products from delivery of parts and training to fleet performance agreements.

More information check [normet.com](https://www.normet.com):

<https://www.normet.com/en/products-and-services>

For any questions about Normet Services contact local Normet.

<https://www.normet.com/en/contact/>

SPARE PARTS

As a leading global Original Equipment Manufacturer, we are committed to providing a complete solution to your spare parts needs. All of Normet's spare parts are manufactured to the highest possible standards to help maintain the safety and profitability of your projects. Our spare parts improve efficiency and total cost of ownership throughout your operations.

Spare part recommendation / Start-up Spare Part package: Normet Xrock products have service kits available for commissioning, 2-year and 4-year operation and most critical parts.

SERVICE AGREEMENTS

Service agreements are always customized to meet our customer needs, consisting of various Normet service products. The service solution is created together with the customer and the level of an agreement can vary with different support agreements (including e.g. parts, periodical maintenance, on-call services, and audits) up to guaranteed fleet availability or process performance (including e.g. parts, all maintenance activities, operator trainings and process audits).

Note that we can provide Digital solutions with connected equipment.

More information check [normet.com](https://www.normet.com).

TRAININGS

Range from equipment service training to process application training.

We offer a sustainable training path from the beginning of your operation to the execution stage of your project.

More information check [normet.com](https://www.normet.com).

COMMISSIONING

Equipment commissioning concerns **equipment familiarization**. This is included as part of Normet vehicle delivery. Safety introduction and operating basics for Normet Equipment. Review of Normet user and spare parts manuals. Hands-on equipment safety device operational training. Ensure product quality and customer satisfaction during handover.

Commissioning includes machinery handover to customers and safety operating principles without technical insights or process application training.

EXTENDED COMMISSIONING

We offer an extended training package on top of standard commissioning. Normet provides extended commissioning services that offer basic insights into maintenance manuals, periodical and daily maintenance, as well as modern operating perspectives to maximize handling efficiency. Safety-oriented training ensures reliable operations for Battery Electric Vehicles and Diesel-Driven based on your vehicle fleet. This cost-effective solution covers the essential aspects of equipment operation, safety, and maintenance schedules.

To ensure continuous and maximized safe operations with your new equipment and to expand your knowledge scale of operations, this option is the most suitable and recommended option for extending your new equipment training. This cost-effective solution covers the essential aspects of equipment operation, safety, and maintenance schedules.

UPGRADES AND MODIFICATIONS

We build our machines to last. We also understand that your needs on the ground can change - and reacting to that change makes a big difference in your productivity. Normet Upgrades & Modifications provide you with access to product improvements that meet your evolving requirements and let you stay one step ahead of the curve.

Contact your local Normet office for Upgrade offering to your fleet.

More information check [normet.com](https://www.normet.com).

