



# Hydraulic Breakers M-Range



Normet reserves the right to change this specification without further notice

Pictures may include options and additional equipment.

## INTRODUCTION

**Normet Xrock Breakers** are made for professional use for excavators from 4 ton up to 120 ton. Breakers can be used on all common applications and tailored for special applications such as underwater jobs and extreme, hot applications. A diverse selection of breakers with small weight differences between 335 kg and 7250 kg ensure perfect match on every carrier.

### M-RANGE

M-range is the middle-range, consisting of four breakers designed for applications such as frozen ground and rock breaking, and urban and infrastructure works e.g. demolition and roadside breaking. Their working weights vary from 740 kg to 1680 kg, meant for excavators from 8 ton up to 26 ton. All M-range hammers have a wide selection of tools available. They are vibration and noise dampened, and they have membrane type accumulator, heavy duty hammer housing, and durable polyurethane buffers as a standard. Automatic greasing device and idle blow protection can be selected as an option. Additionally, for special applications we offer optional hot and underwater kits.

# normet XROCK®



## TECHNICAL SPECIFICATION

### HYDRAULIC BREAKERS

#### XB11

Impact rate	340-710 bpm
Tool diameter	95 mm
Noise level	128 dB

#### XB14

Impact rate	370-710 bpm
Tool diameter	100 mm
Noise level	128 dB

#### XB18

Impact rate	430-780 bpm
Tool diameter	115 mm
Noise level	127 dB

#### XB23

Impact rate	350-560 bpm
Tool diameter	125 mm
Noise level	130 dB

#### XB27

Impact rate	340-560 bpm
Tool diameter	135 mm
Noise level	129 dB

Pressure hose

- Left side
- Right side

### HYDRAULIC SYSTEM

#### XB11

Oil flow	55-120 l/min
Operating pressure	115-125 bar
Relief pressure	190 bar
Back pressure max.	10 bar

#### XB14

Oil flow	65-130 l/min
Operating pressure	115-125 bar
Relief pressure	190 bar
Back pressure max.	10 bar

#### XB18

Oil flow	75-130 l/min
Operating pressure	130-140 bar
Relief pressure	200 bar
Back pressure max.	10 bar

#### XB23

Oil flow	95-150 l/min
Operating pressure	130-140 bar
Relief pressure	200 bar
Back pressure max.	10 bar

#### XB27

Oil flow	115-180 l/min
Operating pressure	125-135 bar
Relief pressure	200 bar
Back pressure max.	10 bar

### HOSES

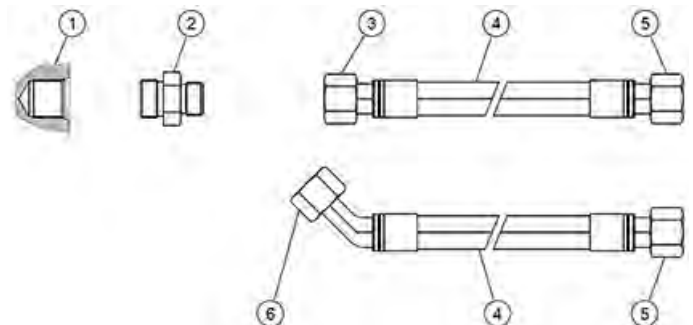

- 1 Breaker port
- 2 Breaker port to hose head (nipple size)
- 3 Head of hose (breaker side)
- 4 Hose
- 5 Head of hose (excavator side)
- 6 Head of hose (breaker side)

IN HOSES	XB11	XB14	XB18	XB23	XB27
<b>Breaker port (1)</b>	3/4"	3/4"	3/4"	1"	1"
<b>Nipple size (2)</b>	3/4" - 36x2"	3/4" - 36x2"	3/4" - 36x2"	1" - 42x2"	1" - 42x2"
<b>Head-breaker (3)</b>	36x2"	36x2"	36x2"	42x2"	42x2"
<b>Hose size (4)</b>	1"	1"	1"	1"	1"
<b>Head-Excavator (5)</b>	*	*	*	*	*

Normet reserves the right to change this specification without further notice

Pictures may include options and additional equipment.

OUT HOSES					
	XB11	XB14	XB18	XB23	XB27
<b>Breaker port (1)</b>	3/4"	3/4"	1"	1"	1-1/4"
<b>Nipple size (2)</b>	3/4" - 36x2"	3/4" - 36x2"	1" - 36x2"	1" - 42x2"	1-1/4" - 42x2"
<b>Head-breaker (3)</b>	36x2"	36x2"	36x2"	42x2"	42x2"
<b>Hose size (4)</b>	1"	1"	1"	1"	1"
<b>Head-Excavator (5)</b>	*	*	*	*	*

\*) The measurement depends on the excavator model

## TECHNICAL DOCUMENTATION

Standard documents:

Instruction manuals, hard copy 1 pcs:

- English
- Russian
- One of destination EU languages

Spare parts manuals, hard copy 1 pcs:

- English

PDF manuals on USB-stick 1 pcs, includes instruction and spare parts manuals

Additional documentation:

- Extra hard copies of manuals
- Extra PDF manuals
- LinkOne WebView electronic manuals
- Other than standard language manuals
- Dimensional (G.A.) drawings

# ACCESSORIES

## MAIN ACCESSORIES

- Idle blow protection
- Underwater use kit
- Hot application kit

## PROCESS PRODUCTIVITY

- Automatic lubrication system

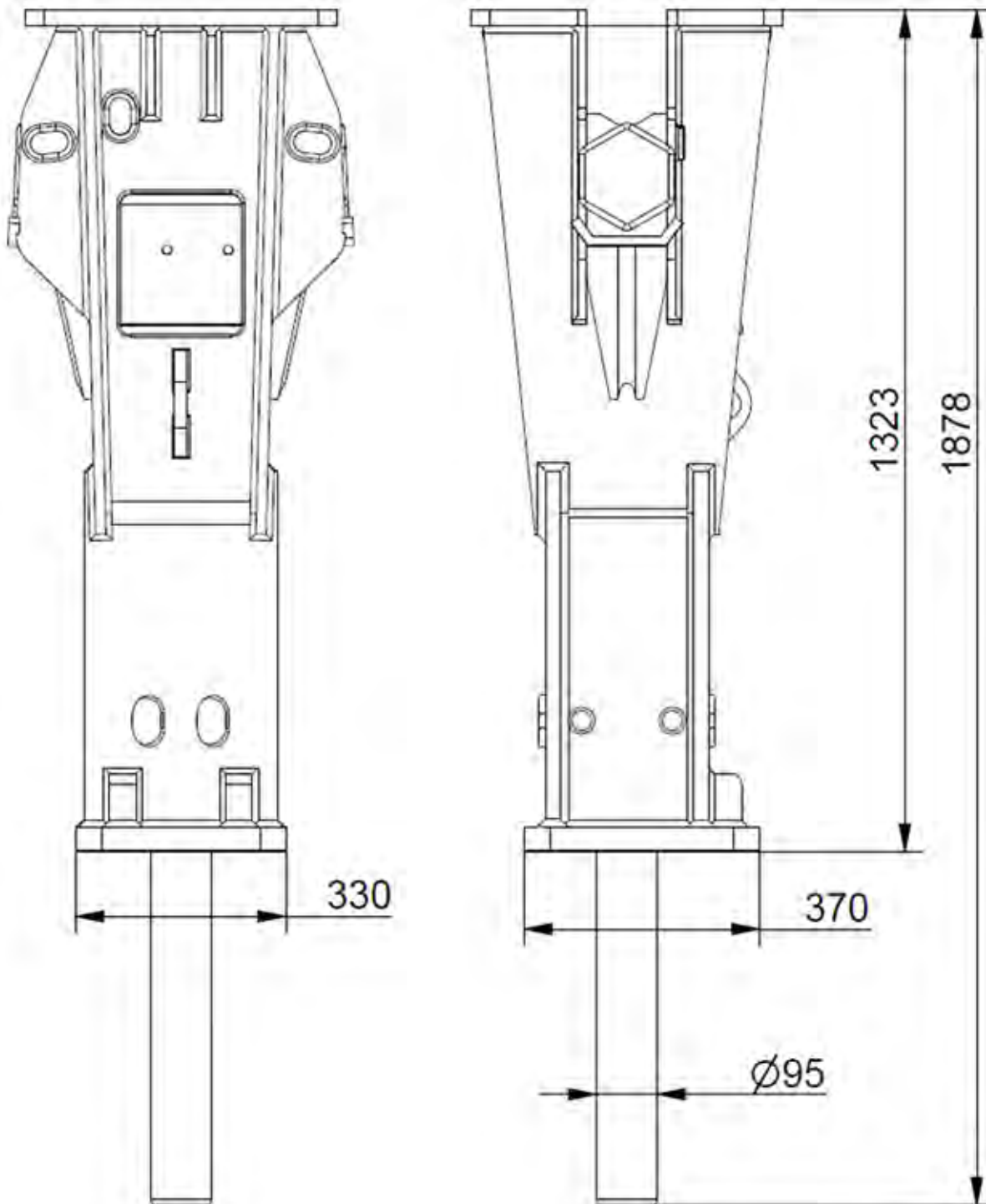
**DIMENSIONS****SIDE VIEW XB11**

Normet reserves the right to change this specification without further notice

Pictures may include options and additional equipment.

## SIDE VIEW XB14

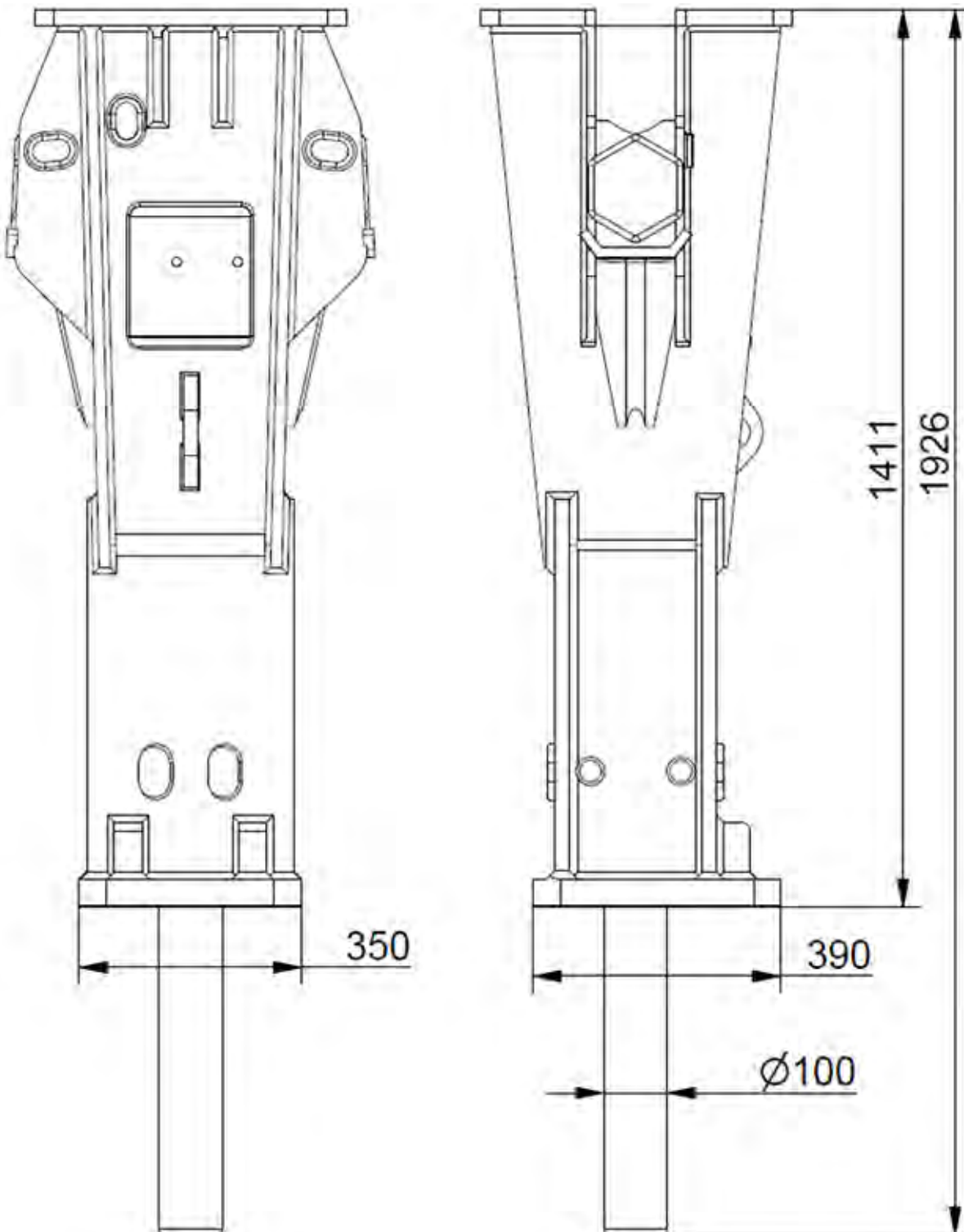

Normet reserves the right to change this specification without further notice

Pictures may include options and additional equipment.

## SIDE VIEW XB18

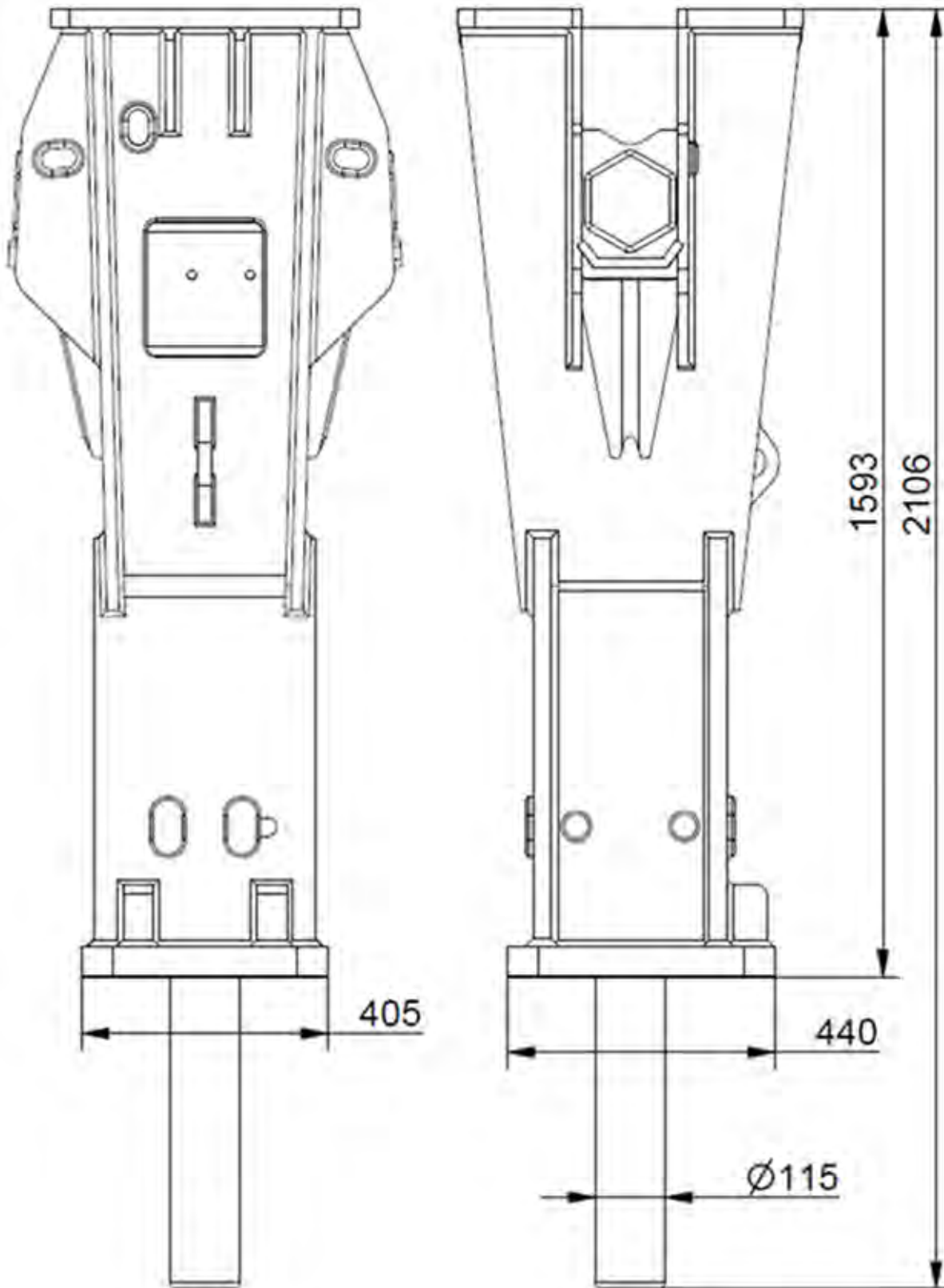

Normet reserves the right to change this specification without further notice

Pictures may include options and additional equipment.



## SIDE VIEW XB23

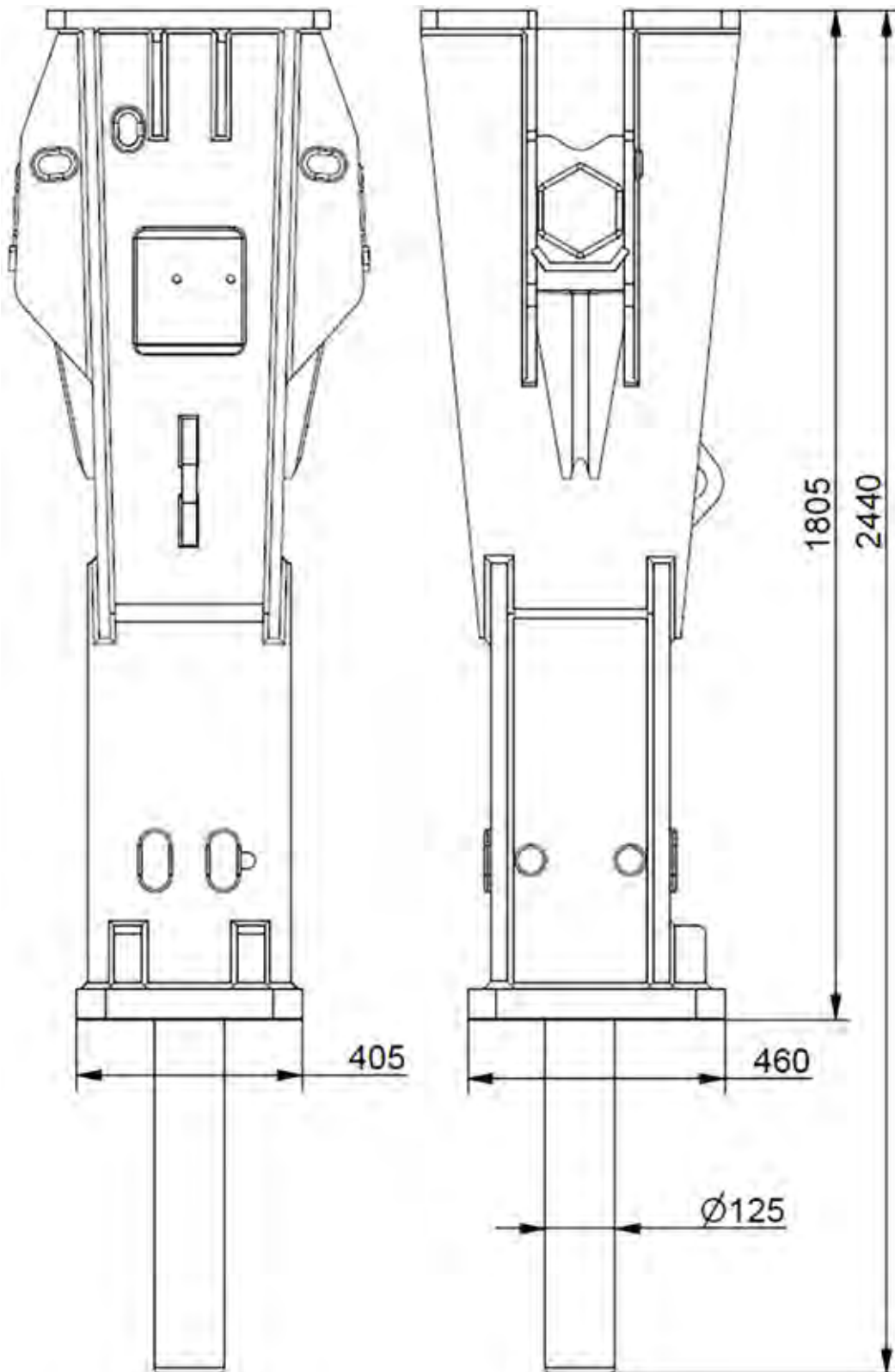

Normet reserves the right to change this specification without further notice

Pictures may include options and additional equipment.

## SIDE VIEW XB27

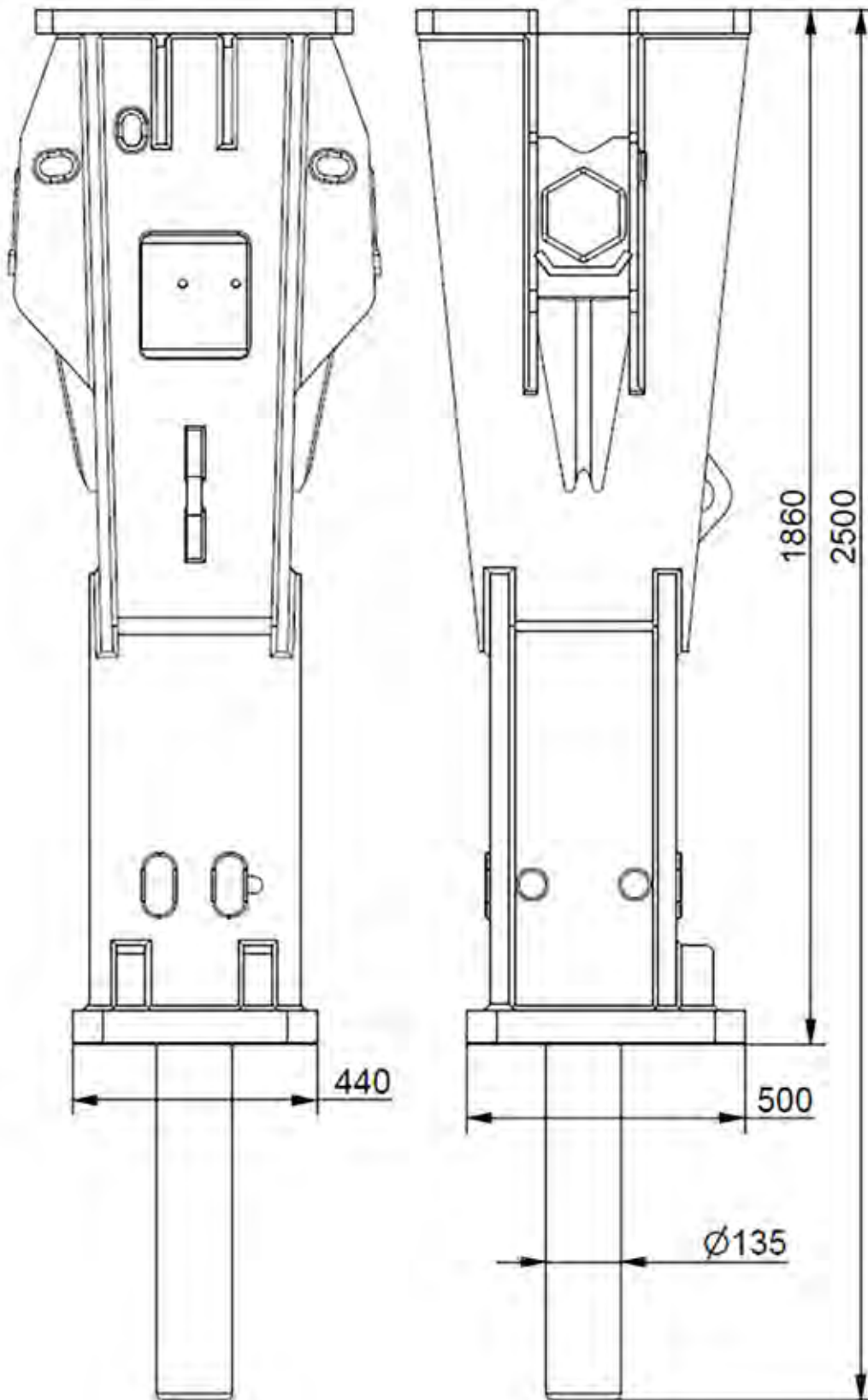

Normet reserves the right to change this specification without further notice

Pictures may include options and additional equipment.

## TOP VIEW XB11

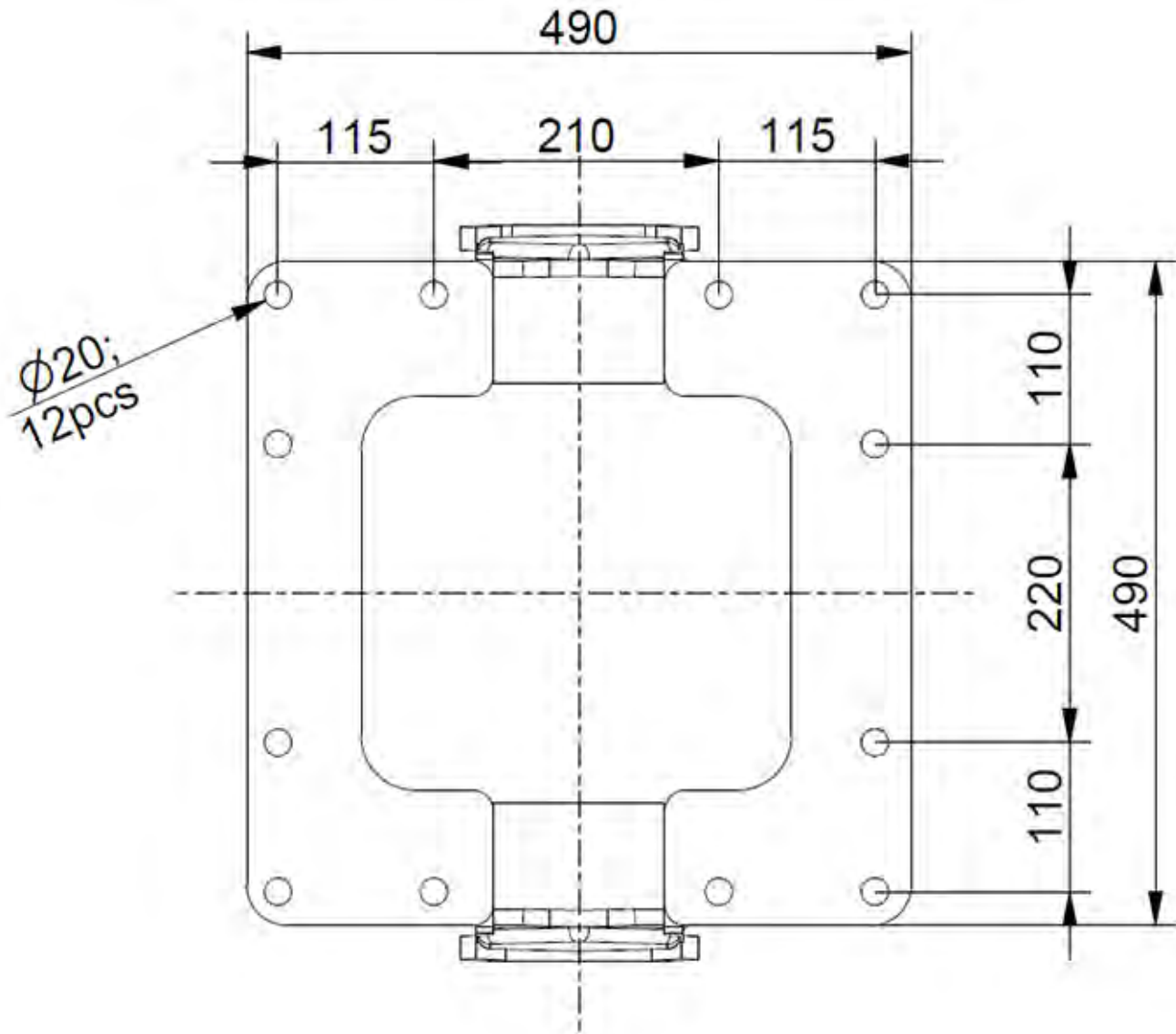

TOP VIEW XB14

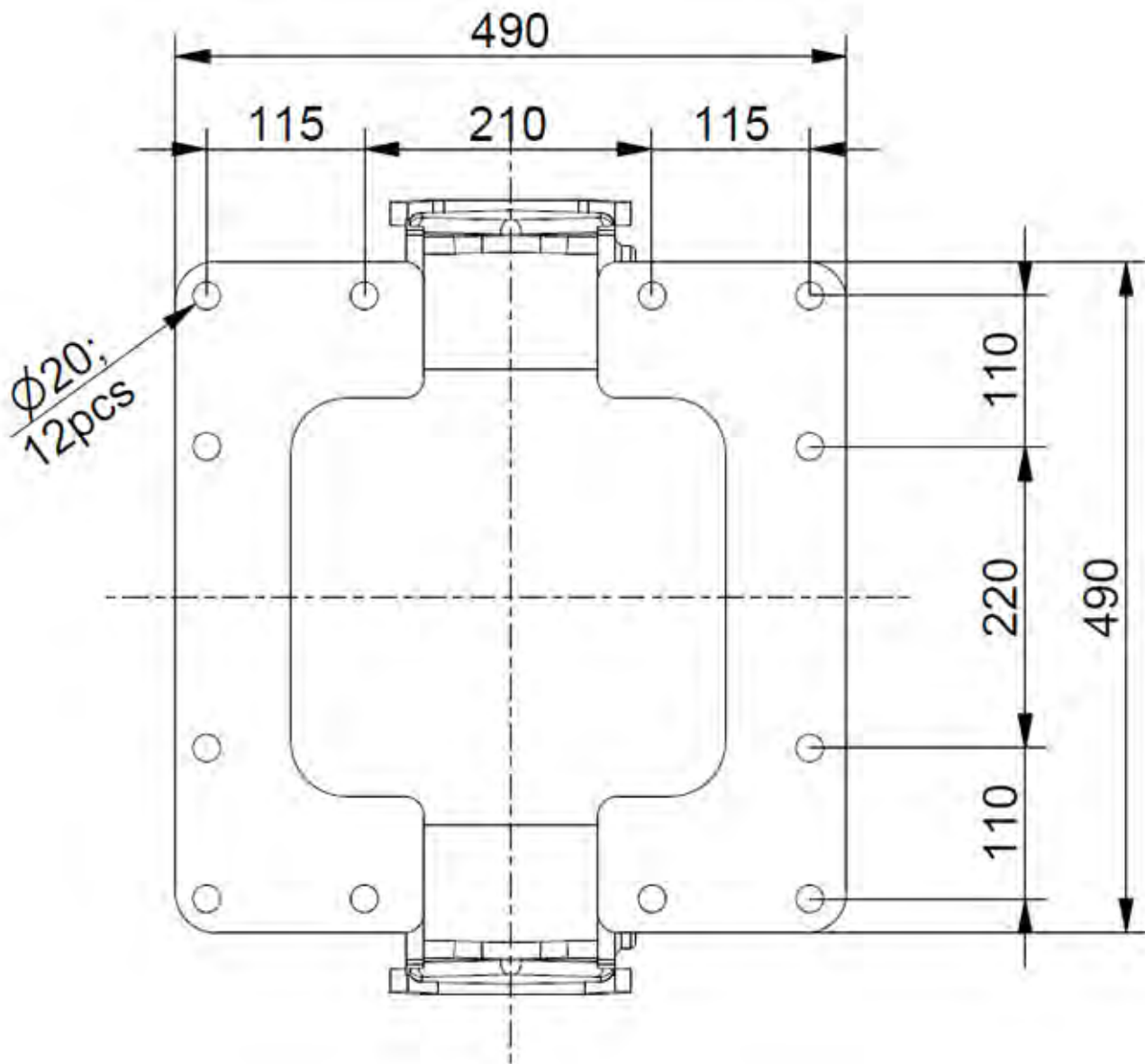

## TOP VIEW XB18

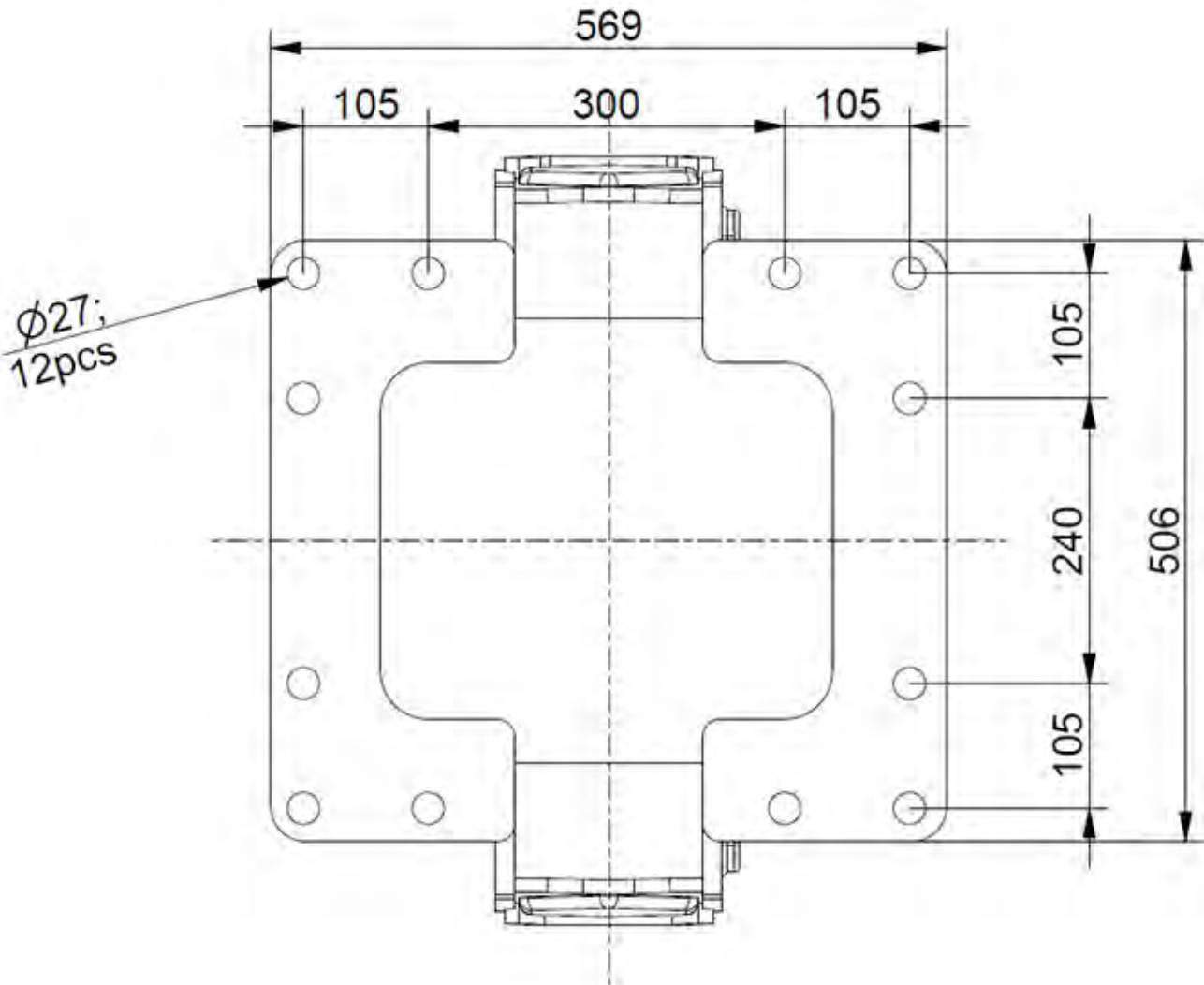

## TOP VIEW XB23

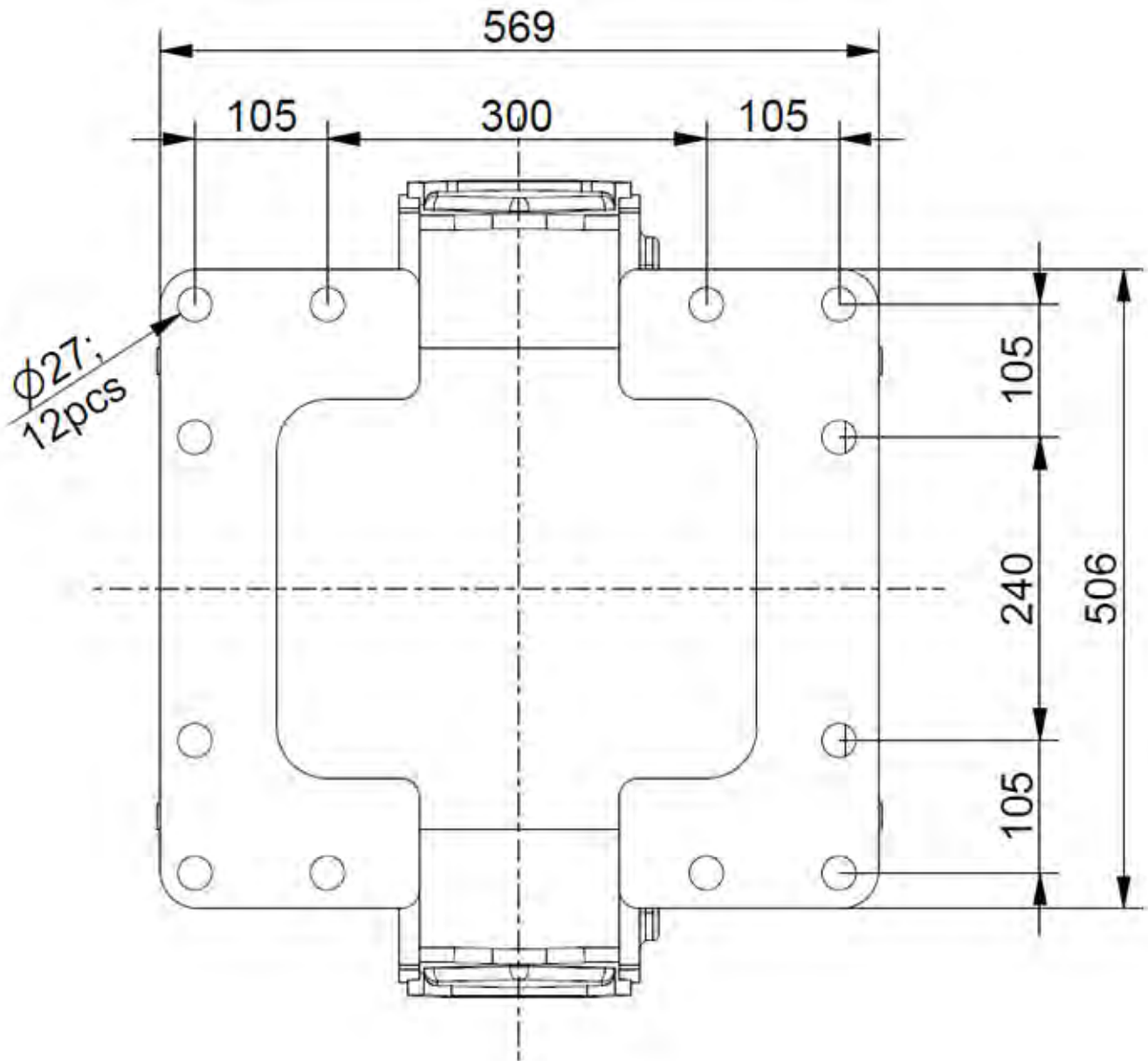

## TOP VIEW XB27

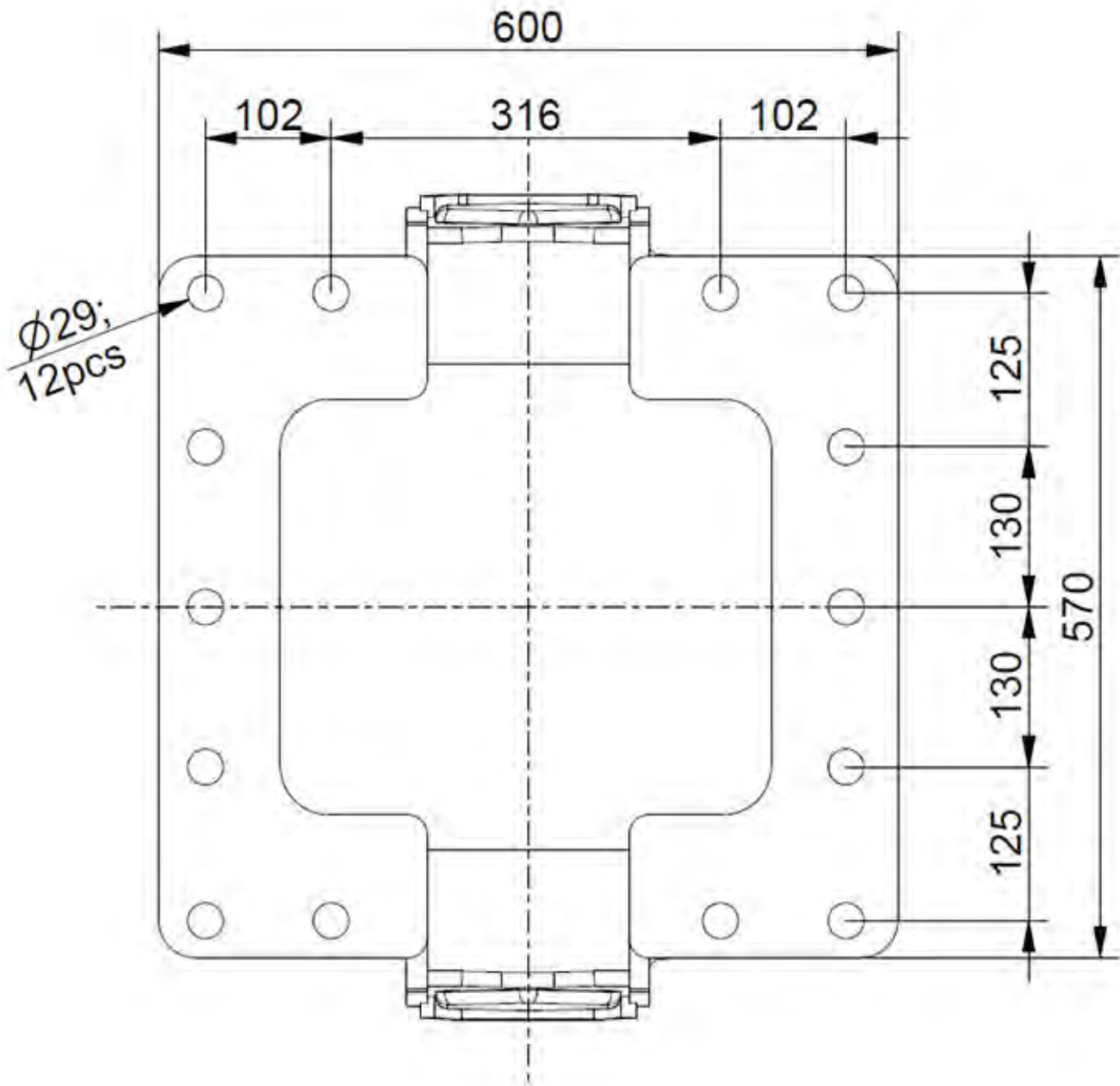

**OPERATING WEIGHT**

XB11 weight	740 kg
Excavator weight	8000-14 000 kg
XB14 weight	910 kg
Excavator weight	10 000-17 000 kg
XB18 weight	1340 kg
Excavator weight	14 000-23 000 kg
XB23 weight	1680 kg
Excavator weight	17 000-26 000 kg
XB27 weight	2020 kg
Excavator weight	23 000-32 000 kg

final machine weight variate in agree with selected options



## SERVICES

### NORMET SERVICES

Our services cover the whole life cycle of your equipment. They include start-up and commissioning, genuine spare parts, upgrades & modifications, and remanufacturing, as well as rental and leasing offerings, and field services. We also offer improvement services such as operator training and process audits.

### SPARE PARTS

Genuine parts from Normet Services ensure that you always have the highest quality parts available to keep your equipment up and running. Depending on your needs, we can offer everything from individual parts to complete parts contracts, and our professionals around the world have the experience to ensure that you have the parts you need when you need them.

#### Initial spare part packages:

Normet Xrock products have service kits available for commissioning, 2-year and 4-year operation and most critical parts.

### UPGRADES AND MODIFICATIONS

Our Upgrades and Modifications services are designed to ensure the economical, efficient and purposeful performance of

your equipment over its entire life cycle. A service provided by a reliable OEM like Normet ensures the safety and performance of your equipment. Normet Upgrades and Modifications save you both time and money, while delivering the high quality you expect from us.

### SERVICE CONTRACTS

With a service agreement, Normet manages your fleet with guaranteed availability and agreed costs, giving you transparency for your life cycle costs, annual operational budget and fleet uptime. This lets you focus on your core operations. Each service agreement is built and customized to meet the individual customer's needs from our portfolio of services. Depending on the level of service agreement you need, you can choose anything from basic technical support for an individual machine all the way up to services for your entire fleet, as well as process performance. The service levels we offer are:

- Parts Availability
- Fleet Support
- Fleet Availability
- Process Performance

The content of a service level can be tailored to meet your particular requirements.

### TRAINING SERVICE

Our Training Services are available for you and your operators throughout the equipment lifecycle and they include:

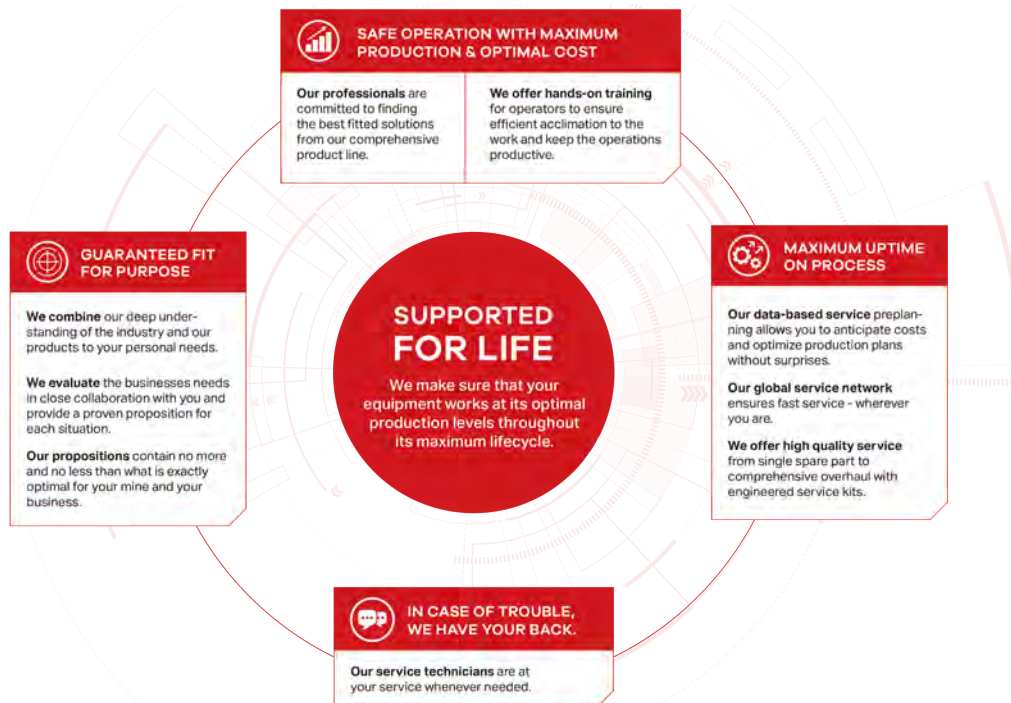

# START-UP AND COMMISSIONING

## 1. OPERATOR TRAINING

	Start-up training	Commissioning
<b>1.1 Classroom training</b>		
General introduction and operation of machine	Basic	No classroom training included in commissioning
Safety instructions	Basic	
Use of manuals	Basic	
Technical introduction of equipment	Basic	
Hands-on service and pre-operation checks	Basic	
Controls and driving (starting, driving, stopping, parking)	Basic	
<b>1.2 Practical training</b>		
Pre-operation checks	Basic	Introduction
Driving, starting, stopping, parking	Basic	Introduction
Preparing the machine for specific operation conditions	Basic	Not covered
Operation	Basic	Introduction
Washing the machine	Basic	Introduction
Troubleshooting	Basic	Basic

## 2. MAINTENANCE AND REPAIR TRAINING

General operation of machines	Basic	Introduction
Symbols of drawings and codes	Basic	Not covered
Understanding hydraulic and electric schematics	Basic	Introduction
Control systems	Basic	Introduction
Function of main components (depending on equipment)	Basic	Introduction
Locations of components in the machine	Basic	Not covered
Periodical maintenance	Basic	Introduction
Troubleshooting	Basic	Not covered
Use of manuals	Basic	Introduction
Connection of hydraulic and electrical equipment	Basic	Not covered