

This map is reproduced from Ordnance Survey material with the permission of Ordnance Survey on behalf of the Controller of Her Majesty's Stationery Office © Crown copyright. Unauthorised reproduction infringes Crown copyright and may lead to prosecution or civil proceedings. Stockport Metropolitan Borough Council 100019571 2021

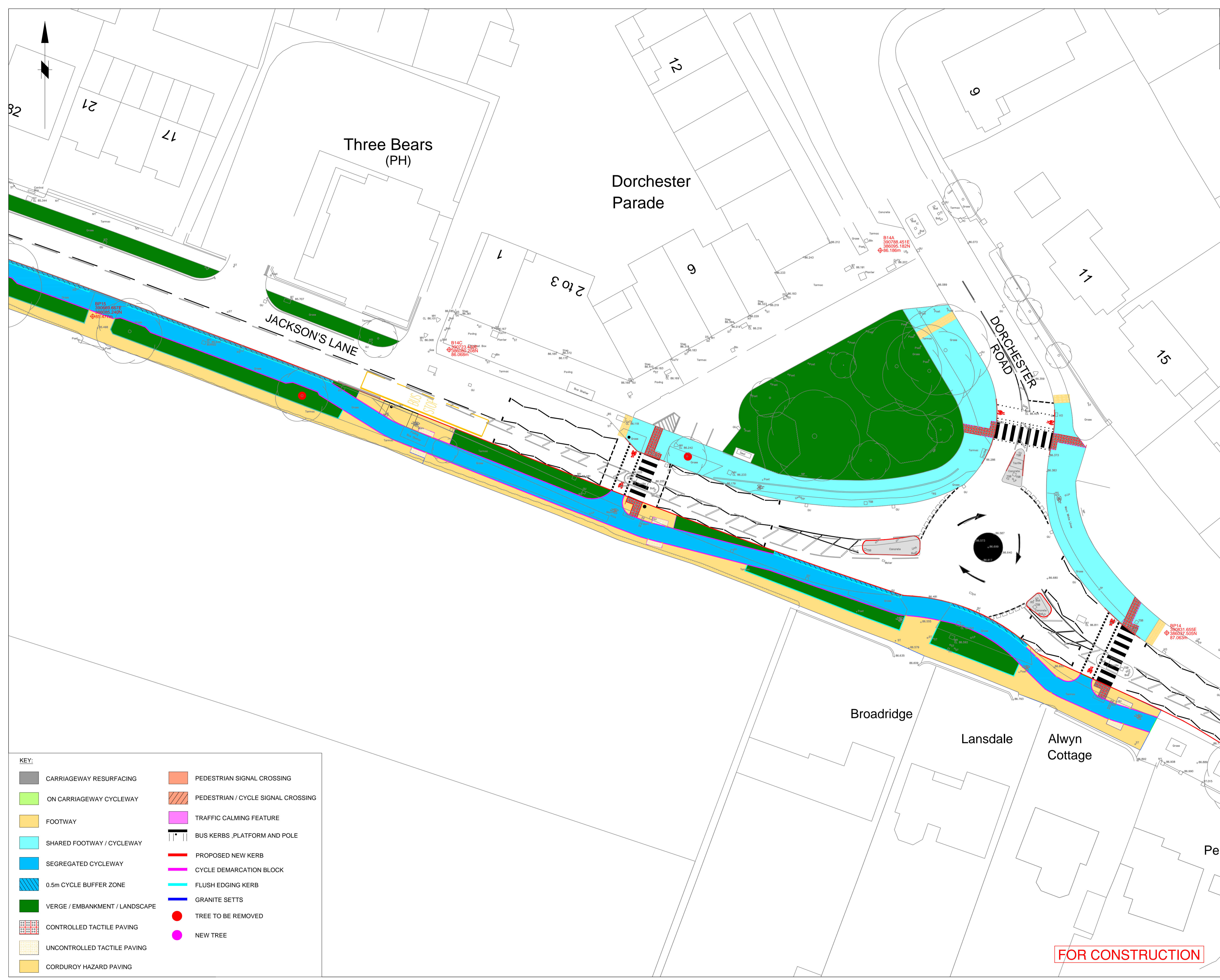

**KEY:**

CARRIAGEWAY RESURFACING	PEDESTRIAN SIGNAL CROSSING
ON CARRIAGEWAY CYCLEWAY	PEDESTRIAN / CYCLE SIGNAL CROSSING
FOOTWAY	TRAFFIC CALMING FEATURE
SHARED FOOTWAY / CYCLEWAY	BUS KERBS, PLATFORM AND POLE
SEGREGATED CYCLEWAY	PROPOSED NEW KERB
0.5m CYCLE BUFFER ZONE	CYCLE DEMARCATION BLOCK
VERGE / EMBANKMENT / LANDSCAPE	FLUSH EDGING KERB
CONTROLLED TACTILE PAVING	GRANITE SETTS
UNCONTROLLED TACTILE PAVING	TREE TO BE REMOVED
CORDUROY HAZARD PAVING	NEW TREE

A	DM	BJD	13.05.21	TREES TO BE REMOVED UPDATED
Rev.	Drawn	Checked	Date	Revision Details
AMENDMENTS				
<b>STOCKPORT</b> METROPOLITAN BOROUGH COUNCIL <small>HIGHWAYS AND TRANSPORTATION          STOCKPORT HOUSE          STOCKPORT SK1 3JZ          TEL 0161 474</small>				
CAROLINE SIMPSON <small>DEPUTY CHIEF EXECUTIVE</small> Job Title				
<b>MCF - 0275B</b> <b>HILLCREST ROAD TO</b> <b>DORCHESTER ROAD</b>				
Drawing Title				
<b>GENERAL ARRANGEMENT</b> <b>SHEET 4 of 4</b>				
Drawn	Engineer	Checked	Approved	
DP	DMcC	SH	BJD	
Date	Date	Date	Date	
28/01/21	28/01/21	31/04/21	16/04/21	
Size	Scale			
A1	1:250			
Drawing No. C/0275B/100-001-01				Revision
				A

**FOR CONSTRUCTION**