

This map is reproduced from Ordnance Survey material with the permission of Ordnance Survey on behalf of the Controller of Her Majesty's Stationery Office © Crown copyright. Unauthorised reproduction infringes Crown copyright and may lead to prosecution or civil proceedings. Stockport Metropolitan Borough Council 100019571 2021

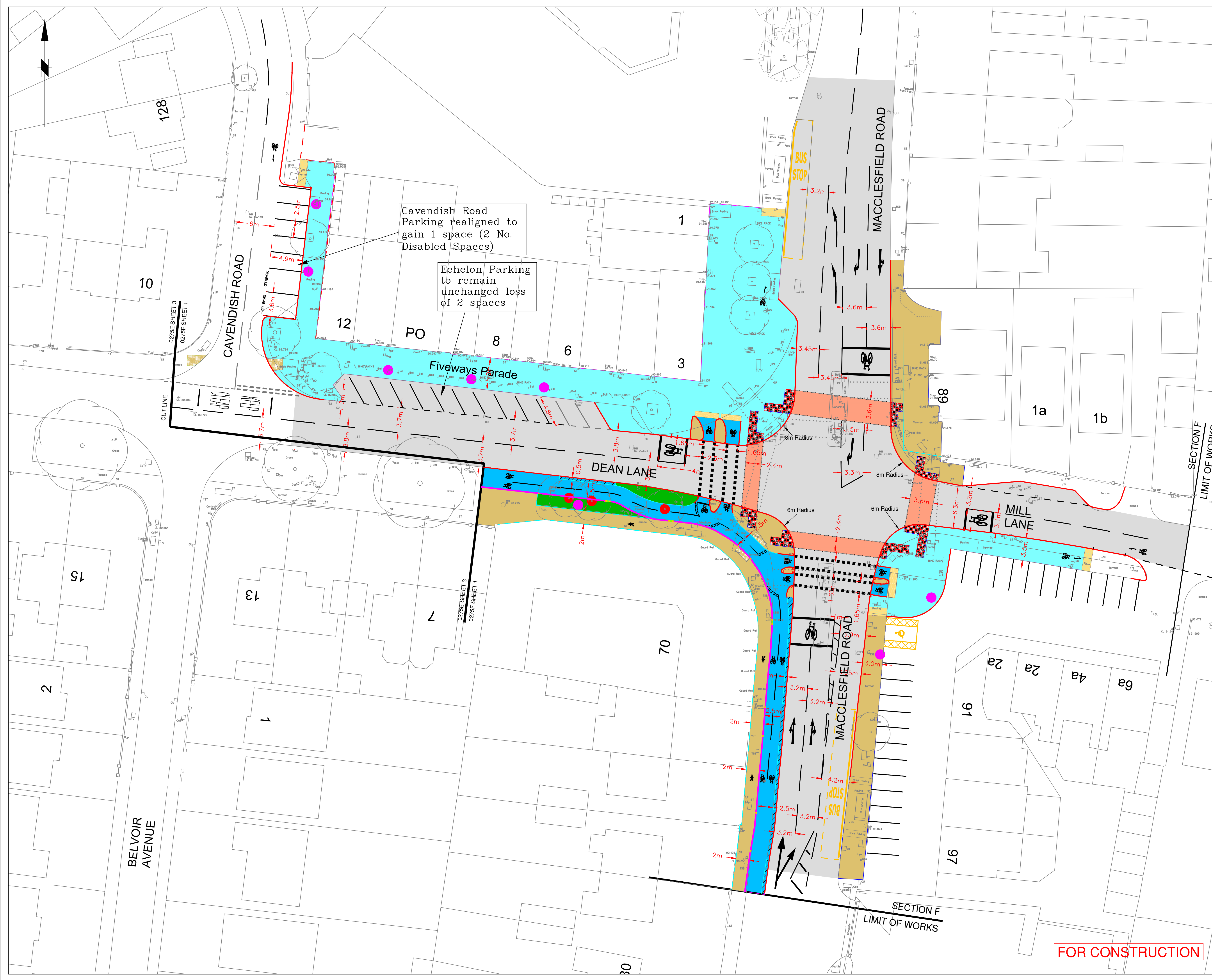

- KEY:**
- CARRIAGEWAY RESURFACING
  - ON CARRIAGEWAY CYCLEWAY
  - FOOTWAY
  - SHARED FOOTWAY / CYCLEWAY
  - SEGREGATED CYCLEWAY
  - CYCLE BUFFER ZONE
  - VERGE / EMBANKMENT / LANDSCAPE
  - CONTROLLED TACTILE PAVING
  - UNCONTROLLED TACTILE PAVING
  - CORDUROY HAZARD PAVING
  - PEDESTRIAN SIGNAL CROSSING
  - PEDESTRIAN / CYCLE SIGNAL CROSSING
  - TRAFFIC CALMING FEATURE
  - PROPOSED NEW KERB
  - CYCLE DEMARCATION BLOCK
  - CYCLE DEMARCATION BREAK
  - CYCLE DEMARCATION STOP END
  - FLUSH EDGING KERB
  - GRANITE SETTS
  - TREE TO BE REMOVED
  - NEW TREE

Rev.	Drawn	Checked	Date	Revision Details
D	DP	AV	14.09.21	Carriageway resurfacing extended on Dean Lane
C	DP	AV	07.07.21	Echelon parking retained Dean Lane Cavendish Road parking amendments not amended to suit parking retention
B	DP	AV	24.02.21	Additional Area of Abeyance added
A	DP	AV	15.02.21	Kerb amendment after site visit with Principle Contractor

AMENDMENTS



CAROLINE SIMPSON  
DEPUTY CHIEF EXECUTIVE  
Job Title

**MCF 0275F  
MACCLESFIELD ROAD  
DEAN LANE JUNCTION**

Drawing Title  
**GENERAL ARRANGEMENT**

Drawn	Engineer	Checked	Approved
AV/DP	AV	SEB	BJD
Date	Date	Date	Date
18/11/20	18/11/20	25.01.21	27.01.21
Size	Scale		
A1	1:250		

Drawing No. C/0275F/0100/001-01 Revision D

FOR CONSTRUCTION