

This map is reproduced from Ordnance Survey material with the permission of Ordnance Survey on behalf of the Controller of Her Majesty's Stationery Office © Crown copyright. Unauthorised reproduction infringes Crown copyright and may lead to prosecution or civil proceedings. Stockport Metropolitan Borough Council 100019571 2021

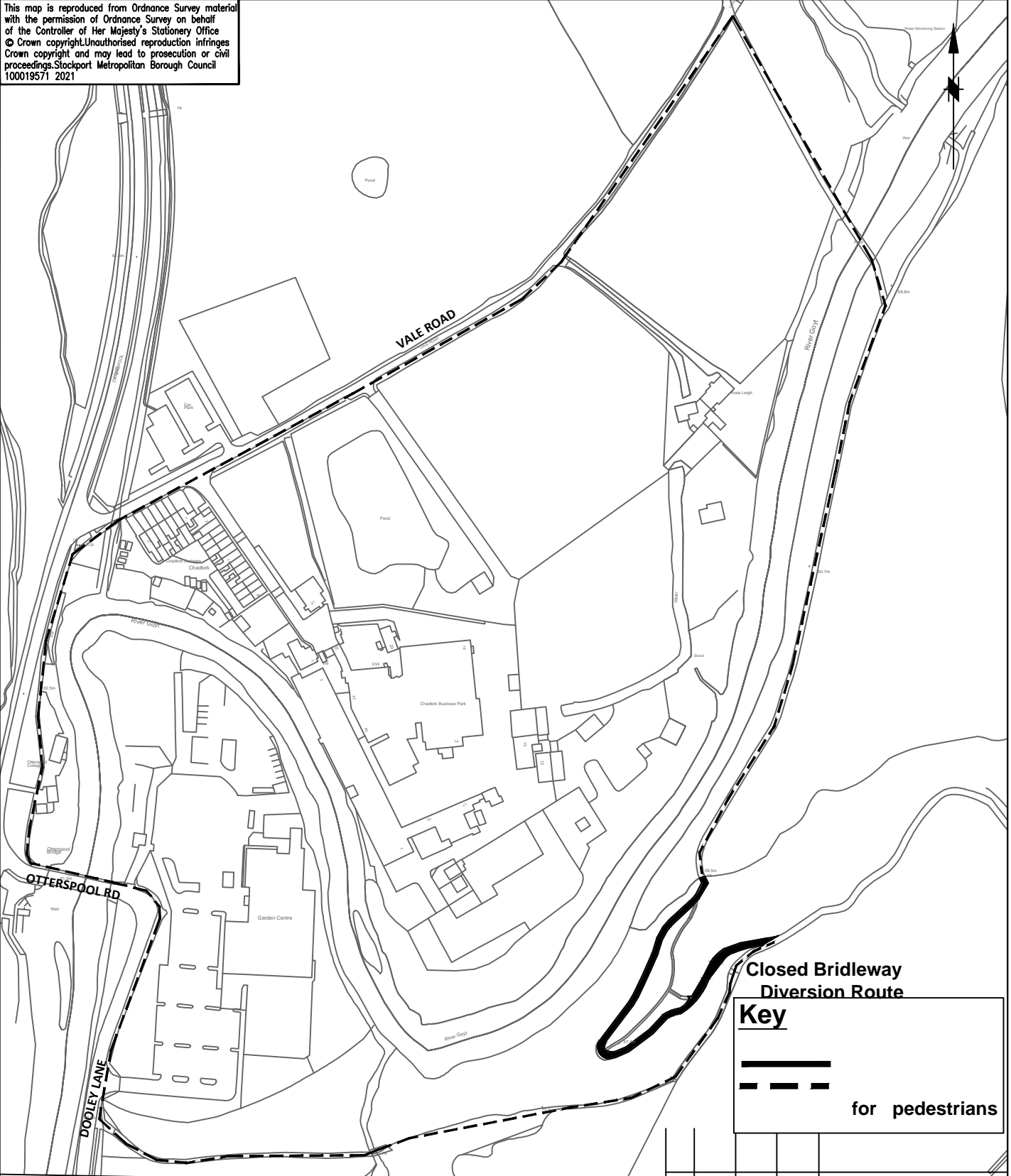

**Closed Bridleway
Diversion Route**

Key

—————
- - - - -
for pedestrians

Rev.	Drawn	Checked	Date	Revision Details
------	-------	---------	------	------------------



STOCKPORT

METROPOLITAN BOROUGH COUNCIL
HIGHWAYS AND TRANSPORTATION
STOPFORD HOUSE
STOCKPORT SK1 3XE
Tel: 0161 474
FAX: 0161

CAROLINE SIMPSON
DEPUTY CHIEF EXECUTIVE

JOB TITLE

ALAN NEWTON WAY TO CHADKIRK 64M

DRAWN HJ	ENGINEER HJ	CHECKED AV	APPROVED AV
DATE 23/02/21	DATE 23/02/21	DATE 02/03/21	DATE 02/03/21
SCALE NTS		SCG No.	
DRAWING NUMBER D_8010_0100_005			Revision

DRAWING TITLE
TEMP PROW CLOSURE