



UT D86 Spot Ceiling

Ceiling Mounted Directional Accent

Description

The UT Spot is a family of high output indoor lights suitable for any application, from museum exhibitions to commercial premises and offices or residential environments. Remodel type IC rated employing remote drivers, for indoor use to be mounted on ceilings & displays, available in LED sources with choice of lumens, color temperature or beam in ELV& FF or 1-10V dimming versions.

The UT Spot Downlight version can operate as downlight (up position) or as adjustable spotlight (down position).

The optical housing of the product is in high-pressure injected aluminum, with white or black finishes.



Dimensions

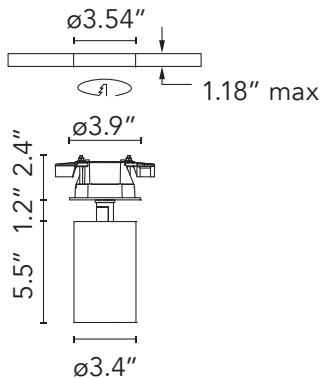

Certifications



Photometrics

For current IES files please visit
arch.flosusa.com

Warranty

2 years from date of sale.

Lamp

Lamp Type	LED ARRAY
Wattage	33W
Output Nominal	3116lm, 3246lm, 2150lm (3000K CRI80)
Color Temperature	3000K, 4000K 3500K* (See Notes)
Color rendering	CRI 80, 90

Optical

Beam Angle	12°/ 24°/ 37°
Lighting Type	Direct
Light Distribution	Symmetric

Physical

Material	Aluminum
Aiming	Adjustable
Weight	3.7 Lbs
Ingress Protection Rating	IP20
Maximum tilt Angle	90°
Rotation	360°

Finishes

Painted lacquer

☐ 30 White ☒ 14 Black



Installation type	Ceiling Trim
Environment	Indoor
Minimum Plenum height	6.2"
Maximum Ceiling thickness	1.18"



UT D86 Spot Ceiling

Ceiling Mounted Directional Accent



Dimensions

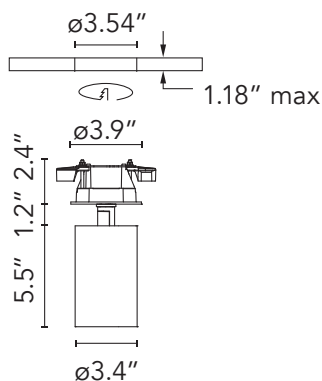

Electrical & Control

driver location: Remote	Remote
Driver Input Voltage	120V-277V
Fixture Vf	38V
Current mA	750mA
Control	Control: 0-10V, ELV

Performance

Maximum delivered output	from 1777lm to 2366lm
Efficacy	88lm/W

Notes

Integral LED is not field replaceable.

IC-rated downlight for direct insulation contact.

Fixture is constant Current Low Voltage LED, Class 2.

Just 1 accessory can be install at the time. For filter options contact Flos.

Semi recessed Spotlight, Wiring suitable for plenum spaces.

3500K available, but not cataloged. Consult factory for additional color temperatures.

Certifications



Photometrics

For current IES files please visit
arch.flosusa.com

Warranty

2 years from date of sale.

UT D86 Spot Ceiling

Ceiling Mounted Directional Accent

How to specify

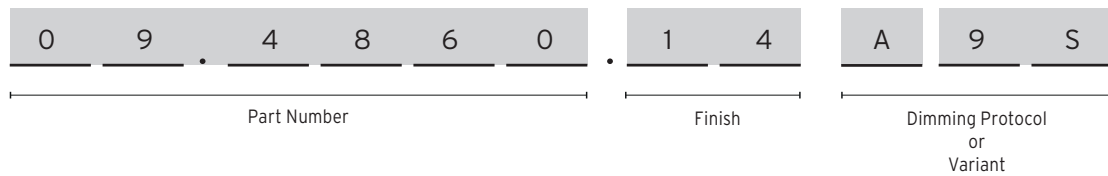

How to Specify ex. 09.4860.14A9S

CCT	CRI	Wattage	Initial Lumens	Beam Angle	Part Number	Finish	Power Supply
3000K	80	33W	3210lm	12°	09.4860	<input type="checkbox"/> 30 = White <input checked="" type="checkbox"/> 14 = Black	IC Rated , Remote Power Supply, order separately
				24°	09.4861		
				37°	09.4862		
3000K	90	33W	2660lm	12°	09.4863	<input type="checkbox"/> 30 = White <input checked="" type="checkbox"/> 14 = Black	A9S = Remote power Supply, order separately
				24°	09.4864		
				37°	09.4865		
4000K	90	33W	2770lm	12°	09.4870	<input type="checkbox"/> 30 = White <input checked="" type="checkbox"/> 14 = Black	A9S = Remote power Supply, order separately
				24°	09.4871		
				37°	09.4872		

Photometrics

3000K CRI 90

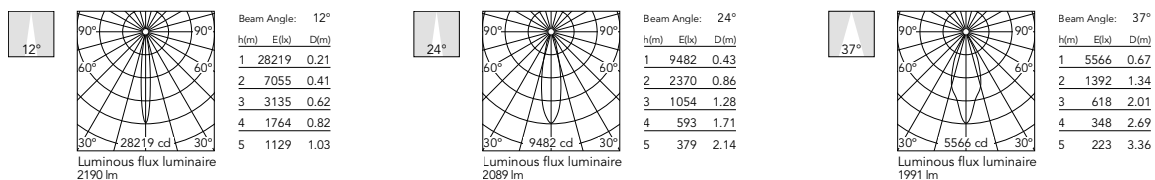

UT D86 Spot Ceiling

Ceiling Mounted Directional Accent



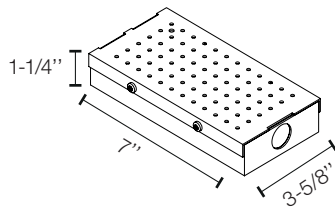

Required Drivers

Splice Box UL 7"x3-5/8"x1-1/4", UL.
With Driver Programmed to 750mA,
40W, 0-10V. Dimmable, 120/277V. 1
Driver per Light

SP40W750MA-10V-A02



Optional Accessories *

Holding Ring	Cross baffle	Flood lens (to use with the holding ring)
08.8410.00	08.8411.00	08.8175.68
		
Honeycomb anti-glare louvre (to use with the holding ring)	Elliptical lens (to use with the holding ring)	
08.8495.14	08.8163.68	
		

* Fixture accommodates exclusively 1 accessory, for Filter options contact Flos

UT D86 Spot Ceiling

Ceiling Mounted Directional Accent

Trays

Registration tray -non electrical, place holder for non IC new construction, \varnothing 4.75'

TRAY-0019

