

## Getting Started with Trimble Connect

Trimble Connect provides the right people with the right data at the right time - enabling teams to easily collaborate and make informed decisions. To make things even easier, this quick guide provides 10 simple steps to getting started with Trimble Connect.

**Step 1:** After purchasing a license at [connect.trimble.com](https://connect.trimble.com), use your Trimble ID to [login to Trimble Connect](#). Once logged in, click the "New" button to begin your project.

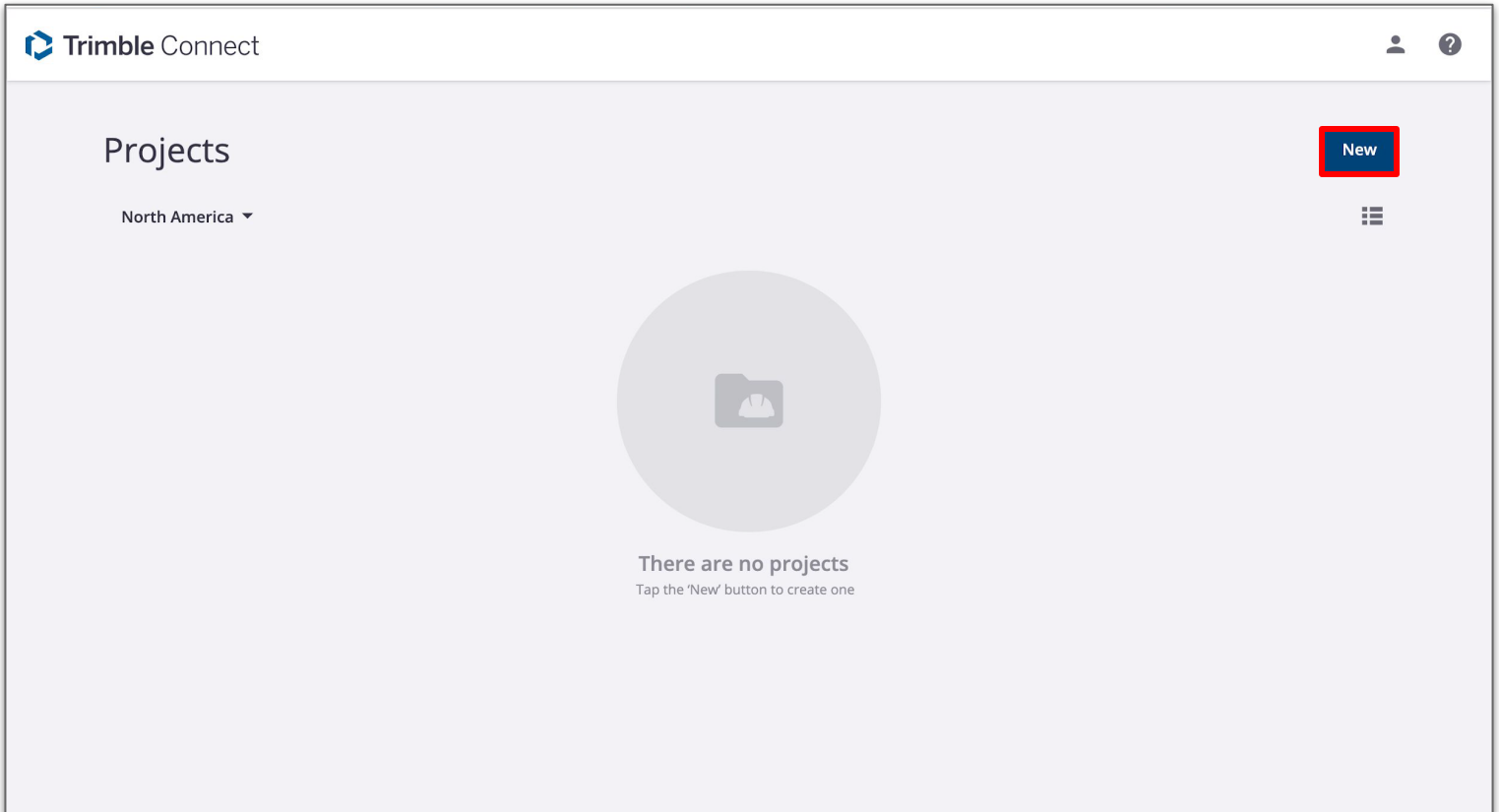

**Step 2:** Enter the name of your project. You may also wish to provide additional details to help your team easily identify the project.

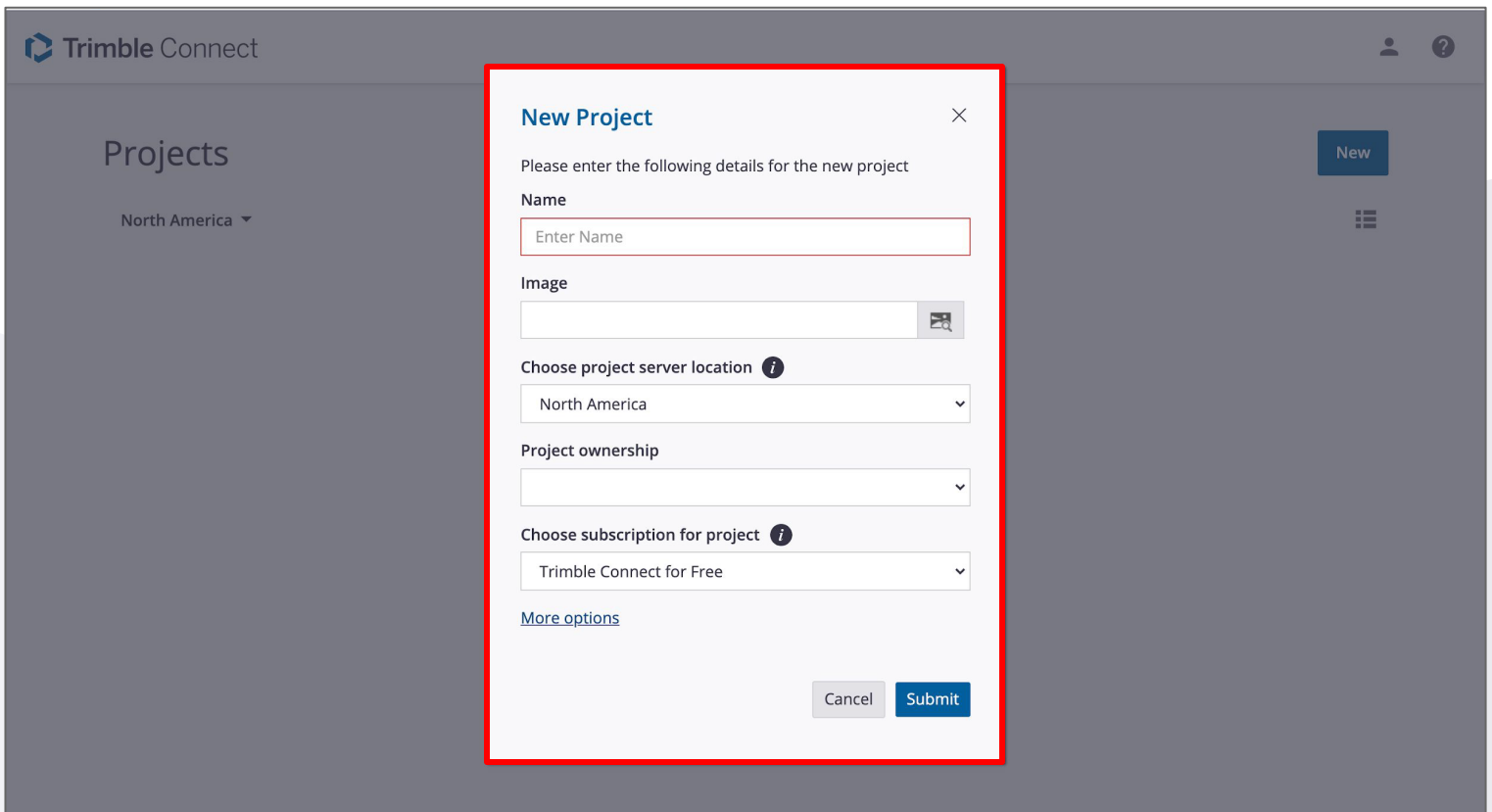

**Step 3:** Now that your project is created, you can add or create project data by clicking the “Add” button in the upper left corner.

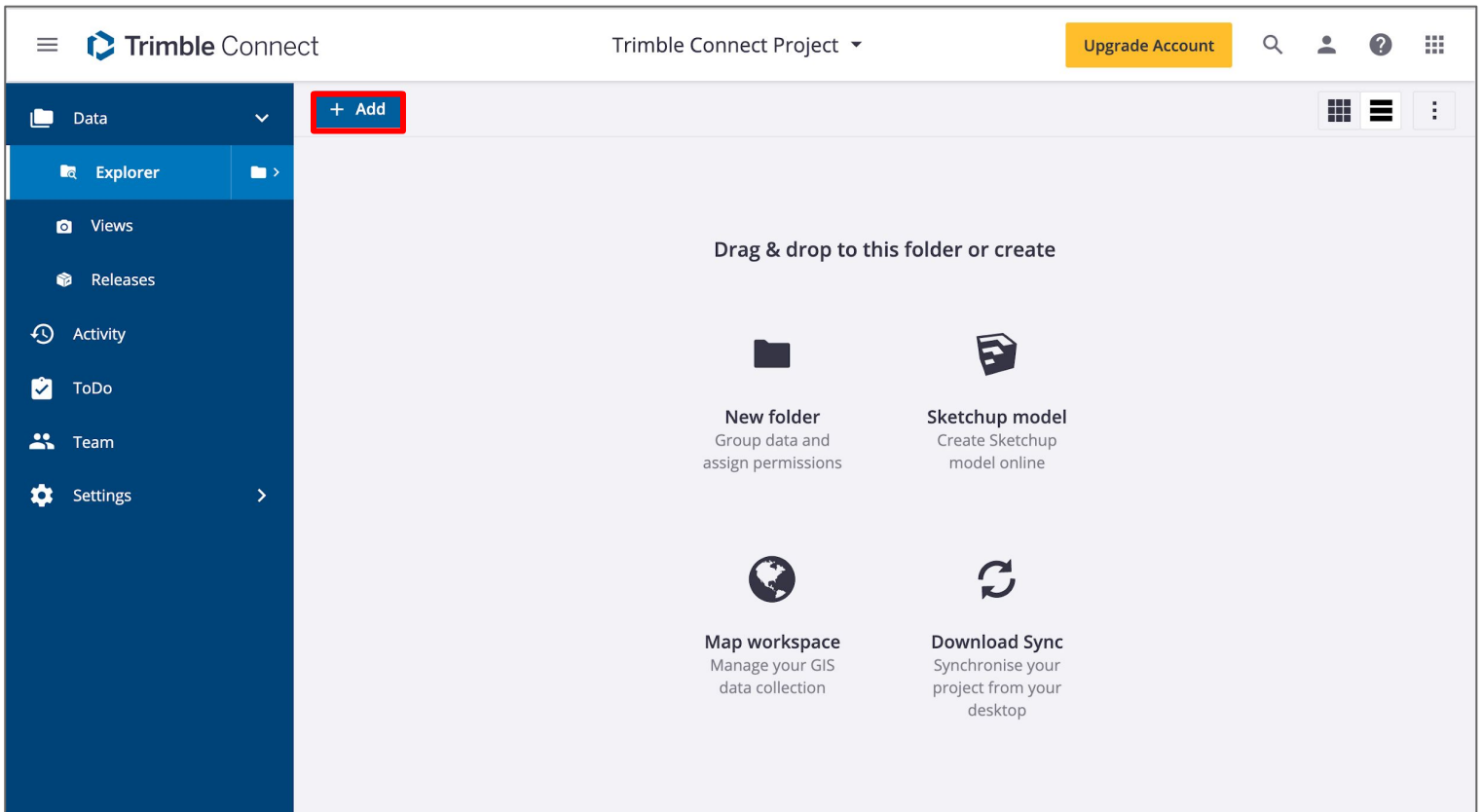

**Step 4:** Upload all of your project files by clicking the “Upload Files” button (For a complete list of compatible file formats, click [here](#)).

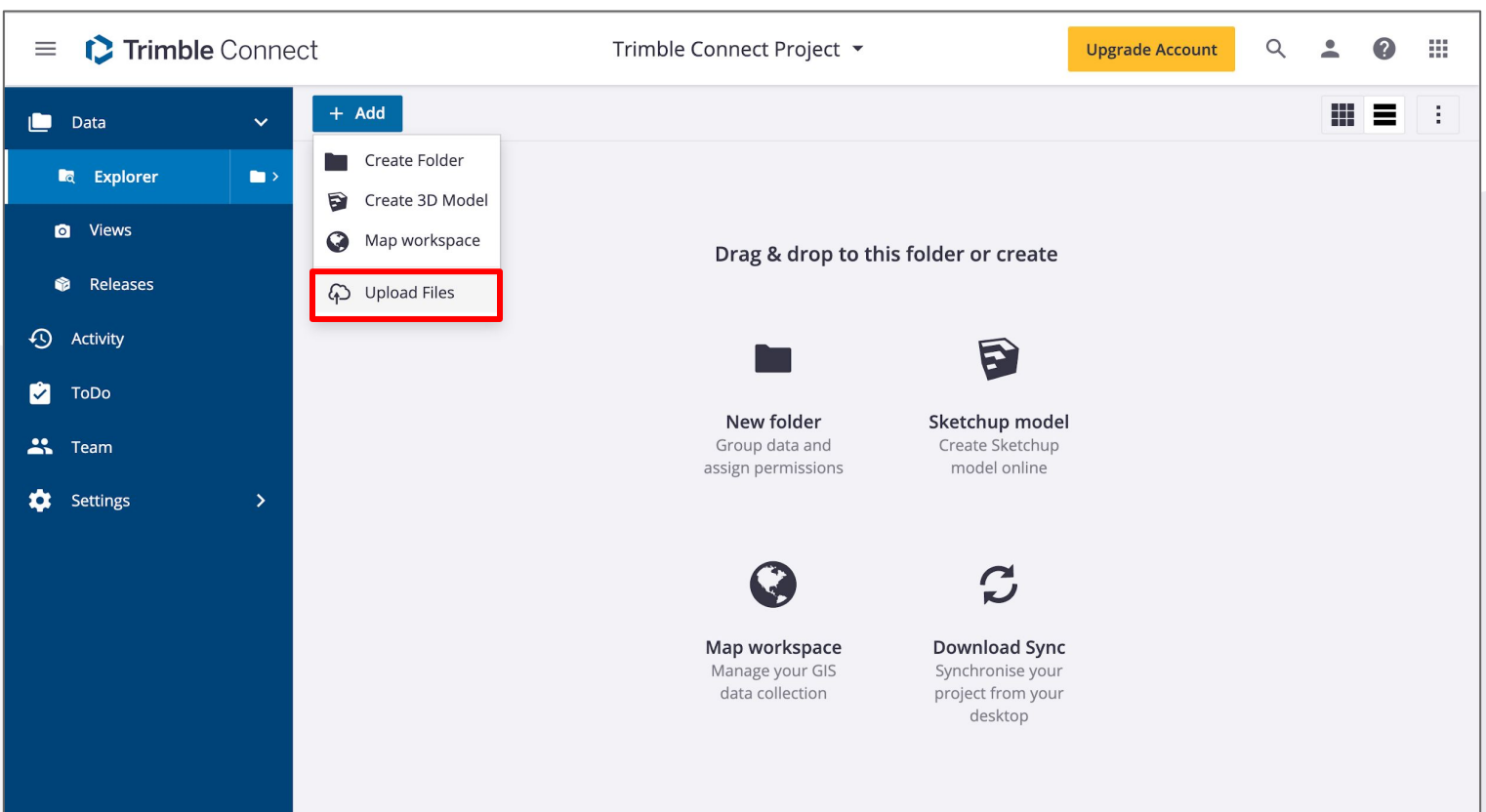

**Step 5:** Keep your project organized by creating a customized folder structure. This allows you to easily group project files together or even assign access permissions as needed.

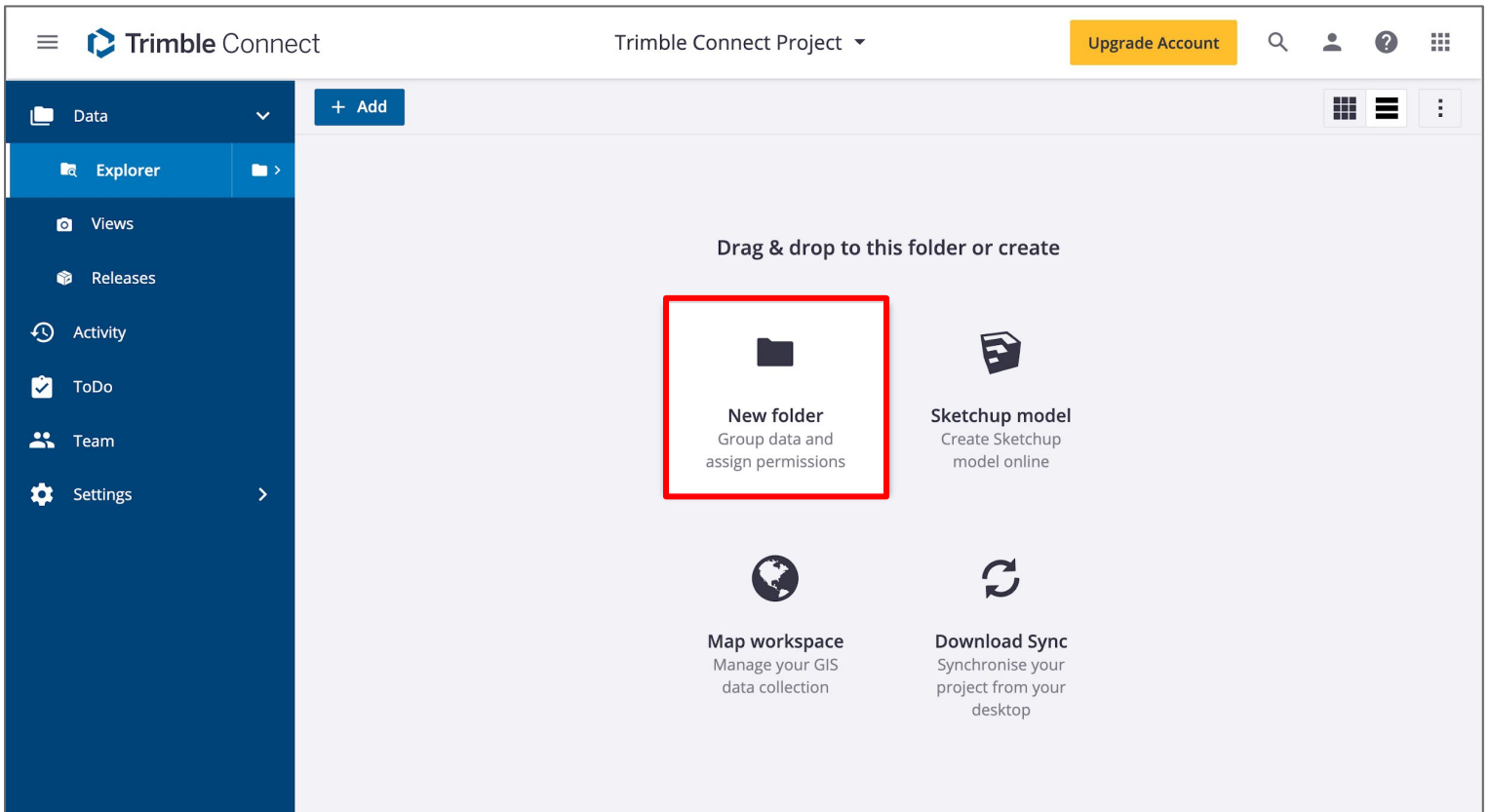

**Step 6:** Keep your project up-to-date by downloading the sync tool and easily synchronizing your project files from your desktop.

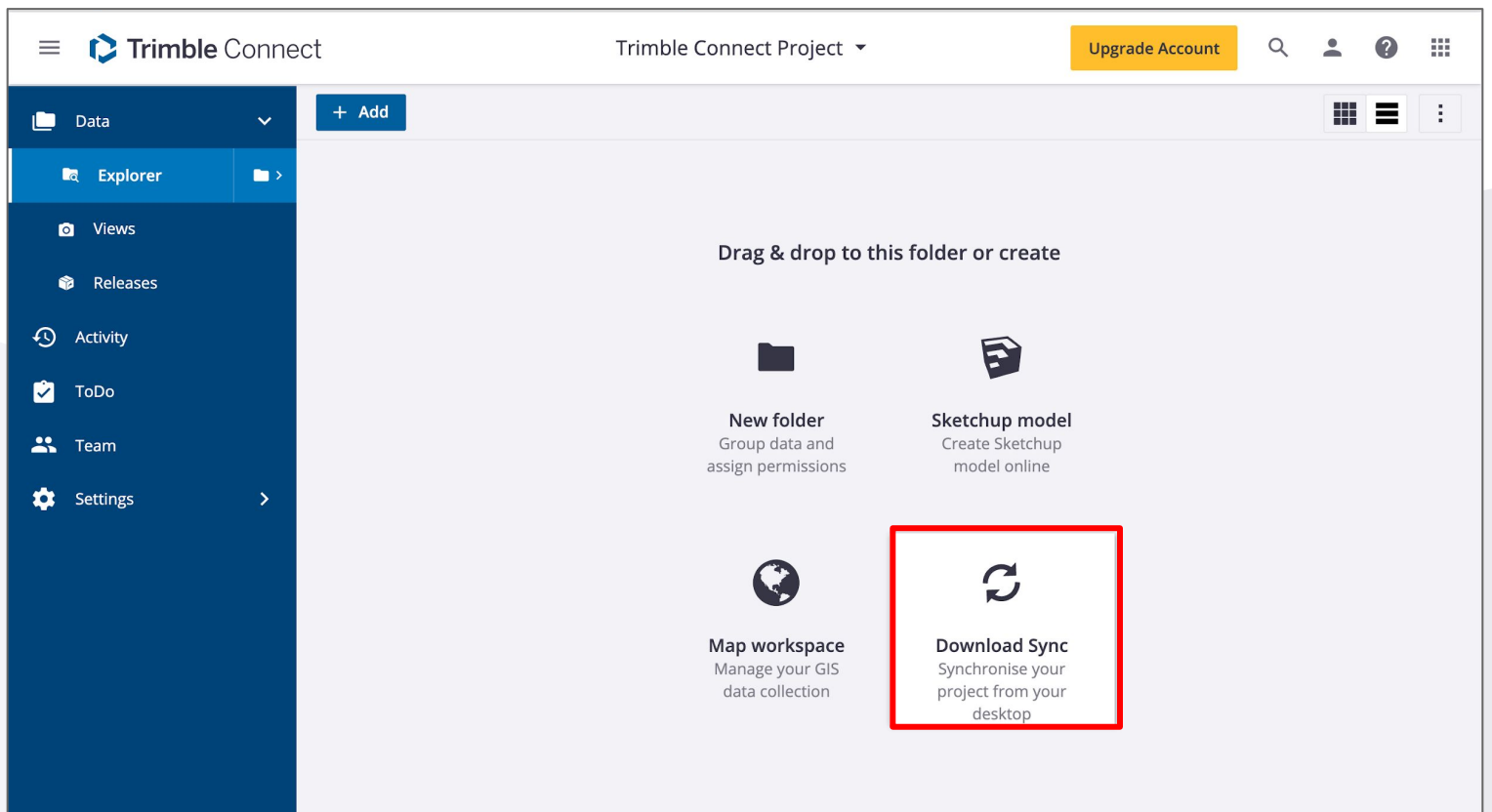

**Step 7:** Create your team by clicking the “Team” tab and then click on “Invite” to invite project members.

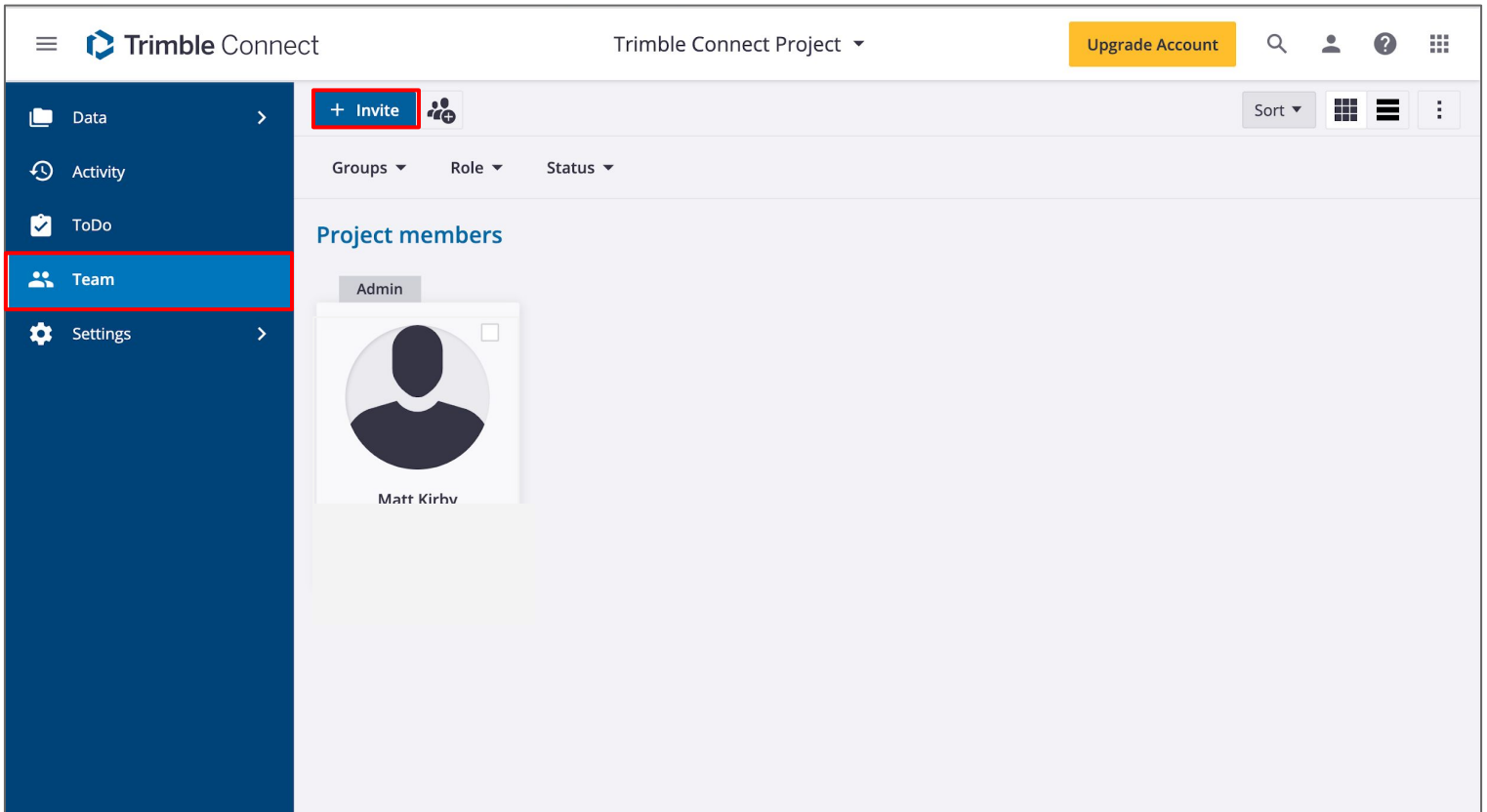

**Step 8:** Also under the “Team” tab, you can easily edit a project member’s role as well as their user permissions to ensure the right people have access to the right data.

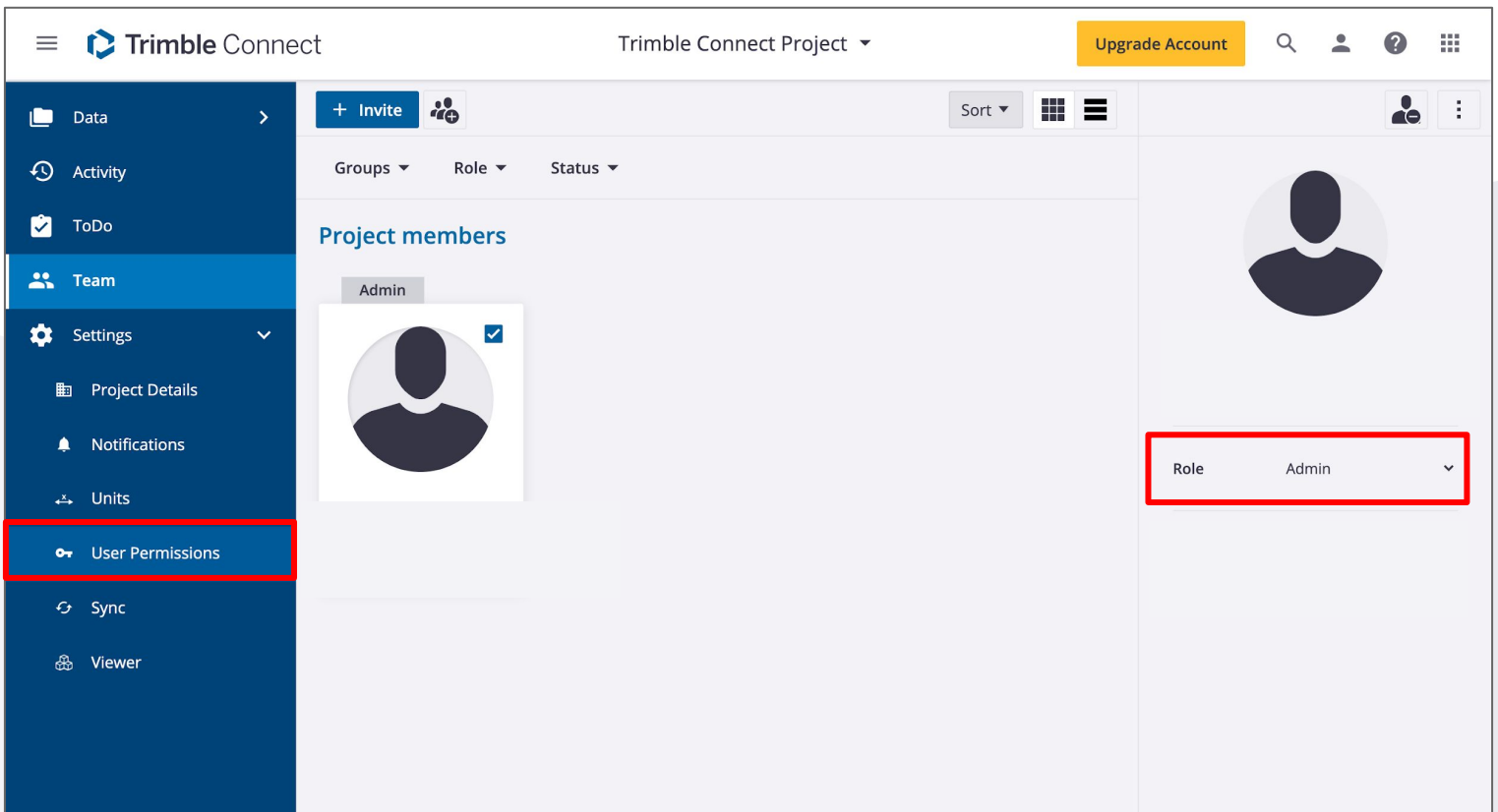

**Step 9:** To begin collaborating, click on the “Data” tab. Under “Explorer”, you can select from your available project files and view them by clicking “View in 3D Viewer”.

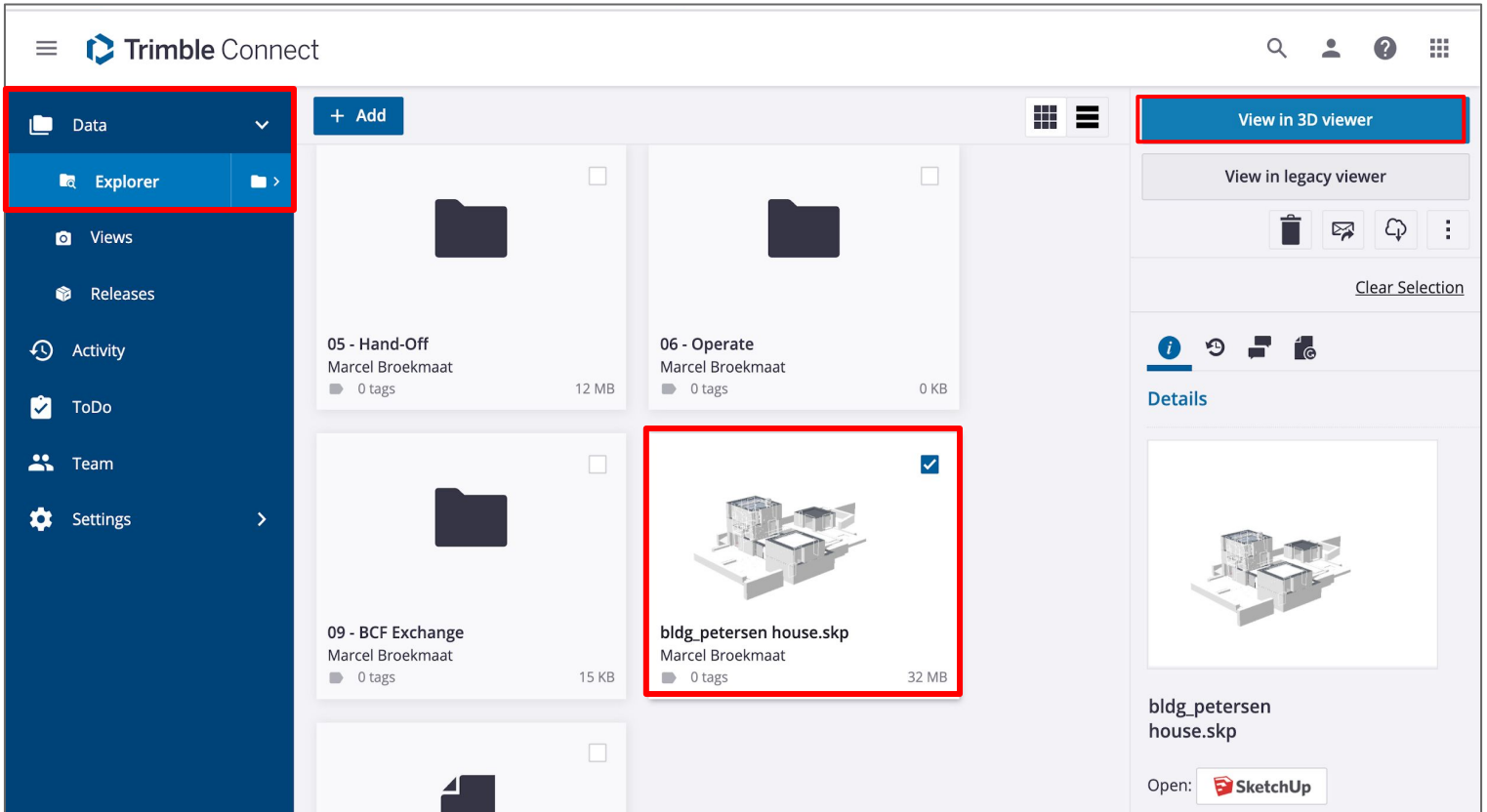

**Step 10:** Easily view, review, annotate, and collaborate on your project by utilizing the various features provided in the 3D Viewer.

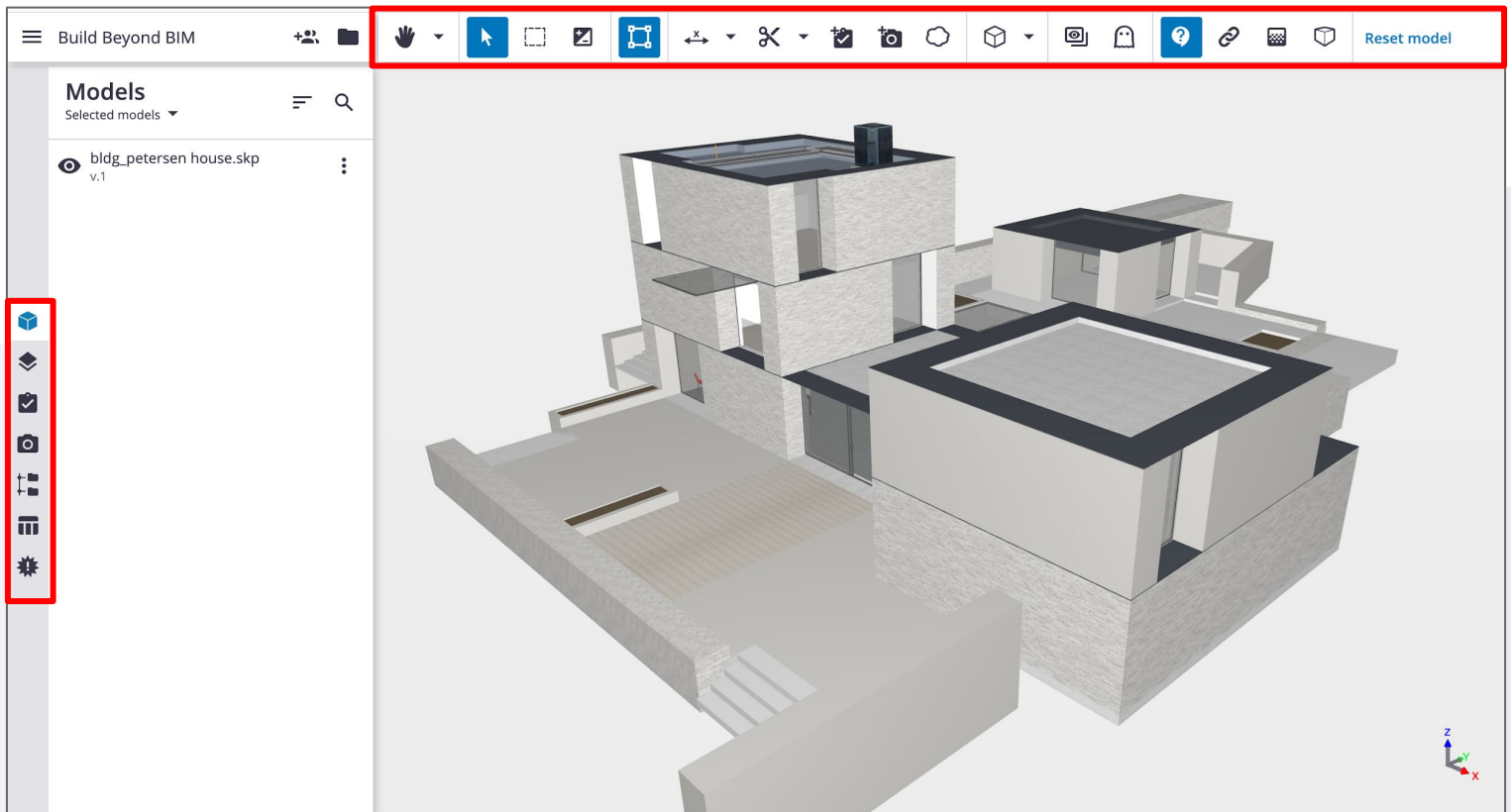



## Collaboration made easy.

For more detailed information on our full application suite, please reference the following user guides:

[Trimble Connect for Browser](#)

[Trimble Connect for Windows](#)

[Trimble Connect for Mobile](#)

For additional resources including user discussions, product documentation, frequently asked questions, video tutorials, and more, visit our [Support & Documentation](#) page or subscribe to the [Trimble Connect YouTube channel](#).