

THE SQUARE®

17901 - 17971 MACARTHUR BOULEVARD | IRVINE, CA 92614



31,943 SF GROSS LEASABLE AREA

- Situated in the bustling Airport Triangle area, this expansive urban village encompasses townhomes, apartments, hotels and newer residential-retail-office developments that are transforming the landscape of the commercial corridor. Conveniently located just near from John Wayne Airport (serving over 10 million passengers annually), with easy access to the 405, 73 and 55 freeways.
- Along with the 15 office buildings at Venture Park, which are within walking distance from the center, the Airport Area is a recognized hub of commerce for the county with a mix of office and industrial campuses.

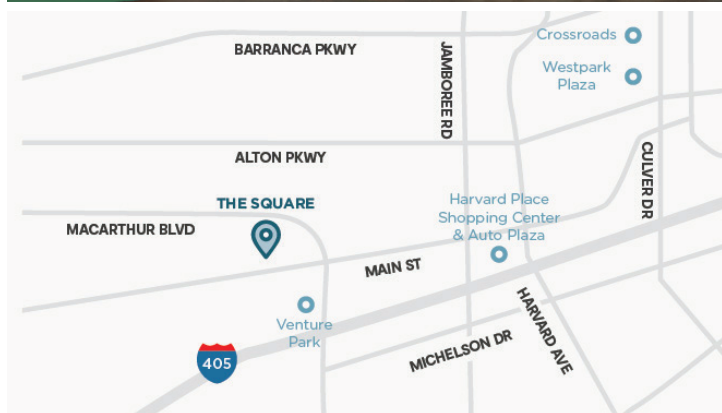

KEY TENANTS

- | | |
|------------------|---------------------|
| Croutons | Poke Dot |
| Cluck Kitchen | Roll Em Up Taquitos |
| Néκτηr Juice Bar | Starbucks Coffee |
| Paderia | Union Bank |

DEMOGRAPHICS (3 MILE RADIUS)

- | | |
|---------------------------------------|---|
| 58,000
AVG DAILY TRAFFIC | 33
MEDIAN AGE |
| 173,000+
POPULATION | \$825,000+
AVG HOME VALUE |
| 311,000+
DAYTIME POPULATION | \$135,000+
AVG HOUSEHOLD INCOME |

17901 - 17971 MACARTHUR BOULEVARD | IRVINE, CA 92614

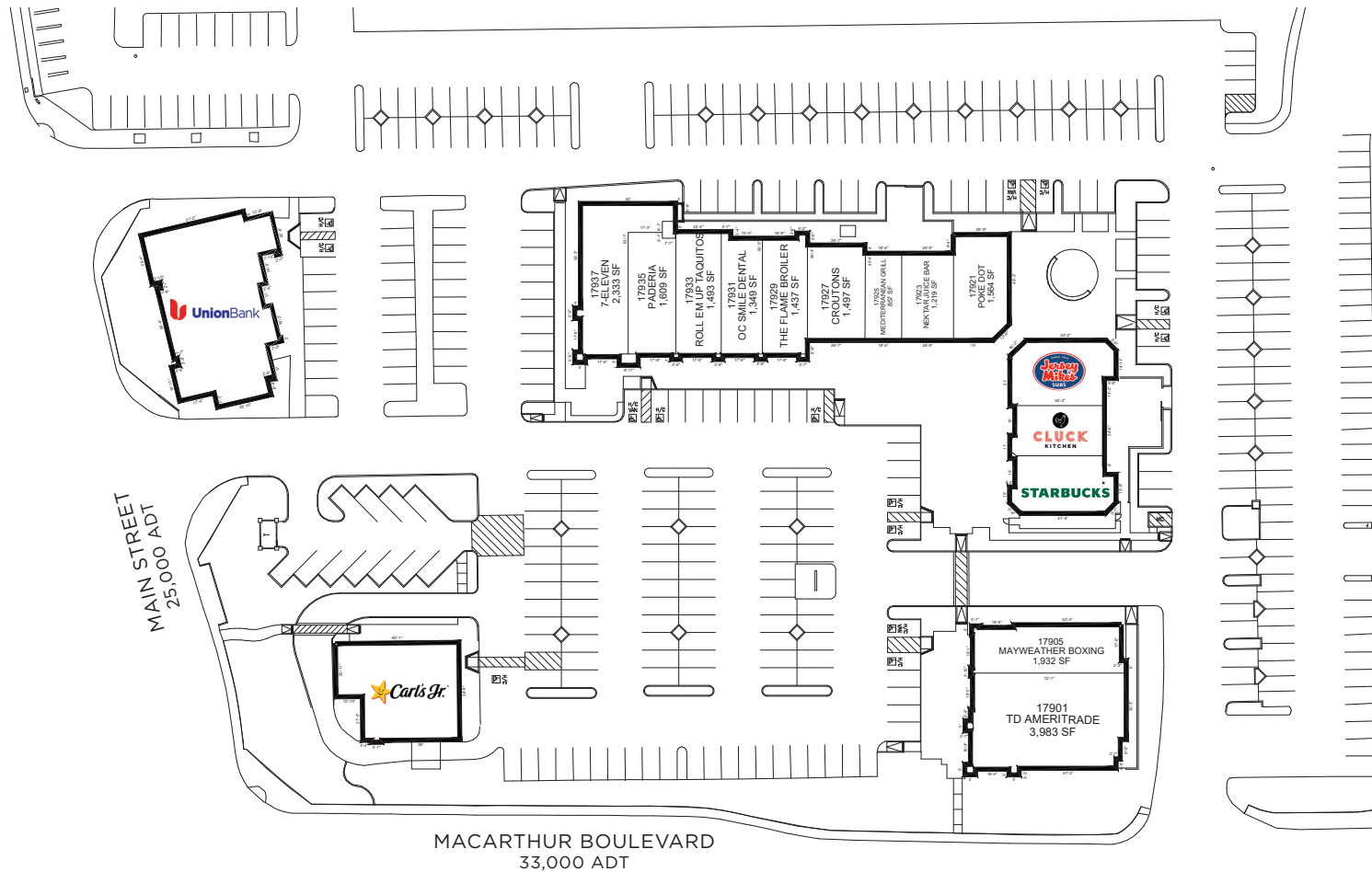

IRVINECOMPANYRETAIL.COM / FOR LEASING INFORMATION, CALL 949.720.2535

© 2023 Irvine Management Company. All Rights Reserved. Sources: 2022 Esri; OCTA Traffic Flow Map. The information contained herein has been obtained from sources we deem reliable. While we have no reason to doubt its accuracy, we do not guarantee it. This is a schematic plan intended only to show the general layout of the Shopping Center and the approximate location of the premises. Landlord, at any time, may change the shape, size, location, number and extent of the improvements shown herein, as well as any additional improvements. Landlord may eliminate, add or relocate any improvements to any portion of the Shopping Center, including, without limitation, buildings, parking areas or structures, roadways, curb cuts, temporary or permanent kiosks, displays or stands, and may add land to and/or withdraw land from the Shopping Center. Plan not to scale. The Square® is a registered trademark of Irvine Management Company. All properties are offered for lease through Irvine Management Company, a licensed real estate broker DRE LIC. #02041810.