

SANTA CLARA SQUARE MARKETPLACE

2702 - 2782 AUGUSTINE DRIVE | SANTA CLARA, CA 95054



123,421 SF GROSS LEASABLE AREA

- Less than two miles from major attractions including Great America Amusement Park, Levi's Stadium (home to the San Francisco 49ers), Mineta San Jose International Airport, and Santa Clara Convention Center which welcomes hundreds of thousands of conference and meeting attendees annually.
- Employers in the area include Cisco Systems, eBay, Google, Hewlett-Packard, and more.
- Nearby colleges include Santa Clara University (9,000+ students) and Mission College.
- Part of Santa Clara Square, a modern integrated community with 1,850 luxury apartment homes and a premier 1.7 million sf workplace community, home to companies such as Intel, Applied Materials, and NVIDIA.

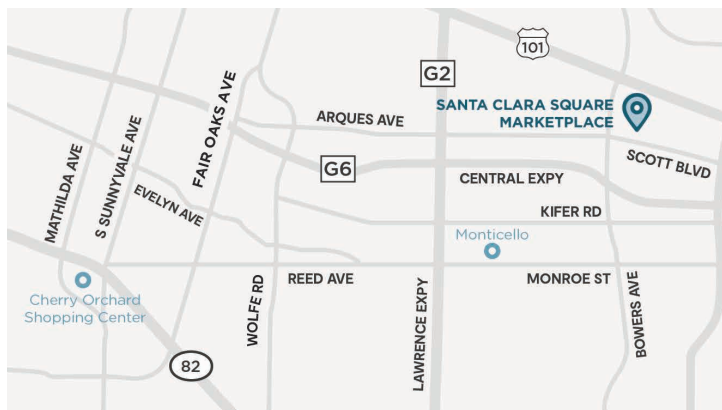

KEY TENANTS

- | | |
|---------------------------------------|--------------------|
| Eureka! | Il Fornaio |
| eyeXam Optometry | Puesto |
| Fleming's Prime Steakhouse & Wine Bar | Whole Foods Market |

DEMOGRAPHICS (3 MILE RADIUS)

- | | |
|---------------------------------------|---|
| 208,000
AVG DAILY TRAFFIC | 37
MEDIAN AGE |
| 201,000+
POPULATION | \$1.3 million+
AVG HOME VALUE |
| 312,000+
DAYTIME POPULATION | \$201,000+
AVG HOUSEHOLD INCOME |



SANTA CLARA SQUARE MARKETPLACE

2702 - 2782 AUGUSTINE DRIVE | SANTA CLARA, CA 95054

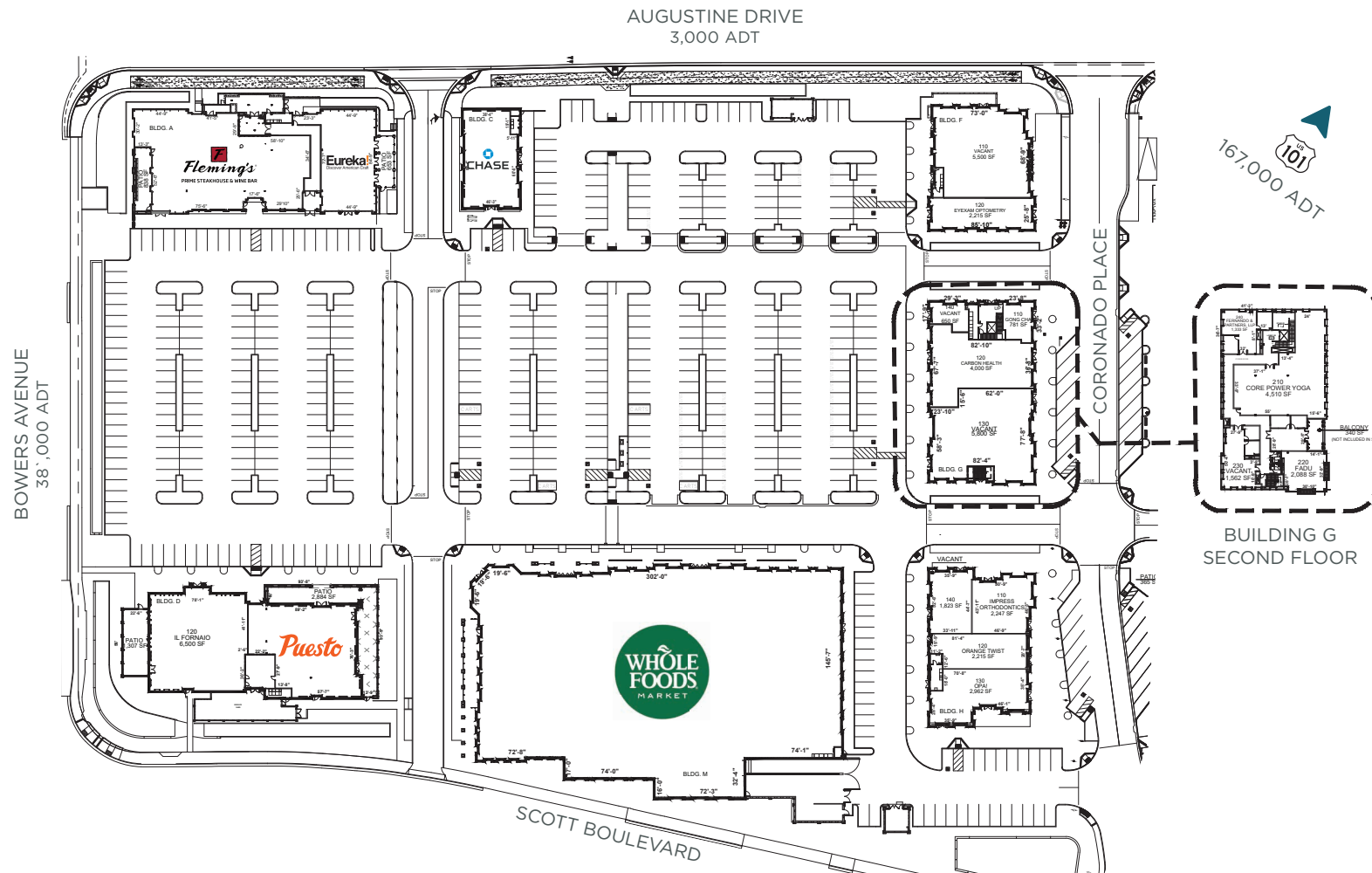

IRVINECOMPANYRETAIL.COM / FOR LEASING INFORMATION, CALL 949.720.2535

© 2024 Irvine Management Company. All Rights Reserved. Sources: 2023 Esri; 2023 City of Santa Clara; 2023 scu.edu. The information contained herein has been obtained from sources we deem reliable. While we have no reason to doubt its accuracy, we do not guarantee it. This is a schematic plan intended only to show the general layout of the Shopping Center and the approximate location of the premises. Landlord, at any time, may change the shape, size, location, number and extent of the improvements shown herein, as well as any additional improvements. Landlord may eliminate, add or relocate any improvements to any portion of the Shopping Center, including, without limitation, buildings, parking areas or structures, roadways, curb cuts, temporary or permanent kiosks, displays or stands, and may add land to and/or withdraw land from the Shopping Center. Plan not to scale.

All properties are offered for lease through Irvine Management Company, a licensed real estate broker DRE LIC. #02041810.