

FRANKLIN STREET APARTMENTS

1501 - 1551 EL CAMINO REAL | REDWOOD CITY, CA 94063



4,974 SF GROSS LEASABLE AREA

Apartment Units: 200+

- Situated south of the 101 freeway and Chestnut Street.
- Located in downtown Redwood City, within walking distance to restaurants, grocery stores, schools, shopping, and entertainment venues.
- Less than one mile from Redwood City Caltrain Station and Redwood City Public Library.
- Draws customers from nearby major businesses including Box Inc., Electronic Arts, Oracle, and more.
- Minutes away from the Bair Island Marina and the Irvine Company-owned luxury apartment community of The Villas at Bair Island (150+ units).
- With a high walk score rating, this area is extremely pedestrian-friendly, making it very convenient to accomplish most errands on foot.



KEY TENANTS

Togo's Great Sandwiches Nature's Green Cleaners

DEMOGRAPHICS (3 MILE RADIUS)

40,000

AVG DAILY TRAFFIC

40

MEDIAN AGE

133,000+

POPULATION

\$1.7 million+

AVG HOME VALUE

138,000+

DAYTIME POPULATION

\$209,000+

AVG HOUSEHOLD INCOME

APARTMENT RESIDENT PROFILE

\$170,000+

MEDIAN HOUSEHOLD INCOME

28

MEDIAN AGE



FRANKLIN STREET APARTMENTS

1501 - 1551 EL CAMINO REAL | REDWOOD CITY, CA 94063

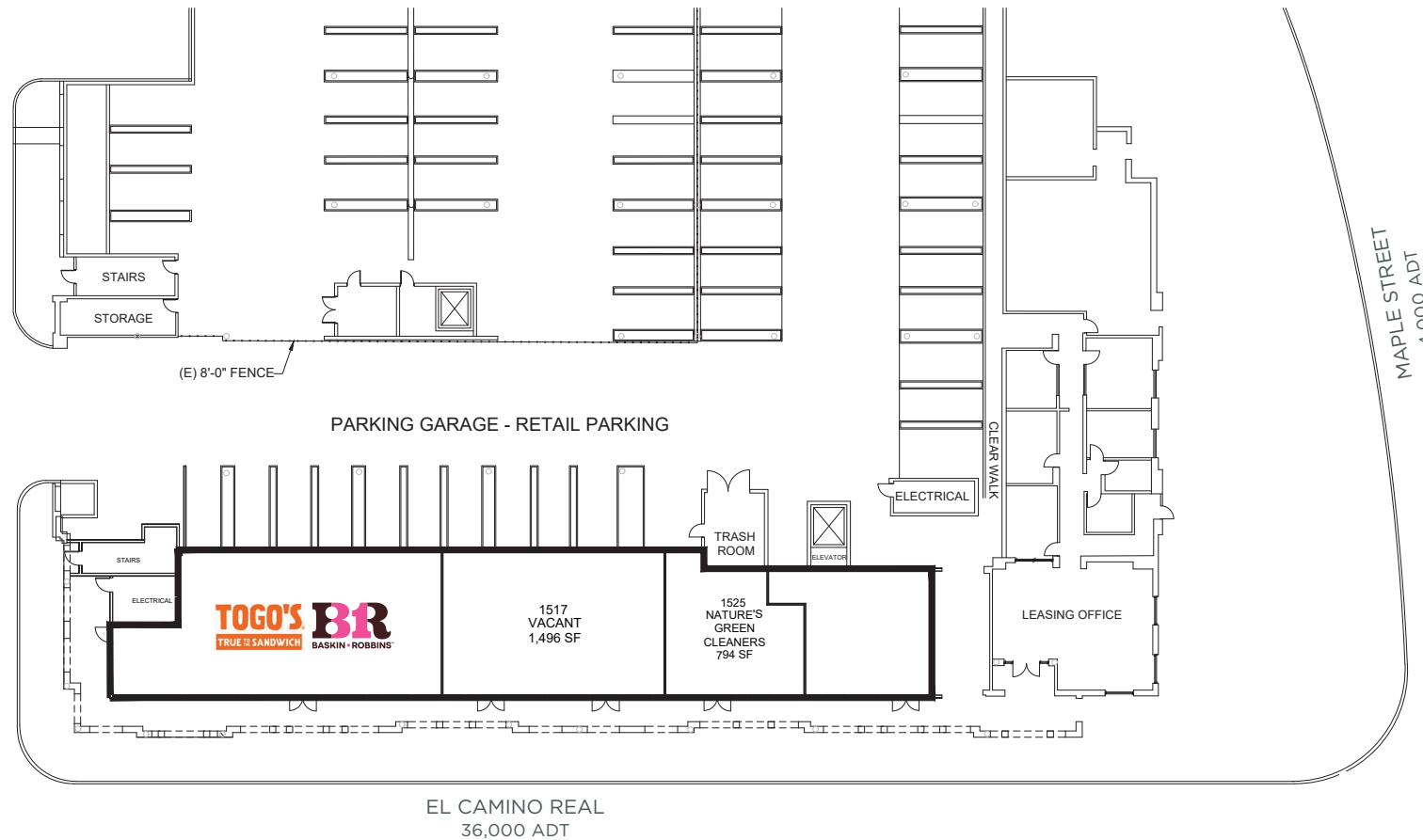

IRVINECOMPANYRETAIL.COM / FOR LEASING INFORMATION, CALL 949.720.2535

© 2024 Irvine Management Company. All Rights Reserved. Sources: 2023 Esri; 2022 Kalibrate Technologies. The information contained herein has been obtained from sources we deem reliable. While we have no reason to doubt its accuracy, we do not guarantee it. This is a schematic plan intended only to show the general layout of the Shopping Center and the approximate location of the premises. Landlord, at any time, may change the shape, size, location, number and extent of the improvements shown herein, as well as any additional improvements. Landlord may eliminate, add or relocate any improvements to any portion of the Shopping Center, including, without limitation, buildings, parking areas or structures, roadways, curb cuts, temporary or permanent kiosks, displays or stands, and may add land to and/or withdraw land from the Shopping Center. Plan not to scale.

All properties are offered for lease through Irvine Management Company, a licensed real estate broker DRE LIC. #02041810.