

# CRESCENT VILLAGE APARTMENT HOMES

3250 - 3350 ZANKER ROAD | SAN JOSE, CA 95134



## 12,928 SF GROSS LEASABLE AREA

Apartment Units: 2,100+

- Easy access from the San Tomas/Montague Expressway.
- Located within North San Jose Innovation Triangle; home to the world's most recognized technology companies including Google, Cisco, Samsung, Broadcom, and Apple.
- Crescent Village is a residential community of over 2,500 luxury apartment homes within a one mile radius of additional Irvine Company apartment developments, North Park, and River View Apartment Homes.
- All residential communities combined offer over 5,000 luxury apartment homes in the immediate trade area providing an ample customer base with access for direct marketing.
- With a high walk score rating, this area is extremely pedestrian-friendly, making it very convenient to accomplish most errands on foot.

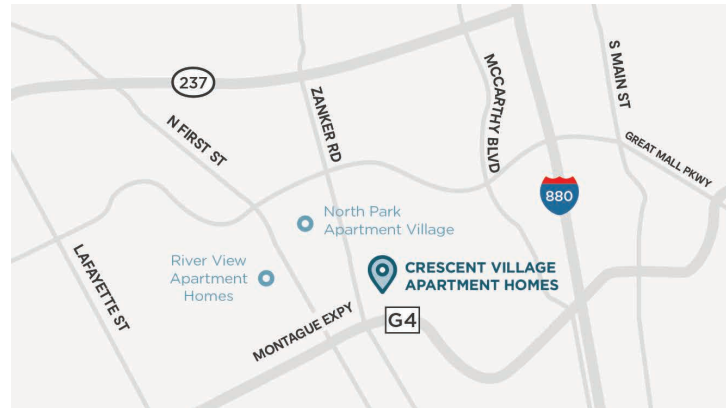

### KEY TENANTS

Curry Up Now  
Laksana Thai Cuisine  
Tandoori Pizza  
Starbucks Coffee

### DEMOGRAPHICS (3 MILE RADIUS)

<b>11,000</b> AVG DAILY TRAFFIC	<b>36</b> MEDIAN AGE
<b>118,000+</b> POPULATION	<b>\$1.1 million+</b> AVG HOME VALUE
<b>312,000+</b> DAYTIME POPULATION	<b>\$209,000+</b> AVG HOUSEHOLD INCOME

### APARTMENT RESIDENT PROFILE

<b>\$227,00+</b> MEDIAN HOUSEHOLD INCOME	<b>31</b> MEDIAN AGE
---	-------------------------



**IRVINE COMPANY**  
RETAIL PROPERTIES

# CRESCENT VILLAGE APARTMENT HOMES

3250 - 3350 ZANKER ROAD | SAN JOSE, CA 95134

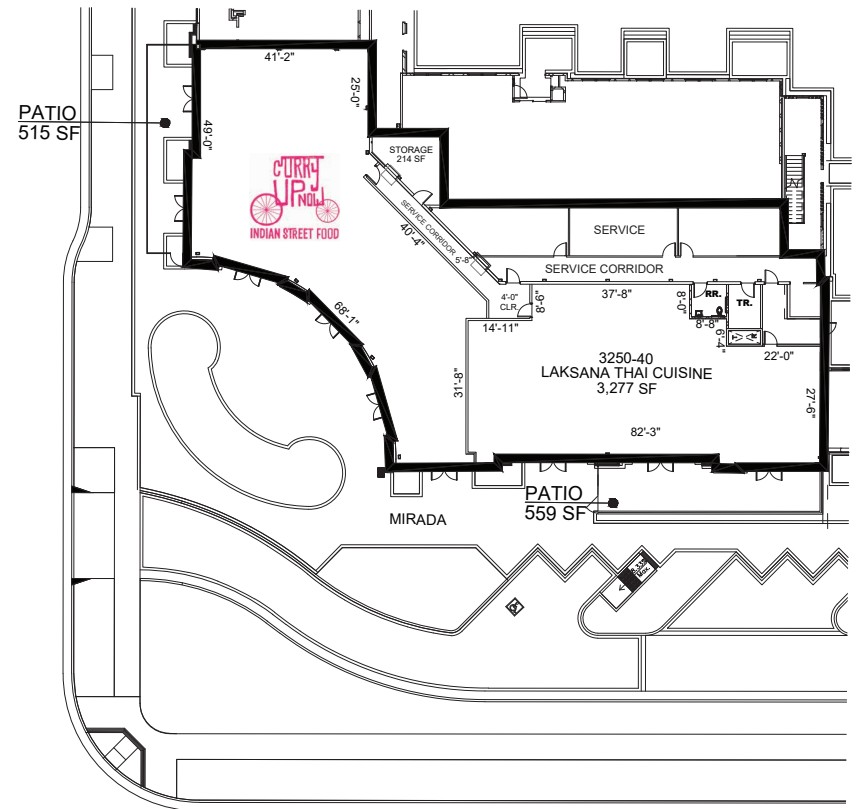
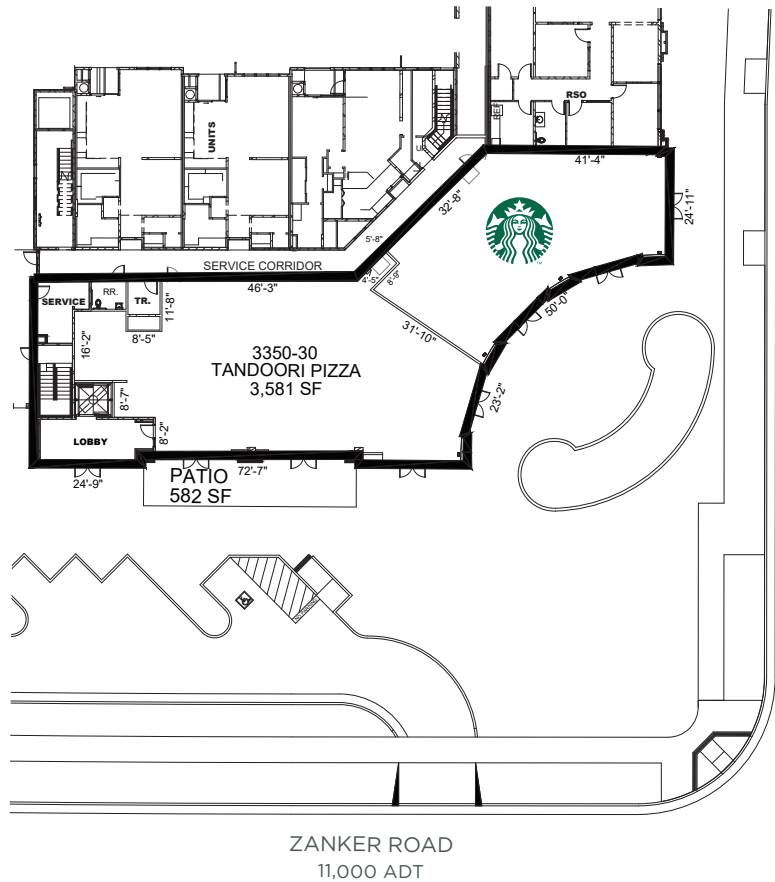

[IRVINECOMPANYRETAIL.COM](http://IRVINECOMPANYRETAIL.COM) / FOR LEASING INFORMATION, CALL 949.720.2535

© 2024 Irvine Management Company. All Rights Reserved. Sources: 2023 Esri; 2023 City of San Jose. The information contained herein has been obtained from sources we deem reliable. While we have no reason to doubt its accuracy, we do not guarantee it. This is a schematic plan intended only to show the general layout of the Shopping Center and the approximate location of the Premises. Landlord, at any time, may change the shape, size, location, number and extent of the improvements shown herein, as well as any additional improvements. Landlord may eliminate, add or relocate any improvements to any portion of the Shopping Center, including, without limitation, buildings, parking areas or structures, roadways, curb cuts, temporary or permanent kiosks, displays or stands, and may add land to and/or withdraw land from the Shopping Center. Plan not to scale.

All properties are offered for lease through Irvine Management Company, a licensed real estate broker DRE LIC. #02041810.