

# Crescent Village Apartment Homes

3250 - 3350 ZANKER ROAD | SAN JOSE, CA 95134



## 12,928 SF GROSS LEASABLE AREA

Apartment Units: 2,188

- Crescent Village Apartment Homes is a mixed-use Amenity Center designed to provide a convenient environment that seamlessly integrates the demands of work, life, and play.
- Crescent Village Apartment Homes is a residential community of over 2,500 luxury apartment homes within a one-mile radius of additional Irvine Company apartment developments: North Park, and River View Apartment Homes.
- Easy access from the San Tomas/Montague Expressway.
- Located within North San Jose Innovation Triangle; home to the world's most-recognized technology companies.
- All residential communities combined offer over 5,000 luxury apartment homes in the immediate trade area providing an ample customer base with access for direct marketing.
- With a high walking score rating, this area is extremely pedestrian friendly, making it very convenient to accomplish most errands by foot.

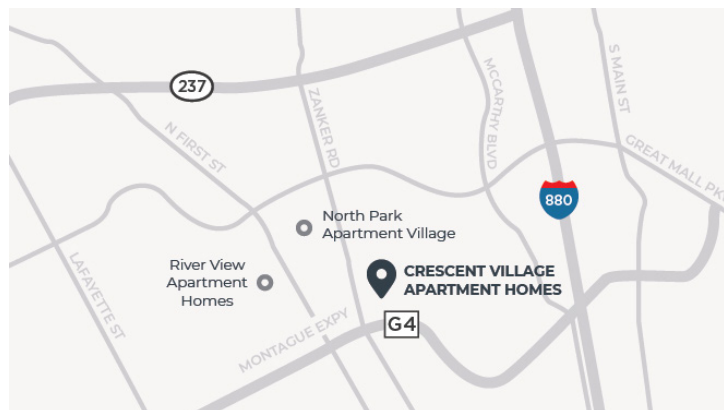

### KEY TENANTS

Curry Up Now

Tandoori Pizza

Laksana Thai Cuisine

Starbucks Coffee

### TOTAL TRADE AREA DEMOGRAPHICS

**127K**  
Annual Visits<sub>1</sub>

**96%**  
Higher Spend on Food<sub>2</sub>  
Vs. the National Average

**36**  
Average Age<sub>2</sub>

**82%**  
Higher Spend on Retail Goods<sub>2</sub>  
Vs. the National Average

**\$221K**  
Avg Household  
Income<sub>2</sub>

### APARTMENT RESIDENT PROFILE

**31**  
Median Age<sub>3</sub>

**\$230K**  
Median Household Income<sub>3</sub>

Total = 70% of visits

Sources: (1) Placer.ai, (2) Esri 2024, (3) Onesite

# Crescent Village Apartment Homes



3250 - 3350 ZANKER ROAD | SAN JOSE, CA 95134

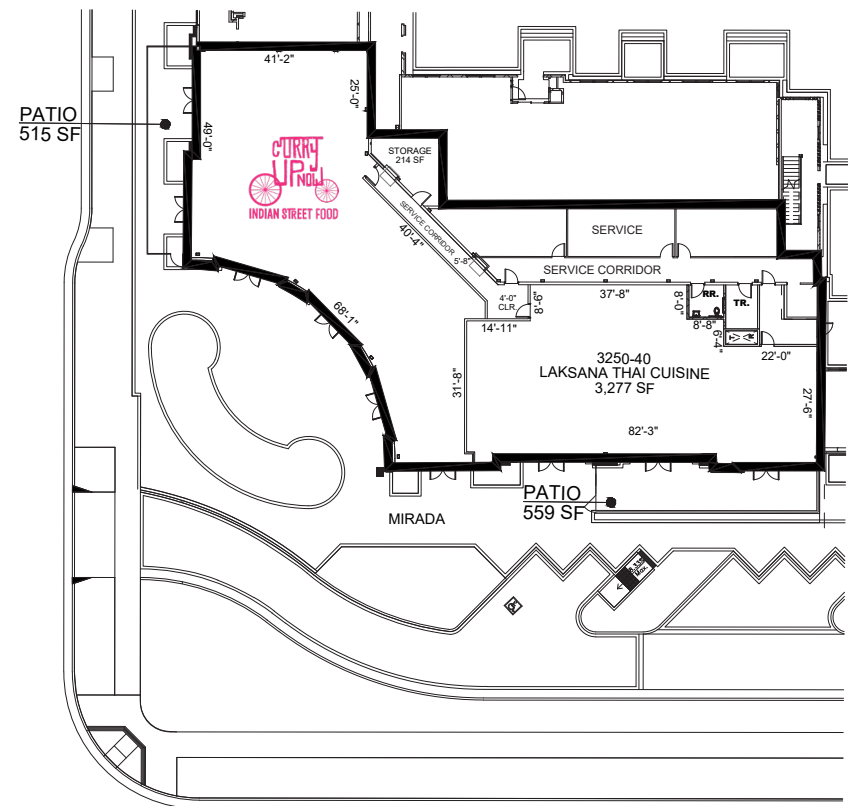
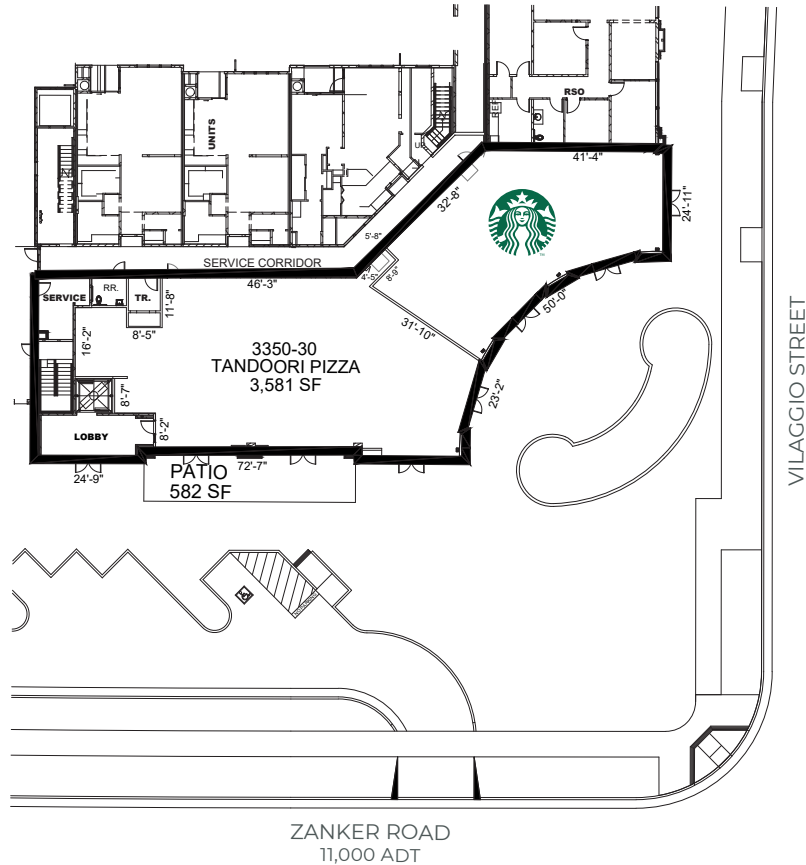

**FOR MORE INFORMATION, VISIT [IRVINECOMPANYRETAIL.COM](https://www.irvinecompanyretail.com)**

© 2025 Irvine Management Company. All Rights Reserved. Sources: 2024 Esri; Placer.ai; Onesite; 2024 City of San Jose. The information contained herein has been obtained from sources we deem reliable. While we have no reason to doubt its accuracy, we do not guarantee it. This is a schematic plan intended only to show the general layout of the Shopping Center and the approximate location of the Premises. Landlord, at any time, may change the shape, size, location, number and extent of the improvements shown herein, as well as any additional improvements. Landlord may eliminate, add or relocate any improvements to any portion of the Shopping Center, including, without limitation, buildings, parking areas or structures, roadways, curb cuts, temporary or permanent kiosks, displays or stands, and may add land to and/or withdraw land from the Shopping Center. Plan not to scale. Irvine Company and the Sunwave logo are registered trademarks of Irvine Management Company. All other trademarks are the property of their respective owners. All properties are offered for lease through Irvine Management Company, a licensed real estate broker DRE LIC. #02041810.