

MONTICELLO

3515 - 3585 MONROE STREET | SANTA CLARA, CA 95051



46,191 SF GROSS LEASABLE AREA

Apartment Units: 800+

- Walking access to Lawrence Caltrain Station linking Santa Clara, San Mateo, and San Francisco counties.
- Within one mile of additional Irvine Company-owned apartment developments, Stewart Village (250+ units), and Santa Clara Square Apartment Homes (1,800+ units).
- Near 1.7 million+ sf of Class A office space home to Ericsson.
- Located near the North San Jose Innovation Triangle, home to the world's most recognized companies including Broadcom, Cisco, Intel, and Apple.

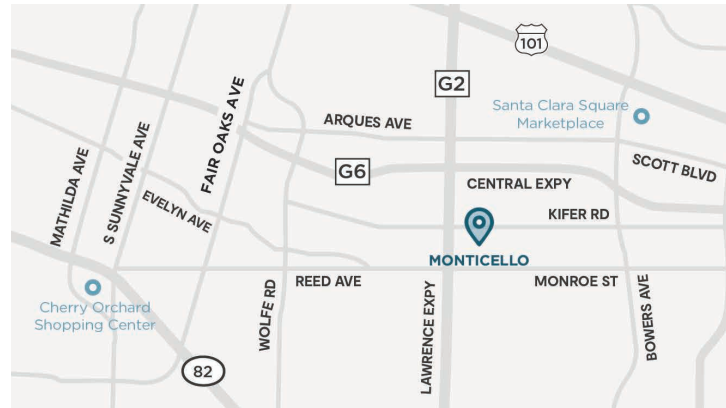

KEY TENANTS

California Pizza Kitchen
Orangetheory Fitness
Pressed

Starbucks Coffee
The Yellow Chilli
Vitality Bowls

DEMOGRAPHICS (3 MILE RADIUS)

83,000
AVG DAILY TRAFFIC

38
MEDIAN AGE

231,000+
POPULATION

\$1.5 million+
AVG HOME VALUE

285,000+
DAYTIME POPULATION

\$205,000+
AVG HOUSEHOLD INCOME

APARTMENT RESIDENT PROFILE

\$238,000+
MEDIAN HOUSEHOLD INCOME

31
MEDIAN AGE



3515 - 3585 MONROE STREET | SANTA CLARA, CA 95051

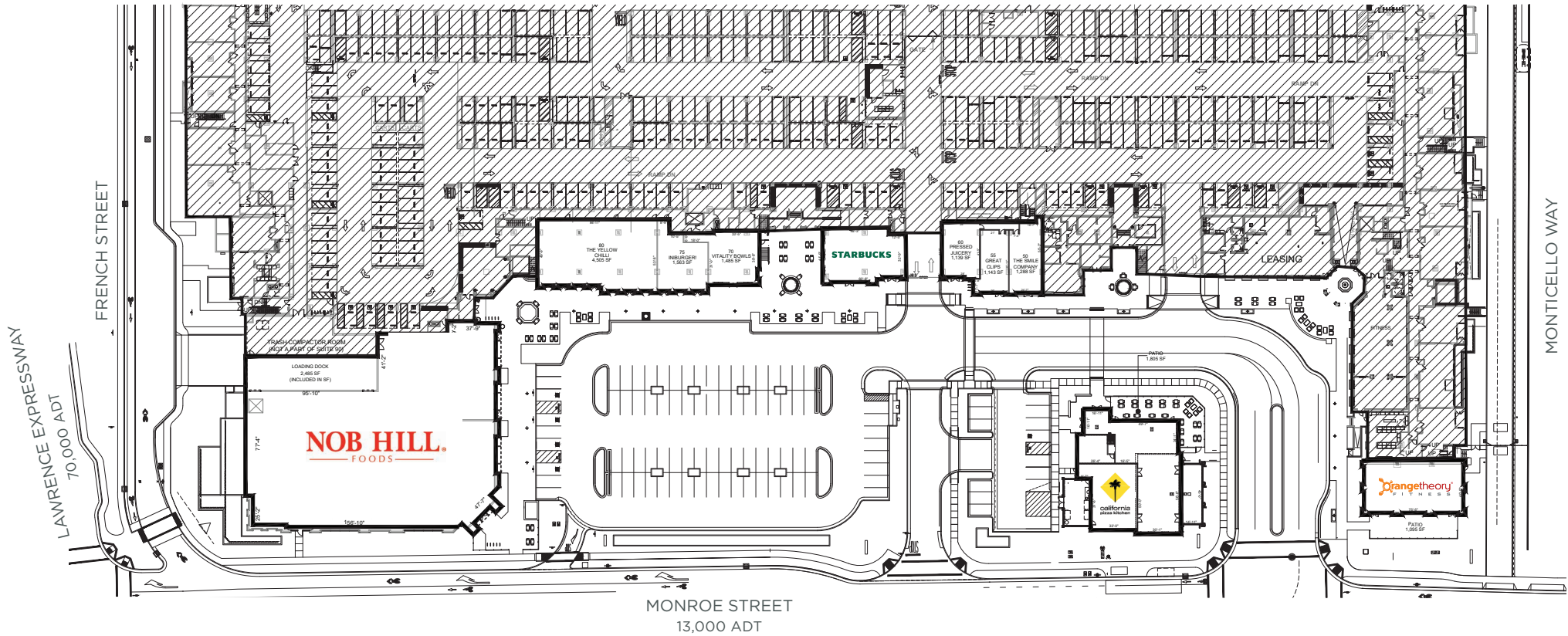

IRVINECOMPANYRETAIL.COM / FOR LEASING INFORMATION, CALL 949.720.2535

© 2024 Irvine Management Company. All Rights Reserved. Sources: 2023 Esri; 2022 Kalibrate Technologies. The information contained herein has been obtained from sources we deem reliable. While we have no reason to doubt its accuracy, we do not guarantee it. This is a schematic plan intended only to show the general layout of the Shopping Center and the approximate location of the Premises. Landlord, at any time, may change the shape, size, location, number and extent of the improvements shown herein, as well as any additional improvements. Landlord may eliminate, add or relocate any improvements to any portion of the Shopping Center, including, without limitation, buildings, parking areas or structures, roadways, curb cuts, temporary or permanent kiosks, displays or stands, and may add land to and/or withdraw land from the Shopping Center. Plan not to scale.

All properties are offered for lease through Irvine Management Company, a licensed real estate broker DRE LIC. #02041810.