

VILAGGIO STREET

PATIO
515 SF

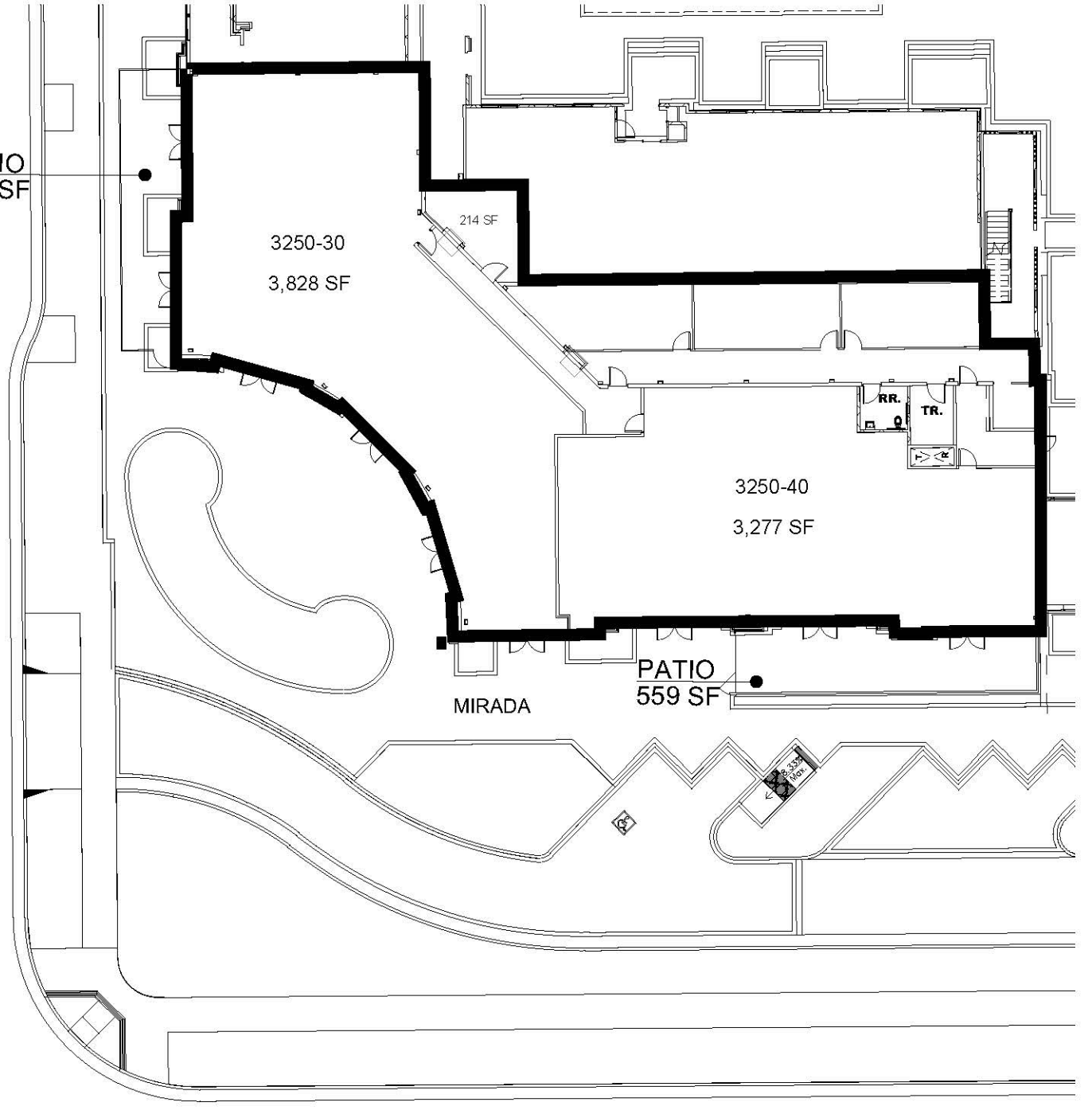

ZANKER ROAD

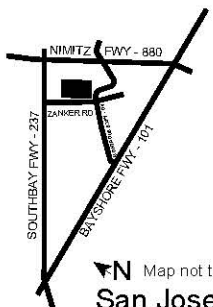

CRESCENT VILLAGE
APARTMENT HOMES

April 2024

© 2018 The Irvine Company LLC. All Rights Reserved. All properties are offered for lease by Irvine Management Company. Sources: Nielsen Claritas 2018; OCTA 2017 Traffic Flow Map; Caltrans 2015, San Joaquin Transportation and Traffic 2011. This is an illustrative plan intended only to show the general layout of the Shopping Center and the approximate location of the Displays, Pelican Island, Irvine Spectrum, Irvine Spectrum Center, Irvine Towers, Los Olivos, Newport Center, Newport Center, Newport Ridge, Oak Creek, Oak Creek Golf Club, Orchard Hill, Pacific Ridge, Portola Springs, Quail Hill, The Irvine Ranch, The Square, Tustin Ridge, University Research Park, and Westpark. All registered trademarks of Irvine Management Company. Pelican Island, Pelican Hill Golf Club, and The Resort at Pelican Hill are trademarks of The Irvine Company LLC. Landlord, at any time, may change the shape, size, location, number and content of the improvement shown hereon, as well as any additional improvements to any portion of the Shopping Center, its building, without the notice, building, parking area or structure, roadway, curb cut, temporary or permanent blocks, displays or stands, and may add land to under with the land from the Shopping Center. PLEASE NOT TO SCALE.