

## THE BOX CONTENT

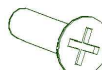

M4 Cross-Head Bolt



M4 Countersunk-Head Bolt

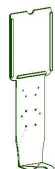

Information Board



Waste Bowl



Dispenser



Plexiglass Board

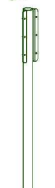

Upper Part

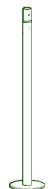

Lower Part



M6 Cross-Head Bolt



Base



Balance Block



M10 Allen Bolt

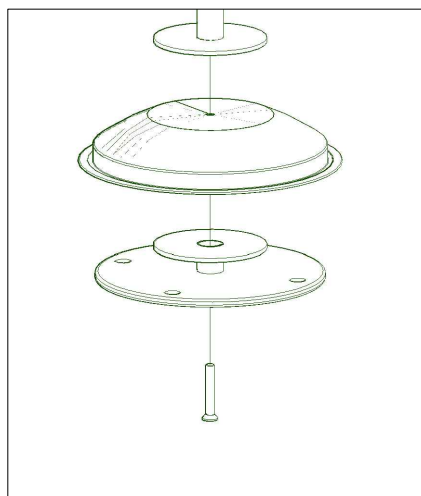

Step 1: Please assemble the base, balance block and upper part by using the M10 allen bolt as shown on the image.

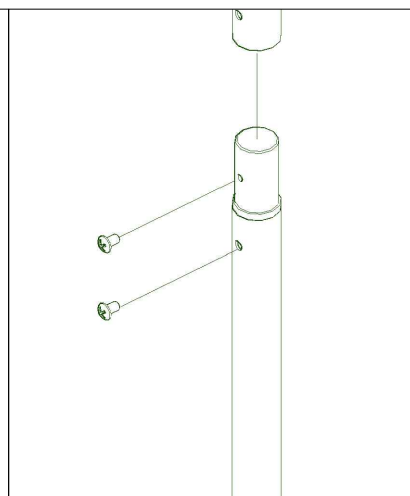

Step 2: Please assemble the upper part and lower part with the M6 cross-head bolt as shown on the image.

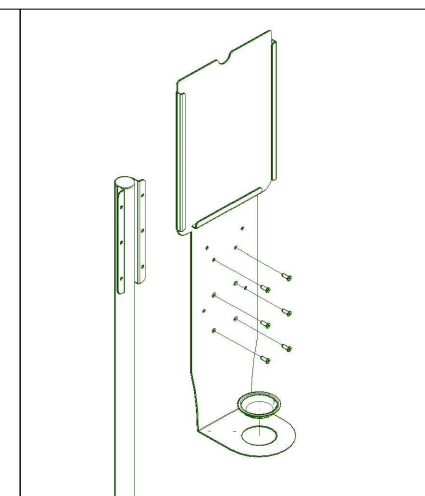

Step 3: Please assemble the upper part and information board by using M4 countersunk-head bolt as shown on the image. Waste bowl should be placed as shown into its place

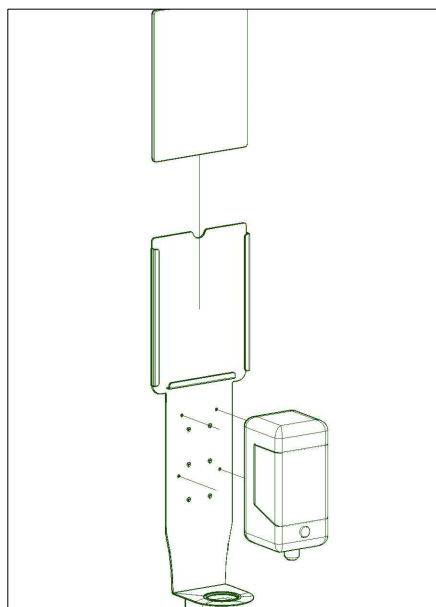

Step 4: Please assemble the dispenser as shown to the information board. Open the front lid of the dispenser and use M4 cross-head bolt. To open the front lid of the dispenser press the bottom below. Place the plexiglass board as shown on the information board to its place

Step 5: Your product is ready to use.

