

- EXISTING AOA FENCE
- NEW AOA FENCE TO BE ADDED AFTER CONSTRUCTION
- LIMITS OF CONSTRUCTION
- TEMPORARY PERIMETER CONSTRUCTION FENCE DURING CONSTRUCTION
- TEMPORARY AOA FENCE DURING CONSTRUCTION

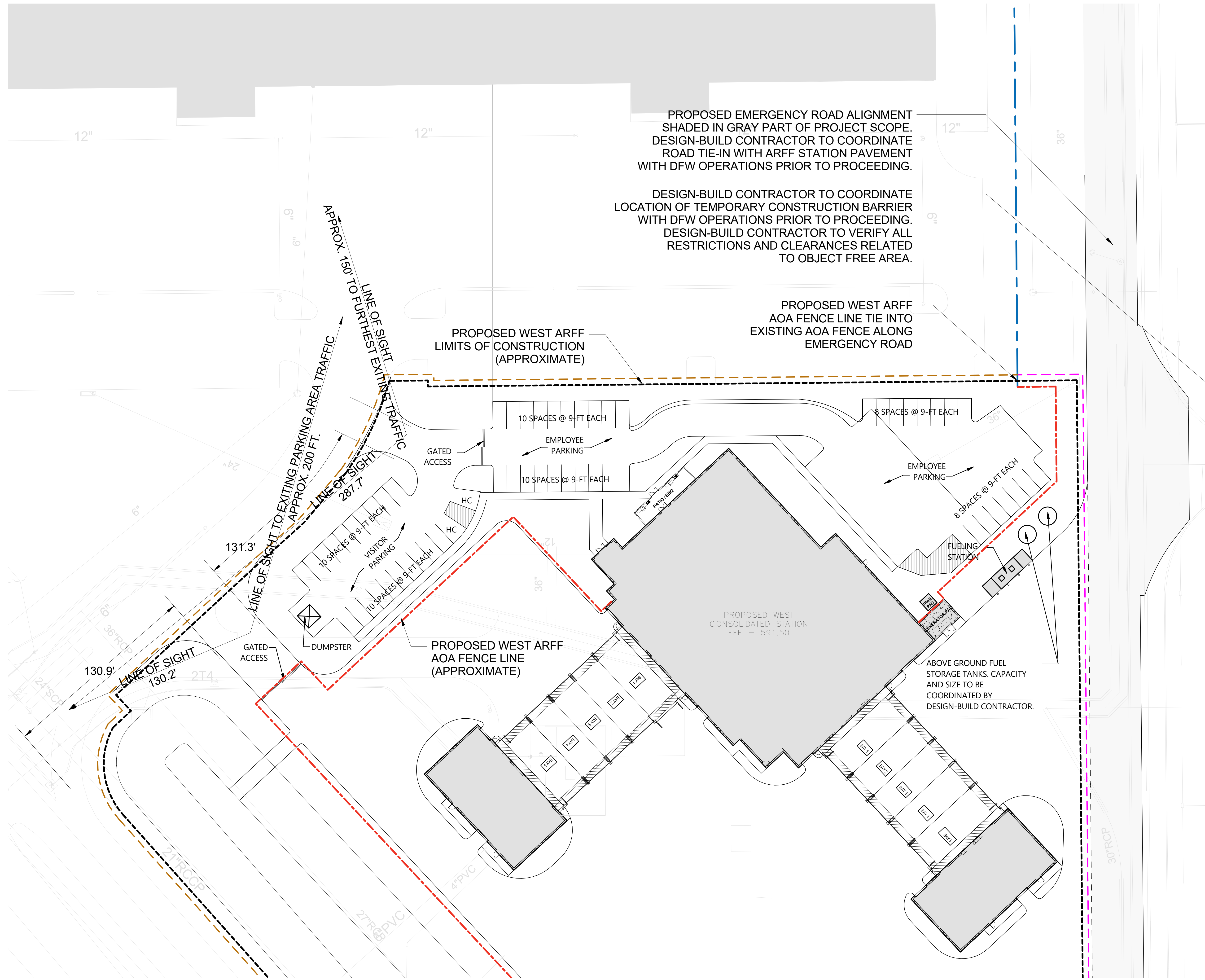

PROPOSED EMERGENCY ROAD ALIGNMENT SHADED IN GRAY PART OF PROJECT SCOPE. DESIGN-BUILD CONTRACTOR TO COORDINATE ROAD TIE-IN WITH ARFF STATION PAVEMENT WITH DFW OPERATIONS PRIOR TO PROCEEDING.

DESIGN-BUILD CONTRACTOR TO COORDINATE LOCATION OF TEMPORARY CONSTRUCTION BARRIER WITH DFW OPERATIONS PRIOR TO PROCEEDING. DESIGN-BUILD CONTRACTOR TO VERIFY ALL RESTRICTIONS AND CLEARANCES RELATED TO OBJECT FREE AREA.

PROPOSED WEST ARFF LIMITS OF CONSTRUCTION (APPROXIMATE)

PROPOSED WEST ARFF AOA FENCE LINE TIE INTO EXISTING AOA FENCE ALONG EMERGENCY ROAD

PROPOSED WEST ARFF AOA FENCE LINE (APPROXIMATE)

ABOVE GROUND FUEL STORAGE TANKS. CAPACITY AND SIZE TO BE COORDINATED BY DESIGN-BUILD CONTRACTOR.

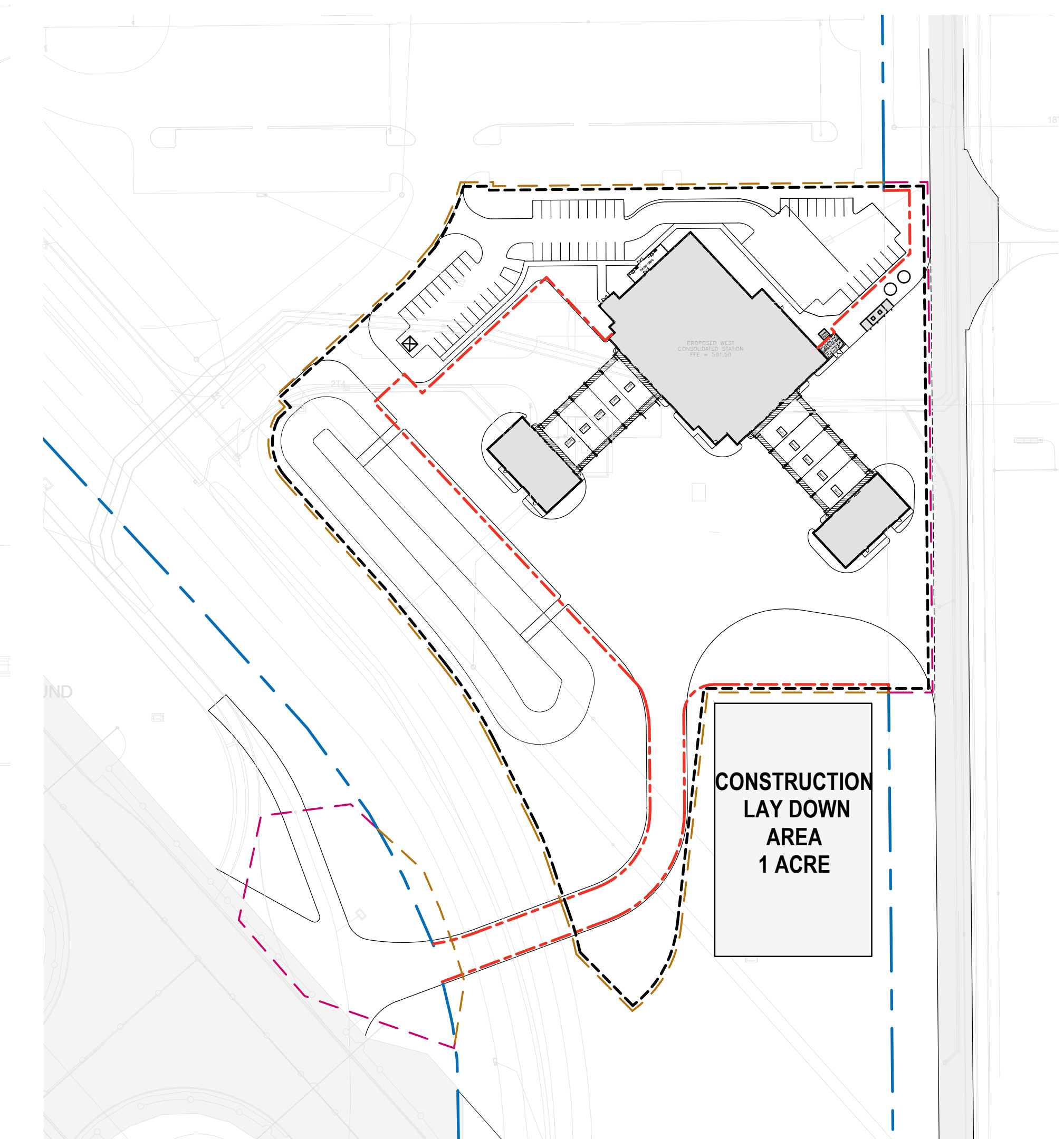

1 CONSTRUCTION PLAN - WEST ARFF SITE OVERALL
SCALE: 1" = 100'-0"

MATCH DRAWING TO 2 / CS1-0-002

2 CONSTRUCTION PLAN - WEST ARFF ENLARGED NORTH
SCALE: 1" = 30'-0"

PRELIMINARY



DESIGN, CODE & CONSTRUCTION (DCC)
3003 SOUTH SERVICE ROAD
DFW AIRPORT, TX 75261



NOT FOR CONSTRUCTION
ISSUE DATE: 08/07/20

NO.	DATE	REVISION
1	08/07/20	50% SCHEMATIC DESIGN
2	07/16/2020	INTERIM SCHEMATIC DESIGN SUBMISSION
3	07/13/2020	100% SCHEMATIC DESIGN
4	06/10/2020	100% SCHEMATIC DESIGN
5	05/25/20	100% SCHEMATIC DESIGN

ARFF STATION CONSOLIDATION
CONSTRUCTION SITE PLAN - WEST ARFF
CONTRACT NUMBER: 9500729 PERMIT NUMBER: A20-1348

SHEET NUMBER
CS1-0-001

SCALE(S) AS NOTED ON THIS SHEET ARE BASED ON A FULL SIZE 30 X 42 SHEET.