

Welcome to Hive

This guide tells you everything you need to know to use your Hive Thermostat Stand.

If you're new to Hive products, please see the user guide provided with your Hive Hub to set up your Hive account.

Hive Thermostat Stand

How to fit the Hive Thermostat or Hive Thermostat Mini to your Hive Thermostat Stand:

- 1 Remove the back plate of the thermostat by pulling the tab at the bottom backwards
- 2 Unscrew the two screws from the stand mount
- 3 Insert the screws through the holes on either side of the back plate and screw these into the stand mount
- 4 Hook the thermostat onto the stand back plate and click it into place

Use your Hive Thermostat in any room with the Hive Thermostat Stand.

Aim for around 1–1.5m from the floor and away from heat sources such as radiators and direct sunlight. To give accurate temperature readings, your thermostat needs a flow of air, so please ensure you place it in an area not covered by curtains or similar objects.

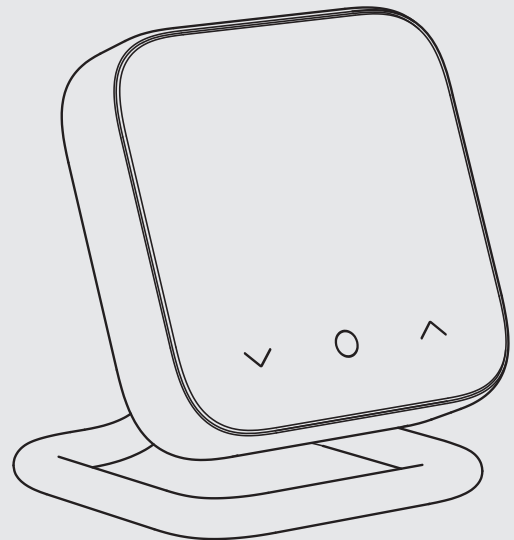

Note: If the thermostat is positioned in the same room as a radiator controlled by a thermostatic radiator valve (TRV), this may prevent the thermostat from being able to reach its target temperature and may result in the central heating being permanently on.

Works with the following Hive Thermostats:

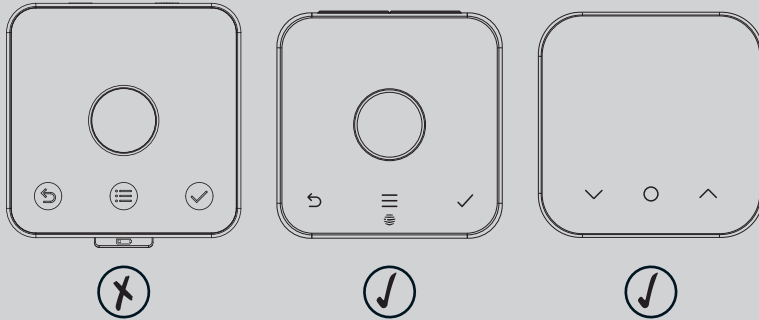

Can we help?

You can view our handy how-to-use videos along with hints and tips at hivehome.com/support

If for any reason you need to return your Hive Thermostat Stand, simply return your box and its contents to the retailer. Any return is subject to the retailer's refund policy so please don't forget to check the retailer's refund policy too.

