

BRAUN

Silk-épil Bikini Styler

Unzip your creativity

Bikini Styler - how to guide

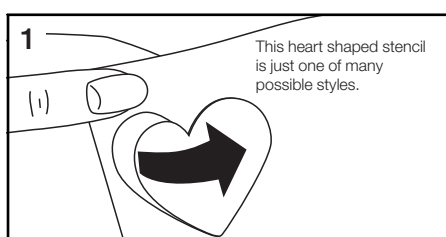

Select a style

1. Print & cut out your preferred bikini style on thick paper.

Note: Thicker paper will ensure the stencil doesn't fold or ripple.

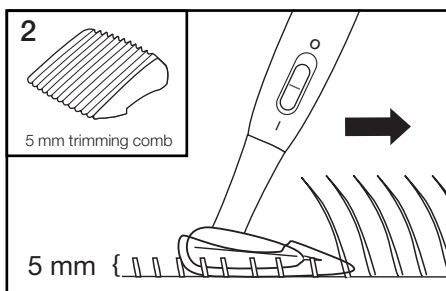

Getting ready

2. Attach the 5 mm trimming comb onto the slim bikini shaping head. Trim the hair to a uniform length by guiding the appliance flat against the skin.

Note: The 5 mm trimming comb cuts the hair to an ideal length for stencil application.

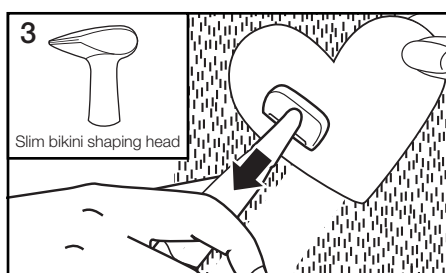

Shave the shape

3. Take off the 5 mm trimming comb. Place the stencil onto the trimmed area in the desired position. Shave the area around the stencil.

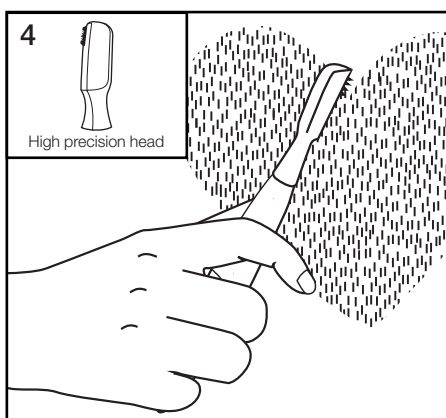

Tips and tricks

4. For more precise styling, or to create an accurate customized shape, use the high precision head.
 - a) Place the cutting head near the hair you'd like to remove and trim slowly against the direction of hair growth.
 - b) For optimal results pull the skin taut with one hand whilst trimming.

Note: Depending on your personal hair density and colour, the outcome might be different.

The high precision head is also perfect for removing unwanted hair in other body areas.

Try more stencil styling on www.braun.com

Important

- The appliance is not intended for use by children or persons with reduced physical, sensory or mental capabilities, unless they are supervised by a person responsible for their safety. Keep the appliance out of reach of children to ensure that they do not play with it.
- Batteries may leak if empty or not used for a long time. In order to protect you and the appliance, please remove batteries in a timely manner and avoid skin contact whilst handling leaking batteries.
- For hygienic reasons, do not share this appliance with other persons.
- Do not use the appliance on irritated or inflamed skin.
- Never use the appliance with a damaged cutting head.