

TECHNICAL SUPPORT

Call Trojan Battery Technical Support:

United States and Canada: 800-423-6569, dial ext. 3045

International: +1-562-236-3045

Email: technical@cdtrojan.com

On the web: trojanbattery.com/resources/technical-support

Corporate Headquarters

Trojan Battery Company

12380 Clark Street

Santa Fe Springs, CA 90670

©2024 Trojan Battery Company, LLC. All rights reserved. Trojan Battery Company is not liable for damages that may result from any information provided in or omitted from this publication, under any circumstances. Trojan Battery Company reserves the right to make adjustments to this publication at any time, without notice or obligation. Please check the Trojan Battery Company website (www.trojanbattery.com) for the most up-to-date information.

RS02259-AES-AGM-LiftPack-QSG Rev 07/26/24



INSTALLATION

- The LiftPack weighs 365 lbs (166 kg) and is not designed to be lifted by hand. Use of a properly rated lifting strap is recommended.

- Verify the equipment is powered off and disconnected from AC power and external chargers.

- Remove existing battery pack and inspect the area for loose wires, debris, or other objects that may interfere with the fit of the LiftPack.

- Using mechanical assistance, pick up the LiftPack by the lifting points and maneuver into position, with the solid side of the case facing out.

- Secure the LiftPack to the equipment by bolting through the mounting tab located inside the hinged charging port door.

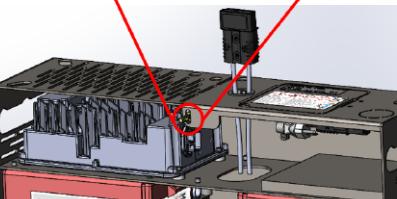
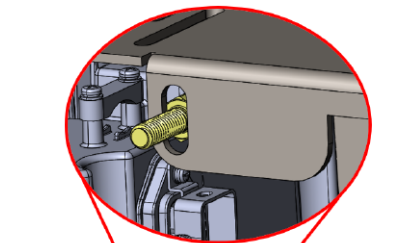

Note: SYS00596 is secured with an extended bolt through the solid face of the LiftPack.

SPECIFICATION

Dimensions & Weight

LiftPack™ Model Number	Nominal Voltage (VDC)	AH Capacity (@ 6 Hr)	Length* (mm)	Width* (mm)	Height* (mm)	Weight** (kg)
SYS00596	24	171	27.3 (693)	7.5 (191)	26.2 (664)	365 (165.6)
SYS00597	24	171	26.5 (673)	7.5 (191)	26.2 (664)	365 (165.6)
SYS00598	24	171	25.3 (643)	8.5 (216)	26.2 (664)	365 (165.6)

*Length/Width/Height dimensions in inches. **Weight in lbs.

Charger Specification

Charger Model	AC Input	DC Output	Operating Temperature
Lester Electrical Summit Series II 650W	Voltage: 100-240Vac Frequency: 50-60Hz Current: <8A Current, maximum	Nominal Voltage: 24VDC Maximum Voltage: 36VDC Maximum Current: 25A	-25C to +60C (-13F to +140F)
DeltaQ IC650	Voltage: 85-270Vac Frequency: 50-60Hz Current: <7.3A Current, maximum	Nominal Voltage: 24VDC Maximum Voltage: 36VDC Maximum Current: 27.1A	-40C to +65C (-40F to +149F)

TROJAN® AES AGM
LIFTPACK™



QUICK START GUIDE

TROJAN® AES AGM LIFTPACK™

LIFTPACK OVERVIEW

- A. LiftPack Case
- B. Lifting Points
- C. Battery Charger
- D. Charging Cord Door
- E. Battery Cable w/ Quick Disconnect
- F. Trojan AES AGM Battery
- G. Battery Hold Down Plate

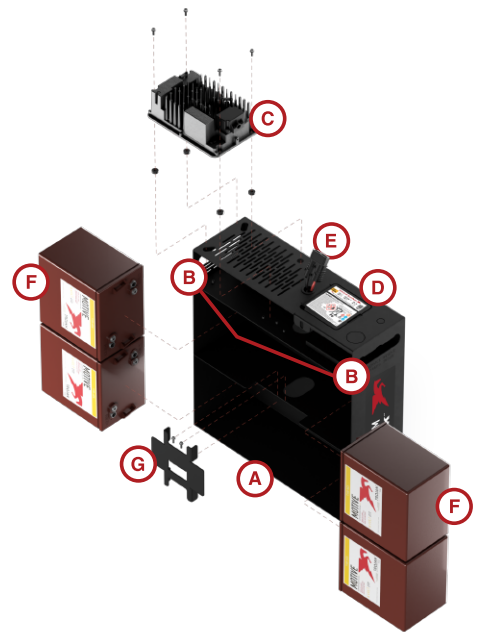

NEEDED FOR INSTALLATION



Eye Protection
& Gloves



Voltmeter
(optional)



Wrench



Lifting Strap
(recommended)



Before installation, fully charge the battery to 100% SOC.

SAFETY

- Do not attempt to move or carry the LiftPack by hand.
- Wear proper personal protective equipment (eye protection, gloves, and safety-toe shoes).
- Always use insulated tools.
- Do not wear jewelry or other metallic objects when handling or working near batteries.
- Keep sparks and flames away from batteries. This includes sources of static electricity.
- Do not remove battery vents.
- Do not disassemble the battery charger.
- Always disconnect the battery cable quick disconnect from the vehicle before charging. Do not reconnect until charging is complete.
- Do not attempt to move the equipment while battery charger is plugged into an AC power source.
- Do not use extension cords for charging unless absolutely necessary. Use only use 3 conductor, 14 AWG, heavy-duty extension cords less than 25 ft (30 cm) in length in good electrical condition.

GETTING STARTED

Your LiftPack will arrive fully assembled and ready to be installed into your equipment.

Before installing the LiftPack:

- Inspect the case, charger, batteries and wiring for signs of damage or leaking.
- Verify the dimensions of the LiftPack will fit securely on the vehicle.
- Fully charge the LiftPack before first use.

