

Top View of Base Stand # 3857300

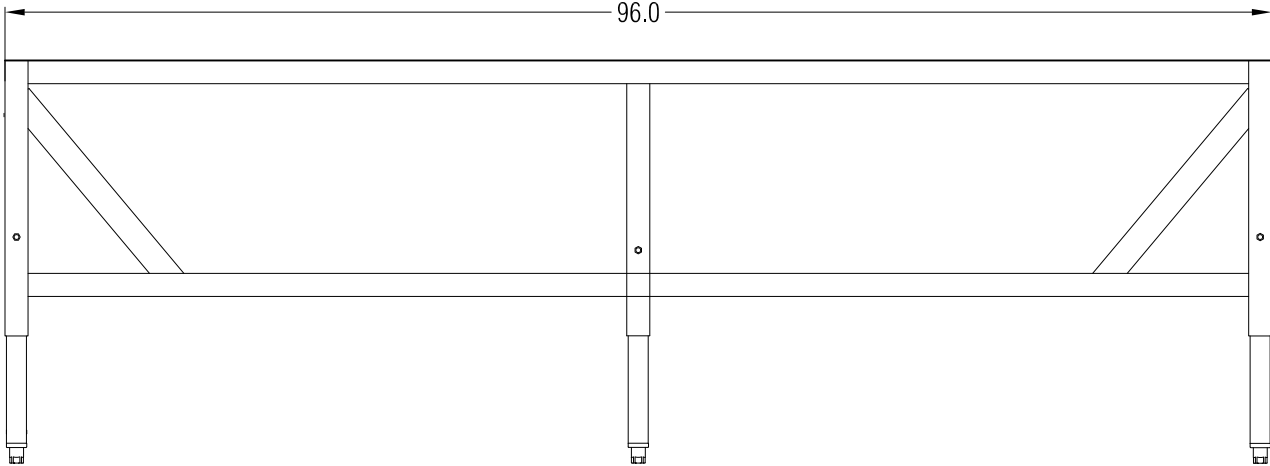

FRONT VIEW

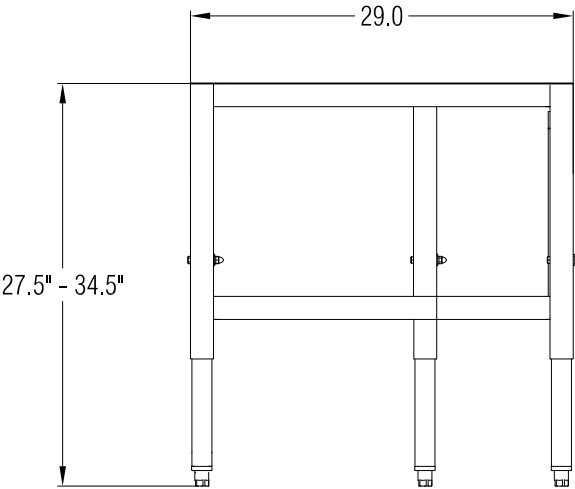

SIDE VIEW

GENERAL DESCRIPTION

8’ TELESCOPING BASE STAND

Model: 3857300

- Supports a Purifier Clean Bench or Enclosure.
- Supports loads up to 4,000 pounds (1814 kg).
- ADA-compliant.
- Durable 1.75” tubular, powder-coated steel frame. Includes a rear crossbar supports.
- Telescoping legs are adjustable to eight height positions in 1” increments from 27.5” to 34.5”.
- Fixed leveling feet.



LABCONCO CORPORATION • KANSAS CITY MO USA 64132  
800-821-5525 / 816-333-8811 • labconco.com

No.	Date

Date:  
05-16-2022

Drawing #  
3857300

Drawn By:  
C. Alumbaugh

Checked By:

Approved By:

Sheet No.

SCALED TO FIT