

REAR VIEW

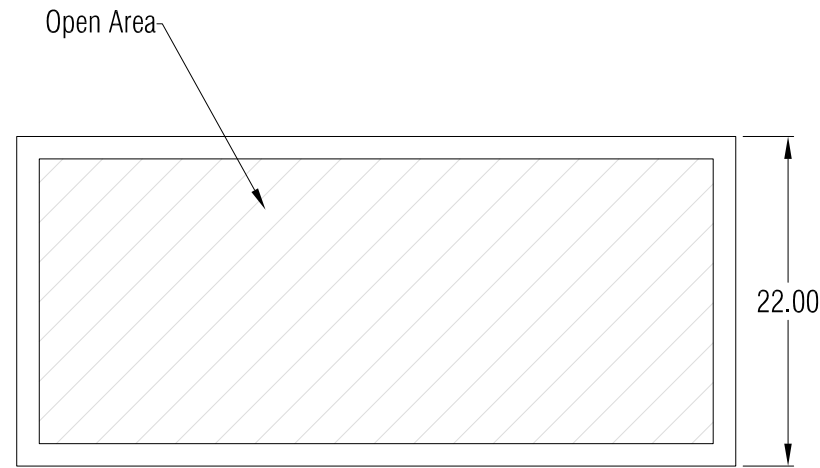

TOP VIEW

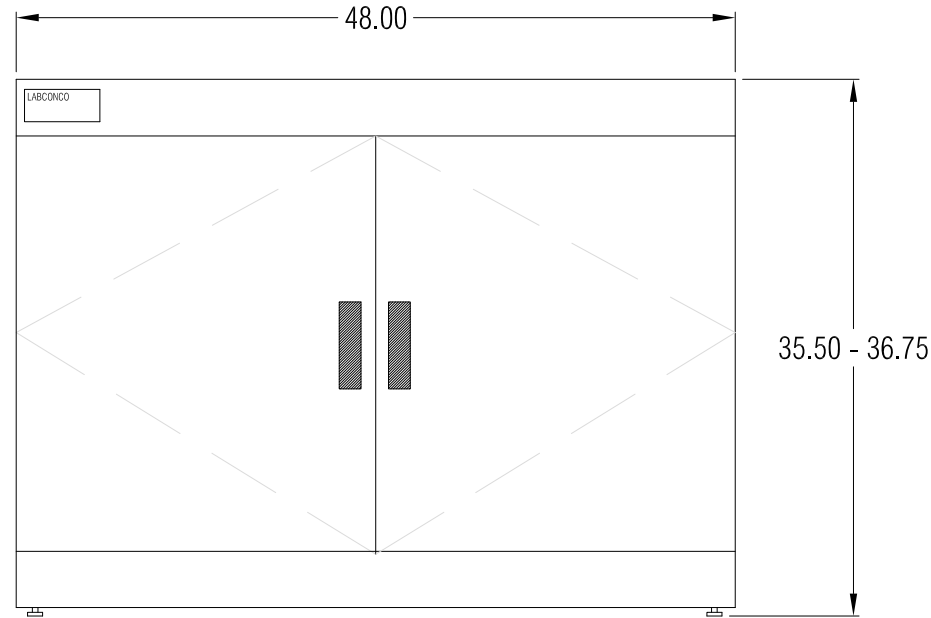

FRONT VIEW

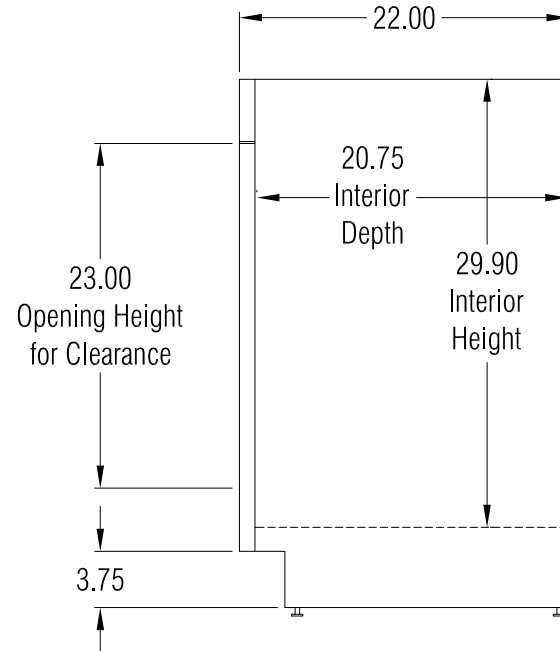

SIDE VIEW

GENERAL DESCRIPTION

48" Protector Standard Storage Cabinet
Model: 9900000

General Features:

- Used for non-chemical storage
- Support all Labconco benchtop fume hoods
- Support loads up to 800 lbs.
- Durable powder-coated steel construction
- Glacier white exterior complements laboratory casework and Labconco fume hoods
- Manual-closing, non-locking doors
- Include leveling feet and one 8" filler panel to increase cabinet depth to 30"

Optional Accessories (Sold Separately)

- Interior Shelf Kits
- Additional Filler Panels

All models require (Sold Separately)

- Work surface

SCALE: SCALED TO FIT



LABCONCO CORPORATION • KANSAS CITY MO USA 64132
800-821-5525 / 816-333-8811 • labconco.com

No.	Date

Date:
06-03-2024

Drawing #
9900000

Drawn By:
C. Alumbaugh

Checked By:

Approved By:

Sheet No.