

# 14143-14205 Washington Avenue

## San Leandro, CA



**52,269 SF Industrial Building**  
**For Lease | Available Q3 2025**



# 14143-14205 Washington Avenue

## San Leandro, CA

### PROPERTY HIGHLIGHTS

With easy access to I-880, I-580 and Highway 92/San Mateo Bridge, 14143-14205 Washington Avenue provides excellent access to Oakland International Airport (5 miles), the Port of Oakland (11 miles) and San Francisco International Airport (25 miles). This property has been designed to meet the growing demand for a variety of industrial and advanced manufacturing requirements.

- ±52,269 SF Warehouse
- Built-to-Suit Office
- ±3.44 Acres
- ±32' Clear Height
- ESFR Sprinkler System
- 15 Dock Doors
- 2 Drive-In Doors
- 3,000 Amps Power
- 62 Car Parking Stalls
- Fully Secured Site

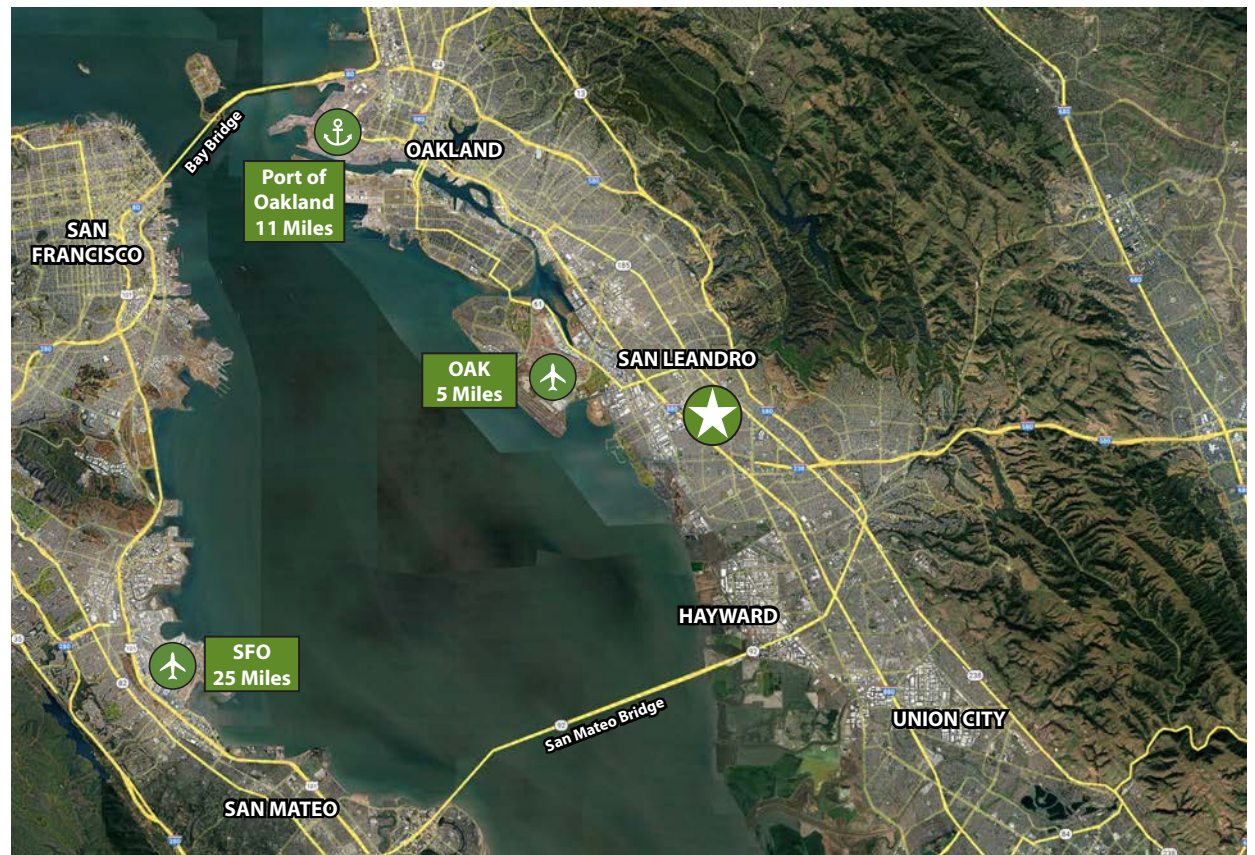

© 2024 KBC ADVISORS This information has been obtained from sources believed to be reliable but has not been verified for accuracy or completeness, and KBC Advisors disclaims any guarantees, warranties or representations, express or implied, as to the completeness or accuracy as to the information contained herein. You should conduct a careful, independent investigation of the property and verify all information. Any reliance on this information is solely at your own risk. The KBC ADVISORS logo is a service mark of KBC ADVISORS. All other marks displayed on this document are the property of their respective owners. Photos herein are the property of their respective owners. Use of these images without the express written consent of the owners is prohibited.



# 14143-14205 Washington Avenue

## San Leandro, CA

### SITE PLAN

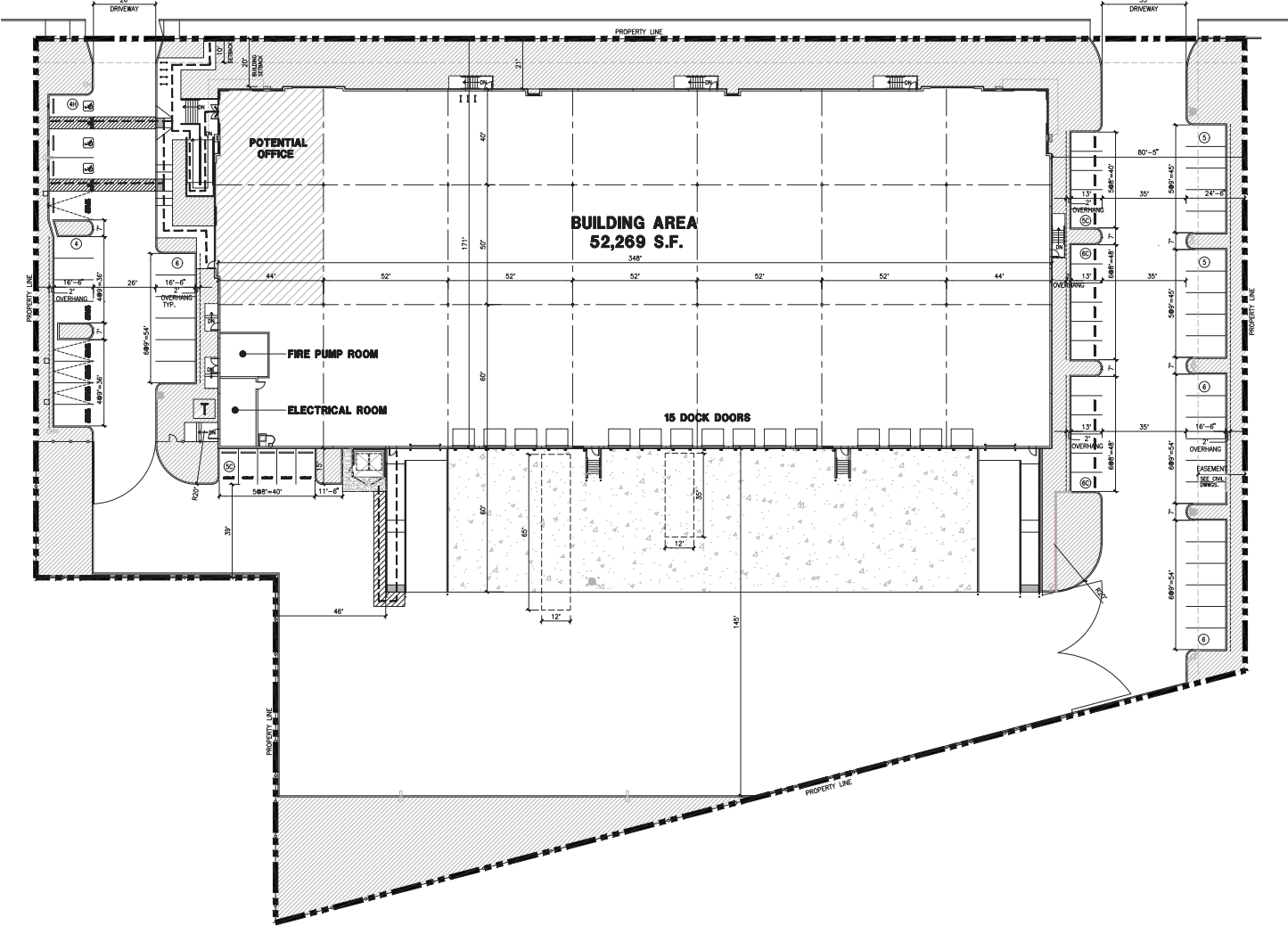

© 2024 KBC ADVISORS This information has been obtained from sources believed to be reliable but has not been verified for accuracy or completeness, and KBC Advisors disclaims any guarantees, warranties or representations, express or implied, as to the completeness or accuracy as to the information contained herein. You should conduct a careful, independent investigation of the property and verify all information. Any reliance on this information is solely at your own risk. The KBC ADVISORS logo is a service mark of KBC ADVISORS. All other marks displayed on this document are the property of their respective owners. Photos herein are the property of their respective owners. Use of these images without the express written consent of the owners is prohibited.



# 14143-14205 Washington Avenue

## San Leandro, CA

### BROKER CONTACT

#### Tom Damaschino, SIOR

Market Leader  
(510) 599-1189  
tom.damaschino@kbcadvisors.com  
DRE License# 01261227



312 Clay Street, Suite 180  
Oakland, CA 94607  
[www.kbcadvisors.com](http://www.kbcadvisors.com)

#### Jeff Starkovich, SIOR

Executive Managing Director  
(510) 409-1111  
jeff.starkovich@cushwake.com  
DRE License# 00644571



555 12th Street, Suite 100  
Oakland, CA 94607  
[www.cushmanwakefield.com](http://www.cushmanwakefield.com)

### OWNER CONTACT

#### John Quinn

Market Leader/Regional Director  
(805) 906-4091  
jqquinn@firstindustrial.com



3620 Happy Valley Road, Suite 201  
Lafayette, CA 94569  
[www.firstindustrial.com](http://www.firstindustrial.com)