

196th Commerce Center

**56,744 SF For Lease**



Unmatched East Valley  
Highway frontage



Oversized grade-level  
door



60' x 20'  
Column Spacing



Heavy Power

8240 South 196th Street Kent, WA 98032

**Matt Wood, SIOR**

+1 206 595 6814

[matt.wood@kbcadvisors.com](mailto:matt.wood@kbcadvisors.com)

**Michael Roy**

+1 206 940 7199

[michael.roy@kbcadvisors.com](mailto:michael.roy@kbcadvisors.com)

**John Broom**

+1 206 877 2750

[john.broom@kbcadvisors.com](mailto:john.broom@kbcadvisors.com)

**KBC Advisors | Seattle**

5628 Airport Way, Suite 238

Seattle, WA 98108

# Floor Plan

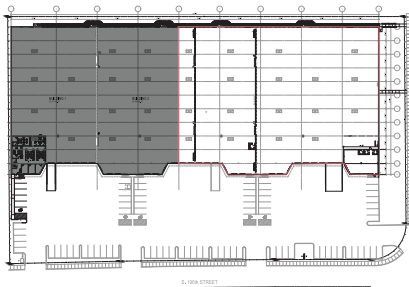
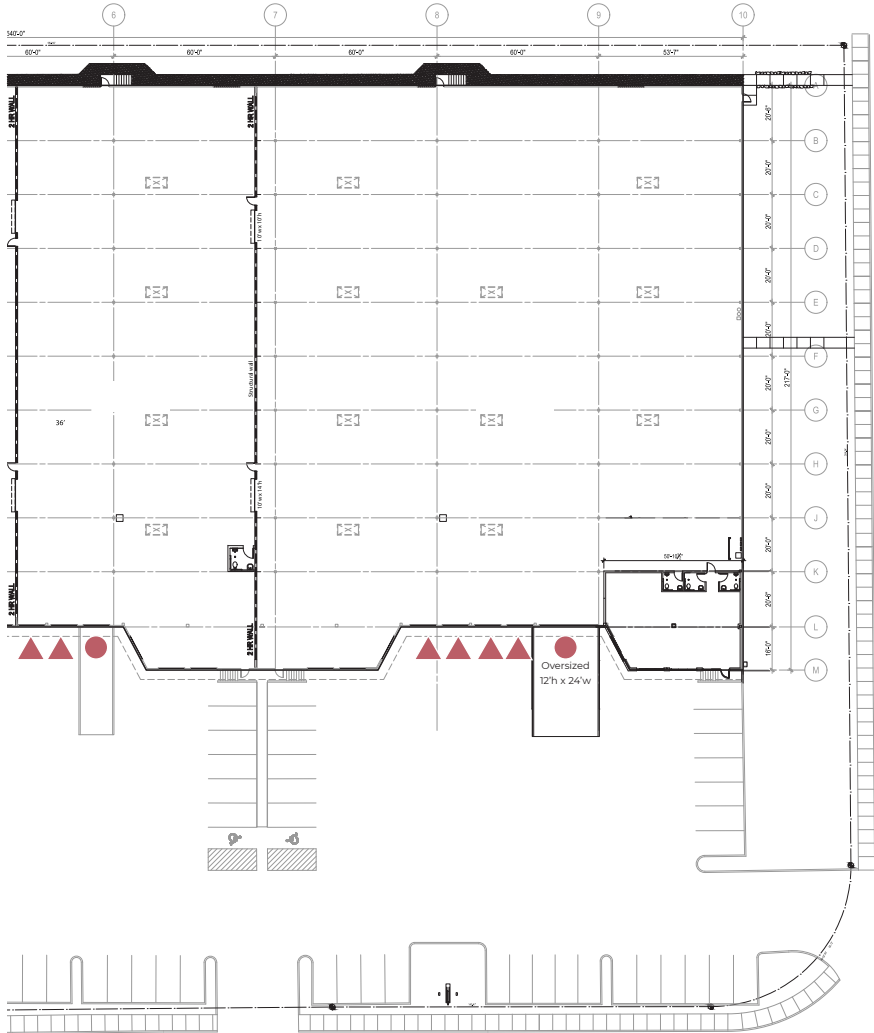

▲ Dock Door  
● Grade Door



**56,744**  
Square Feet

**1,852**  
SF Office

**6**  
Dock-high doors

**2**  
Grade-level doors  
(1 oversized)

**TWO 600**  
Amp panels

**24'**  
Clear height

**48**  
Auto stalls

**10/1/2026**  
Availability

Matt Wood, SIOR  
+1 206 595 6814  
matt.wood@kbcadvisors.com

Michael Roy  
+1 206 940 7199  
michael.roy@kbcadvisors.com

John Broom  
+1 206 877 2750  
john.broom@kbcadvisors.com

KBC Advisors | Seattle  
5628 Airport Way, Suite 238  
Seattle, WA 98108

# Access Map

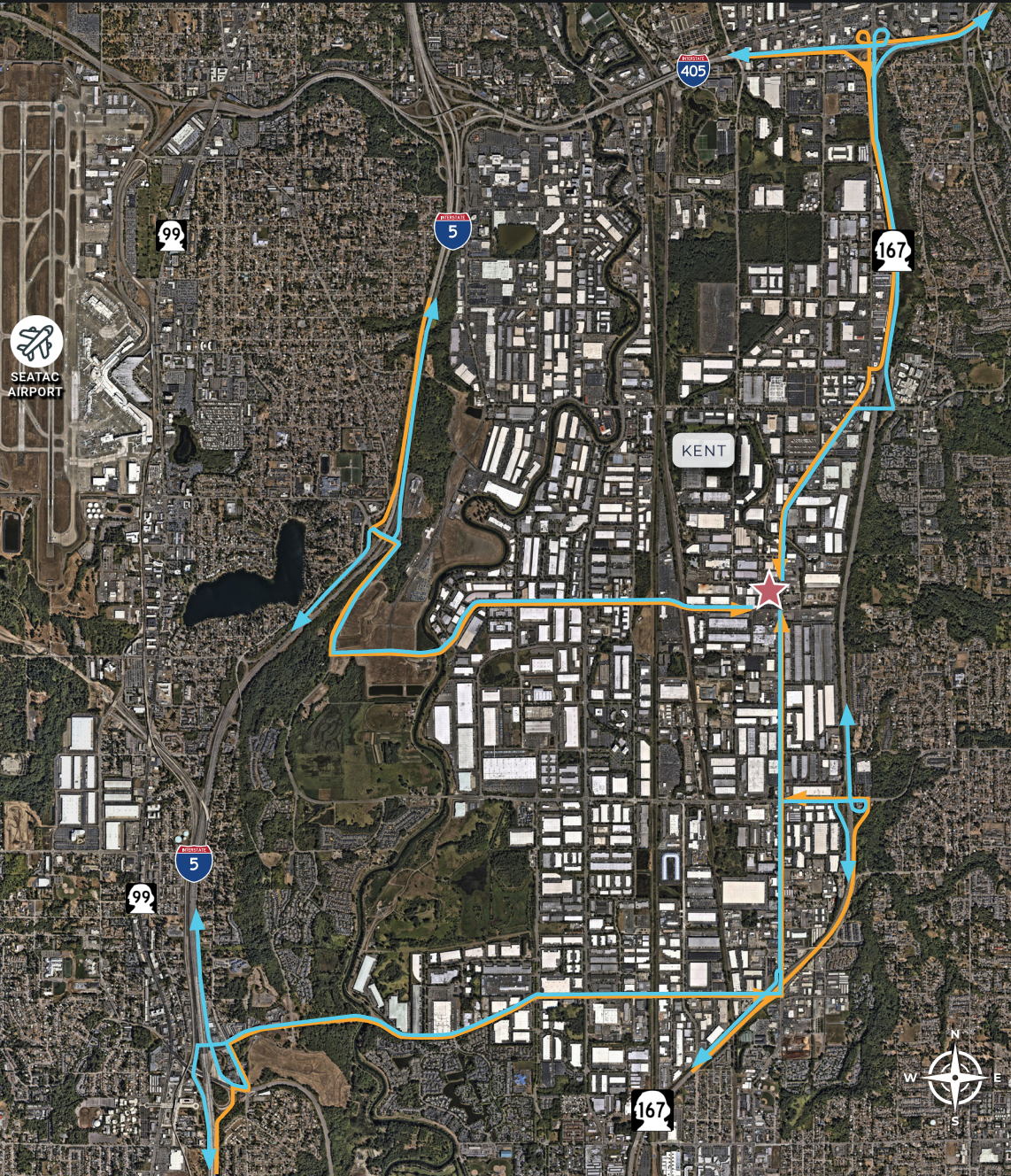

**Matt Wood, SIOR**  
+1 206 595 6814  
matt.wood@kbcadvisors.com

**Michael Roy**  
+1 206 940 7199  
michael.roy@kbcadvisors.com

**John Broom**  
+1 206 877 2750  
john.broom@kbcadvisors.com

**KBC Advisors | Seattle**  
5628 Airport Way, Suite 238  
Seattle, WA 98108

© 2026 KBC ADVISORS This information has been obtained from sources believed to be reliable but has not been verified for accuracy or completeness, and KBC Advisors disclaims any guarantees, warranties or representations, express or implied, as to the completeness or accuracy as to the information contained herein. You should conduct a careful, independent investigation of the property and verify all information. Any reliance on this information is solely at your own risk. The KBC ADVISORS logo is a service mark of KBC ADVISORS. All other marks displayed on this document are the property of their respective owners. Photos herein are the property of their respective owners. Use of these images without the express written consent of the owners is prohibited.

