

2357 Industrial Parkway West, Hayward, CA 94544

±21,792 SF Available For Sublease



±21,792
Square Feet



±1,500 SF
Office



±20'
Clear Height



2 Dock Doors
1 Grade Door



600 Amps
Power

Kevin Kennick
+1 925 330 1601
kevin.kennick@kbcadvisors.com
DRE License# 02110600

Property Overview

PROPERTY SPECS

SIZE	±21,792 SF
OFFICE SIZE	±1,500 SF (with HVAC)
CLEAR HEIGHT	±20'
DOCK DOORS	2
GRADE DOORS	1
AUTO PARKING STALLS	2/1,000 SF
SPRINKLER SYSTEM	Wet
POWER	600 Amps*

BUSINESS PARK SETTING	Parkway Commerce Center Well-Maintained Property
ACCESS	Immediate Access to I-880 Close to Highway 92 & the San Mateo Bridge
AVAILABLE	Now
MASTER LEASE EXPIRATION	September 30, 2026
LEASE RATE	Call Broker

* Sublessee to confirm

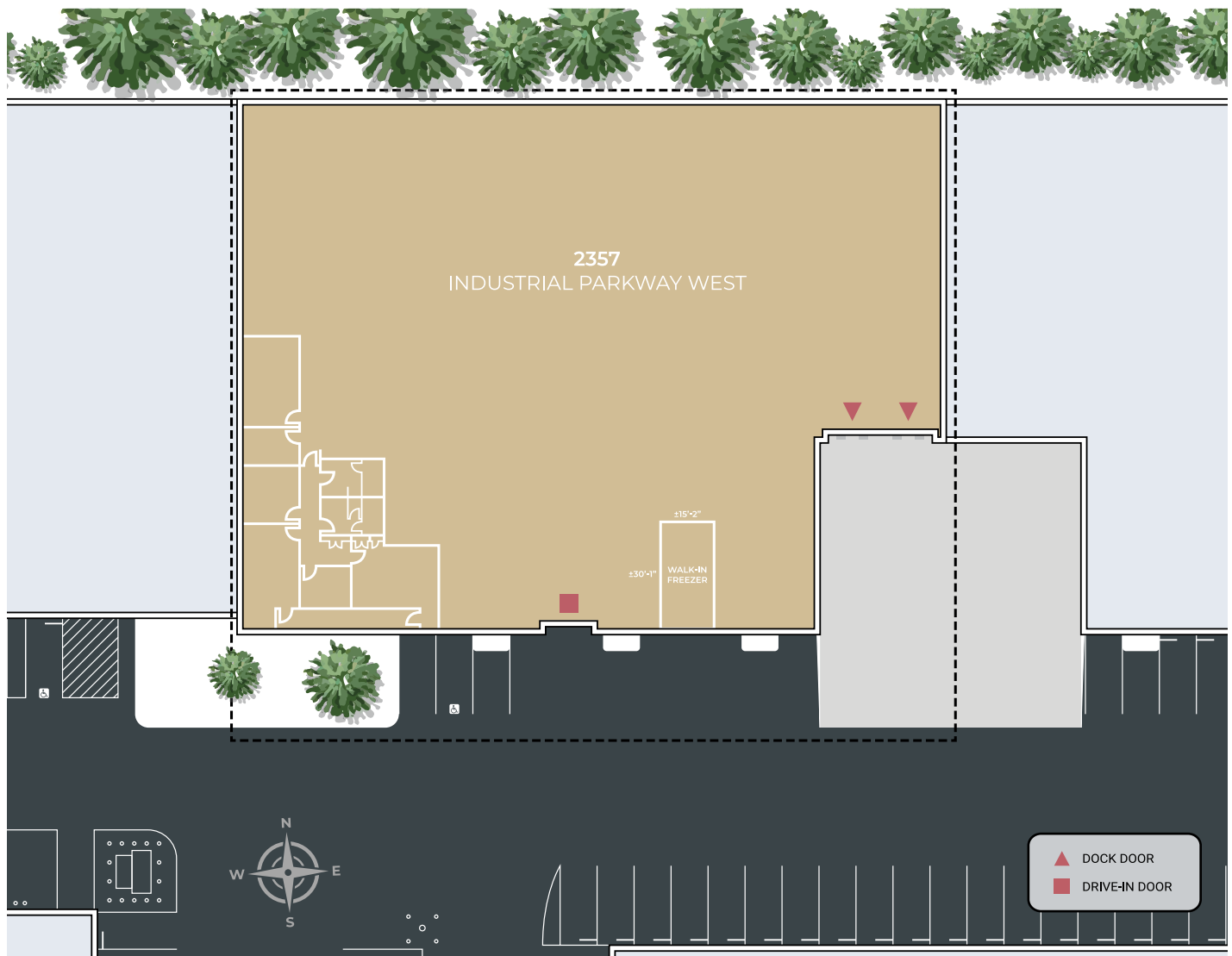

Site plan not to scale & subject to change

Regional Map

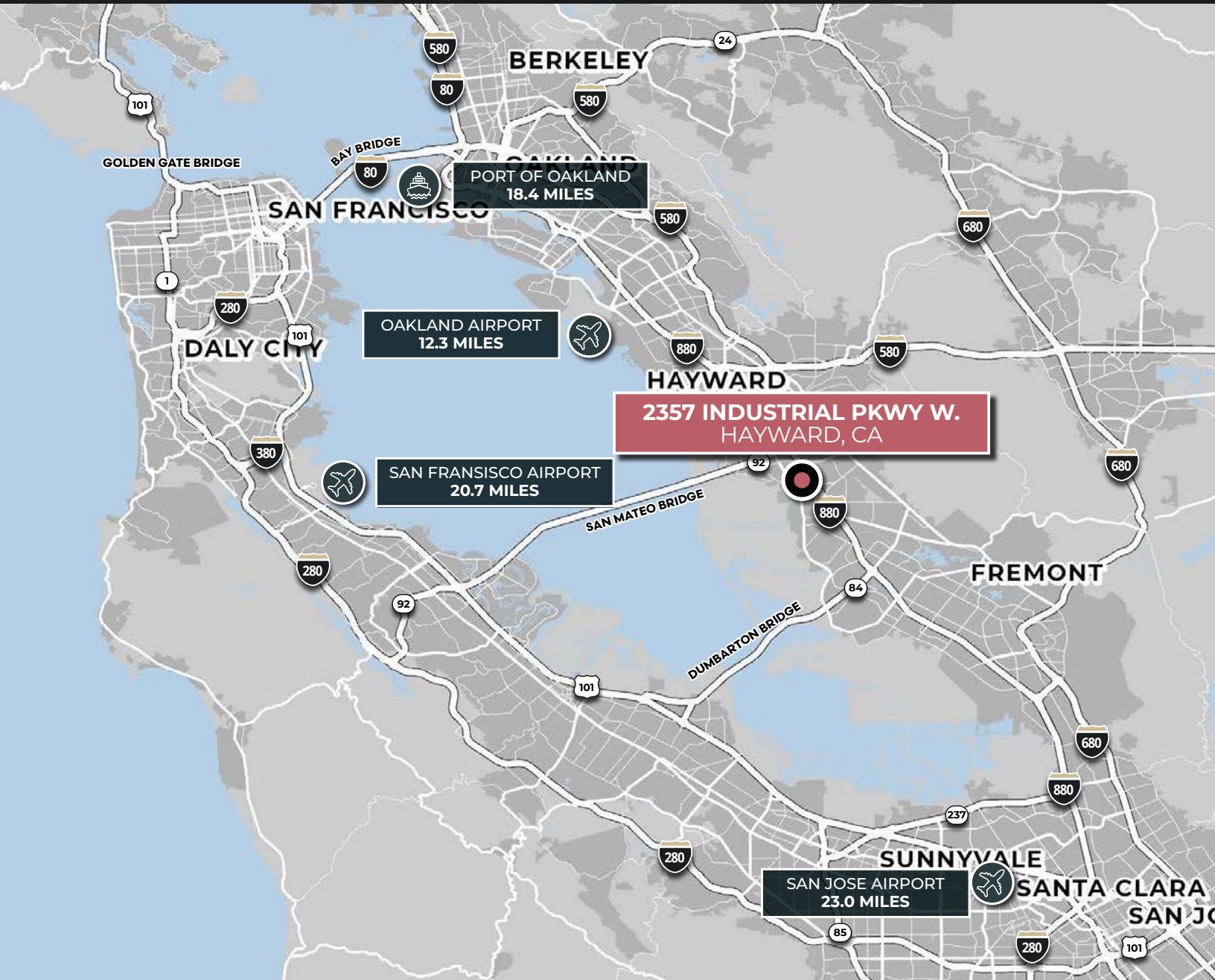

Kevin Kennick
+1 925 330 1601
kevin.kennick@kbcadvisors.com
DRE License# 02110600

© 2025 KBC ADVISORS This information has been obtained from sources believed to be reliable but has not been verified for accuracy or completeness, and KBC Advisors disclaims any guarantees, warranties or representations, express or implied, as to the completeness or accuracy as to the information contained herein. You should conduct a careful, independent investigation of the property and verify all information. Any reliance on this information is solely at your own risk. The KBC ADVISORS logo is a service mark of KBC ADVISORS. All other marks displayed on this document are the property of their respective owners. Photos herein are the property of their respective owners. Use of these images without the express written consent of the owners is prohibited.

